

Tg

DATE IN	SUSPENSE	ENGINEER	LOGGED IN	TYPE	APP NO.
---------	----------	----------	-----------	------	---------

ABOVE THIS LINE FOR DIVISION USE ONLY

NEW MEXICO OIL CONSERVATION DIVISION
- Engineering Bureau -
1220 South St. Francis Drive, Santa Fe, NM 87505



ADMINISTRATIVE APPLICATION CHECKLIST

THIS CHECKLIST IS MANDATORY FOR ALL ADMINISTRATIVE APPLICATIONS FOR EXCEPTIONS TO DIVISION RULES AND REGULATIONS WHICH REQUIRE PROCESSING AT THE DIVISION LEVEL IN SANTA FE

Application Acronyms:

[NSL-Non-Standard Location] [NSP-Non-Standard Proration Unit] [SD-Simultaneous Dedication]
[DHC-Downhole Commingling] [CTB-Lease Commingling] [PLC-Pool/Lease Commingling]
[PC-Pool Commingling] [OLS - Off-Lease Storage] [OLM-Off-Lease Measurement]
[WFX-Waterflood Expansion] [PMX-Pressure Maintenance Expansion]
[SWD-Salt Water Disposal] [IPI-Injection Pressure Increase]
[EOR-Qualified Enhanced Oil Recovery Certification] [PPR-Positive Production Response]

[1] **TYPE OF APPLICATION** - Check Those Which Apply for [A]

- [A] Location - Spacing Unit - Simultaneous Dedication
☐ NSL ☐ NSP ☐ SD

Check One Only for [B] or [C]

- [B] Commingling - Storage - Measurement
☒ DHC ☐ CTB ☐ PLC ☐ PC ☐ OLS ☐ OLM

- [C] Injection - Disposal - Pressure Increase - Enhanced Oil Recovery
☐ WFX ☐ PMX ☐ SWD ☐ IPI ☐ EOR ☐ PPR

- [D] Other: Specify _____



[2] **NOTIFICATION REQUIRED TO:** - Check Those Which Apply, or Does Not Apply

- [A] ☒ Working, Royalty or Overriding Royalty Interest Owners
[B] ☐ Offset Operators, Leaseholders or Surface Owner
[C] ☐ Application is One Which Requires Published Legal Notice
[D] ☐ Notification and/or Concurrent Approval by BLM or SLO
U.S. Bureau of Land Management - Commissioner of Public Lands, State Land Office
[E] ☐ For all of the above, Proof of Notification or Publication is Attached, and/or,
[F] ☐ Waivers are Attached

[3] **SUBMIT ACCURATE AND COMPLETE INFORMATION REQUIRED TO PROCESS THE TYPE OF APPLICATION INDICATED ABOVE.**

[4] **CERTIFICATION:** I hereby certify that the information submitted with this application for administrative approval is **accurate** and **complete** to the best of my knowledge. I also understand that **no action** will be taken on this application until the required information and notifications are submitted to the Division.

Note: Statement must be completed by an individual with managerial and/or supervisory capacity.

James W. Pringle

Print or Type Name

James W. Pringle
Signature

Operations Engineer

Title

1/16/03

Date

e-mail Address

District I
1625 N. French Drive, Hobbs, NM 88240
District II
811 South First Street, Artesia, NM 88210
District III
1000 Rio Brazos Road, Aztec, NM 87410
District IV
2040 South Pacheco, Santa Fe, NM 87505

State of New Mexico
Energy, Minerals and Natural Resources Department

Form C-107A
Revised May 15, 2000

OIL CONSERVATION DIVISION
2040 South Pacheco
Santa Fe, New Mexico 87505

APPLICATION TYPE
☒ Single Well
☐ Establish Pre-Approved Pools
EXISTING WELLBORE
☒ Yes ☐ No

APPLICATION FOR DOWNHOLE COMMINGLING

Yates Petroleum Corporation 105 South Fourth Street
Operator Address

Summers Com 2 M 25 9S 24E Chaves
Lease Well No. Unit Letter-Section-Township-Range County

OGRID No. 025575 Property Code API No. 30-005-63409-63469 Lease Type: Federal State ☒ Fee

DATA ELEMENT	UPPER ZONE	INTERMEDIATE ZONE	LOWER ZONE
Pool Name	Pecos Slope Abo		Wildcat Wolfcamp
Pool Code			
Top and Bottom of Pay Section (Perforated or Open-Hole Interval)	3420-3676		4496-4566'
Method of Production (Flowing or Artificial Lift)	Flowing		Flowing
Bottomhole Pressure (Note: Pressure data will not be required if the bottom perforation in the lower zone is within 150% of the depth of the top perforation in the upper zone)	NA		NA
Oil Gravity or Gas BTU (Degree API or Gas BTU)	NA		NA
Producing, Shut-In or New Zone	New Zone		New Zone
Date and Oil/Gas/Water Rates of Last Production. (Note: For new zones with no production history, applicant shall be required to attach production estimates and supporting data.)	Date: 1/14/03 1000 mcf/d 0 bwp/d 0 bop/d		Date: 1/12/03 468 mcf/d 0 bwp/d 0 bop/d
Fixed Allocation Percentage (Note: If allocation is based upon something other than current or past production, supporting data or explanation will be required.)	Oil 0% Gas 68 %		Oil 0% Gas 32%

ADDITIONAL DATA

Are all working, royalty and overriding royalty interests identical in all commingled zones? Yes _____ No ☒ X
If not, have all working, royalty and overriding royalty interest owners been notified by certified mail? Yes ☒ X No _____

Are all produced fluids from all commingled zones compatible with each other? Yes ☒ X No _____

Will commingling decrease the value of production? Yes _____ No ☒ X

If this well is on, or communitized with, state or federal lands, has either the Commissioner of Public Lands or the United States Bureau of Land Management been notified in writing of this application? Yes _____ No _____

NMOCD Reference Case No. applicable to this well: _____

Attachments:

- C-102 for each zone to be commingled showing its spacing unit and acreage dedication.
- Production curve for each zone for at least one year. (If not available, attach explanation.)
- For zones with no production history, estimated production rates and supporting data.
- Data to support allocation method or formula.
- Notification list of working, royalty and overriding royalty interests for uncommon interest cases.
- Any additional statements, data or documents required to support commingling.

PRE-APPROVED POOLS

If application is to establish Pre-Approved Pools, the following additional information will be required:

- List of other orders approving downhole commingling within the proposed Pre-Approved Pools
- List of all operators within the proposed Pre-Approved Pools
- Proof that all operators within the proposed Pre-Approved Pools were provided notice of this application.
- Bottomhole pressure data.

I hereby certify that the information above is true and complete to the best of my knowledge and belief.

SIGNATURE James W. Pringle TITLE Operations Engineer DATE January 16, 2003
TYPE OR PRINT NAME James W. Pringle TELEPHONE NO. (505)-748-4182

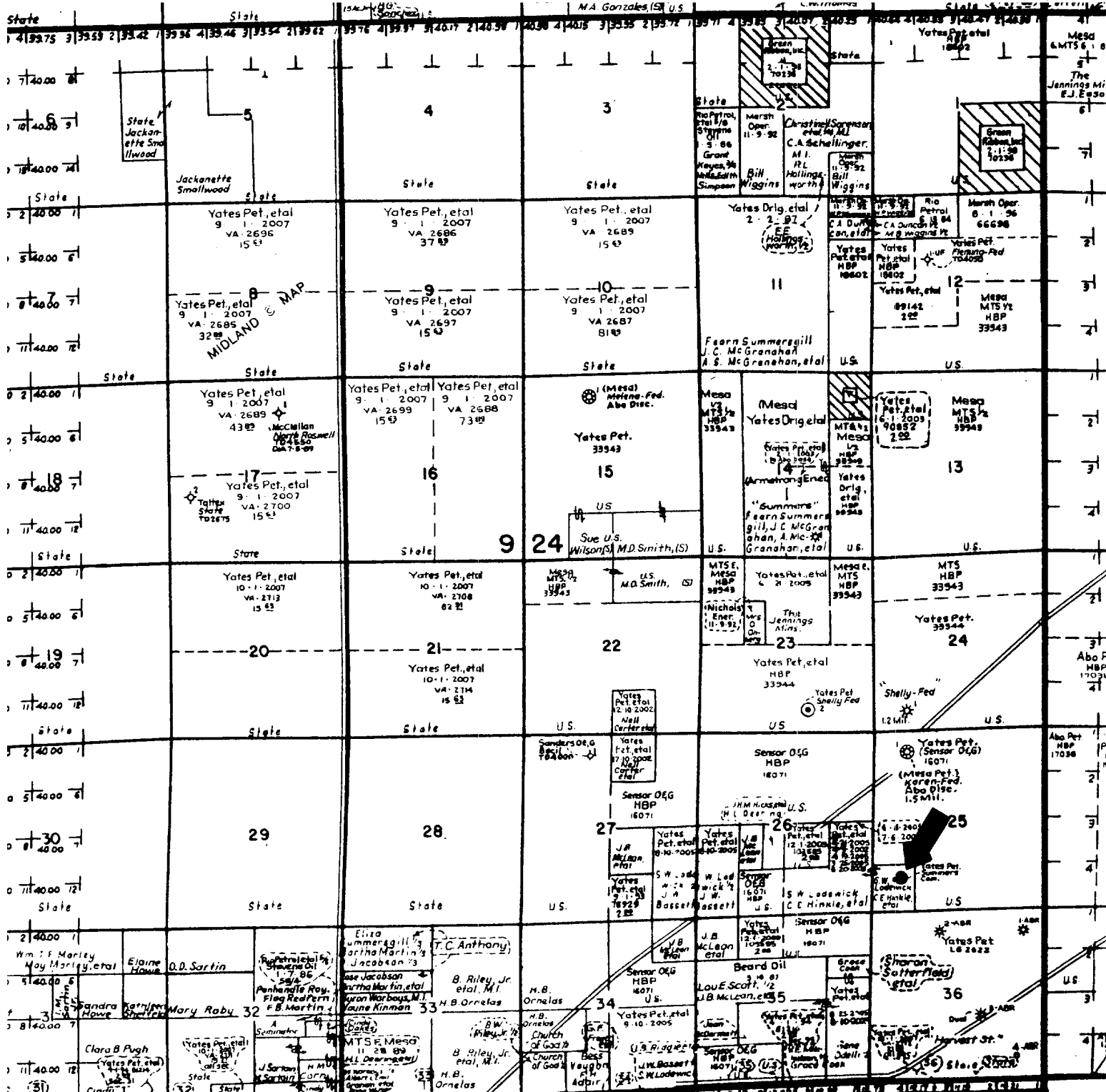

R-24-E

CHAVES, West C



Lease and Fee Information
Posted to 9-21-2002
Oil Conservation Commission Well Information
Posted to 9-21-2002

MARTIN YATES, III
1912 - 1985
FRANK W. YATES
1936 - 1986



105 SOUTH FOURTH STREET
ARTESIA, NEW MEXICO 88210-2118
TELEPHONE (505) 748-1471

S. P. YATES
CHAIRMAN OF THE BOARD
JOHN A. YATES
PRESIDENT
PEYTON YATES
EXECUTIVE VICE PRESIDENT
RANDY G. PATTERSON
SECRETARY
DENNIS G. KINSEY
TREASURER

January 16, 2003

Tim Gum
State of New Mexico
OIL CONSERVATION DIVISION
811 S. First Street
Artesia, NM 88210

Dear Mr. Gum,

Yates Petroleum Corporation hereby seeks administrative approval to downhole commingle the production from the Wildcat Wolfcamp and the Pecos Slope Abo Gas pools in our Summers Com (Fee) #2 located in Unit M of Section 25, Township 9 South, Range 24 East, Chaves County.

If you have any questions or need additional information, please call me at (505) 748-4182.

Thank you.

Sincerely,

A handwritten signature in cursive script that reads 'James W. Pringle'.

James W. Pringle
Operations Engineer

JWP/cm

Enclosures

MARTIN YATES, III
1912 - 1985
FRANK W. YATES
1936 - 1986



105 SOUTH FOURTH STREET
ARTESIA, NEW MEXICO 88210-2118
TELEPHONE (505) 748-1471

S. P. YATES
CHAIRMAN OF THE BOARD
JOHN A. YATES
PRESIDENT
PEYTON YATES
EXECUTIVE VICE PRESIDENT
RANDY G. PATTERSON
SECRETARY
DENNIS G. KINSEY
TREASURER

January 16, 2003

David Catanach
State of New Mexico
OIL CONSERVATION DIVISION
1220 South Saint Francis Drive
Santa Fe, NM 87505

Dear Mr. Catanach,

Yates Petroleum Corporation hereby seeks administrative approval to downhole commingle the production from the Wildcat Wolfcamp and the Pecos Slope Abo Gas pools in our Summers Com (Fee) #2 located in Unit M of Section 25, Township 9 South, Range 24 East, Chaves County.

If you have any questions or need additional information, please call me at (505) 748-4182.

Sincerely,

A handwritten signature in cursive script, reading 'James W. Pringle'. The signature is written in dark ink and is positioned above the typed name and title.

James W. Pringle
Operations Engineer

JWP/em

Enclosures

MARTIN YATES, III
1912 - 1985
FRANK W. YATES
1936 - 1986



105 SOUTH FOURTH STREET
ARTESIA, NEW MEXICO 88210-2118
TELEPHONE (505) 748-1471

S. P. YATES
CHAIRMAN OF THE BOARD
JOHN A. YATES
PRESIDENT
PEYTON YATES
EXECUTIVE VICE PRESIDENT
RANDY G. PATTERSON
SECRETARY
DENNIS G. KINSEY
TREASURER

January 16, 2003

Bureau of Land Management
Armando Lopez
2909 West 2nd Street
Roswell, New Mexico 88201

Dear Mr. Lopez;

Yates Petroleum Corporation hereby seeks administrative approval with the Oil Conservation Division to downhole commingle the production from the Wildcat Wolfcamp and the Pecos Slope Abo Gas pools in our Summers Com (Fee) #2 located in Unit M of Section 25, Township 9 South, Range 24 East, Chaves County.

If you have any questions or need additional information, please call me at (505) 748-4182.

Thank you.

Sincerely,

A handwritten signature in cursive script that reads 'James W. Pringle'.

James W. Pringle
Operations Engineer

JWP/cm

Enclosure

District I
1625 N. French Dr., Hobbs, NM 88240
District II
1301 W. Grand Avenue, Artesia, NM 88210
District III
1000 Rio Brazos Rd., Aztec, NM 87410
District IV
1220 S. St. Francis Dr., Santa Fe, NM 87505

State of New Mexico
Energy, Minerals & Natural Resources Department
OIL CONSERVATION DIVISION
1220 South St. Francis Dr.
Santa Fe, NM 87505

Form C-102
Revised August 15, 2000
Submit to Appropriate District Office
State Lease - 4 Copies
Fee Lease - 3 Copies

☐ AMENDED REPORT

WELL LOCATION AND ACREAGE DEDICATION PLAT

¹ API Number 30-005-63409		² Pool Code		³ Pool Name Pecos Slope Abo	
⁴ Property Code		⁵ Property Name Summers Com (Fee)			⁶ Well Number 2
⁷ OGRID No. 025575		⁸ Operator Name Yates Petroleum Corporation			⁹ Elevation 3563'

¹⁰ Surface Location

UI. or lot no.	Section	Township	Range	Lot Idn	Feet from the	North/South line	Feet from the	East/West line	County
M	25	9S	24E		990	South	660	West	Chaves

¹¹ Bottom Hole Location If Different From Surface

UI. or lot no.	Section	Township	Range	Lot Idn	Feet from the	North/South line	Feet from the	East/West line	County

¹² Dedicated Acres 160	¹³ Joint or Infill	¹⁴ Consolidation Code	¹⁵ Order No.
--------------------------------------	-------------------------------	----------------------------------	-------------------------

NO ALLOWABLE WILL BE ASSIGNED TO THIS COMPLETION UNTIL ALL INTERESTS HAVE BEEN CONSOLIDATED OR A NON-STANDARD UNIT HAS BEEN APPROVED BY THE DIVISION

¹⁶ 				¹⁷ OPERATOR CERTIFICATION <i>I hereby certify that the information contained herein is true and complete to the best of my knowledge and belief.</i> Signature Cherry Matchus Printed Name Engineering Technician Title 01/13/2003 Date
				¹⁸ SURVEYOR CERTIFICATION <i>I hereby certify that the well location shown on this plat was plotted from field notes of actual surveys made by me or under my supervision, and that the same is true and correct to the best of my belief.</i> Date of Survey Signature and Seal of Professional Surveyor: Certificate Number

The Pecos Slope Abo is a new zone and production curves are not available.

District I

1625 N. French Dr., Hobbs, NM 88240

District II

1301 W. Grand Avenue, Artesia, NM 88210

District III

1000 Rio Brazos Rd., Aztec, NM 87410

District IV

1220 S. St. Francis Dr., Santa Fe, NM 87505

State of New Mexico

Energy, Minerals & Natural Resources Department

OIL CONSERVATION DIVISION

1220 South St. Francis Dr.

Santa Fe, NM 87505

Form C-102

Revised August 15, 2000

Submit to Appropriate District Office

State Lease - 4 Copies

Fee Lease - 3 Copies

☐ AMENDED REPORT

WELL LOCATION AND ACREAGE DEDICATION PLAT

¹ API Number 30-005-63409		² Pool Code	³ Pool Name Wildcat Wolfcamp
⁴ Property Code	⁵ Property Name Summers Com (Fee)		⁶ Well Number 2
⁷ OGRID No. 025575	⁸ Operator Name Yates Petroleum Corporation		⁹ Elevation 3563'

¹⁰ Surface Location

UL or lot no. M	Section 25	Township 9S	Range 24E	Lot Idn	Feet from the 990	North/South line South	Feet from the 660'	East/West line West	County Chaves
--------------------	---------------	----------------	--------------	---------	----------------------	---------------------------	-----------------------	------------------------	------------------

¹¹ Bottom Hole Location If Different From Surface

UL or lot no.	Section	Township	Range	Lot Idn	Feet from the	North/South line	Feet from the	East/West line	County
---------------	---------	----------	-------	---------	---------------	------------------	---------------	----------------	--------

¹² Dedicated Acres 320 S/2	¹³ Joint or Infill	¹⁴ Consolidation Code	¹⁵ Order No.
--	-------------------------------	----------------------------------	-------------------------

NO ALLOWABLE WILL BE ASSIGNED TO THIS COMPLETION UNTIL ALL INTERESTS HAVE BEEN CONSOLIDATED OR A NON-STANDARD UNIT HAS BEEN APPROVED BY THE DIVISION

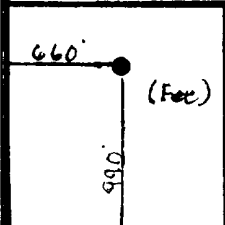
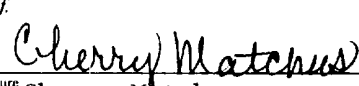
¹⁶ 				¹⁷ OPERATOR CERTIFICATION I hereby certify that the information contained herein is true and complete to the best of my knowledge and belief.  Signature Cherry Matchus Printed Name Engineering Technician Title 01/13/2003 Date
				¹⁸ SURVEYOR CERTIFICATION I hereby certify that the well location shown on this plat was plotted from field notes of actual surveys made by me or under my supervision, and that the same is true and correct to the best of my belief. Date of Survey Signature and Seal of Professional Surveyor: Certificate Number

The Wildcat Wolfcamp is a new zone and production curves are not available.

INTEREST OWNERS

Sensor Oil & Gas Inc.
P.O. Box 1024
Duncan, Ok 73534-1024

John T. Hinkle & Linda J. Hinkle,
Trustees of the Hinkle Living Trust
P.O. Box 1793
Roswell, New Mexico 88202-1793

Bettianne H. Bowen, Trustee
of the Bettianne H. Bowen
Living Trust dated
1902 Ivanhoe Lane
Abilene, Texas 79605

Balwick Limited Partnership,
a Texas limited partnership
P.O. Box 2493
Midland, Texas 79702

John W. Lodewick
3305 Wentwood
Dallas, Texas 75225

Patricia Lodewick a/k/a
Laura Patricia Lodewick
511 Newell
Dallas, Texas 75223

Bonnie H. Morrison
c/o Harry P. Stumpf
11101 Bermuda Dune Drive, NE
Albuquerque, NM 87111-7504

Gerda L. White a/k/a
Gerda White
P.O. Box 1234
Ruidoso, N M 88355

James Lisle Hinkle
P.O. Box 2012
Roswell, NM 88201

Charles E. Hinkle
P.O. Box 1030
King City, Ca 93930

Cynthia Hinkle
Route 3 Box 519
Carmel CA 93923

Jenna Hinkle Santori
212 Skilling Ct.
Cotati CA 94931-5377

Kristen Hinkle
20806 NE 206 Place
Sammamish, WA 98074-6348

Shirley Childress
604 N. Delaware Ave #2
Roswell, NM 88201-2135

Richard Franklin Halter
233 E. Terra Alta
San Antonio, Texas 78209

Jack Chandler Halter
400 Quail Creek Drive
Lufkin, Texas 75901

Grant Weidman Halter
3604 Del Sur
Baytown, Texas 77521

James W. Childress
P.O. Box 3209
Roswell, NM 88202-3209

Richard H. Landsheft, Jr.
2313 Jim Dent
El Paso, Texas 79936

William Brian Landsheft, Trustee
Of the William Brian Landsheft
Revocable Trust
15880 south Peoria
Bixby, OK 74008-4221

Lynn E. Desper
50 Conowado Rd
Connales, NM 87048