

DISTRICT I
1625 N. French Dr., Hobbs, NM 88240

DISTRICT II
1301 W. Grand Avenue, Artesia, NM 88210

DISTRICT III
1000 Rio Brazos Rd., Aztec, NM 87410

DISTRICT IV
1220 S. St. Francis Dr., Santa Fe, NM 87505

State of New Mexico
/, Minerals, and Natural Resources De
at
OIL CONSERVATION DIVISION
1220 South St. Francis Dr.
Santa Fe, New Mexico 87505

Revised August 15, 2000
Submit to Appropriate District Office
State Lease - 4 copies
Fee Lease - 3 copies

☐ AMENDED REPORT

WELL LOCATION AND ACREAGE DEDICATION PLAT

¹ API Number		² Pool Code		³ Pool Name	
⁴ Property Code		⁵ Property Name WILLOW SPRINGS "32" STATE			⁶ Well Number 6
⁷ OGRID No.		⁸ Operator Name RELiance ENERGY, INC.			⁹ Elevation 3865'

¹⁰ Surface Location									
UL or lot no. F	Section 32	Township 4 SOUTH	Range 25 EAST, N.M.P.M.	Lot Idn	Feet from the 1980'	North/South line NORTH	Feet from the 1980'	East/West line WEST	County CHAVES

¹¹ Bottom Hole Location If Different From Surface									
UL or lot no.	Section	Township	Range	Lot Idn	Feet from the	North/South line	Feet from the	East/West line	County
¹² Dedicated Acres 320		¹³ Joint or Infill		¹⁴ Consolidation Code		¹⁵ Order No.			

NO ALLOWABLE WELL BE ASSIGNED TO THIS COMPLETION UNTIL ALL INTERESTS HAVE BEEN CONSOLIDATED OR A NON-STANDARD UNIT HAS BEEN APPROVED BY THE DIVISION

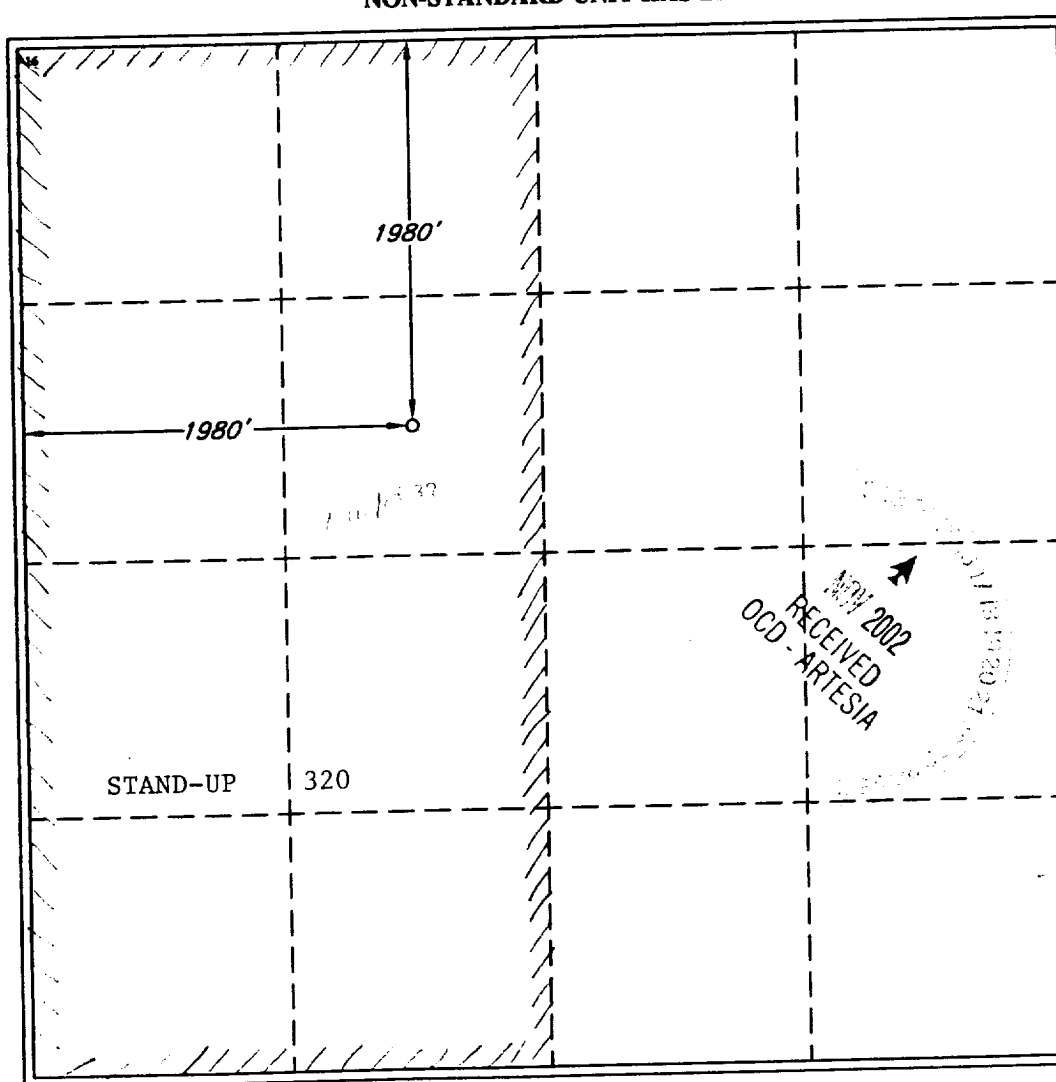

" OPERATOR CERTIFICATION

I hereby certify that the information contained herein is true and complete to the best of my knowledge and belief.

[Signature]
Signature

James R. Berryman

Printed Name

Operations Manager

Title

11-13-02

Date

" SURVEYOR CERTIFICATION

I hereby certify that the well location shown on this plat was plotted from field notes of actual surveys made by me or under my supervision, and that the same is true and correct to the best of my belief.

NOVEMBER 11, 2002

Date of Survey

Signature and Seal of Professional Surveyor

[Signature]
Signature and Seal of Professional Surveyor

V. L. BEZNER

R.P.S. #7920

JOB #84466 / 197 NE / J.C.P.