

NO. OF COPIES RECEIVED	
DISTRIBUTION	
ANALYSIS	1
FILE	1
U.S.G.S.	2
LAND OFFICE	1
OPERATOR	1

NEW MEXICO OIL CONSERVATION COMMISSION

30-011-20019

Form C-101
Revised 1-1-65

SEP 28 1980

O.C.C.
ARTESIAN OFFICE

5A. Indicate Type of Lease STATE <input checked="" type="checkbox"/> FEE <input type="checkbox"/>
5. State Oil & Gas Lease No. L-5070
7. Unit Agreement Name
8. Farm or Lease Name Boldernhel
9. Well No. 1
10. Field and Pool, or Wildcat Wildcat
17. County De Baca
19. Proposed Depth 4800
19A. Formation Abo
20. Rotary or C.T. Rotary
21. Elevations (Show whether DF, RT, etc.) 3805 G.L.
21A. Kind & Status Plug. Bond Statewide
21B. Drilling Contractor BAM Drilling Corp.
22. Approx. Date Work will start 10/20/80

APPLICATION FOR PERMIT TO DRILL, DEEPEN, OR PLUG BACK

1a. Type of Work b. Type of Well OIL WELL <input checked="" type="checkbox"/> GAS WELL <input type="checkbox"/> OTHER <input type="checkbox"/> DEEPEN <input type="checkbox"/> PLUG BACK <input type="checkbox"/> SINGLE ZONE <input checked="" type="checkbox"/> MULTIPLE ZONE <input type="checkbox"/>	2. Name of Operator McClellan Oil Corporation	3. Address of Operator Post Office Drawer 730, Roswell, New Mexico 88201	4. Location of Well UNIT LETTER D LOCATED 660 FEET FROM THE North LINE AND 660 FEET FROM THE West LINE OF SEC. 36 TWP. 3-S RGE. 26-E NMPM
23.			

PROPOSED CASING AND CEMENT PROGRAM

SIZE OF HOLE	SIZE OF CASING	WEIGHT PER FOOT	SETTING DEPTH	SACKS OF CEMENT	EST. TOP
17"	13-3/8"	48 lb.	40	6 yds ready mix	Surface
11"	8-5/8"	20 lb.	1200	400 sx	Circ.
7-7/8"	4-1/2"	10-1/2 lb.	4800	300 sx	4000'

Propose to drill to approximately 4800' to test the Abo formation. If production is indicated, will run casing and attempt completion. A diagrammatic sketch and description of blow-out preventer is attached. Any hydrocarbons produced from this test are not dedicated.

Est. Tops S.A. 1000
Tubb 3600
Abo 4250

APPROVAL VALID
FOR 90 DAYS UNLESS
DRILLING COMMENCED,

EXPIRES 1-2-81

IN ABOVE SPACE DESCRIBE PROPOSED PROGRAM: IF PROPOSAL IS TO DEEPEN OR PLUG BACK, GIVE DATA ON PRESENT PRODUCTIVE ZONE AND PROPOSED NEW PRODUCTIVE ZONE. GIVE BLOWOUT PREVENTER PROGRAM, IF ANY.

I hereby certify that the information above is true and complete to the best of my knowledge and belief.

Signed J. M. McClellan Title Operator Date 9/25/80

(This space for State Use)

APPROVED BY W. A. Gresser TITLE SUPERVISOR, DISTRICT II DATE OCT 7 1980

CONDITIONS OF APPROVAL, IF ANY:

Class C Cement must be circulated to surface behind 8 7/8" casing

WELL LOCATION AND ACREAGE DEDICATION PLAT

Supersides C-128
Effective 1-1-65

All distances must be from the outer boundaries of the Section.

Operator McClellan Oil Corp.		Lease Boldernhel		Well No. 1
Unit Letter	Section 36	Township 3 South	Range 26 East	County De Baca
Actual Footage Location of Well: 660 feet from the North line and 660 feet from the West line				
Ground Level Elev. 3805.2	Producing Formation Abo	Pool Wildcat	Dedicated Acreage: 160 Acres	

1. Outline the acreage dedicated to the subject well by colored pencil or hatchure marks on the plat below.
2. If more than one lease is dedicated to the well, outline each and identify the ownership thereof (both as to working interest and royalty).
3. If more than one lease of different ownership is dedicated to the well, have the interests of all owners been consolidated by communitization, unitization, force-pooling, etc?

☐ Yes ☐ No If answer is "yes," type of consolidation _____

If answer is "no," list the owners and tract descriptions which have actually been consolidated. (Use reverse side of this form if necessary.) _____

No allowable will be assigned to the well until all interests have been consolidated (by communitization, unitization, forced-pooling, or otherwise) or until a non-standard unit, eliminating such interests, has been approved by the Commission.

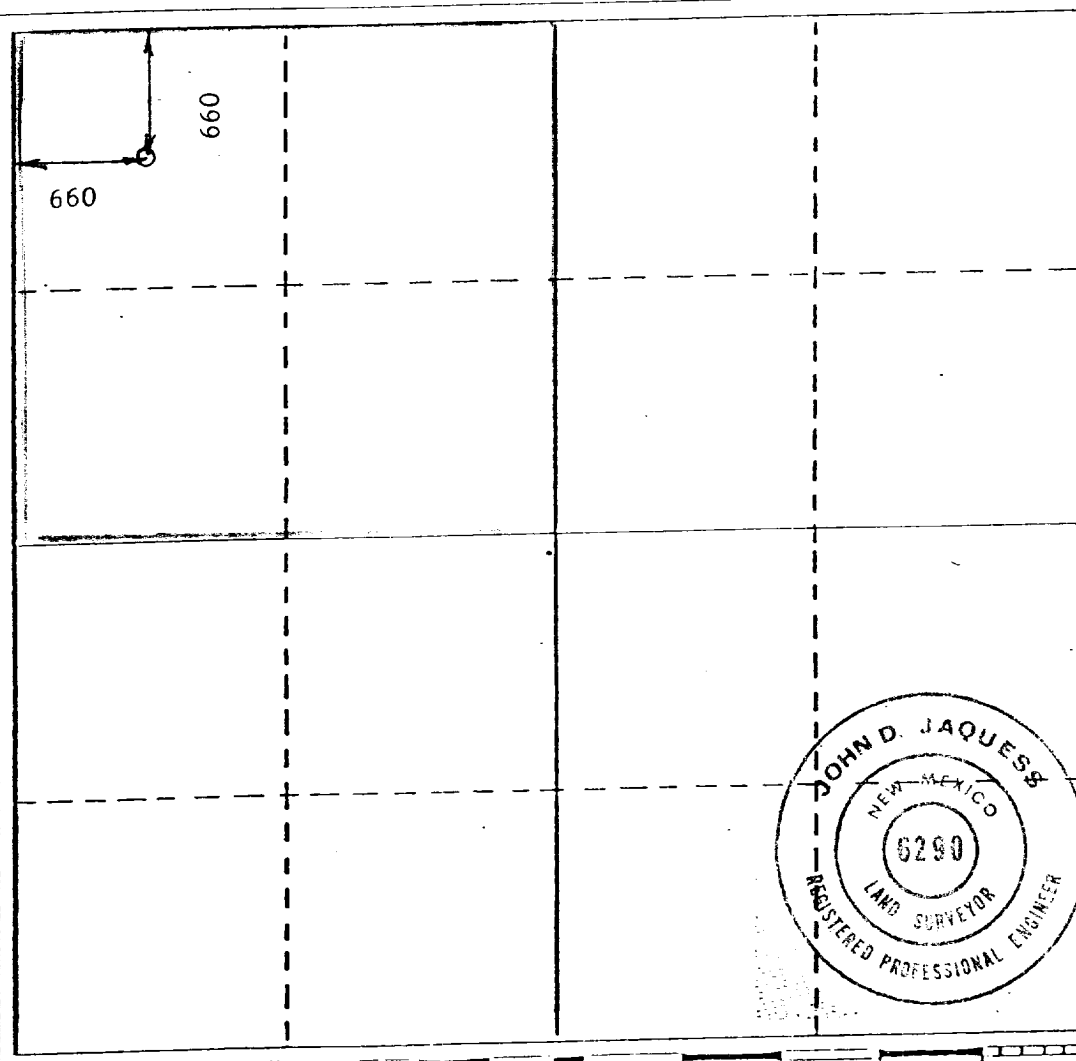

CERTIFICATION

I hereby certify that the information contained herein is true and complete to the best of my knowledge and belief.

Name
Jack L. McClellan

Position
President

Company
McClellan Oil Corporation

Date
Sept. 20, 1980

I hereby certify that the well location shown on this plat was plotted from field notes of actual surveys made by me or under my supervision, and that the same is true and correct to the best of my knowledge and belief.

Date Surveyed
Sept. 20, 1980

Registered Professional Engineer and/or Land Surveyor

John D. Jaquess, P.E.

Certificate No. **6290**

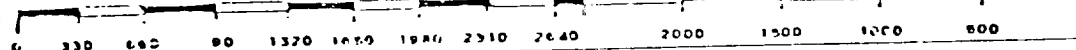

BAM Drilling Corporation
Blowout Preventer Specifications

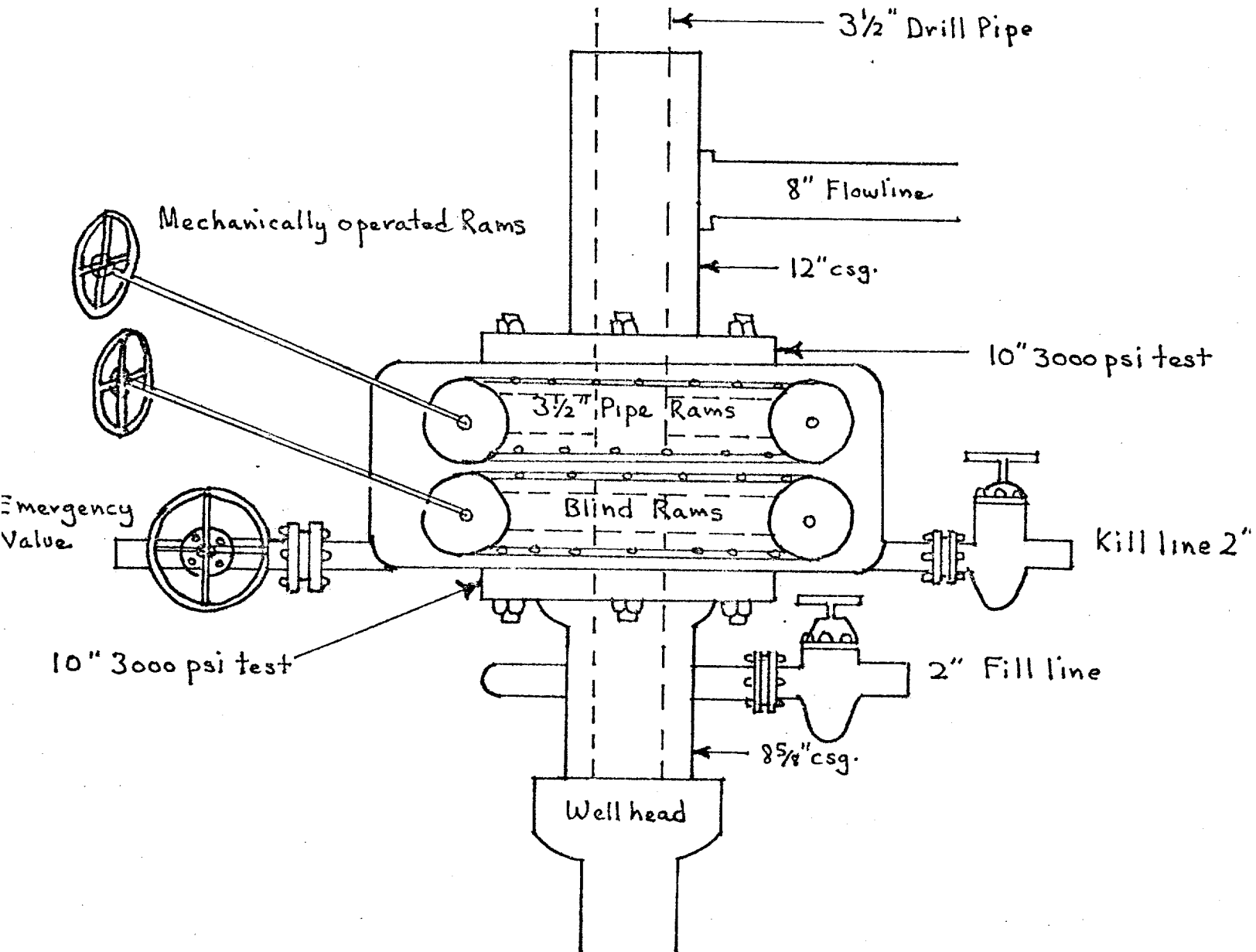

BOP's are Shaffer Double Rams Series 900, 10 inch. mechanically operated. Rated to 3000 psi. Rams consist of one 3 1/2 inch pipe rams and one blind rams. All connections and valves are 3000 psi working pressure.