

NO. OF COPIES RECEIVED	
DISTRIBUTION	
SANTA FE	1
FILE	1
U.S.G.S.	2
LAND OFFICE	
OPERATOR	

NEW MEXICO OIL CONSERVATION COMMISSION

SEP 3 1981

O. C. D.
MESA, OREGON

30-001-20025
Form C-101
Revised 1-4-65

5A. Indicate Type of Lease
STATE <input checked="" type="checkbox"/> FEE <input type="checkbox"/>
5. State Oil & Gas Lease No.
IC-747

APPLICATION FOR PERMIT TO DRILL, DEEPEN, OR PLUG BACK

1a. Type of Work	DRILL <input checked="" type="checkbox"/> DEEPEN <input type="checkbox"/> PLUG BACK <input type="checkbox"/>
b. Type of Well	OIL WELL <input type="checkbox"/> GAS WELL <input checked="" type="checkbox"/> OTHER <input type="checkbox"/> SINGLE ZONE <input checked="" type="checkbox"/> MULTIPLE ZONE <input type="checkbox"/>
2. Name of Operator	Flag-Redfern Oil Company
3. Address of Operator	P.O. Box 2280 Midland, Texas 79702
4. Location of Well	UNIT LETTER P LOCATED 660 FEET FROM THE South LINE AND 660 FEET FROM THE East LINE OF SEC. 17 TWP. 1-S RGE. 25-E NMPM
12. County	DeBaca
19. Proposed Depth	4500
19A. Formation	Abo
20. Rotary or C.T.	Rotary
21. Elevations (Show whether DT, RT, etc.)	4011.7 GR
21A. Kind & Status Plug. Bond	Blanket
21B. Drilling Contractor	WEK Drilling Company
22. Approx. Date Work will start	Sept. 28, 1981

7. Unit Agreement Name
8. Farm or Lease Name
State "17"
9. Well No.
1
10. Field and Pool, or Wildcat
Wildcat
12. County
DeBaca
19. Proposed Depth
4500
19A. Formation
Abo
20. Rotary or C.T.
Rotary
21. Elevations (Show whether DT, RT, etc.)
4011.7 GR
21A. Kind & Status Plug. Bond
Blanket
21B. Drilling Contractor
WEK Drilling Company
22. Approx. Date Work will start
Sept. 28, 1981

23. PROPOSED CASING AND CEMENT PROGRAM

SIZE OF HOLE	SIZE OF CASING	WEIGHT PER FOOT	SETTING DEPTH	SACKS OF CEMENT	EST. TOP
17-1/2"	13-3/8"	48	350	425	Surface
12-1/4"	8-5/8"	24	1400	1100	Surface
7-7/8"	4-1/2"	10.5	4500	400	3000

Drill 17-1/2" hole to approximately 350'. Run 13-3/8" casing and set at 350'. Circulate cement w/425 sx. Cl "C" w/2% CaCl. Drill 12-1/4" hole to approximately 1400'. Run 8-5/8" casing and circulate cement w/600 sx. Halliburton Light containing 1/2 lb. flocele + 4% CaCl and 200 sx. Cl "C" thixset w/4% Ca Cl followed by 300 sx. of Cl "C" w/4% CaCl. Drill 7-7/8" hole to approximately 4500'. Run open hole log. Run 4-1/2" casing and cement w/400 sx. 50-50 Poz/Cl "C" w/.3% CFR-2 and 6 lb./sx. salt. Run correlation log and perforate the Abo formation. Treat w/acid and swab test. Frac w/gelled water and sand if necessary. Potential well.

Mud Program	Estimated Tops
0-1400' Native mud	San Andres 590'
1400-4500' Native mud & Oil	Glorieta 1430'
	Drinkard 2900'
	Abo 3405'
	Hueco 4188'

Blowout Preventors - Cameron 10" Series 900 installed on 8-5/8" casing.
gas is not dedicated
APPROVAL VALID FOR 180 DAYS
PERMIT EXPIRES 3-10-82
UNLESS DRILLING UNDERWAY

IN ABOVE SPACE DESCRIBE PROPOSED PROGRAM: IF PROPOSAL IS TO DEEPEN OR PLUG BACK, GIVE DATA ON PRESENT PRODUCTIVE ZONE AND PROPOSED NEW PRODUCTIVE ZONE. GIVE BLOWOUT PREVENTER PROGRAM, IF ANY.

I hereby certify that the information above is true and complete to the best of my knowledge and belief.

Signed *J. C. Kerner* Title Engineer Date Sept. 2, 1981

(This space for State Use)

APPROVED BY *W. A. Gussitt* TITLE SUPERVISOR, DISTRICT II DATE SEP 10 1981

CONDITIONS OF APPROVAL, IF ANY:

N MEXICO OIL CONSERVATION COMMISS
WELL LOCATION AND ACREAGE DEDICATION PLAT

Form C-102
 Supersedes C-128
 Effective 1-1-65

All distances must be from the outer boundaries of the Section.

Operator FLAG-REDFERN OIL CO.			Lease STATE 17		Well No. 1
Unit Letter P	Section 17	Township 1 SOUTH	Range 25 EAST	County DE BACA	
Actual Footage Location of Well: 660 feet from the EAST line and 660 feet from the SOUTH line					
Ground Level Elev. 4011.7	Producing Formation Abo		Pool Wildcat	Dedicated Acreage: 160.40 Acres	

1. Outline the acreage dedicated to the subject well by colored pencil or hatchure marks on the plat below.
2. If more than one lease is dedicated to the well, outline each and identify the ownership thereof (both as to working interest and royalty).
3. If more than one lease of different ownership is dedicated to the well, have the interests of all owners been consolidated by communitization, unitization, force-pooling, etc?

☐ Yes ☐ No If answer is "yes," type of consolidation _____

If answer is "no," list the owners and tract descriptions which have actually been consolidated. (Use reverse side of this form if necessary.) _____

No allowable will be assigned to the well until all interests have been consolidated (by communitization, unitization, forced-pooling, or otherwise) or until a non-standard unit, eliminating such interests, has been approved by the Commission.

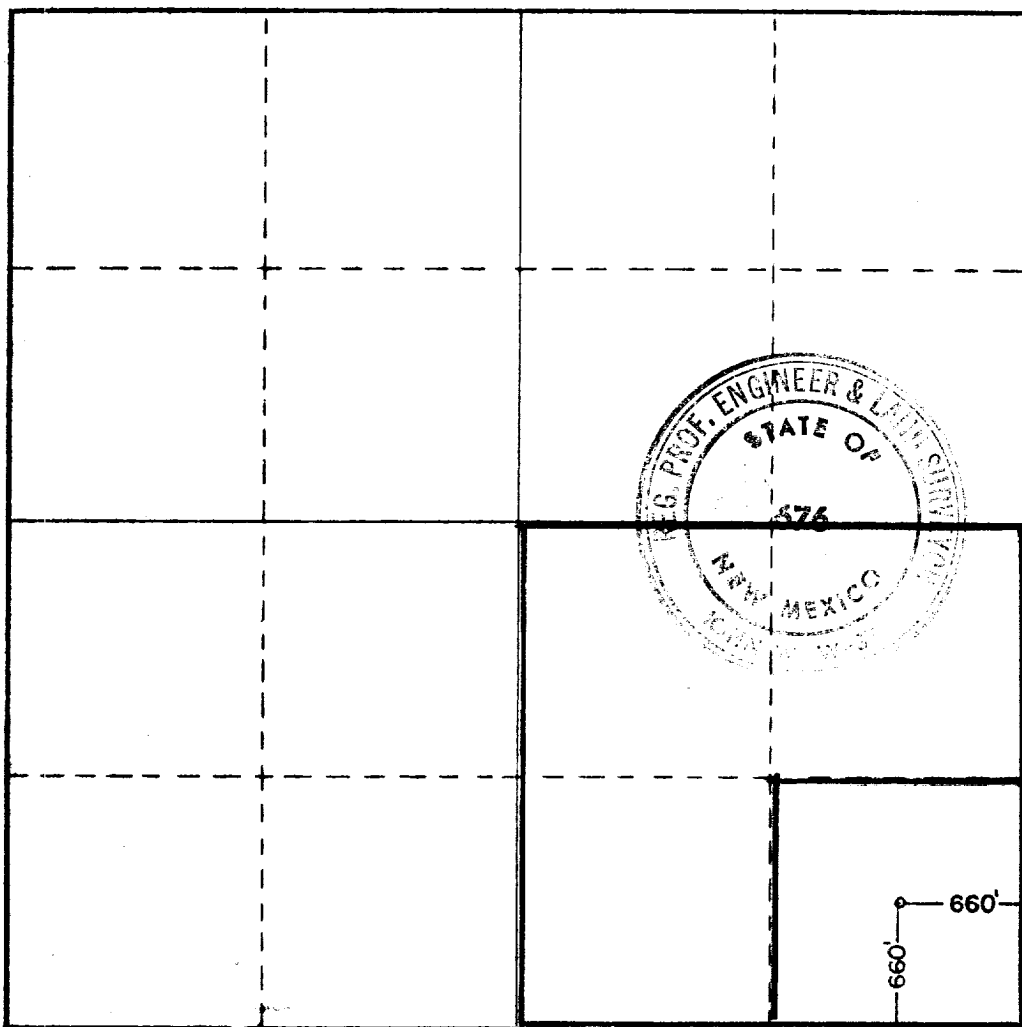

CERTIFICATION

I hereby certify that the information contained herein is true and complete to the best of my knowledge and belief.

Name *J.C. Scherer*
 Position **Engineer**
 Company **Flag-Redfern Oil Company**
 Date **September 2, 1981**

I hereby certify that the well location shown on this plat was plotted from field notes of actual surveys made by me or under my supervision, and that the same is true and correct to the best of my knowledge and belief.

Date Surveyed **8-28-81**
 Registered Professional Engineer and/or Land Surveyor

Schm W
 Certificate No. **JOHN W. WEST 576**
PATRICK A. ROMERO 6663
Ronald J. Eldon 3239

0 330 660 990 1320 1650 1980 2310 2640 2970 3300 3630 3960 4290 4620 4950 5280 5610 5940 6270 6600