

OCT 29 1981

O. C. D.  
ARTESIA, OFFICE

30-011-20027

Form C-101  
Revised 10-1-78

NO. OF COPIES RECEIVED	
DISTRIBUTION	
SANTA FE	1
FILE	1
U.S.G.S.	1
LAND OFFICE	1
OPERATOR	1

5A. Indicate Type of Lease STATE <input checked="" type="checkbox"/> FEDERAL <input type="checkbox"/>
5. State Oil & Gas Lease No. LH-75
7. Unit Agreement Name
8. Farm or Lease Name RIDGE STATE
9. Well No. 1
10. Field and Pool, or Wildcat WILDCAT PENN
12. County DEBACA

APPLICATION FOR PERMIT TO DRILL, DEEPEN, OR PLUG BACK

a. Type of Work

b. Type of Well DRILL ☒ DEEPEN ☐ PLUG BACK ☐

OIL WELL ☐ GAS WELL ☒ OTHER ☐ SINGLE ZONE ☒ MULTIPLE ZONE ☐

Name of Operator  
MESA PETROLEUM CO

Address of Operator  
1000 VAUGHN BUILDING/MIDLAND, TEXAS 79701-4493

Location of Well UNIT LETTER E LOCATED 1650 FEET FROM THE NORTH LINE

ND 660 FEET FROM THE WEST LINE OF SEC. 24 TWP. 1N RGE. 20E

19. Proposed Depth 3700'  
19A. Formation PENN  
20. Rotary or C.T. ROTARY

1. Elevations (Show whether DF, RT, etc.) 5015.3' GR  
21A. Kind & Status Plug. Bond BLANKET  
21B. Drilling Contractor TOM BROWN  
22. Approx. Date Work will start NOVEMBER 9, 1981

PROPOSED CASING AND CEMENT PROGRAM

SIZE OF HOLE	SIZE OF CASING	WEIGHT PER FOOT	SETTING DEPTH	SACKS OF CEMENT	EST. TOP
12 1/4"	8 5/8"	24#	1400'	300/300/300	SURFACE
7 7/8"	4 1/2"	10.5#	3700'	500/500	ISOLATE WTR, O&G

Propose to drill 12 1/4" hole to approximately 1400' more or less and set 8 5/8" surface casing and cement to surface. Will reduce hole to 7 7/8", nipple up RAM type BOPs and drill to total depth. Drilling medium will be air, foam, or mud as required.

Gas Sales are dedicated.

APPROVAL VALID FOR 180 DAYS  
PERMIT EXPIRES 5-2-82  
UNLESS DRILLING UNDERWAY

Posted ID-1  
API + NL Book  
11-6-81

XC: NMOCD (6), TLS, CEN RCDS, ACCTG, ROSWELL, MEC, LAND, PARTNERS, FILE, REM  
ABOVE SPACE DESCRIBE PROPOSED PROGRAM: IF PROPOSAL IS TO DEEPEN OR PLUG BACK, GIVE DATA ON PRESENT PRODUCTIVE ZONE AND PROPOSED NEW PRODU-  
C ZONE. GIVE BLOWOUT PREVENTER PROGRAM, IF ANY.

I hereby certify that the information above is true and complete to the best of my knowledge and belief.

Signed R. E. Mathis Title REGULATORY COORDINATOR Date 10-27-81

(This space for State Use)

APPROVED BY W. A. Gressitt TITLE DATE NOV 02 1981

CONDITIONS OF APPROVAL, IF ANY:

**N. MEXICO OIL CONSERVATION COMMISS**  
**WELL LOCATION AND ACREAGE DEDICATION PLAT**

Form C-102  
 Supersedes C-128  
 Effective 1-1-65

All distances must be from the outer boundaries of the Section.

Operator <b>Mesa Petroleum Company</b>			Lease <b>Ridge State</b>			Well No. <b>1</b>		
Unit Letter <b>E</b>	Section <b>24</b>	Township <b>1 North</b>	Range <b>20 East</b>	County <b>DeBaca</b>				
Actual Footage Location of Well: <b>1650</b> feet from the <b>north</b> line and <b>660</b> feet from the <b>west</b> line								
Ground Level Elev. <b>5015.3'</b>		Producing Formation <b>PENN</b>		Pool <b>WILDCAT PENN</b>			Dedicated Acreage: <b>40</b> Acres	

1. Outline the acreage dedicated to the subject well by colored pencil or hachure marks on the plat below.
2. If more than one lease is dedicated to the well, outline each and identify the ownership thereof (both as to working interest and royalty).
3. If more than one lease of different ownership is dedicated to the well, have the interests of all owners been consolidated by communitization, unitization, force-pooling, etc?

☐ Yes    ☐ No    If answer is "yes," type of consolidation \_\_\_\_\_

If answer is "no," list the owners and tract descriptions which have actually been consolidated. (Use reverse side of this form if necessary.) \_\_\_\_\_

No allowable will be assigned to the well until all interests have been consolidated (by communitization, unitization, forced-pooling, or otherwise) or until a non-standard unit, eliminating such interests, has been approved by the Commission.

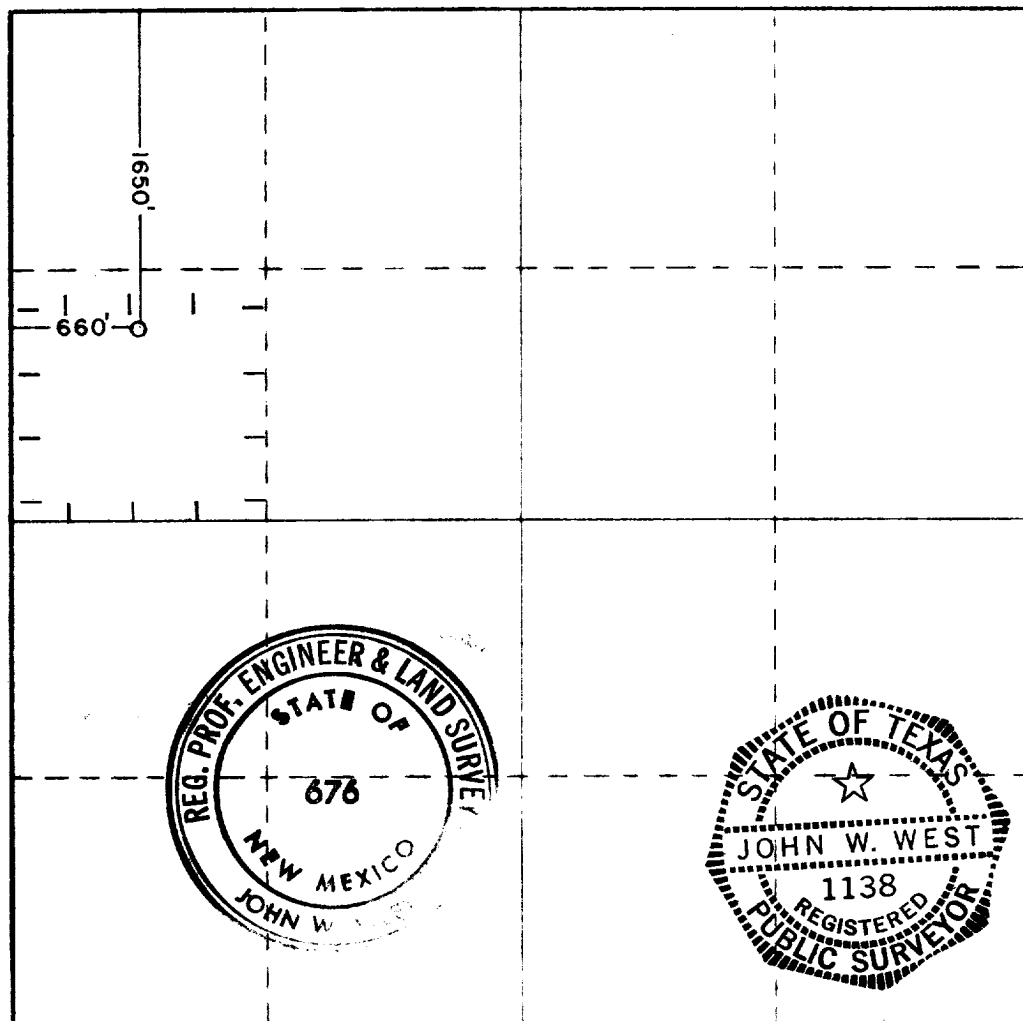

**CERTIFICATION**

I hereby certify that the information contained herein is true and complete to the best of my knowledge and belief.

*R. E. Mathis*

Name <b>R. E. MATHIS.</b>
Position <b>REGULATORY COORDINATOR</b>
Company <b>MESA PETROLEUM CO.</b>
Date <b>10-27-81</b>

I hereby certify that the well location shown on this plat was plotted from field notes of actual surveys made by me or under my supervision, and that the same is true and correct to the best of my knowledge and belief.

Date Surveyed <b>10-17-81</b>
Registered Professional Engineer and/or Land Surveyor <i>John W. West</i> <b>JOHN W. WEST</b> <b>PATRICK A. RAY</b>