

STATE OF NEW MEXICO  
ENERGY AND MINERALS DEPARTMENT

LC OIL CONSERVATION DIVISION  
P. O. BOX 2088  
SANTA FE, NEW MEXICO 87501

Form C-101  
Revised 10-1-78

NO. OF COPIES RECEIVED	5
DISTRIBUTION	
SANTA FE	1
FILE	1
U.S.G.S.	2
LAND OFFICE	
OPERATOR	1

MAY - 6, 1982

O. C. D.  
ARTESIA, OFFICE

5A. Indicate Type of Lease  
STATE ☐ FEDERAL ☒

5. State Oil & Gas Lease No.

APPLICATION FOR PERMIT TO DRILL, DEEPEN, OR PLUG BACK

1a. Type of Work DRILL <input checked="" type="checkbox"/> DEEPEN <input type="checkbox"/> PLUG BACK <input type="checkbox"/>		7. Unit Agreement Name	
b. Type of Well OIL WELL <input checked="" type="checkbox"/> GAS WELL <input type="checkbox"/> OTHER <input type="checkbox"/> SINGLE ZONE <input checked="" type="checkbox"/> MULTIPLE ZONE <input type="checkbox"/>		8. Farm or Lease Name Whites Valley	
2. Name of Operator Triple "L" Petroleum Incorporation		9. Well No. 1	
3. Address of Operator Route 3, Box 329 Big Spring, Texas 79720		10. Field and Pool, or Wildcat Wildcat San Andres	
4. Location of Well UNIT LETTER D LOCATED 660 FEET FROM THE North LINE AND 660 FEET FROM THE WEST LINE OF SEC. 9 TWP. 1 South 22E NMPM		12. County DeBaca	
19. Proposed Depth 1500'		19A. Formation San Andres	20. Rotary or C.T. Cable tool
21. Elevations (Show whether D.F., K.I., etc.) 4432' G.L.	21A. Kind & Status Plug. Bond Single Well Bond	21B. Drilling Contractor Howell	22. Approx. Date Work will start May 24, 1982

23. PROPOSED CASING AND CEMENT PROGRAM

SIZE OF HOLE	SIZE OF CASING	WEIGHT PER FOOT	SETTING DEPTH	SACKS OF CEMENT	EST. TOP
12-1/2"	10-3/4'	40	100'+	40 sx CL "C"	see below
10"	8-5/8'	20	400'+	150 sx CL "C"	Circulated
7"	4-1/2'	9.5	1500'+		Circulated

Cable tool control valve will be used during drilling operations and tested to 1000'. A 12 1/2" hole will be drilled 100'. If no water is incurred, drilling bit will be changed to 10" and drilling will proceed another 300'. If water is incurred during first 100', hole will be reamed out and 10-3/4" casing installed and cement will be circulated to top of surface, or cement slurry poured side of pipe, depending on volume of water. If no water is incurred first 100', 10" hole will be drilled for another 300'. 8-5/8" casing will be installed to total depth of 400', and cement circulated to surface.

A 7" hole will be drilled to a total maximum depth of 1500'. If commercial well can be made, 4-1/2" casing will be installed and cement circulated. All cement work will be tested according to New Mexico Oil Conservation Specification.

APPROVAL VALID FOR 180 DAYS  
PERMIT EXPIRES 11-14-82  
UNLESS DRILLING UNDERWAY

IN ABOVE SPACE DESCRIBE PROPOSED PROGRAM: IF PROPOSAL IS TO DEEPEN OR PLUG BACK, GIVE DATA ON PRESENT PRODUCTIVE ZONE AND PROPOSED NEW PRODUCTIVE ZONE, GIVE BLOWOUT PREVENTER PROGRAM, IF ANY.

I hereby certify that the information above is true and complete to the best of my knowledge and belief.

Signed Jeffrey L. Jones Title Secretary-Treasurer Date 4/30/82  
(This space for State Use)

APPROVED BY M. H. Walker TITLE OIL AND GAS INSPECTOR DATE MAY 14, 1982  
CONDITIONS OF APPROVAL, IF ANY:

Revised  
API & B  
5-14-82

All distances must be from the outer boundaries of the Section.

Operator Triple L Petroleum Incorporation		Lease White's Valley		Well No. #1
Unit Letter D	Section 9	Township 1 South	Range 22 East	County De Baca
Actual Postage Location of Well:				
660 feet from the North		line and 660 feet from the West		line
Ground Level Elev. 4432	Producing Formation San Andres	Pool Wildcat	Dedicated Acreage: 40 Acres	

1. Outline the acreage dedicated to the subject well by colored pencil or hatchure marks on the plat below.

2. If more than one lease is dedicated to the well, outline each and identify the ownership thereof (both as to working interest and royalty).

3. If more than one lease of different ownership is dedicated to the well, have the interests of all owners been consolidated by communitization, unitization, force-pooling, etc?

☐ Yes ☒ No If answer is "yes," type of consolidation \_\_\_\_\_

If answer is "no," list the owners and tract descriptions which have actually been consolidated. (Use reverse side of this form if necessary.) \_\_\_\_\_

No allowable will be assigned to the well until all interests have been consolidated (by communitization, unitization, forced-pooling, or otherwise) or until a non-standard unit, eliminating such interests, has been approved by the Division.

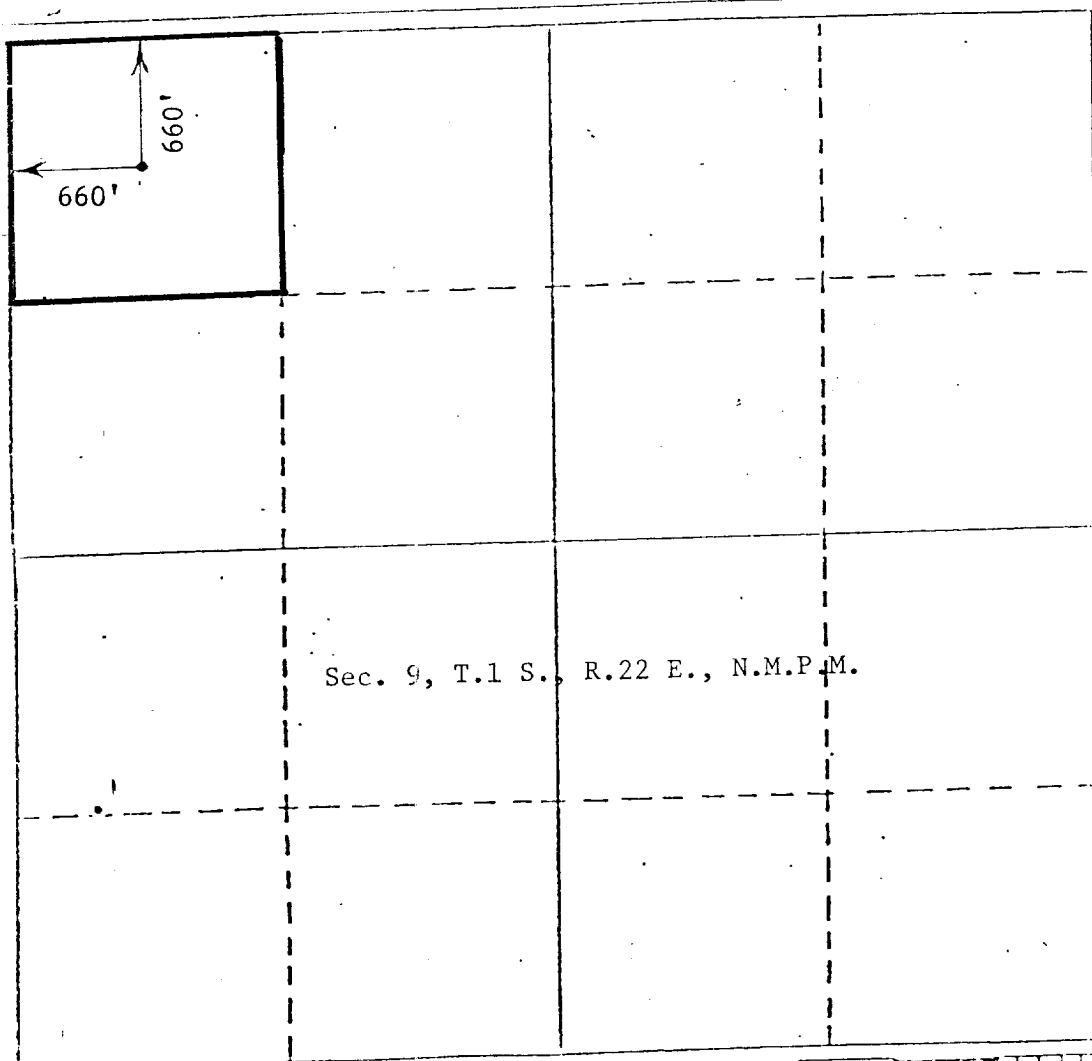

# CERTIFICATION

I hereby certify that the information contained herein is true and complete to the best of my knowledge and belief.

Name Jeffery L. Jones  
Jeffery L. Jones

Position  
Secretary-Treasurer

Company  
Tripele "L" Petroleum, Inc.

Date  
4/30/82

I hereby certify that the well location shown on this plat was plotted from field notes of actual surveys made by me or under my supervision, and that the same is true and correct to the best of my knowledge and belief.

Date Surveyed April 1, 1982  
Registered Professional Engineer  
and/or Land Surveyor  
John D. Jaquess  
John D. Jaquess, P.E. & L.S.  
Certificate No. 6290

