

UNITED STATES
DEPARTMENT OF THE INTERIOR
GEOLOGICAL SURVEYSUBMIT IN T ICATE*
(Other instructions on
reverse side)Form approved.
Budget Bureau No. 42-R1425.

APPLICATION FOR PERMIT TO DRILL, DEEPEN, OR PLUG BACK

1a. TYPE OF WORK

DRILL ☒DEEPEN ☐PLUG BACK ☐

b. TYPE OF WELL

OIL
WELL ☒GAS
WELL ☐

OTHER

SINGLE
ZONEMULTIPLE
ZONE ☐

2. NAME OF OPERATOR

Yates Petroleum Corporation

3. ADDRESS OF OPERATOR

207 S. 4th, Artesia, New Mexico 88210

4. LOCATION OF WELL (Report location clearly and in accordance with any State requirements)

At surface

990' FSL and 990' FWL

At proposed prod. zone
same

14. DISTANCE IN MILES AND DIRECTION FROM NEAREST TOWN OR POST OFFICE*

Approximately 60 miles NE of Roswell, New Mexico.

15. DISTANCE FROM PROPOSED*

LOCATION TO NEAREST
PROPERTY OR LEASE LINE, FT.

(Also to nearest drlg. unit line, if any) 990'

18. DISTANCE FROM PROPOSED LOCATION*

TO NEAREST WELL, DRILLING COMPLETED,
OR APPLIED FOR, ON THIS LEASE, FT.

16. NO. OF ACRES IN LEASE

640

19. PROPOSED DEPTH

1675'

17. NO. OF ACRES ASSIGNED
TO THIS WELL

40

20. ROTARY OR CABLE TOOLS

Rotary

22. APPROX. DATE WORK WILL START*

ASAP

23.

PROPOSED CASING AND CEMENTING PROGRAM

SIZE OF HOLE	SIZE OF CASING	WEIGHT PER FOOT	SETTING DEPTH	QUANTITY OF CEMENT
12 1/4"	8 5/8"	24# J-55	850'	900 sx circulated
7 7/8"	4 1/2"	9.5# J-55	TD	350 sx

We propose to drill and test the San Andres and intermediate formations. Approximately 850' of surface casing will be set and cement circulated to shut off gravel and caving. If needed (lost circulation) no intermediate casing will be run. If commercial, production casing will be run and cemented with adequate cover, perforated and stimulated as needed for production.

MUD PROGRAM: FW gel/LCM to TD.

BOP PROGRAM: BOP's will be installed at the offset and tested daily.

IN ABOVE SPACE DESCRIBE PROPOSED PROGRAM: If proposal is to deepen or plug back, give data on present productive zone and proposed new productive zone. If proposal is to drill or deepen directionally, give pertinent data on subsurface locations and measured and true vertical depths. Give blowout preventer program, if any.

24.

SIGNED

TITLE Regulatory Coordinator

DATE 12/9/82

(This space for Federal or State office use)

PERMIT NO.

APPROVED
(ORIG. SGD.) DAVID R. GLASS

APPROVAL DATE

APPROVED BY

CONDITIONS OF APPROVAL

DEC 20 1982

JAMES A. GILLHAM
DISTRICT SUPERVISORRECEIVED
DEC 16 1982OIL & GAS
U.S. GEOLOGICAL SURVEY
ROSWELL, NEW MEXICO

Posted R.P.G.
12-31-82

NEW MEXICO OIL CONSERVATION COMMISSION
WELL LOCATION AND ACREAGE DEDICATION PLAT

Form C-102
Supersedes C-128
Effective 1-1-65

All distances must be from the outer boundaries of the Section

Operator YATES PETROLEUM CORPORATION		Lease Big Bend "WJ" Federal		Well No. 1
Unit Letter M	Section 35	Township 3 South	Range 25 East	County De Baca
Actual Footage Location of Well: 990 feet from the South line and 990 feet from the West line				
Ground Level Elev. 3798.9'	Producing Formation SAN ANDRES	Pool Wildcat	Dedicated Acreage: 40 Acres	

1. Outline the acreage dedicated to the subject well by colored pencil or hatchure marks on the plat below.
2. If more than one lease is dedicated to the well, outline each and identify the ownership thereof (both as to working interest and royalty).
3. If more than one lease of different ownership is dedicated to the well, have the interests of all owners been consolidated by communitization, unitization, force-pooling, etc?

☐ Yes ☒ No If answer is "yes," type of consolidation _____

If answer is "no," list the owners and tract descriptions which have actually been consolidated. (Use reverse side of this form if necessary.) _____

No allowable will be assigned to the well until all interests have been consolidated (by communitization, unitization, forced-pooling, or otherwise) or until a non-standard unit, eliminating such interests, has been approved by the Commission.

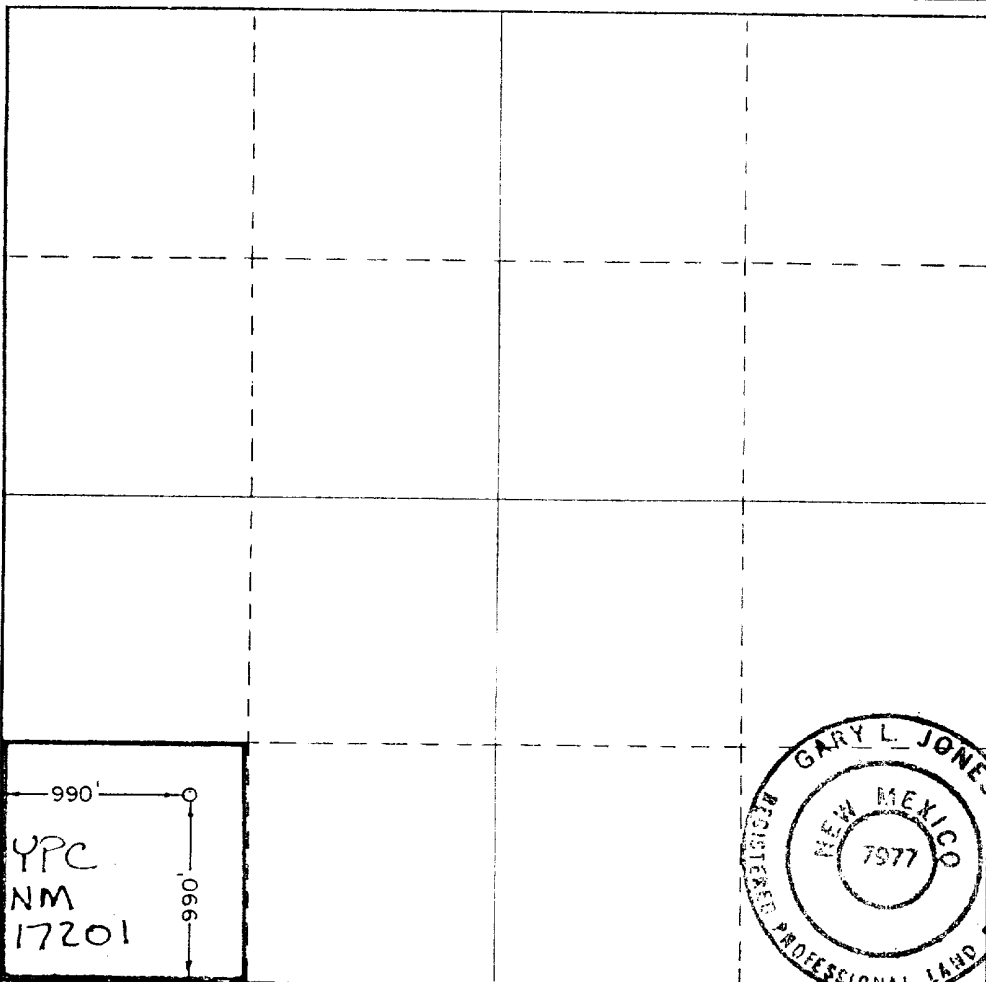

CERTIFICATION

I hereby certify that the information contained herein is true and complete to the best of my knowledge and belief.

Cy Cowan
Name

Cy Cowan
Position

Regulatory Coordinator
Company

Yates Petroleum Corporation
Date

12/9/82

I hereby certify that the well location shown on this plat was plotted from field notes of actual surveys made by me or under my supervision, and that the same is true and correct to the best of my knowledge and belief.

Date Surveyed

December 6, 1982

Registered Professional Engineer
and/or Land Surveyor

Gary L. Jones
Certificate No.

7977

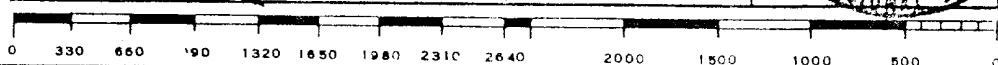

YATES PETROLEUM CORPORATION
Big Bend "WJ" Federal #1
990' FSL and 990' FWL
Sec. 35-T3S-R25E

In conjunction with Form 9-331C, Application for Permit to Drill subject well, Yates Petroleum Corporation submits the following ten items of pertinent information in accordance with USGS requirements.

1. The geologic surface formation is sandy alluvium.
2. The estimated tops of geologic markers are as follows:

San Andres	681'
P1	1016'
P2	1106'
P3 Dolomite	1258'
P4	1459'
Glorieta	1630'
TD	1675'
3. The estimated depths at which anticipated water, oil or gas formations are expected to be encountered:

Water: 490' - 760'

Oil or Gas: 1280'
4. Proposed Casing Program: See Form 9-331C.
5. Pressure Control Equipment: See Form 9-331C and Exhibit B.
6. Mud Program: See Form 9-331C.
7. Auxiliary Equipment: Kelly Cock; pit level indicators and flow sensor equipment;
sub with full-opening valve on floor, drill pipe connection.
8. Testing, Logging and Coring Program:

Samples: Surface casing to TD.
DST's: none
Coring: none
Logging: CNL-LDT DLL & Rxo Sonic
9. No abnormal pressures or temperatures are anticipated.
10. Anticipated starting date: As soon as possible after approval.

Big BEND
WS FED
#1

APPROX 15 mi

19 mi

Yates Petroleum Corp
Big BEND 'WS' FED #1
990' FSL + 990' FWL
Sec 35 T3s R25E
De Baca County
NM

Roswell 23.5 mi

Drill Nipple

Flowline

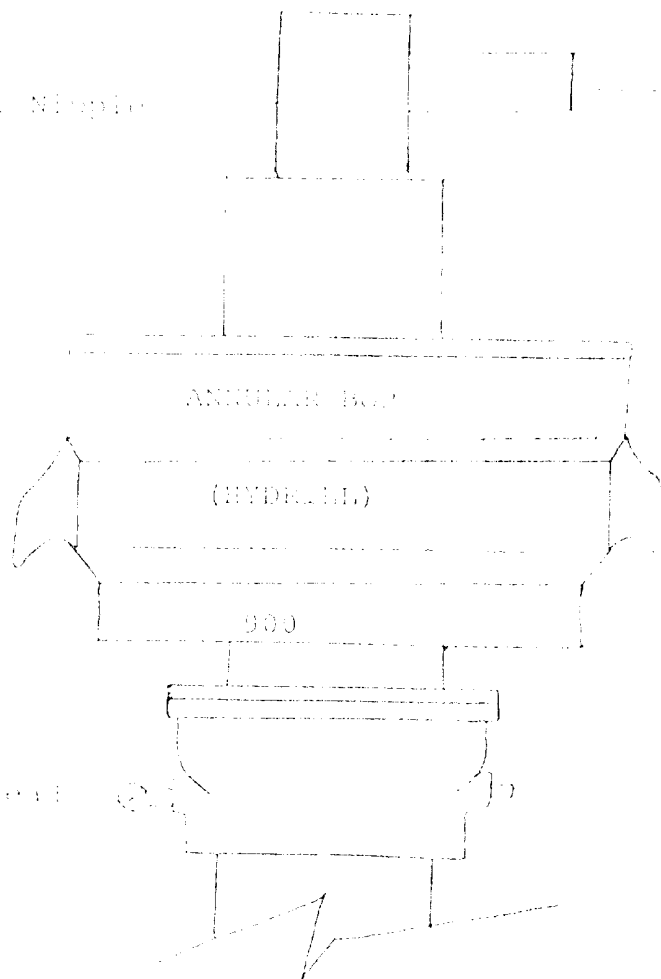

Casinghead or Bradenhead

THE FOLLOWING CONSTITUTE MINIMUM BLOWOUT PREVENTER REQUIREMENTS

1. All preventers to be hydraulically operated with secondary manual controls installed prior to drilling out from under casing.
2. All connections from operating manifolds to preventers to be all steel. Hole or tube a minimum of one inch in diameter.
3. The available closing pressure shall be at least 15% in excess of that required with sufficient volume to operate the BOP's.
4. All connections to and from preventer to have a pressure rating equivalent to that of the BOP's.
5. Hole must be kept filled on trips below intermediate casing.

YATES PETROLEUM CORP.

Exhibit C

Reserve Pit
bottom to be at
ground level to
1 ft.

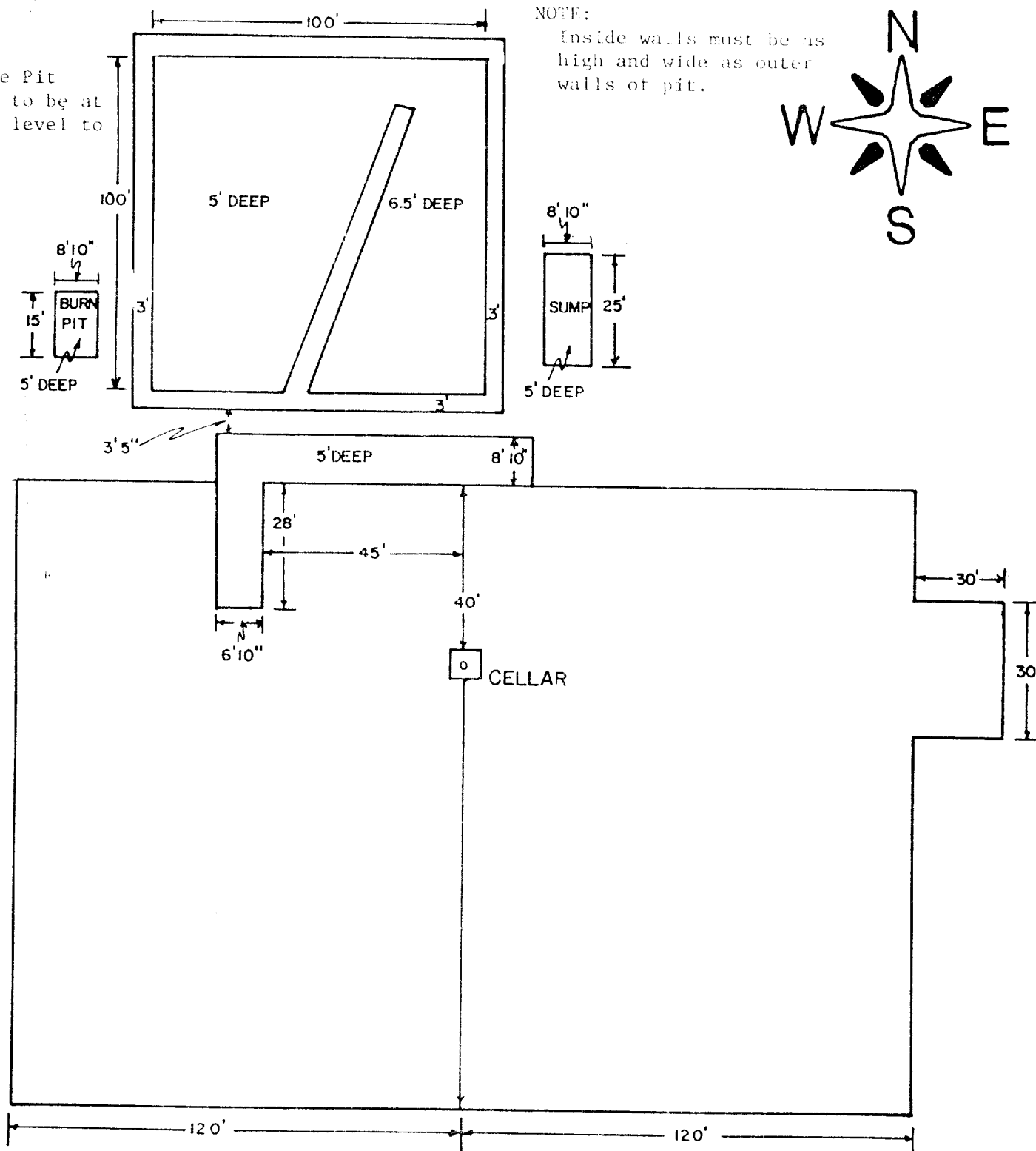



202 SOUTH FOURTH STREET
ARTESIA, NEW MEXICO 88210
TELEPHONE (505) 743-1331

S. P. YATES
PRESIDENT
MARTIN YATES, III
VICE PRESIDENT
JOHN A. YATES
VICE PRESIDENT
B. W. HARPER
SEC. TREAS.

December 8, 1982

Mr. George Stewart
Minerals Management Service
Federal Building
Roswell, New Mexico 88201

Re: Big Bend "WJ" Federal #1

Dear Mr. Stewart,

Yates Petroleum Corporation is submitting an application to drill a well on surface patented to Madison A. Wynn, Dunlap Rt. Box 1116, Roswell, New Mexico. This well will be located 990' FSL and 990' FWL of Section 35S, T3S, R25E, DeBaca County, New Mexico.

During a visit with Mr. Wynn, it was agreed that we would compensate him monetarily for the surface damaged in drilling this well. It was further agreed that in the event of a dry hole, we would rip the road. The pit area will be leveled after it is dry and along with the pad will be left to reseed naturally.

Sincerely,

Cy Cowan
Regulatory Coordinator
YATES PETROLEUM CORPORATION

CC/dw