

FEB 25 1982

O. C. O.

ARTESIA, OFFICE

Form C-101
Revised 10-1-78

5A. Indicate Type of Lease

STATE ☐ FEE ☒

5. State Oil & Gas Lease No.

7. Unit Agreement Name

8. Farm or Lease Name

Cook 20

9. Well No.

1

10. Field and Pool, or Wildcat

Wildcat Abo

12. County

Debaca

19. Proposed Depth

5500

19A. Formation

Abo

20. Rotary or C.T.

Rotary

21. Elevations (Show whether DF, RT, etc.)

4134'G1; 4144'KB

21A. Kind & Status Plug. Bond

Blanket-St. Wide

21B. Drilling Contractor

Pace Drilling Co.

22. Approx. Date Work will start

2/26/82

23.

PROPOSED CASING AND CEMENT PROGRAM

SIZE OF HOLE	SIZE OF CASING	WEIGHT PER FOOT	SETTING DEPTH	SACKS OF CEMENT	EST. TOP
17-1/2"	13-3/8"	54.5#	400' ±	300 sx C1 C	Circulated
12-1/4"	8-5/8"	24 #	1500' ±	750 sx C1 C	Circulated
7-7/8"	4-1/2"	10.5#	5500' ±	600 sx C1 C	-

BOP - Exhibit "C" attached.

Spud well with 17-1/2" bit and drill to approx 400', penetrating San Andres dolomite. Surface casing will be run and cement circulated to surface.

BOP will be installed on the 13-3/8" and adequately tested. A 12-1/4" hole will be drilled to 1500'±. Casing will be run and cement circulated or grouted.

BOP will be installed on the 8-5/8" and tested to approx 1000 psi., and the shoe will be tested to equivalent of 10# mud (100 psi above 8.8 - 9.0#).

APPROVAL VALID FOR 180 DAYS

PERMIT EXPIRES 9-2-82

UNLESS DRILLING UNDERWAY

4. ABOVE SPACE DESCRIBE PROPOSED PROGRAM; IF PROPOSAL IS TO DEEPEN OR PLUG BACK, GIVE DATA ON PRESENT PRODUCTIVE ZONE AND PROPOSED NEW PRODUCTIVE ZONE. GIVE BLOWOUT PREVENTER PROGRAM, IF ANY.

hereby certify that the information above is true and complete to the best of my knowledge and belief.

Signed [Signature] Title Field Consultant Date 2/23/82

(This space for State Use)

APPROVED BY [Signature] TITLE OIL AND GAS INSPECTOR DATE MAR - 2 1982

CONDITIONS OF APPROVAL, IF ANY:

NEW MEXICO OIL CONSERVATION COMMISSION
WELL LOCATION AND ACREAGE DEDICATION PLAT

Form C-102
Supersedes C-128
Effective 1-1-65

All distances must be from the outer boundaries of the Section

Operator ENERGY RESOURCES OIL & GAS CORP.		Lease COOK 20		Well No. 1	
Section F	Section 20	Township 2 South	Range 23 East	County DeBaca	
Aerial footage location of well: 1650 feet from the North line and 1980 feet from the West line					
Ground Level Elev. 4133.7	Producing Formation Abo	Pool Wildcat	Dedicated Acreage: 160 Acres		

- Outline the acreage dedicated to the subject well by colored pencil or hachure marks on the plat below.
- If more than one lease is dedicated to the well, outline each and identify the ownership thereof (both as to working interest and royalty)
- If more than one lease of different ownership is dedicated to the well, have the interests of all owners been consolidated by communitization, unitization, force-pooling, etc?

☐ Yes ☒ No If answer is "yes," type of consolidation _____

If answer is "no," list the owners and tract descriptions which have actually been consolidated. (Use reverse side of this form if necessary.) _____

No allowable will be assigned to the well until all interests have been consolidated (by communitization, unitization, forced-pooling, or otherwise) or until a non-standard unit, eliminating such interests, has been approved by the Commission.

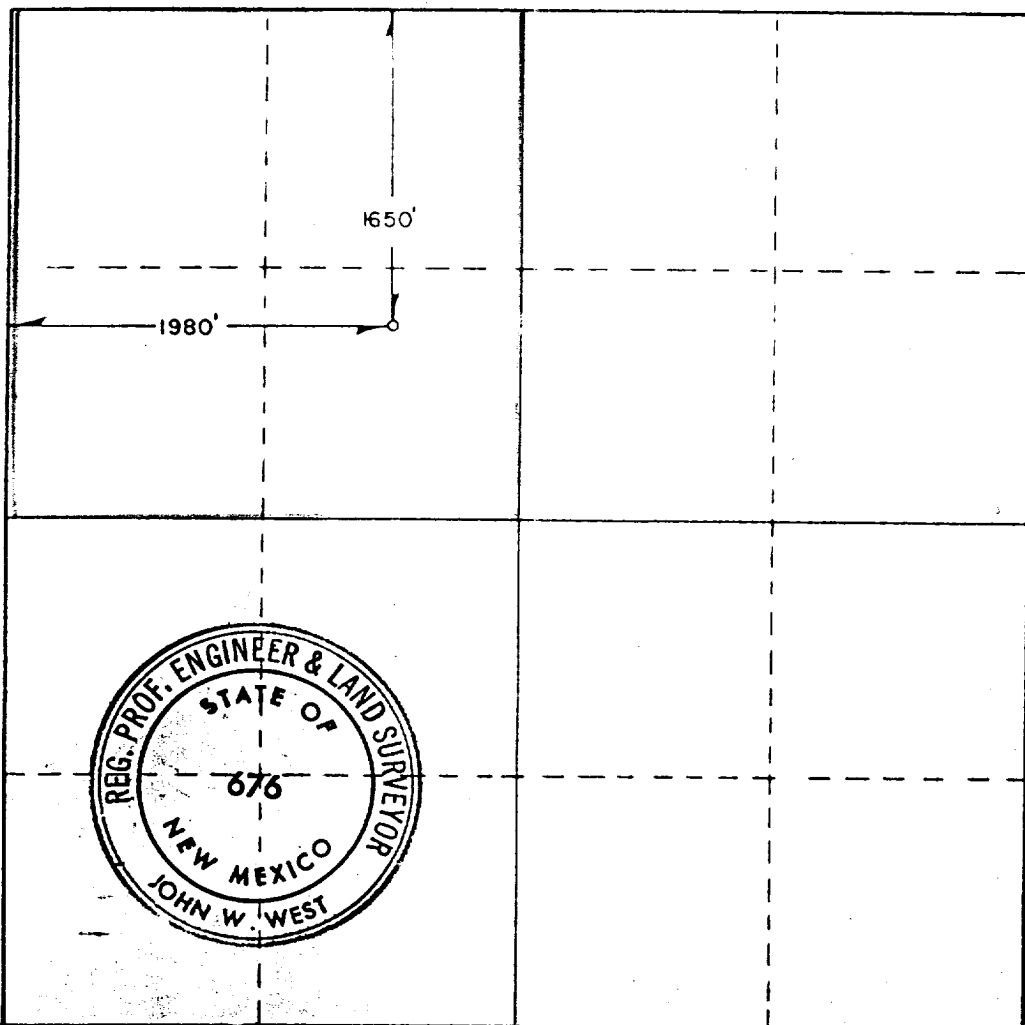

CERTIFICATION

I hereby certify that the information contained herein is true and complete to the best of my knowledge and belief.

John A. Sheldon
Name

John A. Sheldon

Position

Field Consultant

Company

Energy Resources Oil & Gas Corporation

Date 2/23/82

I hereby certify that the well location shown on this plat was plotted from field notes of actual surveys made by me or under my supervision, and that the same is true and correct to the best of my knowledge and belief.

Date Surveyed

February 8th, 1982

Registered Professional Engineer and/or Land Surveyor

John W. West

Certificate No. **JOHN W. WEST 676**
PATRICK A. ROMERO 6863
Ronald J. Eldson 3239

Energy Resources Oil & Gas
#1 Cook 20, Sec. 20, T2S, R23E
DeBaca County, New Mexico

Exhibit "C"

TYPE 39 SHAFFER

12" 900 B.O.P.

7" Flow Line

TOP - 3½" Rams

BOTTOM - Blind Rams

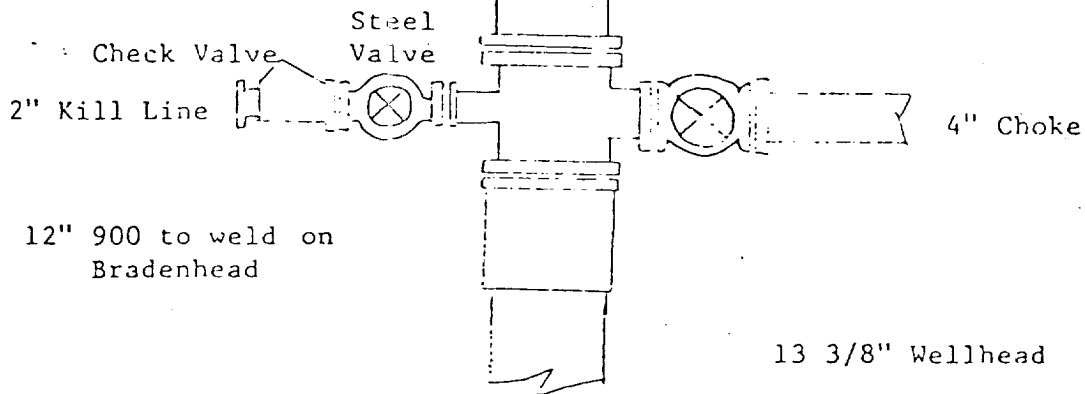

2" Standard Ball plug

2" Standard 2/2000# Ball Valve