

NUMBER OF COPIES RECEIVED		6
DISTRIBUTION		
SANTA FE	1	
FILE		
U.S.G.S.	2	
LAND OFFICE		
TRANSPORTER		
OIL		
GAS		
PRORATOR OFFICE		
OPERATOR		

NEW MEXICO OIL CONSERVATION COMMISSION
Santa Fe, New Mexico

Form C-101
Revised (12/1/55)

NOTICE OF INTENTION TO DRILL

Notice must be given to the District Office of the Oil Conservation Commission and approval obtained before drilling or recompletion begins. If changes in the proposed plan are considered advisable, a copy of this notice showing such changes will be returned to the sender. Submit this notice in QUINTUPLICATE. One copy will be returned following approval. See additional instructions in Rules and Regulations of the Commission. If State Land submit 6 Copies Attach Form C- 128 in triplicate to first 3 copies of form C-101

(Place) January 11, 1963 (Date)

OIL CONSERVATION COMMISSION
SANTA FE, NEW MEXICO

Gentlemen:

You are hereby notified that it is our intention to commence the Drilling of a well to be known as

O. A. Peters

(Company or Operator)

State

(Lease)

Well No. 1, in P. (Unit) The well is

located 860 feet from the South line and 660 feet from the

East

line of Section 2, T. 1-N, R. 20-E, NMPM.

(GIVE LOCATION FROM SECTION LINE)

Wildcat Pool, DeBaca County

If State Land the Oil and Gas Lease is No. K-1787

If patented land the owner is

Address

We propose to drill well with drilling equipment as follows:

Rotary Tools

The status of plugging bond is One Well Plugging Bond

Drilling Contractor

We intend to complete this well in the Perm.

formation at an approximate depth of 5500 feet.

CASING PROGRAM

We propose to use the following strings of Casing and to cement them as indicated:

Size of Hole	Size of Casing	Weight per Foot	New or Second Hand	Depth	Sacks Cement
12 1/2"	10-1/4	40	2nd	25	75
8-5/8"	7" BLK PIPE	28	2nd	3,300	300
7-7/8"	4 1/2	16	new	TD	Circ.

If changes in the above plans become advisable we will notify you immediately.

ADDITIONAL INFORMATION (If recompletion give full details of proposed plan of work.)

This being a Wildcat and the water zones unknown the above casing program most likely will be changed. You will be advised on any changes.

JAN 11 1963

Approved Except as follows: _____, 19____

OIL CONSERVATION COMMISSION

By M. L. Armstrong

Sincerely yours,

O. A. Peters

(Company or Operator)

By O. A. Peters

Owner

Position

Send Communications regarding well to: O. A. Peters Roswell, N. M.

Name P. O. 23

Address

NUMBER OF COPIES RECEIVED	
DISTRIBUTION	
SANTA FE	
FILE	
U.S.G.S.	
LAND OFFICE	
TRANSPORTER	OIL GAS
PRORATOR OFFICE	
OPERATOR	

NEW MEXICO OIL CONSERVATION COMMISSION
WELL LOCATION AND ACREAGE DEDICATION PLAT
 SEE INSTRUCTIONS FOR COMPLETING THIS FORM ON THE REVERSE SIDE

FORM C-128
 Revised 5/1/57

SECTION A

Operator O. A. Peters		Lease State		Well No. 1
Unit Letter	Section 2	Township 1-N	Range 20-E	County De Baca
Actual Footage Location of Well: 660 feet from the East line and 860 feet from the South line				
Ground Level Elev.	Producing Formation	Pool Wildcat	Dedicated Acreage: Acres	

1. Is the Operator the only owner in the dedicated acreage outlined on the plat below? YES ☒ NO ☐ ("Owner" means the person who has the right to drill into and to produce from any pool and to appropriate the production either for himself or for himself and another. (65-3-29 (e) NMSA 1935 Comp.)
2. If the answer to question one is "no," have the interests of all the owners been consolidated by communitization agreement or otherwise? YES ☐ NO ☐ . If answer is "yes," Type of Consolidation _____
3. If the answer to question two is "no," list all the owners and their respective interests below:

Owner	Land Description

SECTION B

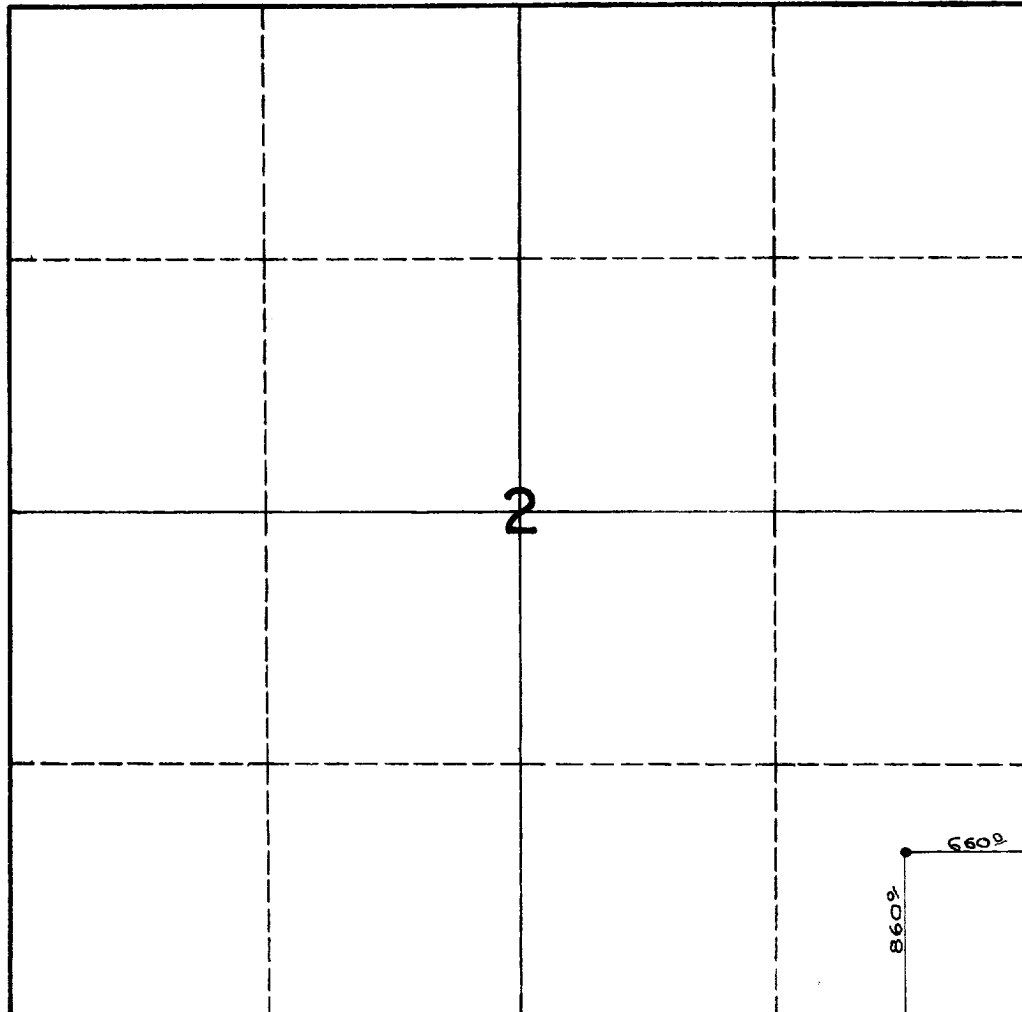

CERTIFICATION

I hereby certify that the information in SECTION A above is true and complete to the best of my knowledge and belief.

O. A. Peters

Name
Position Owner
Company O. A. Peters
Date 1/11/63

I hereby certify that the well location shown on the plat in SECTION B was plotted from field notes of actual surveys made by me or under my supervision, and that the same is true and correct to the best of my knowledge and belief.

Date Surveyed December 4, 1962
Registered Professional Engineer and/or Land Surveyor Verlan E. Hall
Certificate No. 3241

0 330 660 990 1320 1650 1980 2310 2640 2000 1500 1000 500 0

INSTRUCTIONS FOR COMPLETION OF FORM C-128

1. Operator shall furnish and certify to the information called for in Section A.
2. Operator shall outline the dedicated acreage for *both* oil and gas wells on the plat in Section B.
3. A registered professional engineer or land surveyor registered in the State of New Mexico or approved by the Commission shall show on the plat the location of the well and certify this information in the space provided.
4. All distances shown on the plat must be from the outer boundaries of the Section.
5. If additional space is needed for listing owners and their respective interests as required in question 3 of Section A, please use space below.