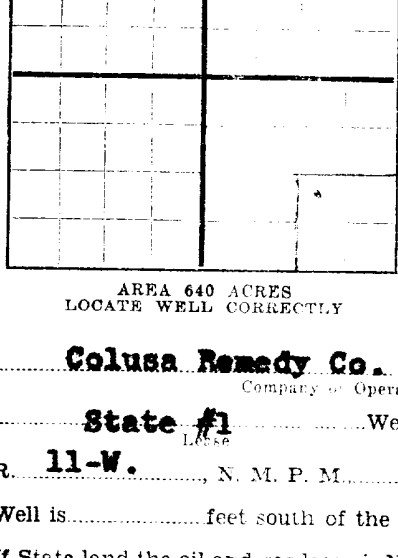

N

AREA 640 ACRES  
LOCATE WELL CORRECTLYNEW MEXICO OIL CONSERVATION COMMISSION  
Santa Fe, New Mexico

## WELL RECORD

Mail to Oil Conservation Commission, Santa Fe, New Mexico, or its proper agent not more than twenty days after completion of well. Follow instructions in the Rules and Regulations of the Commission. Indicate questionable data by following it with (?). SUBMIT IN TRIPPLICATE. FORM C-110 WILL NOT BE APPROVED UNTIL FORM C-105 IS PROPERLY FILLED OUT.

**Colusa Remedy Co.**  
Company or Operator  
State **#1** Well No. **wildcat** in **SE 1/4 of SW 1/4** Sec. **3** T. **20-S**  
R. **11-W.** N. M. P. M. Field, **Grant** County.  
Well is \_\_\_\_\_ feet south of the North line and \_\_\_\_\_ feet west of the East line of \_\_\_\_\_  
If State land the oil and gas lease is No. **554** Assignment No. \_\_\_\_\_  
If patented land the owner is \_\_\_\_\_ Address \_\_\_\_\_  
If Government land the permittee is \_\_\_\_\_ Address \_\_\_\_\_  
The Lessee is \_\_\_\_\_ F. R. Older Address **1021 N. Normandie Ave.**  
Drilling commenced **October** 19 **46** Drilling was completed \_\_\_\_\_ 19 \_\_\_\_\_  
Name of drilling contractor **none** Address \_\_\_\_\_  
Elevation above sea level at top of casing **unknown** feet.  
The information given is to be kept confidential until \_\_\_\_\_ 19 \_\_\_\_\_ **not confidential**  
**Please see copy of notice of intention OR ZONES ours is illegible**  
No. 1, from \_\_\_\_\_ to \_\_\_\_\_ No. 4, from \_\_\_\_\_ to \_\_\_\_\_  
No. 2, from \_\_\_\_\_ to \_\_\_\_\_ No. 5, from \_\_\_\_\_ to \_\_\_\_\_  
No. 3, from \_\_\_\_\_ to \_\_\_\_\_ No. 6, from \_\_\_\_\_ to \_\_\_\_\_

**IMPORTANT WATER SANDS**  
Include data on rate of water inflow and elevation to which water rose in hole  
No. 1, from \_\_\_\_\_ to \_\_\_\_\_ feet.  
No. 2, from **none** to \_\_\_\_\_ feet.  
No. 3, from \_\_\_\_\_ to \_\_\_\_\_ feet.  
No. 4, from \_\_\_\_\_ to \_\_\_\_\_ feet.

## CASING RECORD

SIZE	WEIGHT PER FOOT	THREADS PER INCH	MAKE	AMOUNT	KIND OF SHOE	CUT & FILLED FROM	PERFORATED FROM TO	PURPOSE
<b>8-5/8</b>	<b>26</b>	<b>9</b>	<b>seamless 1,100 Baker</b>					
<b>6-5/8</b>	<b>20</b>	<b>9</b>	<b>1805</b>					

## MUDDING AND CEMENTING RECORD

SIZE OF HOLE	SIZE OF CASING	WHERE SET	NO. SACKS OF CEMENT	METHODS USED	MUD GRAVITY	AMOUNT OF MUD USED
		<b>none</b>				

## PLUGS AND ADAPTERS

Heaving plug—Material **none** Length \_\_\_\_\_ Depth Set \_\_\_\_\_  
Adapters — Material **none** Size \_\_\_\_\_

## RECORD OF SHOOTING OR CHEMICAL TREATMENT

SIZE	SHELL USED	EXPLOSIVE OR CHEMICAL USED	QUANTITY	DATE	DEPTH SHOT OR TREATED	DEPTH CLEANED OUT
	<b>none</b>					

Results of shooting or chemical treatment **none**

## RECORD OF DRILL-STEM AND SPECIAL TESTS

If drill-stem or other special tests or deviation surveys were made, submit report on separate sheet and attach hereto.  
**none**

## TOOLS USED

Rotary tools were used from **none** feet to \_\_\_\_\_ feet, and from \_\_\_\_\_ feet to \_\_\_\_\_ feet  
Cable tools were used from **surface** feet to **1890** feet, and from \_\_\_\_\_ feet to \_\_\_\_\_ feet

## PRODUCTION

Put to producing \_\_\_\_\_ **none** 19 \_\_\_\_\_  
The production of the first 24 hours was \_\_\_\_\_ barrels of fluid of which \_\_\_\_\_ % was oil; \_\_\_\_\_ % emulsion; \_\_\_\_\_ % water; and \_\_\_\_\_ % sediment. Gravity, Be. \_\_\_\_\_  
If gas well, cu. ft. per 24 hours \_\_\_\_\_ Gallons gasoline per 1,000 cu. ft. of gas \_\_\_\_\_  
Rock pressure, lbs. per sq. in. \_\_\_\_\_

## EMPLOYEES

**J. R. Rogers** Driller  
**J. N. Webster** Driller

## FORMATION RECORD ON OTHER SIDE

I hereby swear or affirm that the information given herewith is a complete and correct record of the well and all work done on it so far as can be determined from available records.

Subscribed and sworn to before me this \_\_\_\_\_ day of \_\_\_\_\_ 19 \_\_\_\_\_

Notary Public

My Commission expires \_\_\_\_\_

Name **W. H. Rogers** Place \_\_\_\_\_ Date \_\_\_\_\_

Position **Agent**

Representing **Colusa Remedy Co.** Company or Operator

Address **6305 Yucca**

**Hollywood-28-Cal.**

## FORMATION RECORD

FROM	TO	THICKNESS IN FEET	FORMATION
<b>surface</b>	<b>bottom</b>	<b>1,890</b>	<b>Rhyolite as reported by Bureau of Mines Secorah</b>

## NEW MEXICO OIL CONSERVATION COMMISSION

SANTA FE, NEW MEXICO

## MISCELLANEOUS NOTICES

Submit this notice in triplicate to the Oil Conservation Commission or its proper agent before the work specified begin. A copy will be returned to the sender on which will be given the approval, with any modifications ~~com~~ advisable, or the rejection by the Commission or agent, of the plan submitted. The plan as approved should be ~~in~~ and work should not begin until approval is obtained. See additional instructions in the Rules and Regulations of the Commission.

Indicate nature of notice by checking below:

NOTICE OF INTENTION TO TEST CASING SHUT-OFF		NOTICE OF INTENTION TO SHOOT OR CHEMICALLY TREAT WELL	
NOTICE OF INTENTION TO CHANGE PLANS		NOTICE OF INTENTION TO PULL OR OTHERWISE ALTER CASING	
NOTICE OF INTENTION TO REPAIR WELL		NOTICE OF INTENTION TO PLUG WELL	X
NOTICE OF INTENTION TO DEEPEN WELL			

Los Angeles, California

Feb. 21, 1949

Place

Date

OIL CONSERVATION COMMISSION,  
Santa Fe, New Mexico.

Gentlemen:

Following is a notice of intention to do certain work as described below at the

v Colusa Remedy Co.

State

Well No. 1

in SE<sup>1</sup> of SE<sup>1</sup>

Company or Operator

Lease

of Sec. 3, T29 -S, R. 11-W, N. M. P. M., wildcat

Field

Grant

County.

## FULL DETAILS OF PROPOSED PLAN OF WORK

FOLLOW INSTRUCTIONS IN THE RULES AND REGULATIONS OF THE COMMISSION

Pulled casing, bridged hole and set pipe in cement  
four feet sticking above ground.

Approved 9-15, 1949  
except as follows:

Colusa Remedy Co.

Company or Operator

By

Position Agent

Send communications regarding well to

C.W. Colgrove

Name

Address

6305 Yucca

Los Angeles 28-California

OIL CONSERVATION COMMISSION,

By

Title

Frank (Bauer)  
Comptroller