

NEW MEXICO OIL CONSERVATION COMMISSION  
Santa Fe, New Mexico

Form G-101  
Revised (12/1/55)

NOTICE OF INTENTION TO DRILL

Notice must be given to the District Office of the Oil Conservation Commission and approval obtained before drilling or recompletion begins. If changes in the proposed plan are considered advisable, a copy of this notice showing such changes will be returned to the sender. Submit this notice in QUINTUPPLICATE. One copy will be returned following approval. See additional instructions in Rules and Regulations of the Commission. If State Land submit 6 Copies Attach Form G-128 in triplicate to first 3 copies of form G-101

Capitan, New Mexico

February 12, 1959

(Place)

(Date)

OIL CONSERVATION COMMISSION  
SANTA FE, NEW MEXICO

Gentlemen:

You are hereby notified that it is our intention to commence the Drilling of a well to be known as  
**Western Ranchers Oil Company, Incorporated**

(Company or Operator)

**Beecher**

*Martin*

(Lease)

Well No. **1**, in **H** (Unit) The well is

located **1650** feet from the **north** line and **337.5** feet from the

**east**

line of Section **19**, T. **8 S**, R. **14 E**, NMPM.

(GIVE LOCATION FROM SECTION LINE)

**Wildcat**

Pool,

**Lincoln**

County

If State Land the Oil and Gas Lease is No.

If patented land the owner is **Beecher Martin**

Address **Livingston, New Mexico**

We propose to drill well with drilling equipment as follows: **Rotary**

The status of plugging bond is **one well bond on file in Santa Fe**

Drilling Contractor **Steinberger Drilling Company**

We intend to complete this well in the **unknown** formation at an approximate depth of **1000** feet.

CASING PROGRAM

We propose to use the following strings of Casing and to cement them as indicated:

Size of Hole	Size of Casing	Weight per Foot	New or Second Hand	Depth	Sacks Cement
6-1/4 "	4-1/2"	9.5	New	Approx 1000'	50

If changes in the above plans become advisable we will notify you immediately.

ADDITIONAL INFORMATION (If recompletion give full details of proposed plan of work.)

**Propose to start 8-3/4" hole; set one joint 7" conductor pipe. This is a wildcat well, and don't know how much surface pipe will have to use to protect fresh water, but will set whatever is necessary.**

Approved \_\_\_\_\_, 19\_\_\_\_\_  
Except as follows:

OIL CONSERVATION COMMISSION

By

*M. L. Armstrong*

Sincerely yours,

**WESTERN RANCHERS OIL COMPANY, INC.**

(Company or Operator)

By

*Ira M. Young*  
**Ira M. Young, President**

Position

Send Communications regarding well to

**Western Ranchers Oil Company, Inc.**

Name

**P. O. Box 183, Capitan, New Mexico**

Address

NEW MEXICO OIL CONSERVATION COMMISSION  
Well Location and Acreage Dedication Plat

Section A.

Date February 12, 1959

Operator Western Ranchers Oil Co. Inc. Lease Beecher Martin  
Well No. 1 Unit Letter H Section 19 Township 8 South Range 14 East NMPM  
Located 1650 Feet From north Line, 337.5 Feet From East Line  
County Lincoln G. L. Elevation 6999 Dedicated Acreage 40 Acres  
Name of Producing Formation Unkown Pool Wildcat

1. Is the Operator the only owner\* in the dedicated acreage outlined on the plat below?  
Yes x No       .
2. If the answer to question one is "no," have the interests of all the owners been consolidated by communitization agreement or otherwise? Yes        No       . If answer is "yes," Type of Consolidation
3. If the answer to question two is "no," list all the owners and their respective interests below:

Owner

Land Description

Section B

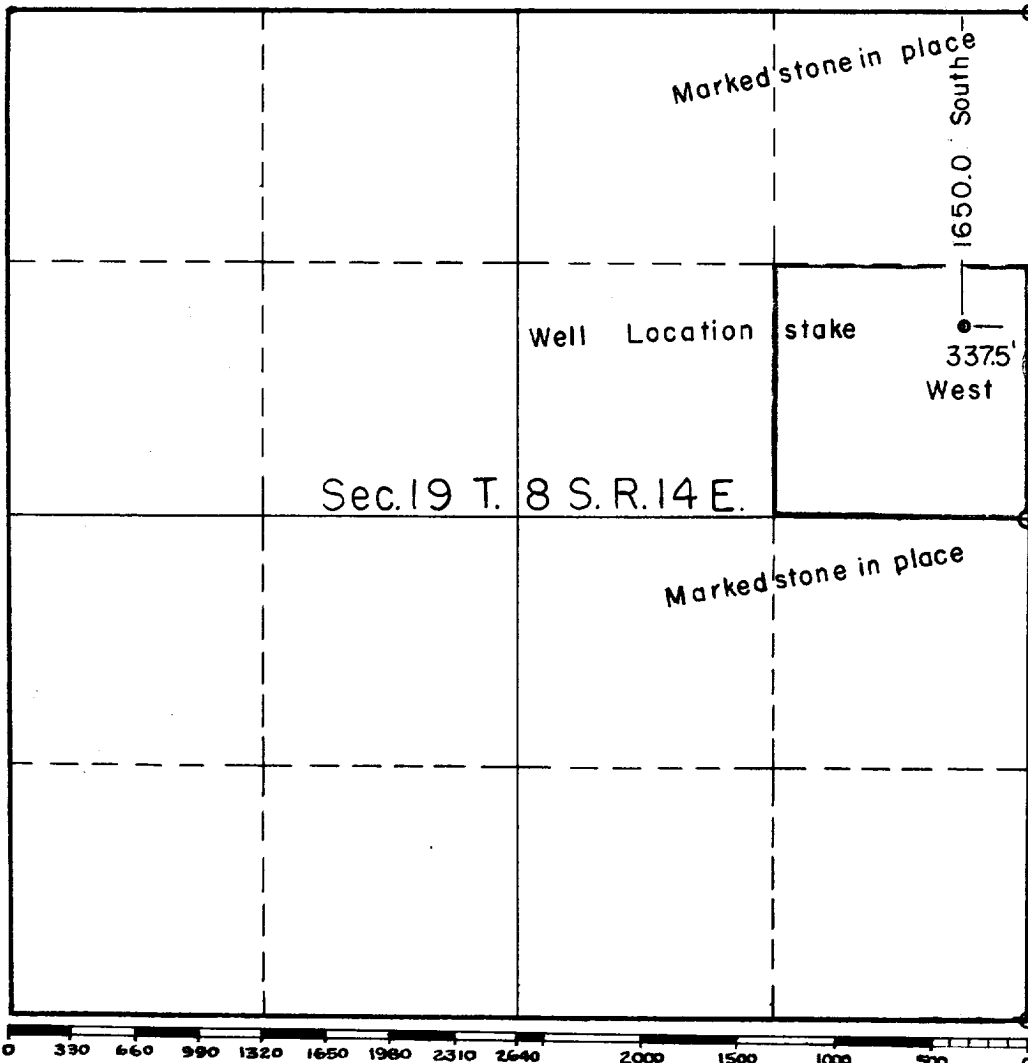

This is to certify that the information in Section A above is true and complete to the best of my knowledge and belief.

Western Ranchers Oil Co.  
(Operator)

W. M. Leaning  
(Representative)

Box 153 Clinton, N. M.  
Address

This is to certify that the well location shown on the plat in Section B was plotted from field notes of actual surveys made by me or under my supervision and that the same is true and correct to the best of my knowledge and belief.

Date Surveyed 2 / 11 / '59

Wiley D. Edgington  
Registered Professional  
Engineer and Land Surveyor.

Certificate No. 141

(See instructions for completing this form on the reverse side)

INSTRUCTIONS FOR COMPLETION

1. Operator shall furnish and certify to the information called for in Section A.
2. Operator shall outline the dedicated acreage for both oil and gas wells on the plat in Section B.
3. A registered professional engineer or land surveyor registered in the State of New Mexico or approved by the Commission shall show on the plat the location of the well and certify this information in the space provided.
4. All distances shown on the plat must be from the outer boundaries of Section.
5. If additional space is needed for listing owners and their respective interests as required in question 3, Section A, please use space below

\* "Owner" means the person who has the right to drill into and to produce from any pool and to appropriate the production either for himself or for himself and another. (65-3-29 (e) NMSA 1953 Comp.)