

NO. OF COPIES RECEIVED	6
DISTRIBUTION	
SANTA FE	1
FILE	1
U.S.G.S.	1
LAND OFFICE	1
OPERATOR	1

NEW MEXICO OIL CONSERVATION COMMISSION

JAN 07 1981

O. C. D.

ARTESIA OFFICE

30-027-20007

Form C-101
Revised 1-1-65

5A. Indicate Type of Lease
STATE <input checked="" type="checkbox"/> FEE <input type="checkbox"/>
5. State Oil & Gas Lease No.
LG - 8525

APPLICATION FOR PERMIT TO DRILL, DEEPEN, OR PLUG BACK

1a. Type of Work		7. Unit Agreement Name	
b. Type of Well DRILL <input checked="" type="checkbox"/> DEEPEN <input type="checkbox"/> PLUG BACK <input type="checkbox"/> OIL WELL <input type="checkbox"/> GAS WELL <input checked="" type="checkbox"/> OTHER <input type="checkbox"/> SINGLE ZONE <input checked="" type="checkbox"/> MULTIPLE ZONE <input type="checkbox"/>		8. Farm or Lease Name CHADWICK STATE	
2. Name of Operator Mesa Petroleum Co.		9. Well No. 1	
3. Address of Operator 1000 Vaughn Building / Midland, Texas 79701		10. Field and Pool, or Wildcat X WILDCAT	
4. Location of Well UNIT LETTER K LOCATED 1980' FEET FROM THE SOUTH LINE AND 1980' FEET FROM THE WEST LINE OF SEC. 2 TWP. 2S RGE. 15E NMPM		12. County CHAVES	
21. Elevations (Show whether DF, RT, etc.) 6011.3' GR		19. Proposed Depth 3000'	19A. Formation PENN
21A. Kind & Status Plug. Bond BLANKET	21B. Drilling Contractor DESERT	20. Rotary or C.T. ROTARY	
22. Approx. Date Work will start JANUARY 15, 1981			

PROPOSED CASING AND CEMENT PROGRAM

SIZE OF HOLE	SIZE OF CASING	WEIGHT PER FOOT	SETTING DEPTH	SACKS OF CEMENT	EST. TOP
7 1/2"	13 3/8"	48#	600	375	SURFACE
1"	8 5/8"	24#	1500	400	SUFFICIENT TO
7 7/8"	4 1/2"	10.5#	3000	400	COVER ALL PAY

Propose to drill a 17 1/2" hole w/air to 600', 13 3/8" csg will be run and cemented back to surface. The hole will be reduced to 11" and drilled to 1500'. 8 5/8" csg will be run if water is encountered; if no water is encountered, the hole size will be reduced to 7 7/8" and drilled to TD.

Gas sales are not dedicated.

APPROVAL VALID FOR 180 DAYS
PERMIT EXPIRES 7-16-81
UNLESS DRILLING UNDERWAY

CC: NMOCD (6), TLS, CEN RCDS, ACCTG, HOBBS OFFICE, MEC, MAH, PARTNERS, FILE

ABOVE SPACE DESCRIBE PROPOSED PROGRAM: IF PROPOSAL IS TO DEEPEN OR PLUG BACK, GIVE DATA ON PRESENT PRODUCTIVE ZONE AND PROPOSED NEW PRODUCTION ZONE. GIVE BLOWOUT PREVENTER PROGRAM, IF ANY.

I hereby certify that the information above is true and complete to the best of my knowledge and belief.

Signed R. E. Nathan Title Regulatory Coordinator Date JANUARY 5, 1981

(This space for State Use)

APPROVED BY W. A. Gressitt TITLE SUPERVISOR, DISTRICT II DATE JAN 16 1981

CONDITIONS OF APPROVAL, IF ANY:

**NEW MEXICO OIL CONSERVATION COMMISSION
WELL LOCATION AND ACREAGE DEDICATION PLAT**

Form C-102
Supersedes C-128
Effective 1-1-65

All distances must be from the outer boundaries of the Section

Location Mesa Petroleum Co.		County Chadwick State		Section 1	
Twp 2 South		Range 15 East		County Lincoln County, N.M.	
Year 1980		Feet from the South		Feet from the West	
Acres 6011.3		Lease PENN		Lease WILDCAT	
				Total Acres 40 320 Acres	

1. Outline the acreage dedicated to the subject well by colored pencil or hatchure marks on the plat below.
2. If more than one lease is dedicated to the well, outline each and identify the ownership thereof (both as to working interest and royalty).
3. If more than one lease of different ownership is dedicated to the well, have the interests of all owners been consolidated by communitization, unitization, force-pooling, etc?

☐ Yes ☐ No If answer is "yes" type of consolidation _____

If answer is "no," list the owners and tract descriptions which have actually been consolidated. (Use reverse side of this form if necessary) _____

No allowable will be assigned to the well until all interests have been consolidated (by communitization, unitization, forced-pooling, or otherwise) or until a non-standard unit, eliminating such interests, has been approved by the Commission.

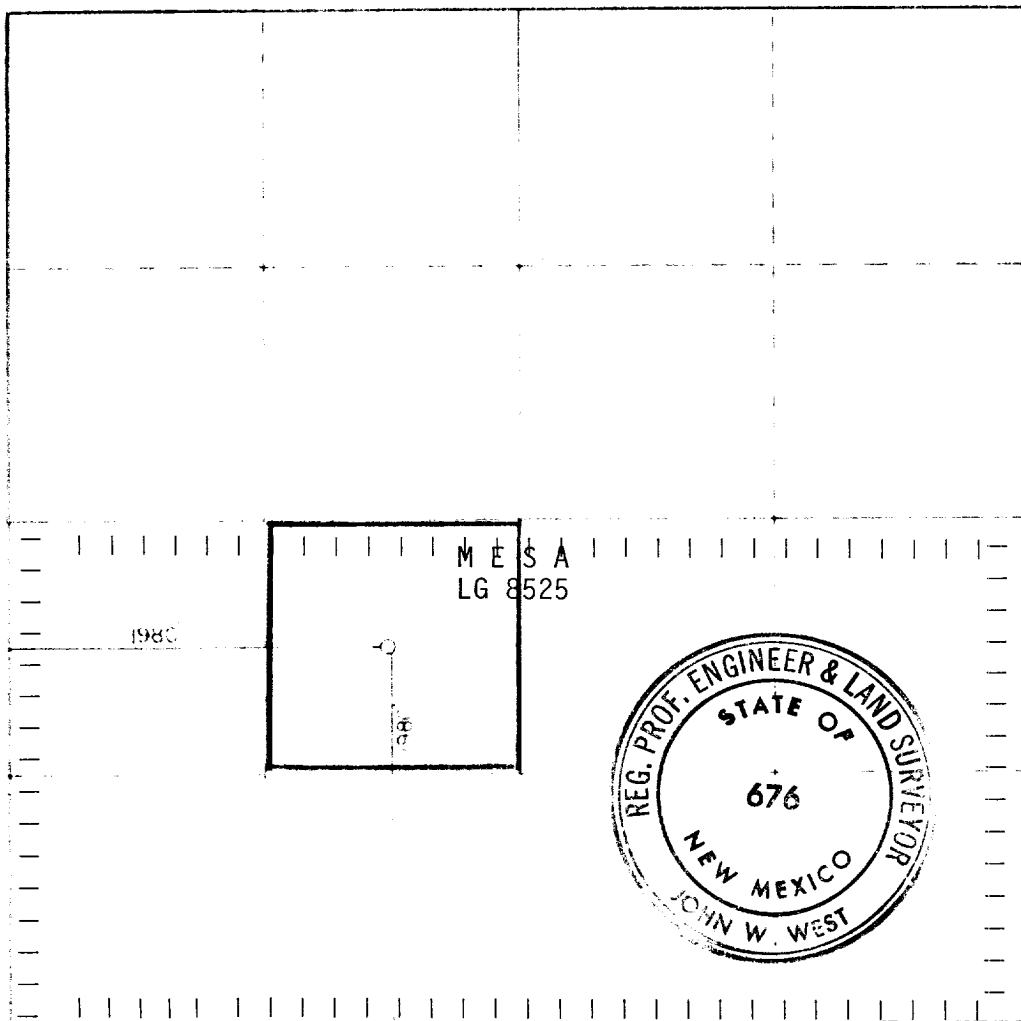

CERTIFICATION

I hereby certify that the information contained herein is true and complete to the best of my knowledge and belief.

R. E. Mathis

Name
R. E. MATHIS

Position
REGULATORY COORDINATOR

Company
MESA PETROLEUM CO.

Date
JANUARY 2, 1981

I hereby certify that the well location shown on this plat was plotted from field notes of actual surveys made by me or under my supervision, and that the same is true and correct to the best of my knowledge and belief.

12-16 & 17-80

John W. West

Certified by	JOHN W. WEST	676
	PATRICK A. ROMERO	6868
	Ronald J. Eidson	3239