

NO. OF COPIES RECEIVED	
DISTRIBUTION	
SANTA FE	
FILE	
U.S.G.S.	
LAND OFFICE	
OPERATOR	

NEW MEXICO OIL CONSERVATION COMMISSION

MAY 28 1981

O. C. D.
ARTESIA, OFFICE

30-027-20012

Form C-101
Revised 1-1-65

5A. Indicate Type of Lease
STATE <input checked="" type="checkbox"/> FEE <input type="checkbox"/>
5. State Oil & Gas Lease No.
LG 8898

APPLICATION FOR PERMIT TO DRILL, DEEPEN, OR PLUG BACK

1a. Type of Work	7. Unit Agreement Name
b. Type of Well DRILL <input checked="" type="checkbox"/> DEEPEN <input type="checkbox"/> PLUG BACK <input type="checkbox"/> OIL WELL <input type="checkbox"/> GAS WELL <input checked="" type="checkbox"/> OTHER <input type="checkbox"/> SINGLE ZONE <input checked="" type="checkbox"/> MULTIPLE ZONE <input type="checkbox"/>	8. Farm or Lease Name SANDERS STATE
2. Name of Operator MESA PETROLEUM CO. ✓	9. Well No. 1
3. Address of Operator 1000 VAUGHN BUILDING/MIDLAND, TEXAS 79701	10. Field and Pool, or Wildcat WILDCAT PENN
4. Location of Well UNIT LETTER J LOCATED 1980 FEET FROM THE SOUTH LINE AND 1980 FEET FROM THE EAST LINE OF SEC. 21 TWP. 1N RGE. 18E NMPM	12. County LINCOLN
19. Proposed Depth 4500'	19A. Formation PENN
20. Rotary or C.T. ROTARY	
21. Elevations (Show whether DF, RT, etc.) 5557.3' GR	21A. Kind & Status Plug. Bond BLANKET
21B. Drilling Contractor DESERT DRILLING	22. Approx. Date Work will start August 1, 1981

23.

PROPOSED CASING AND CEMENT PROGRAM

SIZE OF HOLE	SIZE OF CASING	WEIGHT PER FOOT	SETTING DEPTH	SACKS OF CEMENT	EST. TOP
17 1/2"	13 3/8"	48#	800'	500	SURFACE
11"	8 5/8"	24#	1600'	500	SUFFICIENT TO
7 7/8"	4 1/2"	10.5#	4500'	500	ISOLATE WTR, O&G SUFFICIENT TO COVER ALL PAY

Propose to drill 17 1/2" hole on air or foam to 800' or deeper to set 13 3/8" surface casing and cement to surface. Will reduce hole to 11" and drill to approximately 1600' to set 8 5/8" casing. Will nipple up ram type BOPs and reduce hole to 7 7/8" to drill to total depth. After log evaluation, 4 1/2" casing may be run and cemented with sufficient kinds and amounts to isolate and seal off any fresh water, oil, or gas zones encountered.

Gas Sales Are Dedicated To Transwestern Pipeline Company.

APPROVAL VALID FOR 180 DAYS
PERMIT EXPIRES 12-12-81
UNLESS DRILLING UNDERWAY

XC: MNOCD (6), TLS, CEN RCDS, ACCTG, MEC, LAND, PARTNERS, FILE, HOBBS

IN ABOVE SPACE DESCRIBE PROPOSED PROGRAM; IF PROPOSAL IS TO DEEPEN OR PLUG BACK, GIVE DATA ON PRESENT PRODUCTIVE ZONE AND PROPOSED NEW PRODUCTIVE ZONE. GIVE BLOWOUT PREVENTER PROGRAM, IF ANY.

I hereby certify that the information above is true and complete to the best of my knowledge and belief.

Signed R. E. [Signature] Title REGULATORY COORDINATOR Date MAY 25, 1981

(This space for State Use)

APPROVED BY W. A. Gressett TITLE SUPERVISOR, DISTRICT II DATE JUN 12 1981

CONDITIONS OF APPROVAL, IF ANY:

**NEW MEXICO OIL CONSERVATION COMMISSION
WELL LOCATION AND ACREAGE DEDICATION PLAT**

Form C-102
Supersedes C-128
Effective 1-1-65

All distances must be from the outer boundaries of the Section

Operator Mesa petroleum Co.			Lease Sanders State		Well No. 1
Unit Letter J	Section 21	Township 1N	Range 18E	County Lincoln	
Actual Footage Location of Well: 1980 feet from the SOUTH line and 1980 feet from the EAST line					
Ground Level Elev. 5557.3	Producing Formation PENN		Pool WILDCAT		Dedicated Acreage: 5/2 320 40 Acres

1. Outline the acreage dedicated to the subject well by colored pencil or hachure marks on the plat below.
2. If more than one lease is dedicated to the well, outline each and identify the ownership thereof (both as to working interest and royalty).
3. If more than one lease of different ownership is dedicated to the well, have the interests of all owners been consolidated by communitization, unitization, force-pooling, etc?

☐ Yes ☐ No If answer is "yes," type of consolidation _____

If answer is "no," list the owners and tract descriptions which have actually been consolidated. (Use reverse side of this form if necessary.) _____

No allowable will be assigned to the well until all interests have been consolidated (by communitization, unitization, forced-pooling, or otherwise) or until a non-standard unit, eliminating such interests, has been approved by the Commission.

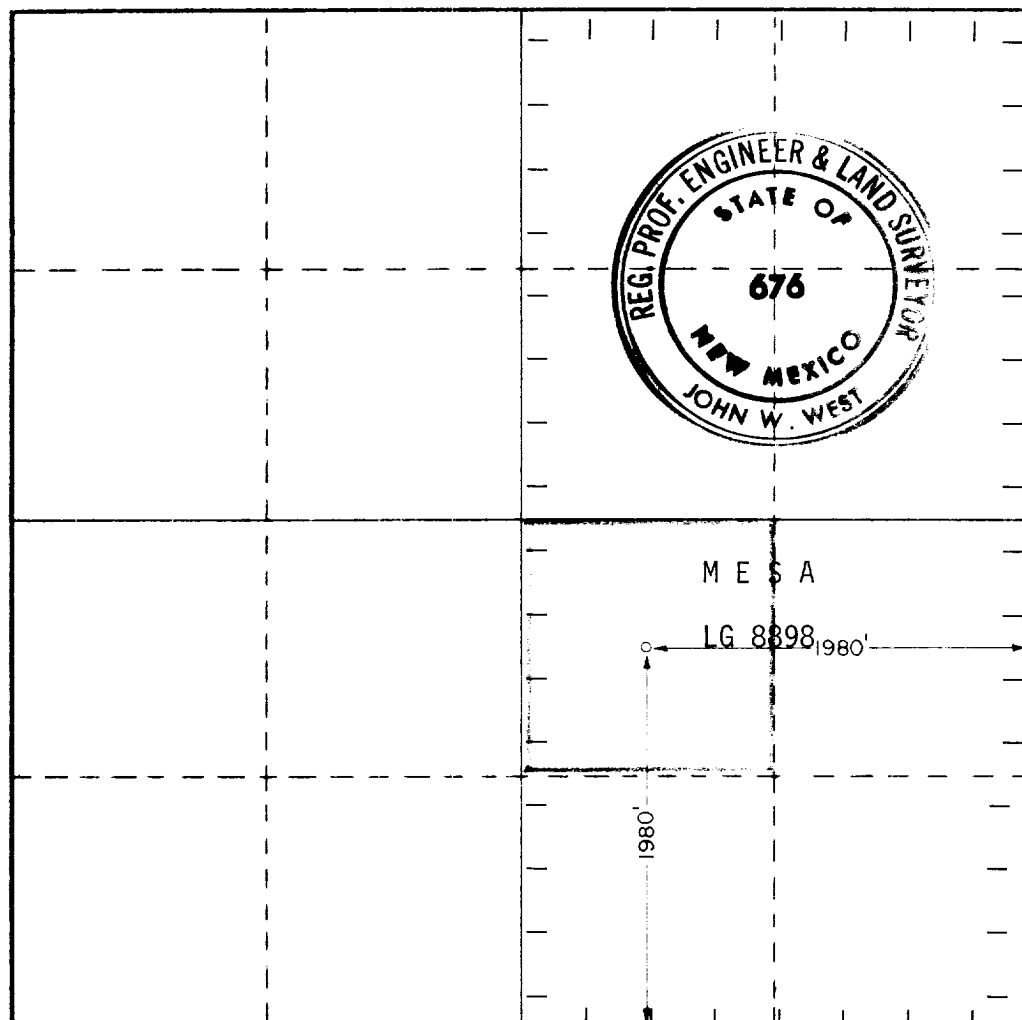

CERTIFICATION

I hereby certify that the information contained herein is true and complete to the best of my knowledge and belief.

R. E. Mathis

Name

R. E. MATHIS

Position

REGULATORY COORDINATOR

Company

MESA PETROLEUM CO.

Date

MAY 25, 1981

I hereby certify that the well location shown on this plat was plotted from field notes of actual surveys made by me or under my supervision, and that the same is true and correct to the best of my knowledge and belief.

May 8, 1981

Date Surveyed

Registered Professional Engineer
and/or Land Surveyor

John W. West

Certificate No.	JOHN W. WEST	676
	PATRICK A. ROMERO	6663
	Ronald J. Eidson	3239

0 330 660 990 1320 1650 1980 2310 2640 2000 1500 1000 500