

OIL CONSERVATION DIVISION

P. O. BOX **RECEIVED**
SANTA FE, NEW MEXICO 87501

Form C-101
Revised 10-1-79

NO. OF COPIES RECEIVED	
DISTRIBUTION	
SANTA FE	1
FILE	1
U.S.D.S.	
LAND OFFICE	
OPERATOR	2

MAR 31 1982

O. C. D.

5a. Indicate Type of Lease
State <input checked="" type="checkbox"/> For <input type="checkbox"/>
5. State Oil & Gas Lease No.
LG 8654

ARTESIA OFFICE

(DO NOT USE THIS FORM FOR PROPOSALS TO DRILL OR TO DEEPTEN OR PLUG BACK TO A DIFFERENT RESERVOIR. USE "APPLICATION FOR PERMIT" (FORM C-101) FOR SUCH PROPOSALS.)

6. Indicate Type of Well	7. Unit Agreement Name
OIL WELL <input type="checkbox"/> GAS WELL <input checked="" type="checkbox"/> OTHER <input type="checkbox"/>	
8. Name of Operator	8. Farm or Lease Name
Rault Petroleum Corporation	Taylor State
9. Address of Operator	9. Well No.
103 N. Pennsylvania Roswell, New Mexico 88201	#1
10. Location of Well	10. Field and Pool, or Wildcat
UNIT LETTER 660 660 FEET FROM THE North LINE AND 1980 FEET FROM	Wildcat Penn.
THE West LINE, SECTION 22 TOWNSHIP 1S RANGE 15E NORTH	
11. Elevation (Show whether DF, RT, GR, etc.)	12. County
5976 Gr	Lincoln

Check Appropriate Box To Indicate Nature of Notice, Report or Other Data
NOTICE OF INTENTION TO: SUBSEQUENT REPORT OF:

PERFORM REMEDIAL WORK <input type="checkbox"/>	PLUG AND ABANDON <input type="checkbox"/>	REMEDIAL WORK <input type="checkbox"/>	ALTERING CASING <input type="checkbox"/>
TEMPORARILY ABANDON <input type="checkbox"/>	CHANGE PLANS <input type="checkbox"/>	COMMENCE DRILLING OPNS. <input type="checkbox"/>	PLUG AND ABANDONMENT <input type="checkbox"/>
PULL UP ALTER CASING <input type="checkbox"/>	OTHER <input checked="" type="checkbox"/>	CASING TEST AND CEMENT JOBS <input type="checkbox"/>	
OTHER Change designated operator <input checked="" type="checkbox"/>			

17. Describe Proposed or Completed Operations (Clearly state all pertinent details, and give pertinent dates, including estimated date of starting any proposed work) SEE RULE 1103.

Change Mesa Petroleum Co. as operator to Rault Petroleum Corporation

(1) as new designated operator.

Effective December 29, 1981. Mailing Address:

Rault Petroleum Corporation
103 N. Pennsylvania
Roswell, New Mexico 88201
505-624-1800

(2) Change surface casing from 1300' to 650' as verbally approved
3-31-82 by the New Mexico District Commission.

Posted ID-3
Chng Operator
4-2-82

18. I hereby certify that the information above is true and complete to the best of my knowledge and belief.

SIGNED <u>Jim Vickrey</u>	TITLE <u>Manager</u>	DATE <u>3-31-82</u>
APPROVED BY <u>W.A. Gessert</u>	TITLE <u>SUPERVISOR, DISTRICT 7</u>	DATE <u>MAR 31 1982</u>
CONDITIONS OF APPROVAL, IF ANY:		

NO. OF COPIES RECEIVED	
DISTRIBUTION	
SANTA FE	1
FILE	1
U.S.G.S.	2
LAND OFFICE	1
OPERATOR	1

RECEIVED
NEW MEXICO OIL CONSERVATION COMMISSION
OCT 22 1981
O. C. D.
ARTERIAL OFFICE

30-027-20015
Form C-101
Revised 1-1-65

5A. Indicate Type of Lease STATE <input checked="" type="checkbox"/> FEE <input type="checkbox"/>
5. State Oil & Gas Lease No. LG 8654

APPLICATION FOR PERMIT TO DRILL, DEEPEN, OR PLUG BACK

1a. Type of Work DRILL <input checked="" type="checkbox"/> DEEPEN <input type="checkbox"/> PLUG BACK <input type="checkbox"/>		7. Unit Agreement Name
b. Type of Well OIL WELL <input type="checkbox"/> GAS WELL <input checked="" type="checkbox"/> OTHER <input type="checkbox"/>		8. Farm or Lease Name Taylor State
2. Name of Operator Mesa Petroleum Co. ✓		9. Well No. 1
3. Address of Operator 1000 Vaughn Building/Midland, Texas 79701-4493		10. Field and Pool, or Wildcat Wildcat Penn
4. Location of Well UNIT LETTER C LOCATED 660' FEET FROM THE North LINE AND 1980' FEET FROM THE West LINE OF SEC. 22 TWP. 1S RGE. 15E NMPM		12. County Lincoln
19. Proposed Depth 3000'		19A. Formation Penn
20. Rotary or C.T. Rotary		
21. Elevations (Show whether DF, RT, etc.) 5976' GR	21A. Kind & Status Plug. Bond Blanket	21B. Drilling Contractor Tom Brown
22. Approx. Date Work will start November 24, 1981		

23.

PROPOSED CASING AND CEMENT PROGRAM

SIZE OF HOLE	SIZE OF CASING	WEIGHT PER FOOT	SETTING DEPTH	SACKS OF CEMENT	EST. TOP
12 1/4"	8 5/8"	24#	1300'	300/300/300	Surface
7 7/8"	4 1/2"	10.5#	3000'	500/500	Isolate Wtr. O&G

Propose to drill 12 1/4" hole to approximately 1300' more or less and set 8 5/8" surface casing and cement to surface. Will reduce hole to 7 7/8", nipple up RAM type BOPs and drill to total depth. Drilling medium will be air, foam, or mud as required.

Gas Sales are dedicated.

APPROVAL VALID FOR 180 DAYS
PERMIT EXPIRES 4-29-82
UNLESS DRILLING UNDERWAY

Posted ID-1
API & NGL Book
10-30-81

XC: NMOCD(6), TLS, CEN RCDS, ACCTG, ROSWELL, MEC, LAND, PARTNERS, FILE, REM

IN ABOVE SPACE DESCRIBE PROPOSED PROGRAM: IF PROPOSAL IS TO DEEPEN OR PLUG BACK, GIVE DATA ON PRESENT PRODUCTIVE ZONE AND PROPOSED NEW PRODUCTIVE ZONE. GIVE BLOWOUT PREVENTER PROGRAM, IF ANY.

I hereby certify that the information above is true and complete to the best of my knowledge and belief.

Signed R. E. Mark Title Regulatory Coordinator Date 10-21-81

(This space for State Use)

APPROVED BY N. A. Gressett TITLE SUPERVISOR, DISTRICT II DATE OCT 28 1981

CONDITIONS OF APPROVAL, IF ANY:

NEW MEXICO OIL CONSERVATION COMMISSION
WELL LOCATION AND ACREAGE DEDICATION PLAT

Form C-102
Supersedes C-128
Effective 1-1-65

All distances must be from the outer boundaries of the Section

Operator Mesa Petroleum Company			Lease Taylor State			Well No. 1		
Tract Letter C	Section 22	Township 1 South	Range 15 East	County Lincoln				
Actual Footage Location of Well: 660 feet from the north line and 1980 feet from the West line								
Ground Level Elev. 5976.0		Producing Formation Penn		Pool Wildcat			Dedicated Acreage: 40 Acres	

1. Outline the acreage dedicated to the subject well by colored pencil or hachure marks on the plat below.
2. If more than one lease is dedicated to the well, outline each and identify the ownership thereof (both as to working interest and royalty).
3. If more than one lease of different ownership is dedicated to the well, have the interests of all owners been consolidated by communitization, unitization, force-pooling, etc?

☐ Yes ☐ No If answer is "yes," type of consolidation _____

If answer is "no," list the owners and tract descriptions which have actually been consolidated. (Use reverse side of this form if necessary.) _____

No allowable will be assigned to the well until all interests have been consolidated (by communitization, unitization, forced-pooling, or otherwise) or until a non-standard unit, eliminating such interests, has been approved by the Commission.

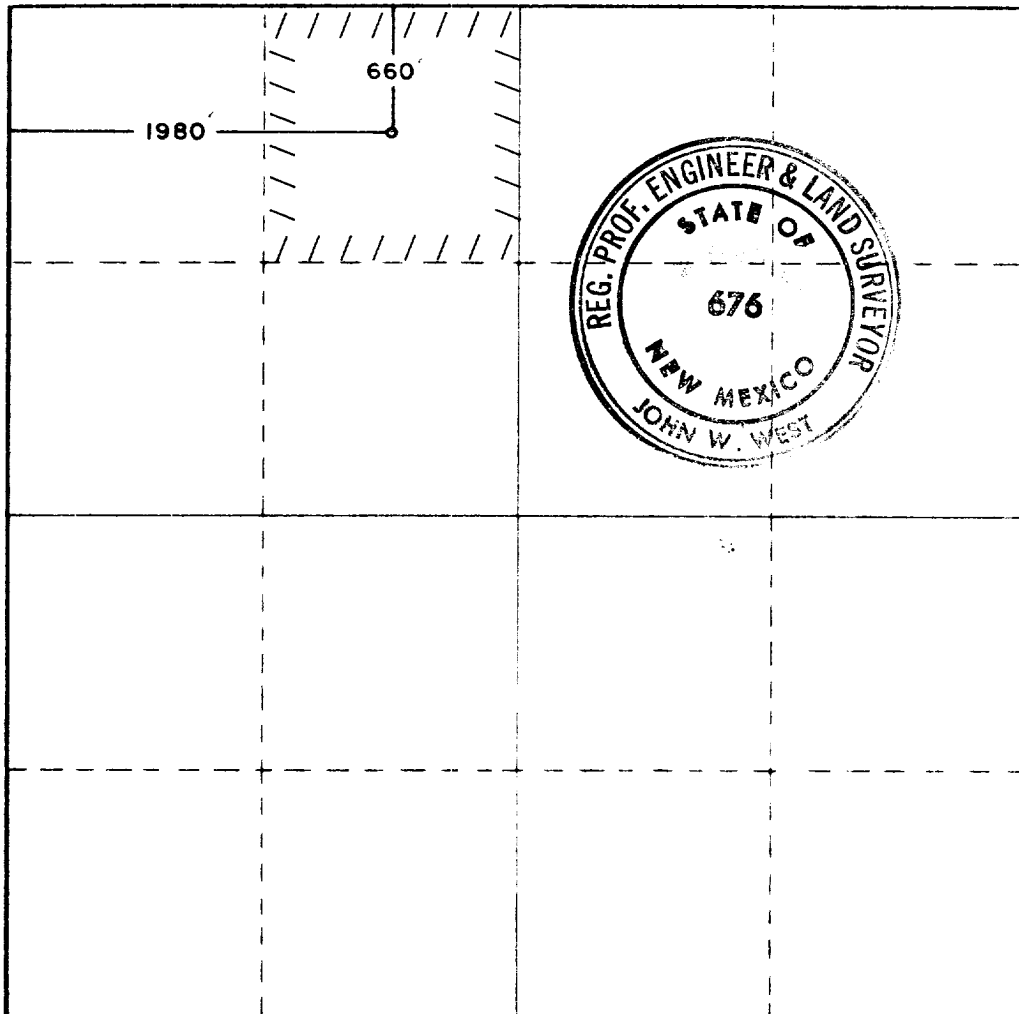

CERTIFICATION

I hereby certify that the information contained herein is true and complete to the best of my knowledge and belief.

R. E. Mathis

Name

R. E. Mathis

Position

Regulatory Coordinator

Company

Mesa Petroleum Co.

Date

10-21-81

I hereby certify that the well location shown on this plat was plotted from field notes of actual surveys made by me or under my supervision, and that the same is true and correct to the best of my knowledge and belief.

Date Surveyed

10-10-81

Registered Professional Engineer and Land Surveyor

John W. West

Certificate No. **JOHN W. WEST 676**
PATRICK A. ROMERO 6865
Ronald J. Eidson 3239

