

STATE OF NEW MEXICO
ENERGY AND MINERALS DEPARTMENT

OIL CONSERVATION DIVISION

Form C-103
Revised 10-1

NO. OF COPIES RECEIVED	5
DISTRIBUTION	
SANTA FE	1
FILE	1
U.S.G.S.	
LAND OFFICE	
OPERATOR	1

P. O. BOX 2082
SANTA FE, NEW MEXICO 87501

JUN 4 1982

O. C. D.
ARTESIA, OFFICE

59. Indicate Type of Lease
State Fee

5. State Oil & Gas Lease No.
LG-8091

SUNDRY NOTICES AND REPORTS ON WELLS

(DO NOT USE THIS FORM FOR PROPOSALS TO DRILL OR TO DEEPEN OR PLUG BACK TO A DIFFERENT RESERVOIR. USE "APPLICATION FOR PERMIT" (FORM C-101) FOR SUCH PROPOSALS.)

1. OIL WELL GAS WELL OTHER

2. Name of Operator
Rault Petroleum Corporation

3. Address of Operator
103 N. Pennsylvania, Roswell, New Mexico 88201

4. Location of Well
UNIT LETTER J 1980 FEET FROM THE South LINE AND 1980 FEET FROM East
TOWNSHIP 2 RANGE R19E

7. Unit Agreement Name

8. Farm or Lease Name
Armstrong State

9. Well No.
1

10. Field and Pool, or Wildcat
Wildcat ABO

12. County
Lincoln

15. Elevation (Show whether DP, RT, GR, etc.)
3950' grd

Check Appropriate Box To Indicate Nature of Notice, Report or Other Data
NOTICE OF INTENTION TO:

PERFORM REMEDIAL WORK

TEMPORARILY ABANDON

PULL OR ALTER CASING

OTHER

PLUG AND ABANDON

CHANGE PLANS

OTHER

REMEDIAL WORK

COMMENCE DRILLING OPNS.

CASING TEST AND CEMENT JOBS

OTHER

ALTERING CASING

PLUG AND ABANDONMENT

17. Describe Proposed or Completed Operations (Clearly state all pertinent details, and give pertinent dates, including estimated date of starting any proposed work) SEE RULE 1103.

After testing water from the ABO perforations 2590-94; 2680-86 feet; 2750-86 feet, June 2, 1982. We have decided to suspend completion operations and await further development in the area.

18. I hereby certify that the information above is true and complete to the best of my knowledge and belief.

SIGNED Jim W. Vidrine TITLE Manager DATE June 3, 1982

APPROVED BY [Signature] TITLE OIL AND GAS INSPECTOR DATE JUN 8 1982

CONDITIONS OF APPROVAL, IF ANY:

OIL CONSERVATION DIVISION
P. O. BOX 2088
SANTA FE, NEW MEXICO 87501

NO. OF COPIES RECEIVED	5
DISTRIBUTION	
JANITOR	1
FILE	1
U.S.O.S.	
LAND OFFICE	
OPERATOR	1

RECEIVED

APR 29 1982

4a. Indicate Type of Lease
State For

5. State Oil & Gas Lease No.
LG 8091

SUNDRY NOTICES AND REPORTS ON WELLS
DO NOT USE THIS FORM FOR PROPOSALS TO DRILL OR TO DEEPEN OR PLUG BACK TO A DIFFERENT RESERVOIR.
USE APPLICATION FOR PERMIT - C-101 (FORM C-101) FOR SUCH PROPOSALS.

O.C.D.
ARTESIA, OFFICE

1. OIL WELL GAS WELL OTHER

2. Name of Operator
Rault Petroleum Corporation

3. Address of Operator
103 North Pennsylvania, Roswell, New Mexico 88201

4. Location of Well
UNIT LETTER J 1980 FEET FROM THE South LINE AND 1980 FEET FROM THE East LINE, SECTION 2 TOWNSHIP 3S RANGE 19E

7. Unit Agreement Name

8. Farm or Lease Name
Armstrong State

9. Well No.
1

10. Field and Pool, or Wildcat
Wildcat Area

12. County
Lincoln

15. Elevation (Show whether DF, RT, CR, etc.)
3950' grd.

Check Appropriate Box To Indicate Nature of Notice, Report or Other Data

NOTICE OF INTENTION TO:

PERFORM REMEDIAL WORK

TEMPORARILY ABANDON

PULL OR ALTER CASING

OTHER

PLUG AND ABANDON

CHANGE PLANS

SUBSEQUENT REPORT OF:

REMEDIAL WORK

COMMENCE DRILLING OPNS.

CASING TEST AND CEMENT JOBS

OTHER

ALTERING CASING

PLUG AND ABANDONMENT

17. Describe Proposed or Completed Operations (Clearly state all pertinent details, and give pertinent dates, including estimated date of starting any proposed work) SEE RULE 1103.

- 1) Commenced drilling 12 1/4" Hole, 12:45 am, 3/24/82.
- 2) Drilled to 860' with full returns.
- 3) Ran 20 joints of 8 5/8, 24# casing, cemented with 400 sx 50% pozmix, Class "C", 6% gel, 2% CaCl., followed with 150 sx Class "C", 2% CaCl., PD @ 3:15 pm, 3/15/82, circulated 60 sx excess cement. WOC 18 3/4 hours.
- 4) Tested 8 5/8: casing with 600 psi.
- 5) Drilled 7 7/8" hole to 3897'.
- 6) Ran open hole electric and porosity logs.
- 7) Ran 94 joints, 4 12", 10.5#, j-55, landed @ 3892, cemented with 950 sx, 50% pozmix, Class "C", PD @ 11 a.m. 3/30/82.

18. I hereby certify that the information above is true and complete to the best of my knowledge and belief.

SIGNED James Verdine TITLE Manager DATE 4-27-82

APPROVED BY Mike Walker TITLE OIL AND GAS INSPECTOR DATE MAY 3 1982

CONDITIONS OF APPROVAL, IF ANY:

STATE OF NEW MEXICO
ENERGY AND MINERALS DEPARTMENT

OIL CONSERVATION DIVISION
P. O. BOX 2088
SANTA FE, NEW MEXICO 87501

30-027-20017

Form C-101
Revised 10-1-78

NO. OF COPIES RECEIVED	
DISTRIBUTION	
SANTA FE	
FILE	
U.S.G.S.	
LAND OFFICE	
OPERATOR	

RECEIVED
FEB 11 1982

O. C. D.
ARTESIA, OFFICE

5A. Indicate Type of Lease
STATE FCC

5. State Oil & Gas Lease No.
LG 8091

APPLICATION FOR PERMIT TO DRILL, DEEPEN, OR PLUG BACK

1a. Type of Work
b. Type of Well DRILL DEEPEN PLUG BACK
OIL WELL GAS WELL OTHER SINGLE ZONE MULTIPLE ZONE

2. Name of Operator
Rault Petroleum Corporation

3. Address of Operator
808 W. Missouri, Midland, Texas 79701

4. Location of Well
UNIT LETTER T LOCATED 1980 FEET FROM THE South LINE
AND 1980 FEET FROM THE East LINE OF SEC. 2 TWP. T3S REC. R19E NMPM

7. Unit Agreement Name
ARMSTRONG STATE

8. Farm or Lease Name
Armstrong State

9. Well No.
1

10. Field and Pool, or Wildcat
Wildcat 26-0

12. County
Lincoln

19. Proposed Depth
3950'

19A. Formation
ABO

20. Rotary or C.T.
RT

21. Elevations (Show whether DF, KT, etc.)
4878gr.

21A. Kind & Status Plug. Bond
\$50,000.00 Plugging

21B. Drilling Contractor
Rault Drilling Co.

22. Approx. Date Work will start
March 1982

PROPOSED CASING AND CEMENT PROGRAM

SIZE OF HOLE	SIZE OF CASING	WEIGHT PER FOOT	SETTING DEPTH	SACKS OF CEMENT	EST. TOP
12 1/4"	8-5/8"	24#	850'	1050	surface
7-7/8"	4 1/2"	10.5#	3950'	1000	1400

Rault Petroleum will move in Rotary tools, drill 12 1/2" surface hole, run 8-5/8" casing with proper float equipment, attempt to circulate cement to surface, if not successful, cement with 1" Kobe side string to circulate cement to surface, WOC 12 hours, nipple up 10"-900 double pipe preventer, test casing and BOP to 800psi, drill 7-7/8" hole to TD, Run open hole logs, run 4 1/2" casing to TD, cement casing with enough cement fill-up to circulate to surface casing.

ACREAGE NOT DEDICATED

APPROVAL VALID FOR 180 DAYS
PERMIT EXPIRES 8-18-82
UNLESS DRILLING UNDERWAY

Pat & M. B. B. B.
API & M. B. B. B.
2-19-82

IN ABOVE SPACE DESCRIBE PROPOSED PROGRAM; IF PROPOSAL IS TO DEEPEN OR PLUG BACK, GIVE DATA ON PRESENT PRODUCTIVE ZONE AND PROPOSED NEW PRODUCTIVE ZONE. GIVE BLOWOUT PREVENTER PROGRAM, IF ANY.

I hereby certify that the information above is true and complete to the best of my knowledge and belief.

Signed Miss Vidar Title Manager Date Feb. 10, 1982

(This space for State Use)

APPROVED BY M. Williams TITLE OIL AND GAS INSPECTOR DATE FEB 18 1982

CONDITIONS OF APPROVAL, IF ANY:

All distances must be from the outer boundaries of the Section.

Operator Rault Petroleum Corp.		Lease Armstrong State		Well No. #1
Unit Letter J	Section 2	Township 3 South	Range 19 East	County Lincoln
Actual Footage Location of Well: 1980 feet from the South line and 1980 feet from the East line				
Ground Level Elev. 4878	Producing Formation ABC	Pool Wildcat	Dedicated Acreage: 160 Acres	

1. Outline the acreage dedicated to the subject well by colored pencil or hachure marks on the plat below.
2. If more than one lease is dedicated to the well, outline each and identify the ownership thereof (both as to working interest and royalty).
3. If more than one lease of different ownership is dedicated to the well, have the interests of all owners been consolidated by communitization, unitization, force-pooling, etc?

Yes No If answer is "yes," type of consolidation _____

If answer is "no," list the owners and tract descriptions which have actually been consolidated. (Use reverse side of this form if necessary.) _____

No allowable will be assigned to the well until all interests have been consolidated (by communitization, unitization, forced-pooling, or otherwise) or until a non-standard unit, eliminating such interests, has been approved by the Division.

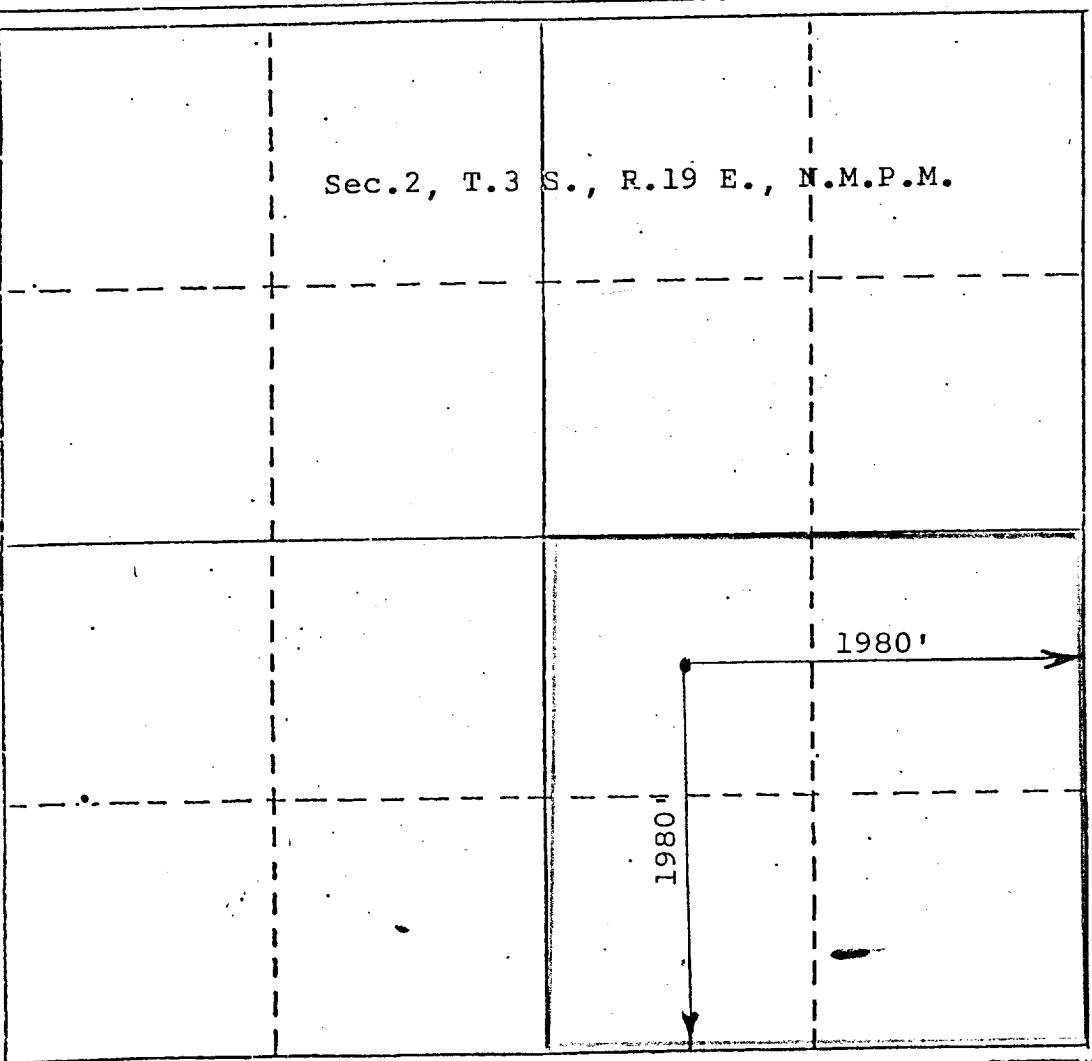

CERTIFICATION

I hereby certify that the information contained herein is true and complete to the best of my knowledge and belief.

Name
J. W. VORINE

Position
MANAGER

Company
Rault Petro. Corp.

Date
FEB 11, 1982

I hereby certify that the well location shown on this plat was plotted from field notes of actual surveys made by me or under my supervision, and that the same is true and correct to the best of my knowledge and belief.

Date Surveyed
February 8, 1982

Registered Professional Engineer and/or Land Surveyor
John D. Jaquess

Certificate No. **6290**

