

UNITED STATES  
DEPARTMENT OF THE INTERIOR  
GEOLOGICAL SURVEY

30-027-20027

5. LEASE DESIGNATION AND SERIAL NO.

NM-39755

6. IF INDIAN, ALLOTTEE OR TRIBE NAME

7. UNIT AGREEMENT NAME

8. FARM OR LEASE NAME

Boggle "ZH" Federal

9. WELL NO.

1

10. FIELD AND POOL, OR WILDCAT

Wildcat-Pre-Cambrian

11. SEC., T., R., M., OR BLK.  
AND SURVEY OR AREA

Sec. 25-T4S-R14E

12. COUNTY OR PARISH

Lincoln

13. STATE

NM

## APPLICATION FOR PERMIT TO DRILL, DEEPEN OR PLUG BACK

1a. TYPE OF WORK

DRILL ☒DEEPEN ☐OIL & GAS PLUG BACK ☐

b. TYPE OF WELL

OIL  
WELL ☐GAS  
WELL ☒

OTHER

SINGLE ☒ MULTIPLE ☐  
ROSWELL, NEW MEXICO

2. NAME OF OPERATOR

Yates Petroleum Corporation

3. ADDRESS OF OPERATOR

207 S. 4th, Artesia, New Mexico 88210

4. LOCATION OF WELL (Report location clearly and in accordance with any State regulations)  
At surface

1780' FNL and 1980' FEL

At proposed prod. zone

same

14. DISTANCE IN MILES AND DIRECTION FROM NEAREST TOWN OR POST OFFICE

Approximately 27 miles SE of Corona, New Mexico.

15. DISTANCE FROM PROPOSED\*

LOCATION TO NEAREST

PROPERTY OR LEASE LINE, FT.

(Also to nearest drlg. unit line, if any)

1780'

16. NO. OF ACRES IN LEASE

1840'

17. NO. OF ACRES ASSIGNED

160

18. DISTANCE FROM PROPOSED LOCATION\*

TO NEAREST WELL, DRILLING, COMPLETED,  
OR APPLIED FOR, ON THIS LEASE, FT.

19. PROPOSED DEPTH

1800'

20. ROTARY OR CABLE TOOLS

Rotary

21. ELEVATIONS (Show whether DF, RT, GR, etc.)

6014' GL

22. APPROX. DATE WORK WILL START\*

ASAP

23.

## PROPOSED CASING AND CEMENTING PROGRAM

SIZE OF HOLE	SIZE OF CASING	WEIGHT PER FOOT	SETTING DEPTH	QUANTITY OF CEMENT
17 1/2"	13 3/8"	48# J-55	300'	700 sx circ
7 7/8"	4 1/2"	9.5# J-55	TD	550 sx circ

We propose to drill and test the Pre-Cambrian and intermediate formations. Approximately 300' of surface casing will be set and cement circulated to shut off gravel and caving. If needed (lost circulation) 9 5/8" intermediate casing will be run to 1300' and cemented with enough cement calculated to tie back into the surface casing. If commercial, production casing will be run and cemented with adequate cover, perforate and stimulate as needed for production.

MUD PROGRAM: FW gel/LCM to 700', Brine to 1700'.

BOP PROGRAM: BOP's will be installed at the offset and tested daily.

GAS NOT DEDICATED.

IN ABOVE SPACE DESCRIBE PROPOSED PROGRAM: If proposal is to deepen or plug back, give data on present productive zone and proposed new productive zone. If proposal is to drill or deepen directionally, give pertinent data on subsurface locations and measured and true vertical depths. Give blowout preventer program, if any.

24.

SIGNED

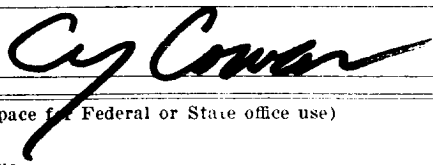

TITLE

Regulatory Agent

DATE

3/30/84

(This space for Federal or State office use)

PERMIT NO.

APPROVAL DATE

S/Phil Kirk

APPROVED BY

TITLE



DATE

4-25-84

CONDITIONS OF APPROVAL, IF ANY:

Post. A.P.D.  
10-10 2/3 Bk.  
5-4-84

NEW MEXICO OIL CONSERVATION COMMISSION  
WELL LOCATION AND ACREAGE DEDICATION PLAT

Form C-102  
Supersedes C-128  
Effective 1-1-65

All distances must be from the outer boundaries of the Section

Operator <b>YATES PETROLEUM CORPORATION</b>			Lease <b>Boggle "ZH" Federal</b>		Well No. <b>1</b>
Unit Letter <b>G</b>	Section <b>25</b>	Township <b>4 South</b>	Range <b>14 East</b>	County <b>Lincoln</b>	

Actual Footage Location of Well:

**1780** feet from the **North** line and **1980** feet from the **East** line

Ground Level Elev. <b>6014'</b>	Producing Formation <b>Pre Cambrian</b>	Pool <b>Wildcat</b>	Dedicated Acreage: <b>160</b> Acres
------------------------------------	--	------------------------	--

1. Outline the acreage dedicated to the subject well by colored pencil or hachure marks on the plat below.
2. If more than one lease is dedicated to the well, outline each and identify the ownership thereof (both as to working interest and royalty).
3. If more than one lease of different ownership is dedicated to the well, have the interests of all owners been consolidated by communitization, unitization, force-pooling, etc?

☐ Yes ☒ No If answer is "yes," type of consolidation \_\_\_\_\_

If answer is "no," list the owners and tract descriptions which have actually been consolidated. (Use reverse side of this form if necessary.) \_\_\_\_\_

No allowable will be assigned to the well until all interests have been consolidated (by communitization, unitization, forced-pooling, or otherwise) or until a non-standard unit, eliminating such interests, has been approved by the Commission.

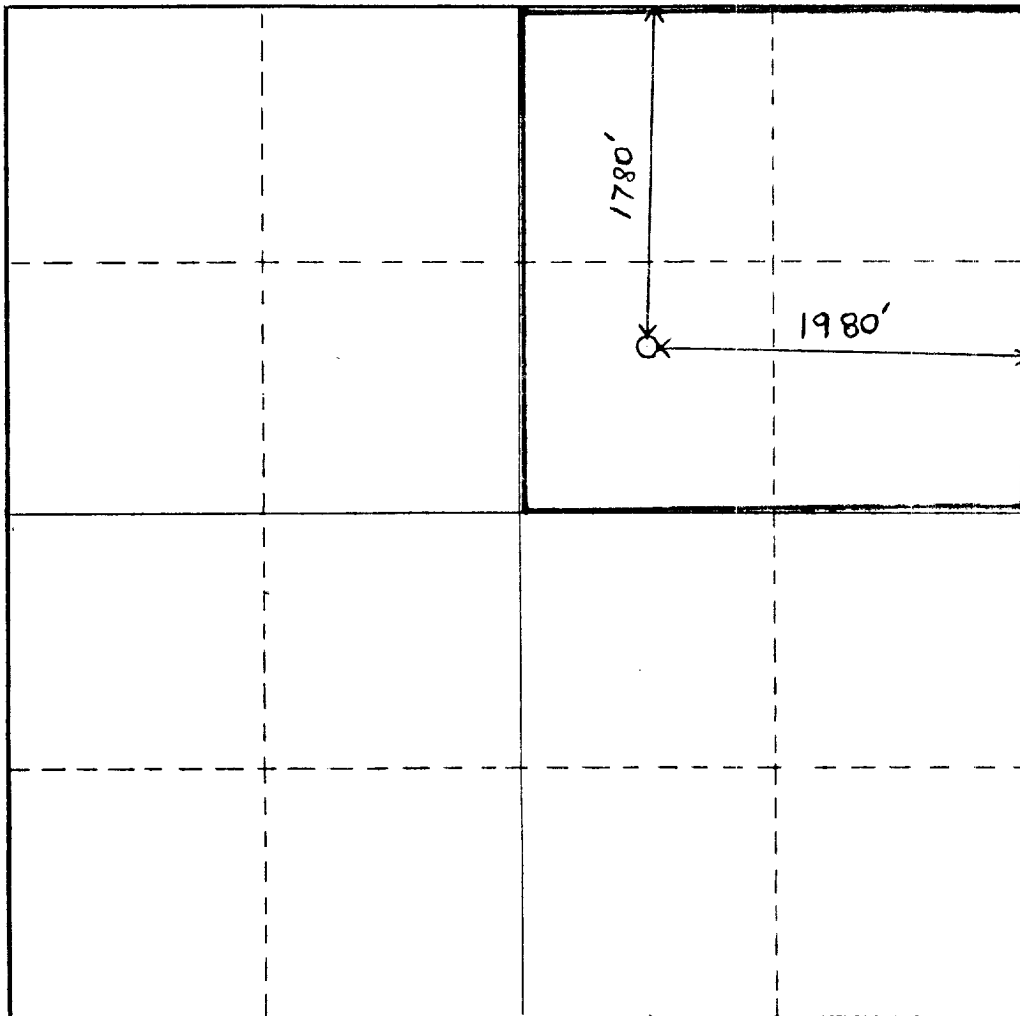

CERTIFICATION

I hereby certify that the information contained herein is true and complete to the best of my knowledge and belief.

*Cy Cowan*

Name

Cy Cowan

Position

Regulatory Agent

Company

Yates Petroleum Corp.

Date

3/30/84

I hereby certify that the well location shown on this plat was plotted from field notes of actual surveys made by me or under my supervision, and that the same is true and correct to the best of my knowledge and belief.

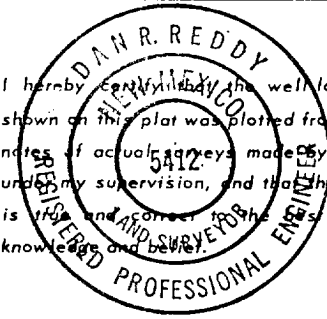

Date Surveyed

March 9, 1984

Registered Professional Engineer and/or Land Surveyor

*Dan R. Reddy*

Certificate No.

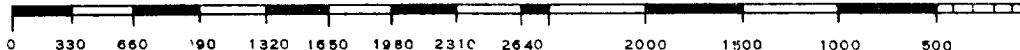

# EXHIBIT B

## BOP DIAGRAM

RATED 3000<sup>#</sup>

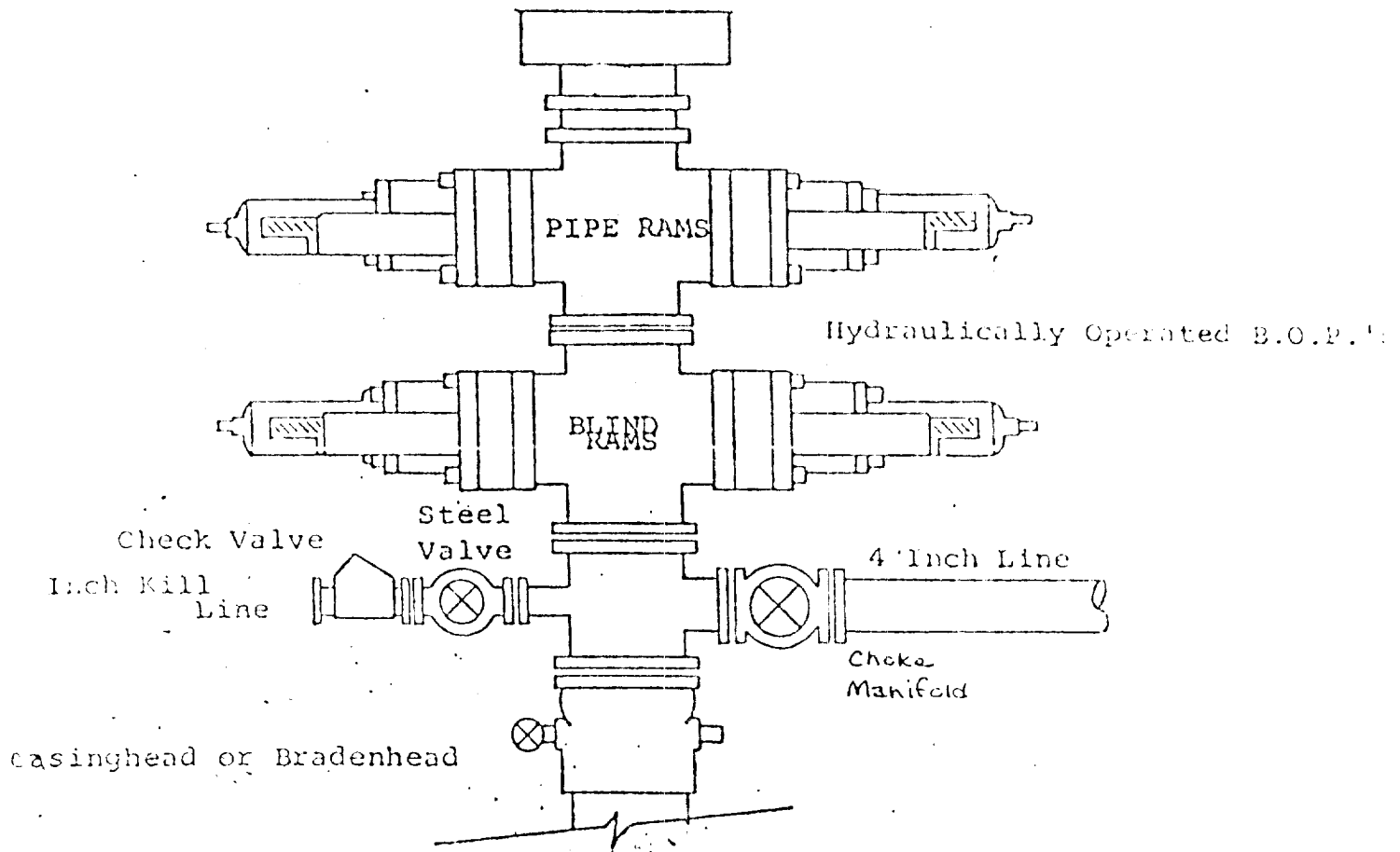

YATES PETROLEUM CORPORATION  
Boggle "ZH" Federal #1  
1780' FNL and 1980' FEL  
Sec. 25-T4S-R14E

In conjunction with Form 9-331C, Application for Permit to Drill subject well, Yates Petroleum Corporation submits the following ten items of pertinent information in accordance with BLM requirements.

1. The geologic surface formation is sandy alluvium.
2. The estimated tops of geologic markers are as follows:

San Andres	surface
Glorieta	25'
Lower San Andres	85'
Lower Glorieta	160'
Yeso	205'
Pre-Cambrian	1210'
TD	1800'

3. The estimated depths at which anticipated water, oil or gas formations are expected to be encountered:

Water: none

Oil or Gas: Yeso formation

4. Proposed Casing Program: See Form 9-331C.
5. Pressure Control Equipment: See Form 9-331C.
6. Mud Program: See Form 9-331C.
7. Auxiliary Equipment: Kelly Cock; pit level indicators and flow sensor equipment; sub with full-opening valve on floor, drill pipe connection.
8. Testing, Logging and Coring Program:  
Samples: Surface casing to TD.  
DST's: As warranted.  
Coring: None.  
Logging: CNL-FDC TD to csg w/GR-CNL to surface DLL from TD to csg.
9. No abnormal pressures or temperatures are anticipated.
10. Anticipated starting date: As soon as possible after approval.

Bogle  
4Q

Bogle  
ZH 7ED #1

YATES Petroleum Corp  
Bogle 'ZH' 7ED #1  
1780' FNL + 1980' FEL  
SEC 25 T4S R4E  
Lincoln County  
Exhibit A'NM

YATES PETROLEUM CORP.  
Exhibit C

