

REC'D BY
DEC 11 1984
UNITED STATES
DEPARTMENT OF THE INTERIOR
GEOLOGICAL SURVEY
ARTESIA OFFICE

NEW OIL CONS. COMMISSION
Drawer DD
Artesia, NM 88210
SUBMIT IN LIGATE*
the sections on
reverse side)

Form approved.
Budget Bureau No. 42-R1425.

30-027-20031

5. LEASE DESIGNATION AND SERIAL NO.

NM-37148

6. IF INDIAN, ALLOTTEE OR TRIBE NAME

7. UNIT AGREEMENT NAME

8. FARM OR LEASE NAME

Hardstick "AAV" Federal

WELL NO.

9. FIELD AND POOL, OR WILDCAT

Wildcat - Abo

10. SEC., T., R., M., OR BLK.
AND SURVEY OR AREA

Section 27-T4S-R19E

12. COUNTY OR PARISH 13. STATE

Lincoln

NM

1a. TYPE OF WORK

DRILL ☒

DEEPEN ☐

PLUG BACK ☐

b. TYPE OF WELL

OIL WELL ☐

GAS WELL ☒

OTHER

SINGLE ZONE ☐

2. NAME OF OPERATOR

YATES PETROLEUM CORPORATION

3. ADDRESS OF OPERATOR

207 South Fourth Street, Artesia, New Mexico 88210

4. LOCATION OF WELL (Report location clearly and in accordance with any State requirements.)

At surface

1980' FNL and 1980' FWL

At proposed prod. zone

same

14. DISTANCE IN MILES AND DIRECTION FROM NEAREST TOWN OR POST OFFICE*

Approximately 34 miles northwest of Roswell, New Mexico.

15. DISTANCE FROM PROPOSED*

LOCATION TO NEAREST

PROPERTY OR LEASE LINE, FT.

(Also to nearest drlg. unit line, if any)

1980'

16. NO. OF ACRES IN LEASE

2560

18. DISTANCE FROM PROPOSED LOCATION*

TO NEAREST WELL, DRILLING, COMPLETED,

OR APPLIED FOR, ON THIS LEASE, FT.

19. PROPOSED DEPTH

4000'

17. NO. OF ACRES ASSIGNED TO THIS WELL

160

20. ROTARY OR CABLE TOOLS

Rotary

21. ELEVATIONS (Show whether DF, RT, GR, etc.)

4841' GL

22. APPROX. DATE WORK WILL START*

ASAP

23.

PROPOSED CASING AND CEMENTING PROGRAM

SIZE OF HOLE	SIZE OF CASING	WEIGHT PER FOOT	SETTING DEPTH	QUANTITY OF CEMENT
17 1/2"	13 3/8"	54.5# K-55	800'	700 sx circulated
7 7/8"	4 1/2"	10.5# K-55	TD	200 sx

We propose to drill and test the Abo and intermediate formations. Approximately 800' of surface casing will be set and cement circulated to shut off gravel and caving. If commercial, production casing will be run and cemented with adequate cover, perforated and stimulated as needed for production.

MUD PROGRAM: FW gel/LCM to 800', Brine to TD.

BOP PROGRAM: BOP's will be installed at the offset and tested daily.

GAS NOT DEDICATED.

IN ABOVE SPACE DESCRIBE PROPOSED PROGRAM: If proposal is to deepen or plug back, give data on present productive zone and proposed new productive zone. If proposal is to drill or deepen directionally, give pertinent data on subsurface locations and measured and true vertical depths. Give blowout preventer program, if any.

24.

SIGNED

Glenn Rodriguez

TITLE Regulatory Agent

DATE 12/12/84

(This space for Federal or State office use)

PERMIT NO.

APPROVAL DATE

APPROVED BY

S/Phil Kirk

TITLE

Area Manager

DATE

12-13-84

CONDITIONS OF APPROVAL, IF ANY:

NEW MEXICO OIL CONSERVATION COMMISSION
WELL LOCATION AND ACREAGE DEDICATION PLAT

Form C-102
Supersedes C-128
Effective 1-1-65

All distances must be from the outer boundaries of the Section.

Operator YATES PETROLEUM CORPORATION			Lease Yardstick AAV Federal		Well No. 1
Unit Letter F	Section 27	Township 4 South	Range 19 East	County Lincoln	
Actual Footage Location of Well: 1980 feet from the North line and 1980 feet from the West line					
Ground Level Elev. 4841'	Producing Formation ABO		Pool WILDCAT		Dedicated Acreage: 160 Acres

- Outline the acreage dedicated to the subject well by colored pencil or hachure marks on the plat below.
- If more than one lease is dedicated to the well, outline each and identify the ownership thereof (both as to working interest and royalty).
- If more than one lease of different ownership is dedicated to the well, have the interests of all owners been consolidated by communitization, unitization, force-pooling, etc?

☐ Yes ☐ No If answer is "yes," type of consolidation _____

If answer is "no," list the owners and tract descriptions which have actually been consolidated. (Use reverse side of this form if necessary.) _____

No allowable will be assigned to the well until all interests have been consolidated (by communitization, unitization, forced-pooling, or otherwise) or until a non-standard unit, eliminating such interests, has been approved by the Commission.

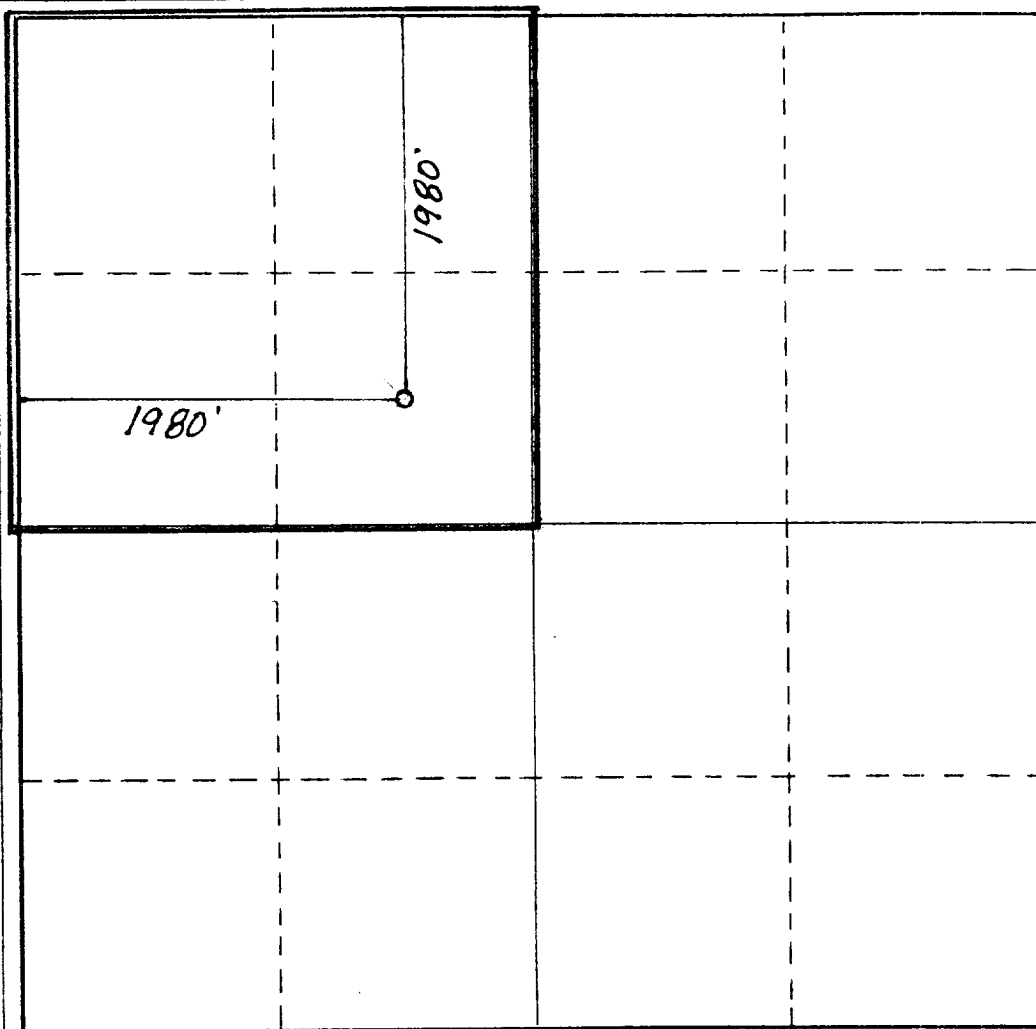

CERTIFICATION

I hereby certify that the information contained herein is true and complete to the best of my knowledge and belief.

Blisario Rodriguez
Name

BLISARIO RODRIGUEZ
Position

YATES PETROLEUM CORP.
Company

REG. AGT.

Date
12-12-84

I hereby certify that the well location shown on this plat was plotted from field notes of actual surveys made by me or under my supervision and that the same is true and correct to the best of my knowledge and belief.

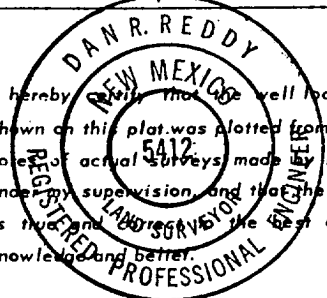

Date Surveyed

December 11, 1984

Registered Professional Engineer
and/or Land Surveyor

Dan R. Reddy
Certificate No.

NM PE&LS NO. 5412

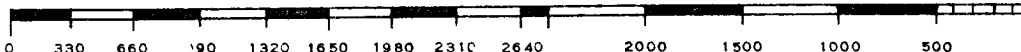

YATES PETROLEUM CORPORATION
Yardstick "AAV" Federal #1
1980' FNL and 1980' FWL
Section 27-T4S-R19E
Lincoln County, New Mexico

000' 10'

In conjunction with Form 9-331C, Application for Permit to Drill subject well, Yates Petroleum Corporation submits the following ten items of pertinent information in accordance with BLM requirements.

1. The geologic surface formation is San Andres.
2. The estimated tops of geologic markers are as follows:

San Andres	Surface
Glorieta	670'
Yeso	800'
U. Clearfork	1175'
Tubb	1860'
Abo	2260'
Penn	3135'
Pre-Cambrian	3560'
TD	approx. 4050'

3. The estimated depths at which anticipated water, oil or gas formations are expected to be encountered:

Water: appr. 250-350'
Oil or Gas: Abo 2100'; Penn 3160'

4. Proposed Casing Program: See Form 9-331C.
5. Pressure Control Equipment: See Form 9-331C and Exhibit B.
6. Mud Program: See Form 9-331C.
7. Auxiliary Equipment: Kelly Cock; pit level indicators and flow sensor equipment; sub with full-opening valve on floor, drill pipe connection.

8. Testing, Logging and Coring Program:

Samples: 10' samples caught out from under surface casing to TD.
DST's: As warranted.
Coring: None
Logging: CNL-FDC TD to csg w/GR-CNL to surface & DLL w/RxO from TD to csg.
EPT-TD to csg.
Mud Logging: One man unit from surface to TD.

9. No abnormal pressures or temperatures are anticipated.
10. Anticipated starting date: As soon as possible after approval

EXHIBIT B

BDP DIAGRAM

RATED 3000[#]

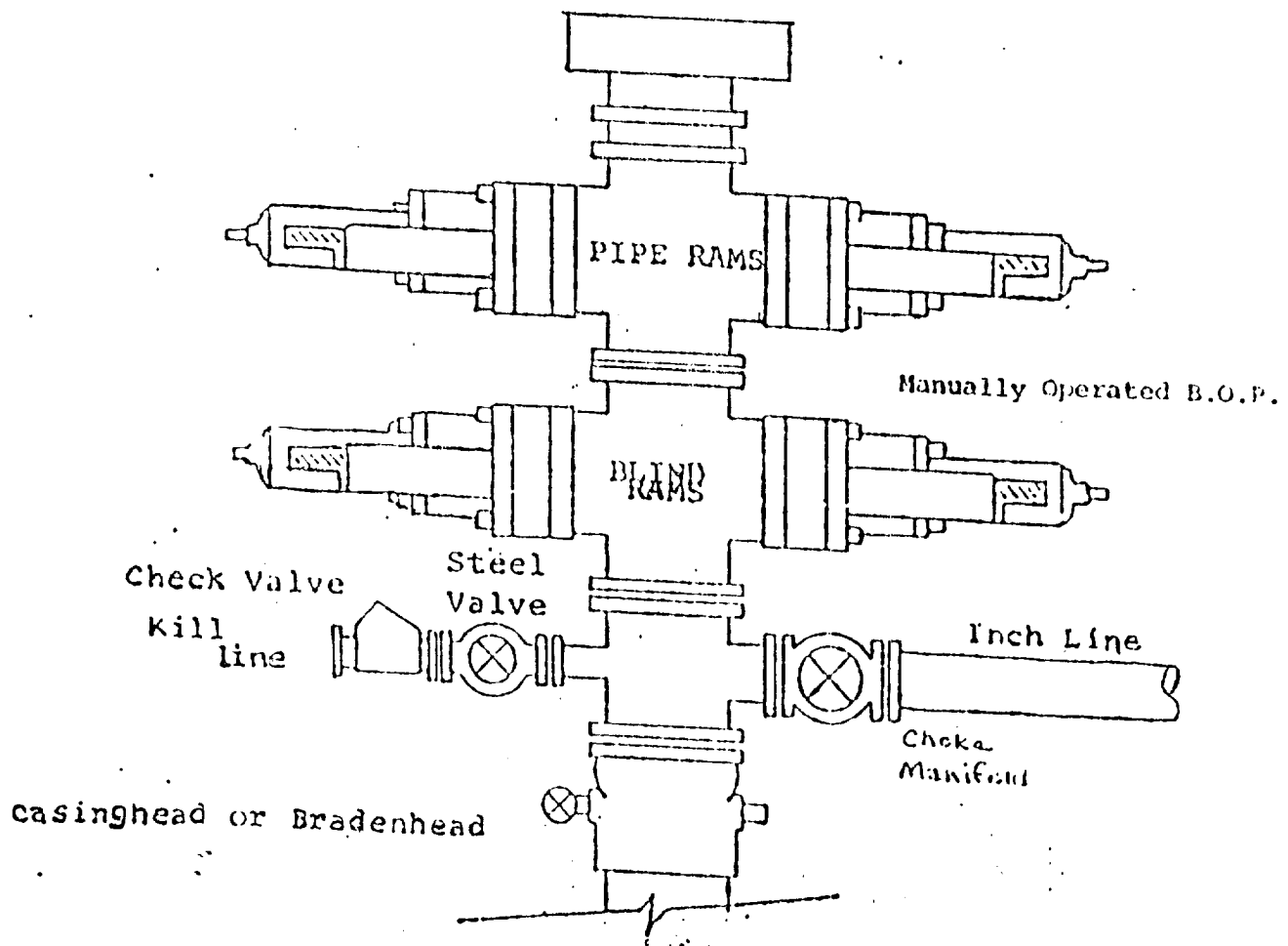

YATES PETROLEUM CORP.

Exhibit C

Reserve Pit
Bottom to be at
ground level to
1 ft.

