

NUMBER OF COPIES RECEIVED	
DISTRIBUTION	
SANTA FE	1
FILE	1
U.S.G.S.	2
LAND OFFICE	1
TRANSPORTER	OIL
	GAS
PRODUCTION OFFICE	
OPERATOR	

NEW MEXICO OIL CONSERVATION COMMISSION  
Santa Fe, New Mexico

Form C-101  
Revised (12/1/55)

NOTICE OF INTENTION TO DRILL

Notice must be given to the District Office of the Oil Conservation Commission and approval obtained before drilling or recompletion begins. If changes in the proposed plan are considered advisable, a copy of this notice showing such changes will be returned to the sender. Submit this notice in QUINTUPLICATE. One copy will be returned following approval. See additional instructions in Rules and Regulations of the Commission. If State Land submit 6 Copies Attach Form C-128 in triplicate to first 3 copies of form C-101

Hobbs, New Mexico  
(Place)

RECEIVED  
November 27, 1963  
(Date)  
DEC 2 1963

OIL CONSERVATION COMMISSION  
SANTA FE, NEW MEXICO

Gentlemen:

You are hereby notified that it is our intention to commence the Drilling of a well to be known as

Shelly Oil Company  
(Company or Operator)

New Mexico "C"  
(Lease)

Well No. 1-A, in "0" (Unit) The well is

located 560 feet from the South line and 1900 feet from the East line of Section 19, T. 28-S, R. 5-W, NMPM.

(GIVE LOCATION FROM SECTION LINE) Wildest Pool, Luna County

If State Land the Oil and Gas Lease is No. E - 9601 - 4

If patented land the owner is

Address

We propose to drill well with drilling equipment as follows: To be drilled with rotary tools from surface to total depth.

The status of plugging bond is Blanket Bond No. 1253622 for \$100,000.00 with Federal Insurance Company.

Drilling Contractor Parker Drilling Company  
Tulsa, Oklahoma

We intend to complete this well in the Permian formation at an approximate depth of 10,250 feet.

CASING PROGRAM

We propose to use the following strings of Casing and to cement them as indicated:

Size of Hole	Size of Casing	Weight per Foot	New or Second Hand	Depth	Sacks Cement
26"	20"	56.04	New	21'	50
17-1/2"	13-3/8"	48	New	1000'	1000
12-1/4"	9-5/8"	36	New	5000'	250
8-3/4"	5-1/2"	15.54 & 17	New	10250'	900

If changes in the above plans become advisable we will notify you immediately.

ADDITIONAL INFORMATION (If recompletion give full details of proposed plan of work.) The pump & plug process will be used in cementing all strings of casing & cement will be circulated to surface on the 13-3/8" OD casing. The 5-1/2" OD casing will be set at 10,250' and will be cemented with a sufficient amount of cement to cover any pay zones encountered up the hole. Air will be used for the circulating media from 450' to TD if possible. The 5-1/2" OD casing will be perforated & treated with approximately 2,000 gallons of Acid.

Approved: \_\_\_\_\_, 19\_\_\_\_  
Except as follows: DEC 2 1963

Sincerely yours,

Shelly Oil Company  
(Company or Operator)

By: (ORIGINAL) H. E. Ash

Position: Dist. Supt.

Send Communications regarding well to

Name: Shelly Oil Company

Address: Box 720 - Hobbs, New Mexico

OIL CONSERVATION COMMISSION

By: M. L. Armstrong

NEW MEXICO OIL CONSERVATION COMMISSION  
WELL LOCATION AND ACREAGE DEDICATION PLAT

FORM C-128  
Revised 5/1/57

SEE INSTRUCTIONS FOR COMPLETING THIS FORM ON THE REVERSE SIDE

SECTION A

Operator <b>SKELLY OIL COMPANY</b>		Lease <b>NEW MEXICO "C"</b>		Well No. <b>1A</b>	
U.S. Lot <b>0</b>	Section <b>19</b>	Township <b>28 SOUTH</b>	Range <b>5 WEST</b>	County <b>LIWA</b>	
Actual Postage Location of Well: <b>560</b> feet from the <b>SOUTH</b> line and <b>1980</b> feet from the <b>WEST</b> line					
Ground Level Elev. <b>4009.7</b>	Producing Formation <b>Precambrian</b>		Pool <b>Wildcat</b>	Dedicated Acreage: <b>40</b> Acres	

1. Is the Operator the only owner in the dedicated acreage outlined on the plat below? YES ☒ NO \_\_\_\_ . ("Owner" means the person who has the right to drill into and to produce from any pool and to appropriate the production either for himself or for himself and another. (65-3-29 (e) NMSA 1955 Comp.)
2. If the answer to question one is "no," have the interests of all the owners been consolidated by communitization agreement or otherwise? YES \_\_\_\_ NO \_\_\_\_ . If answer is "yes," Type of Consolidation \_\_\_\_
3. If the answer to question two is "no," list all the owners and their respective interests below:

Owner	Land Description

SECTION B

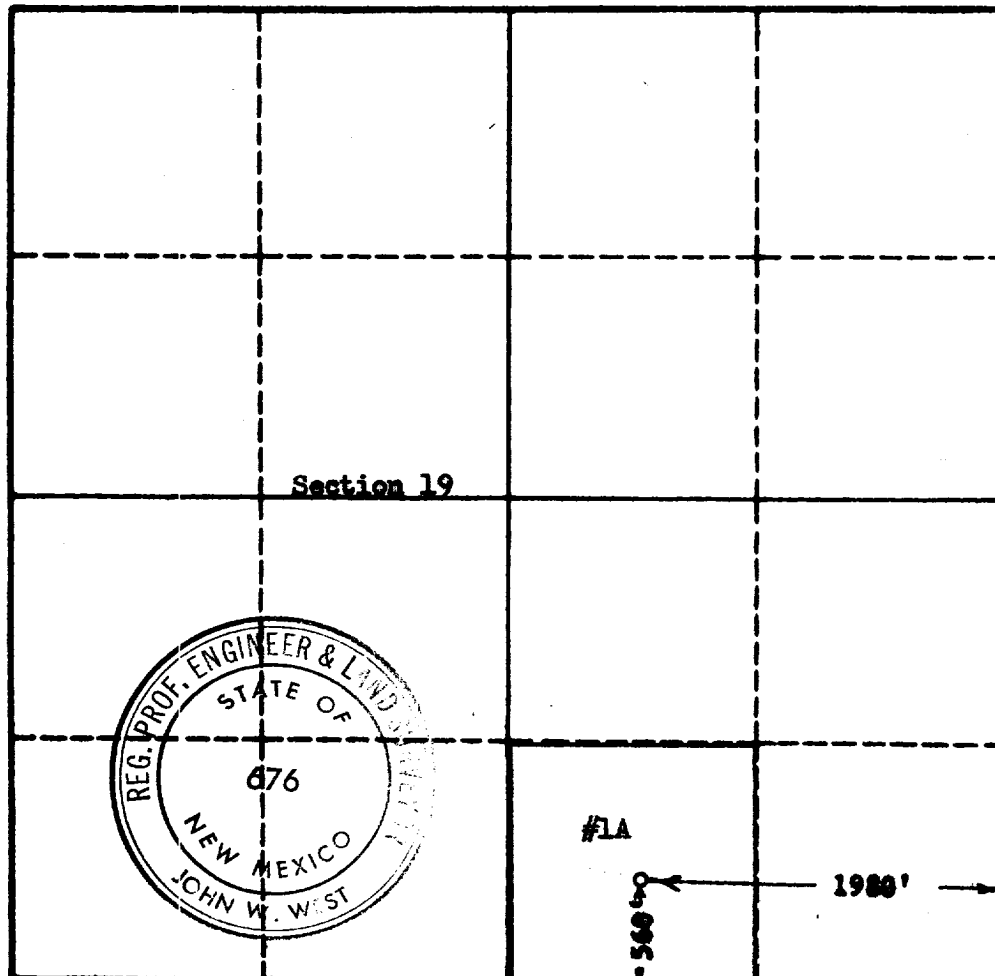

CERTIFICATION

I hereby certify that the information in SECTION A above is true and complete to the best of my knowledge and belief.

Name (ORIGINAL SIGNED) **H. E. Ash**  
Position **Dist. Supt.**  
Company **Skelly Oil Company**  
Date **November 27, 1963**

I hereby certify that the well location shown on the plat in SECTION B was plotted from field notes of actual surveys made by me or under my supervision, and that the same is true and correct to the best of my knowledge and belief.

Date Surveyed **OCTOBER 25, 1963**  
Registered Professional Engineer and/or Land Surveyor, **JOHN W. WEST**  
*John W. West*  
Certificate No. **N.M. - P.E. & L.S. NO. 676**