

NO. OF COPIES RECEIVED	6
DISTRIBUTION	
SANTA FE	
FILE	
U.S.G.S.	
LAND OFFICE	
OPERATOR	

NEW MEXICO CONSERVATION COMMISSION

OCT 3 1969

O. C. C.
ARTEZIA. OFFICE

30-029-20001
Form C-101
Revised 1-1-65

5A. Indicate Type of Lease
STATE <input checked="" type="checkbox"/> FEE <input type="checkbox"/>
5. State Oil & Gas Lease No.
1349

APPLICATION FOR PERMIT TO DRILL, DEEPEN, OR PLUG BACK

1a. Type of Work		7. Unit Agreement Name	
b. Type of Well DRILL <input checked="" type="checkbox"/> DEEPEN <input type="checkbox"/> PLUG BACK <input type="checkbox"/> OIL WELL <input type="checkbox"/> GAS WELL <input type="checkbox"/> OTHER Wildcat SINGLE ZONE <input type="checkbox"/> MULTIPLE ZONE <input type="checkbox"/>		8. Farm or Lease Name SL 1349 (7)	
2. Name of Operator COCKRELL CORPORATION		9. Well No. 1	
3. Address of Operator Suite 999, The Main Building, Houston, Texas 77002		10. Field and Pool, or Wildcat Wildcat	
4. Location of Well UNIT LETTER <u>E</u> LOCATED <u>1,500</u> FEET FROM THE <u>N</u> LINE. AND <u>700</u> FEET FROM THE <u>W</u> LINE OF SEC. <u>7</u> TWP. <u>23S</u> RGE. <u>10W</u> NMPM		12. County Luna	
19. Proposed Depth 8,000'		19A. Formation Pre-Cambrian	
20. Rotary or C.T. Rotary		21. Elevations (Show whether DF, RT, etc.)	
21A. Kind & Status Plug. Bond General		21B. Drilling Contractor Delta Drilling Co.	
22. Approx. Date Work will start 10-5-69			

23.

PROPOSED CASING AND CEMENT PROGRAM

SIZE OF HOLE	SIZE OF CASING	WEIGHT PER FOOT	SETTING DEPTH	SACKS OF CEMENT	EST. TOP
12-1/4"	9-5/8"	36	2,000'	700	Surface
8-3/4"	5-1/2 or 7"	17 or 23	8,000'	500	7,000'

Blow out preventers will be installed after setting 9-5/8" surface casing.

APPROVAL VALID
FOR 90 DAYS UNLESS
DRILLING COMMENCED,
EXPIRES 1-3-70

IN ABOVE SPACE DESCRIBE PROPOSED PROGRAM: IF PROPOSAL IS TO DEEPEN OR PLUG BACK, GIVE DATA ON PRESENT PRODUCTIVE ZONE AND PROPOSED NEW PRODUCTIVE ZONE. GIVE BLOWOUT PREVENTER PROGRAM, IF ANY.

I hereby certify that the information above is true and complete to the best of my knowledge and belief.

Signed H.E. Turckley Title Manager of Drilling & Production Date OCT 1 1969

(This space for State Use)

APPROVED BY W.A. Gussess TITLE OIL AND GAS INSPECTOR DATE OCT 3 1969

CONDITIONS OF APPROVAL, IF ANY: The NSL must be approved prior to assigning an allowable.

Declaré Water Basin
Members Basin

Cement must be circulated to
surface behind 9 5/8" casing

NEW MEXICO OIL CONSERVATION COMMISSION
WELL LOCATION AND ACREAGE DEDICATION PLAT

Form C-102
 Supersedes C-128
 Effective 1-1-65

All distances must be from the outer boundaries of the Section.

Operator COCKRELL CORPORATION			Lease SL 1349		Well No. 1
Unit Letter E	Section 7	Township 35S 23S	Range 10W	County Luna	
Actual Footage Location of Well: 700 feet from the W line and 1,500 feet from the N line					
Ground Level Elev:	Producing Formation Wildcat	Pool Wildcat	Dedicated Acreage: 80 40 Acres		

1. Outline the acreage dedicated to the subject well by colored pencil or hatchure marks on the plat below.
2. If more than one lease is dedicated to the well, outline each and identify the ownership thereof (both as to working interest and royalty).
3. If more than one lease of different ownership is dedicated to the well, have the interests of all owners been consolidated by communitization, unitization, force-pooling, etc?

☐ Yes ☐ No If answer is "yes," type of consolidation _____

If answer is "no," list the owners and tract descriptions which have actually been consolidated. (Use reverse side of this form if necessary.) _____

No allowable will be assigned to the well until all interests have been consolidated (by communitization, unitization, forced-pooling, or otherwise) or until a non-standard unit, eliminating such interests, has been approved by the Commission.

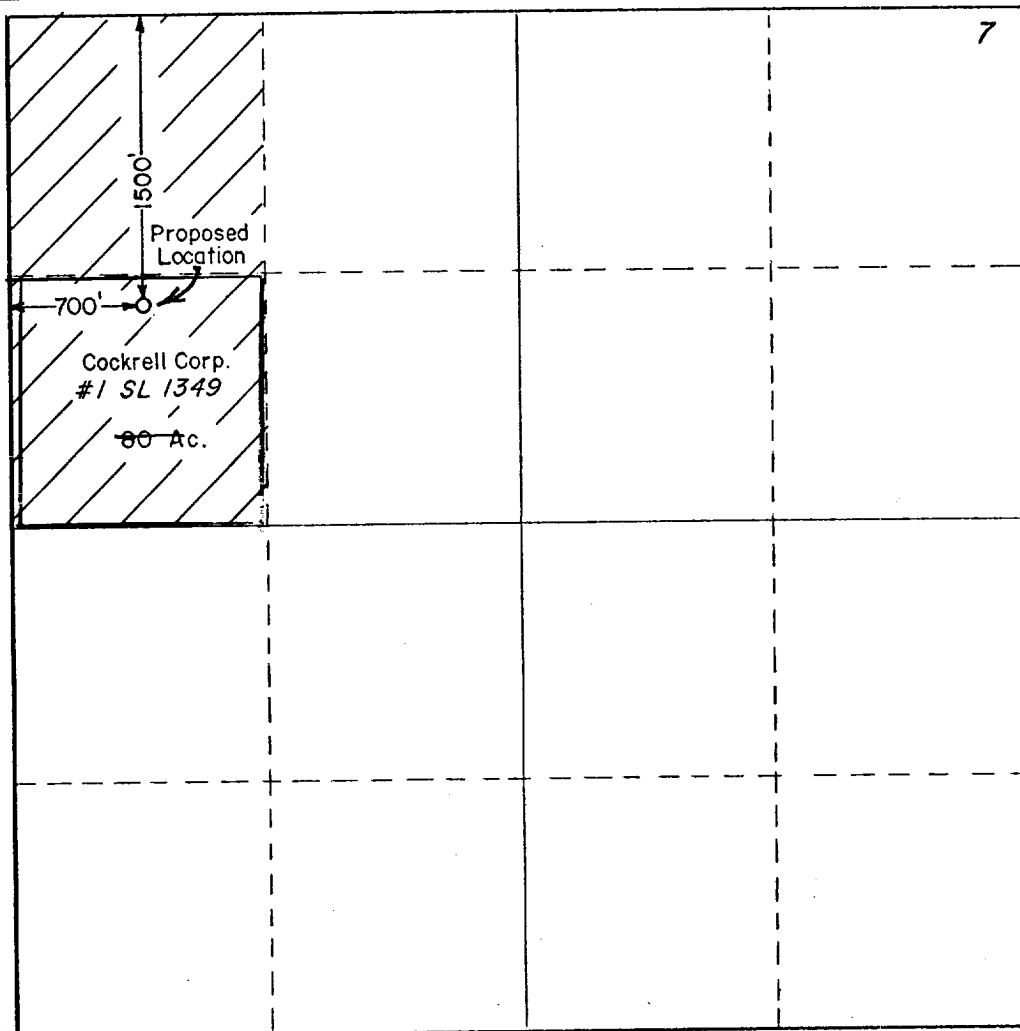

CERTIFICATION

I hereby certify that the information contained herein is true and complete to the best of my knowledge and belief.

[Signature]
 Name _____

Manager of Drilg. & Prod.

Position

COCKRELL CORPORATION

Company

September 23, 1969

Date

I hereby certify that the well location shown on this plat was plotted from field notes of actual surveys made by me or under my supervision, and that the same is true and correct to the best of my knowledge and belief.

[Signature]
 Date Surveyed _____

Sept. 9, 1969

Registered Professional Engineer
 and/or Land Surveyor

John L. Gray

Certificate No.

New Mexico 148

0 330 660 990 1320 1650 1980 2310 2640 2000 1500 1000 500 0