

NEW MEXICO OIL CONSERVATION COMMISSION  
Santa Fe, New Mexico

Form C-101  
Revised (12/1/55)

NOTICE OF INTENTION TO DRILL

MAY 13 1960

Notice must be given to the District Office of the Oil Conservation Commission and approval obtained before drilling or recompletion begins. If changes in the proposed plan are considered advisable, a copy of this notice showing such changes will be returned to the sender. Submit this notice in QUINTUPLICATE. One copy will be returned following approval. See additional instructions in Rules and Regulations of the Commission. If State Land submit 6 Copies Attach Form C-128 in triplicate to first 3 copies of form C-101

Alamogordo, New Mexico

May 2, 1960

(Place)

(Date)

OIL CONSERVATION COMMISSION  
SANTA FE, NEW MEXICO

Gentlemen:

You are hereby notified that it is our intention to commence the Drilling of a well to be known as

DWIGHT L. SMITH

(Company or Operator)

J. W. WALKER

(Lease)

Well No. 1, in I The well is

(Unit)

located 2290 feet from the South line and 500 feet from the

East

line of Section 21, T. 15S, R. 11E, NMPM.

(GIVE LOCATION FROM SECTION LINE)

Wildcat

Pool, Otero County

If State Land the Oil and Gas Lease is No.

If patented land the owner is J. W. Walker

Address La Luz, New Mexico

We propose to drill well with drilling equipment as follows: Custom Built

Combination spudder and rotary rig.

The status of plugging bond is On File

Drilling Contractor Walter Johnson

P. O. Box 588

Truth or Consequences, New Mexico

We intend to complete this well in the Pennsylvania

formation at an approximate depth of 5000 feet.

CASING PROGRAM

We propose to use the following strings of Casing and to cement them as indicated:

| Size of Hole | Size of Casing | Weight per Foot | New or Second Hand | Depth         | Backs Cement |
|--------------|----------------|-----------------|--------------------|---------------|--------------|
| 12 1/4"      | 10" 8 5/8"     | 20 lbs          | second             | 120-300       | 25           |
|              | 4.5"           |                 |                    | to Production | 50           |
|              |                |                 |                    |               |              |
|              |                |                 |                    |               |              |

If changes in the above plans become advisable we will notify you immediately.

ADDITIONAL INFORMATION (If recompletion give full details of proposed plan of work.)

Approved MAY 13 1960, 19  
Except as follows:

OIL CONSERVATION COMMISSION

By W. A. Gressett

Sincerely yours,

DWIGHT L. SMITH

(Company or Operator)

By

Position President

Send Communications regarding well to

Name Dwight L. Smith

Address 903 1/2 Delaware, Alamogordo, New Mexico

RECEIVED

**NEW MEXICO OIL CONSERVATION COMMISSION**  
**WELL LOCATION AND ACREAGE DEDICATION PLAT**

FORM C-128  
 Revised 5/1/57

MAY 13 1960

SEE INSTRUCTIONS FOR COMPLETING THIS FORM ON THE REVERSE SIDE

D. C. C.

ARTESIA, OFFICE

## SECTION A

|   |  |                        |                              |                        |                                       |
|---|--|------------------------|------------------------------|------------------------|---------------------------------------|
| Operator<br><b>DWIGHT L. SMITH</b>  |  |                        | Lease<br><b>J. W. WALKER</b> |                        | Well No.<br><b>1</b>                  |
| Unit Letter<br><b>I</b>   | Section<br><b>21</b>                       | Township<br><b>158</b> | Range<br><b>11E</b>          | County<br><b>Otero</b> |                                       |
| Actual Footage Location of Well:<br><b>2290</b> feet from the <b>South</b> line and <b>500</b> feet from the <b>East</b> line |  |                        |                              |                        |                                       |
| Ground Level Elev.<br><b>5200</b>   | Producing Formation<br><b>Pennsylvania</b> |                        | Pool<br><b>Wildcat</b>       |                        | Dedicated Acreage:<br><b>40</b> Acres |

1. Is the Operator the only owner in the dedicated acreage outlined on the plat below? YES XXX NO \_\_\_\_ . ("Owner" means the person who has the right to drill into and to produce from any pool and to appropriate the production either for himself or for himself and another. (65-3-29 (e) NMSA 1935 Comp.)
2. If the answer to question one is "no," have the interests of all the owners been consolidated by communitization agreement or otherwise? YES \_\_\_\_ NO \_\_\_\_ . If answer is "yes," Type of Consolidation \_\_\_\_\_
3. If the answer to question two is "no," list all the owners and their respective interests below:

| Owner | Land Description |
|-------|------------------|
|       |                  |

## SECTION B

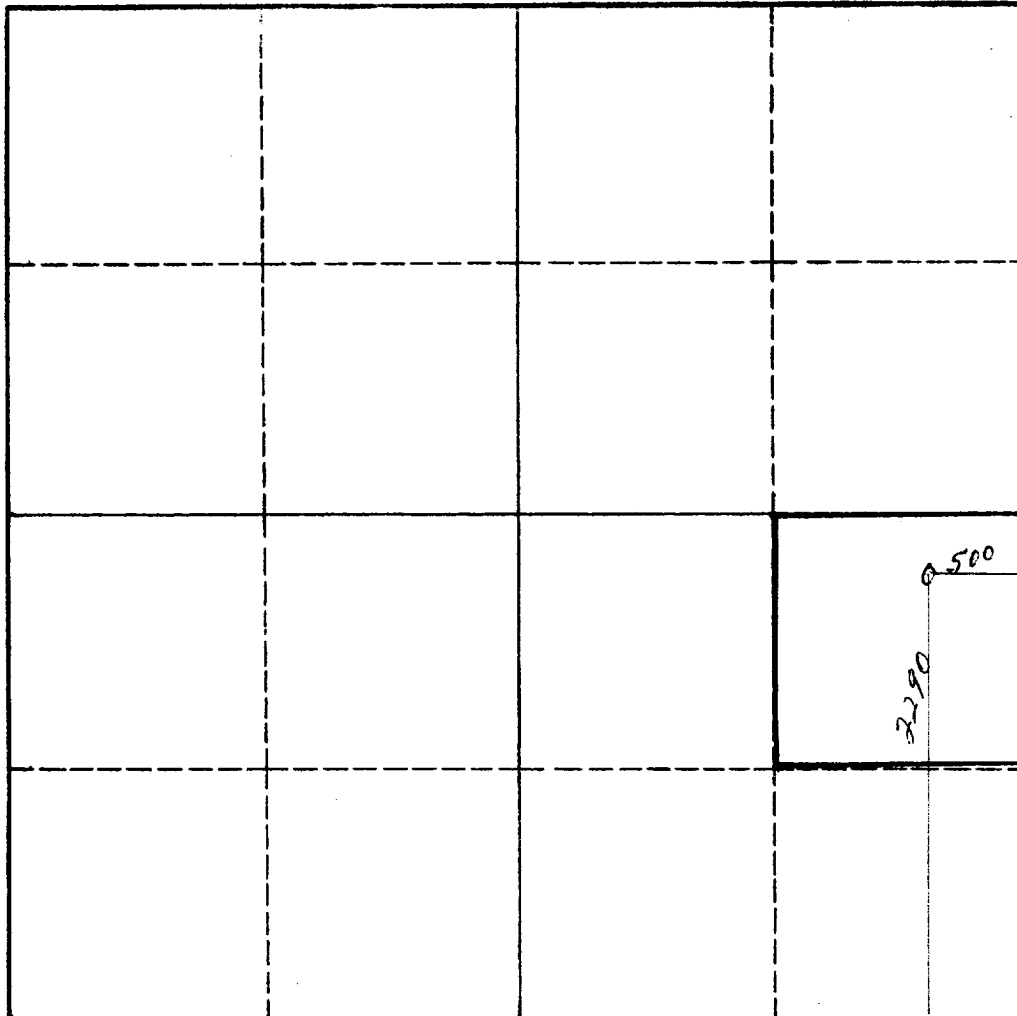

## CERTIFICATION

I hereby certify that the information in SECTION A above is true and complete to the best of my knowledge and belief.

Name

Position

**President**

Company

**DWIGHT L. SMITH**

Date

**May 2, 1960**

I hereby certify that the well location shown on the plat in SECTION B was plotted from field notes of actual surveys made by me or under my supervision, and that the same is true and correct to the best of my knowledge and belief.

Date Surveyed

**30 April 1960**

Registered Professional Engineer  
 and/or Land Surveyor

Certificate No.

**N/M 1359**

0 330 660 990 1320 1650 1980 2310 2640 2000 1500 1000 500 0

## INSTRUCTIONS FOR COMPLETION OF FORM C-128

1. Operator shall furnish and certify to the information called for in Section A.
2. Operator shall outline the dedicated acreage for *both* oil and gas wells on the plat in Section B.
3. A registered professional engineer or land surveyor registered in the State of New Mexico or approved by the Commission shall show on the plat the location of the well and certify this information in the space provided.
4. All distances shown on the plat must be from the outer boundaries of the Section.
5. If additional space is needed for listing owners and their respective interests as required in question 3 of Section A, please use space below.

| OIL CONSERVATION COMMISSION |   |   |
|-----------------------------|---|---|
| ARTERIA DISTRICT OFFICE     |   |   |
| No. Copies Received         | 6 |   |
|                             |   |   |
|                             |   |   |
| OPERATOR                    | 2 |   |
| SANTA FE                    | 1 |   |
| PRORATION OFFICE            |   |   |
| STATE LAND OFFICE           |   |   |
| U. S. G. S.                 | 2 |   |
| TRANSPORTER                 |   |   |
| FILE                        | 1 | ✓ |
| BUREAU OF MINES             |   |   |
|                             |   |   |