

NO. OF COPIES RECEIVED	
DISTRIBUTION	
SANTA FE	1
FILE	1
U.S.G.S.	2
LAND OFFICE	1
OPERATOR	1

NEW MEXICO OIL CONSERVATION COMMISSION

RECEIVED
APR 3 1980

O. C. D.
ARTESIA, OFFICE

30-035-20019

Form C-101
Revised 1-1-65

5A. Indicate Type of Lease STATE <input checked="" type="checkbox"/> FEE <input type="checkbox"/>
5. State Oil & Gas Lease No. LG 1306

APPLICATION FOR PERMIT TO DRILL, DEEPEN, OR PLUG BACK

1a. Type of Work b. Type of Well DRILL <input checked="" type="checkbox"/> DEEPEN <input type="checkbox"/> PLUG BACK <input type="checkbox"/> OIL WELL <input checked="" type="checkbox"/> GAS WELL <input type="checkbox"/> OTHER <input type="checkbox"/> SINGLE ZONE <input checked="" type="checkbox"/> MULTIPLE ZONE <input type="checkbox"/>		7. Unit Agreement Name
2. Name of Operator PENNZOIL COMPANY		8. Farm or Lease Name Southland 28 State
3. Address of Operator P.O. Drawer 1828, Midland, Texas 79702		9. Well No. 1
4. Location of Well UNIT LETTER M LOCATED 660 FEET FROM THE South LINE AND 760 FEET FROM THE West LINE OF SEC. 28 TWP. 25-S RGE. 17-E NMPM		10. Field and Pool, or Wildcat X Wildcat
		12. County Otero
19. Proposed Depth 5000'		19A. Formation Fusselman
		20. Rotary or C.T. Rotary
21. Elevations (Show whether DF, RT, etc.) 4000' Est. GR	21A. Kind & Status Plug. Bond Blanket	21B. Drilling Contractor Ard Drilling
		22. Approx. Date Work will start 4/25/80

PROPOSED CASING AND CEMENT PROGRAM

SIZE OF HOLE	SIZE OF CASING	WEIGHT PER FOOT	SETTING DEPTH	SACKS OF CEMENT	EST. TOP
12-1/4	8-5/8	24	1100	600	Surface
7-7/8	4-1/2	9.5	5000	1100	1500

APPROVAL VALID
FOR 90 DAYS UNLESS
DRILLING COMMENCED,

EXPIRES 8-5-80

IN ABOVE SPACE DESCRIBE PROPOSED PROGRAM: IF PROPOSAL IS TO DEEPEN OR PLUG BACK, GIVE DATA ON PRESENT PRODUCTIVE ZONE AND PROPOSED NEW PRODUCTIVE ZONE, GIVE BLOWOUT PREVENTER PROGRAM, IF ANY.

I hereby certify that the information above is true and complete to the best of my knowledge and belief.

Signed Tommy Grant Title District Production Manager Date 4/2/80

(This space for State Use)

APPROVED BY W. A. Gressett TITLE SUPERVISOR, DISTRICT II DATE MAY - 5 1980

CONDITIONS OF APPROVAL, IF ANY:

Cement must be circulated to
surface behind 8 7/8" casing

WELL LOCATION AND ACREAGE DEDICATION PLAT

Supersedes L-128
Effective 1-1-65

All distances must be from the outer boundaries of the Section

Operator Pennzoil Co.		Lease 28 Southland State 28		Well No. 1
Unit Letter M	Section 28	Township 25 South	Range 17 East	County Otero
Actual Footage Location of Well: 660 feet from the South line and 760 feet from the West line				
Ground Level Elev. 3957.1	Producing Formation Fusselman	Pool Wildcat	Estimated Acreage 40 Acres	

1. Outline the acreage dedicated to the subject well by colored pencil or hachure **RECEIVED** plat below.
2. If more than one lease is dedicated to the well, outline each and identify the ownership thereof (both as to working interest and royalty).
3. If more than one lease of different ownership is dedicated to the well, have the interests of all owners been consolidated by communitization, unitization, force-pooling, etc?

APR 3 1980

O. C. D.
ARTESIA, OFFICE
☐ Yes ☐ No If answer is "yes," type of consolidation _____

If answer is "no," list the owners and tract descriptions which have actually been consolidated. (Use reverse side of this form if necessary.) _____

No allowable will be assigned to the well until all interests have been consolidated (by communitization, unitization, forced-pooling, or otherwise) or until a non-standard unit, eliminating such interests, has been approved by the Commission.

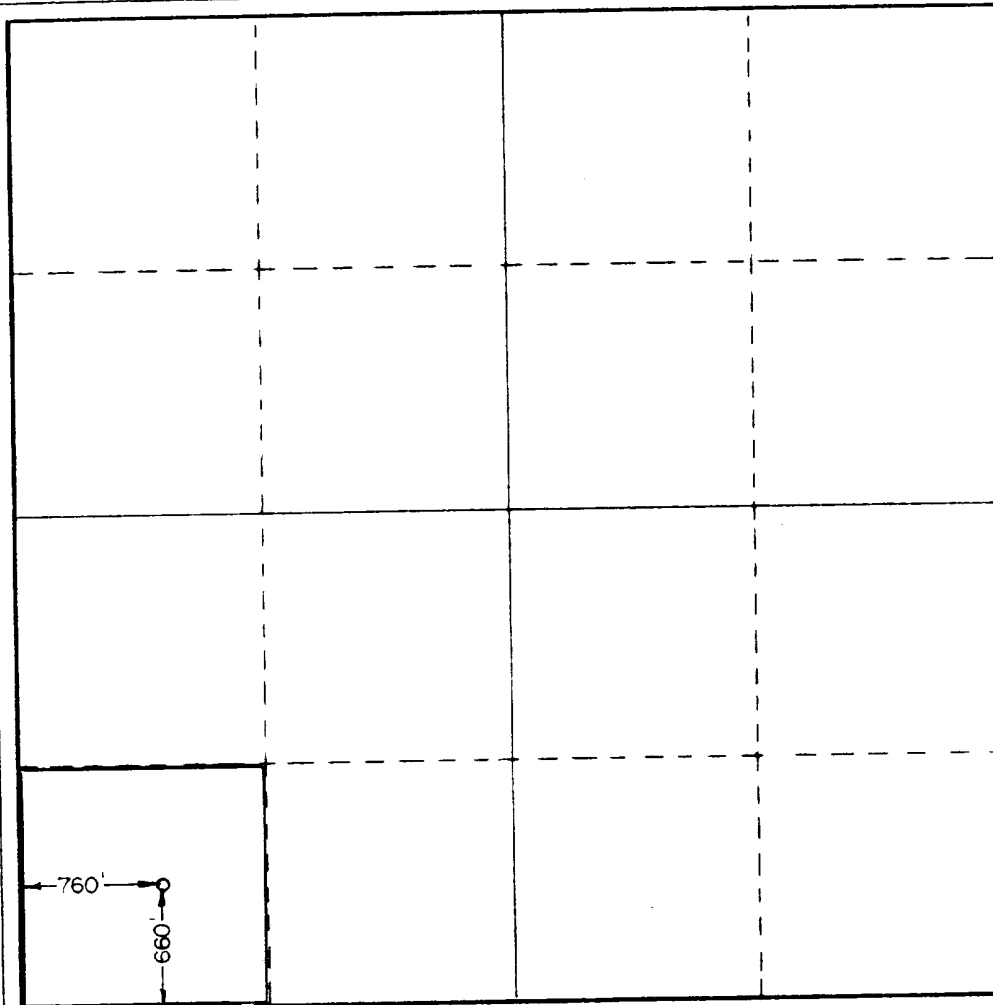

CERTIFICATION

I hereby certify that the information contained herein is true and complete to the best of my knowledge and belief.

L. Charles Marquart
Name

L. Charles Marquart

Position

District Production Manager

Company

Pennzoil Expl & Prod

Date

April 2, 1980

I hereby certify that the well location shown on this plat was plotted from field notes of actual surveys made by me or under my supervision, and that the same is true and correct to the best of my knowledge and belief.

Date Surveyed

March 28, 1980

Registered Professional Engineer
and/or Land Surveyor

John W. West
Certificate No.

JOHN W. WEST 676
PATRICK A. ROMERO 6463
Ronald J. Eidson 3239

0 330 660 990 1320 1650 1980 2310 2640 2000 1800 1000 800 0

Pennzoil Company

RECEIVED

MAY -1 1980

O. C. D.
ARTESIA, OFFICE

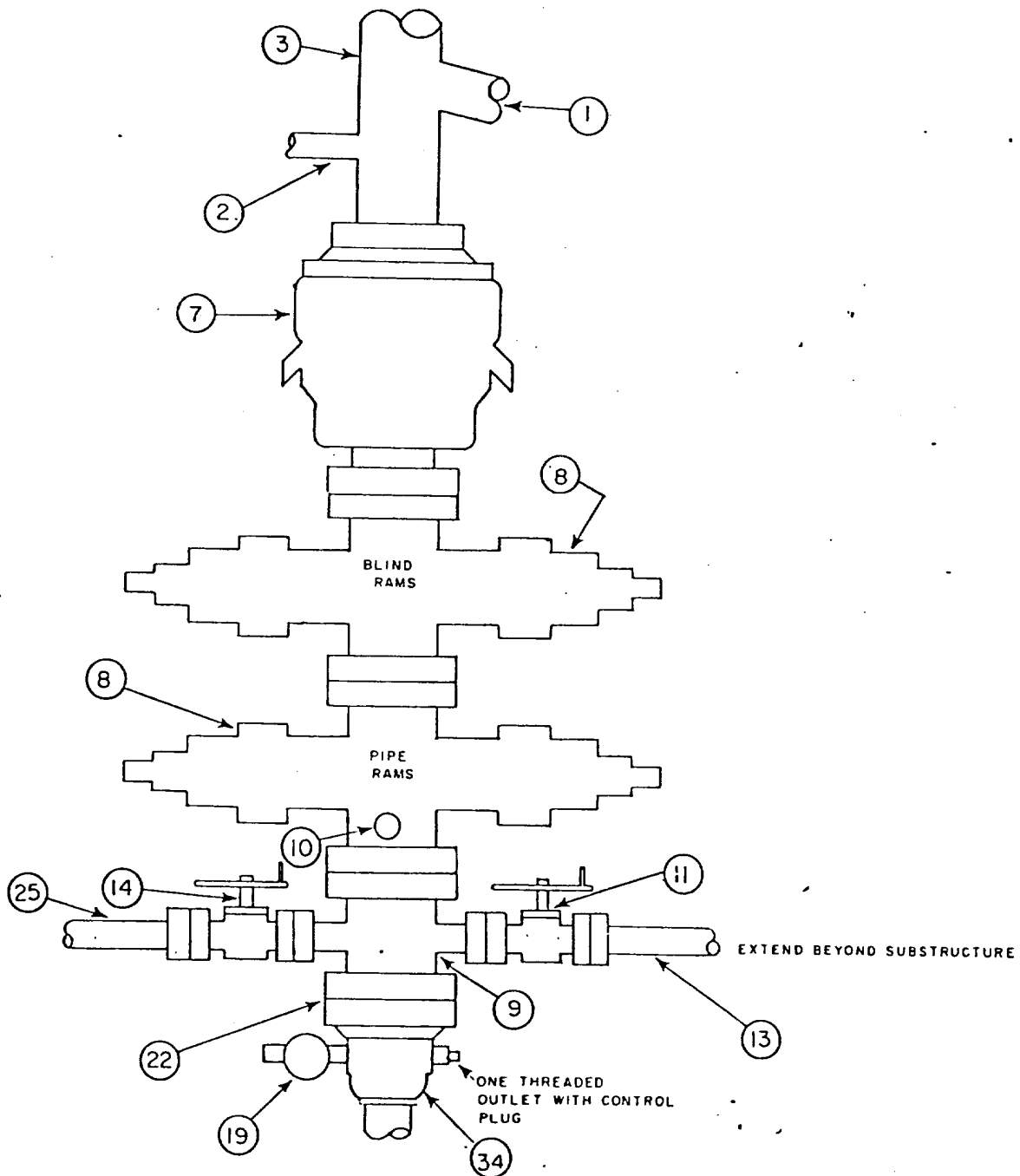

hcm

CHECK LIST AND DRAWINGS (ATTACHED)
 MINIMUM BLOWOUT PREVENTER EQUIPMENT REQUIREMENTS
 (ATTACHMENT NO. 2 TO BID SHEET AND WELL SPECIFICATIONS)
 3000 PSI WORKING PRESSURE
 TO BE INSTALLED AFTER SETTING 8-5/8 INCH CASING

ATTACHMENT NO. 2
 (See Section 4)
 Page 1 of 1

RECEIVED

MAY - 1 1980

O. C. D.
 ARTESIA, OFFICE

Contractor or Pzl. to furnish items checked (X). See attached drawing.

No.	Item	Min. Size *	Type	Press. Rating	Furnished By	
					Contr.	Pzl.
1.	Flow Line	8"	Weld	125	X	
2.	Fill Up Line	2"	Thd or Weld	125	X	
3.	Bell Nipple	8"	Weld	125	X	
4.	Rotating Head					
5.	Hydraulically Operated Gate Valve					
6.	Blooe Line					
7.	Bag Preventer	8"	Flange	3000	X	
8.	Hydraulically Operated Ram Preventer or Rotating Head					
9.	Drilling Spool with 2 in. and 2 in. Side Outlets	8"	Flange	3000	X	
10.	Preventer Side Outlets, 2 in. and 2 in. Use as alternate to No. 9 above.	8"	Flange	3000	X	
11.	Gate Valve	2"	Thd or Flge	3000	X	
12.	Hydraulically Operated Gate Valve					
13.	Line to Choke Manifold	2"	Thd or Flge	3000	X	
14.	Gate Valve	2"	Thd or Flge	3000	X	
15.	Hydraulically Operated Gate Valve					
16.	Check Valve					
17.	Drilling Spool with in. and in. side outlets					
18.	Preventer Side Outlets in. and in. Use as alternate to No. 17 above.					
19.	Gate Valve	2"	Thd	3000		X
20.	Hydraulically Operated Gate Valve					
21.	Relief Line					
22.	Wear Flange or Bushing	N/A				
23.	Kill Line to accessible location approx. ft. from rig.					
24.	Gate Valve					
25.	Kill Line to rig pump manifold	2"	Thd or Flge	3000	X	
26.	Way Cross, in. x in. x in. x in.					
27.	Tee, in. x in. x in.					
28.	Half Union					
29.	Casing Spool					
30.	Gate Valve					
31.	Casing Spool					
32.	Gate Valve					
33.	Pressure Gauge					
34.	Casing Head	8"	Flge or Thd	3000		X
35.	Gate Valve					
36.	Gate Valve					

*Line sizes to be inside diometer.

Valves, spools and preventer sizes to be bore dimension.

Jan



BRUCE KING
GOVERNOR
LARRY KEHOE
SECRETARY

STATE OF NEW MEXICO
ENERGY AND MINERALS DEPARTMENT
OIL CONSERVATION DIVISION
ARTESIA DISTRICT OFFICE

April 8, 1980

P.O. DRAWER DD
ARTESIA, NEW MEXICO 88210
(505) 746-4884

748-1283

Pennzoil Company
Post Office Drawer 1828
Midland, Texas 79702

Re: Southland 28 State
#1-M-28-25-17
Southland 2 State
#1-D-2-26-17
Otero County, NM

Gentlemen:

Please furnish us a copy of the BOP Program for the
subject wells.

Enclosed is a copy of some information concerning
water in this area.

If you have any questions concerning this matter,
feel free to contact me.

Sincerely,

W. A. Gressett
Supervisor, District II

WAG:AR
Encl.

April 29, 1980: To date we have had no response to
this letter. Please advise. -- WAG

EXPLANATION

GEOLOGY



VALLEY FILL

ALLUVIUM AND LACUSTRINE DEPOSITS COMPOSED OF BOULDERS, COBBLES, GRAVEL, SAND, SILT, AND CLAY. CONTAINS SOME GYPSUM AND SALT IN PLACES. YIELDS LARGE QUANTITIES OF WATER TO A FEW WELLS. WATER IS HARD AND SALINE IN LOWLAND AREAS.



LIMESTONE

MOSTLY MASSIVE GRAY LIMESTONE INTERBEDDED WITH BLACK CHERTY LIMESTONE, SHALY LIMESTONE, AND SILICEOUS SHALE. CONTAINS MANY INTERCONNECTED SOLUTION CHANNELS FILLED WITH POTABLE BUT HARD WATER. YIELDS LARGE QUANTITIES OF WATER TO WELLS.

WELLS

WELLS IN VALLEY FILL INDICATED BY SOLID CIRCLE, WELLS IN LIMESTONE BY OPEN CIRCLE. QUESTION MARKS INDICATE THAT WATER-BEARING FORMATION IS NOT KNOWN. WELLS CLASSIFIED ONLY AS TO USE OR INTENDED USE.

● ●
IRRIGATION WELLS

● ○
DOMESTIC AND STOCK WELLS

○ 450
1,500

UPPER NUMBER IS DEPTH TO WATER IN FEET BELOW LAND-SURFACE DATUM. LOWER NUMBER IS SPECIFIC ELECTRICAL CONDUCTANCE IN MICROMHOS AT 25° C.

— 25 —

LINE OF EQUAL DEPTH TO WATER, IN FEET BELOW LAND SURFACE. INTERVAL IS VARIABLE.

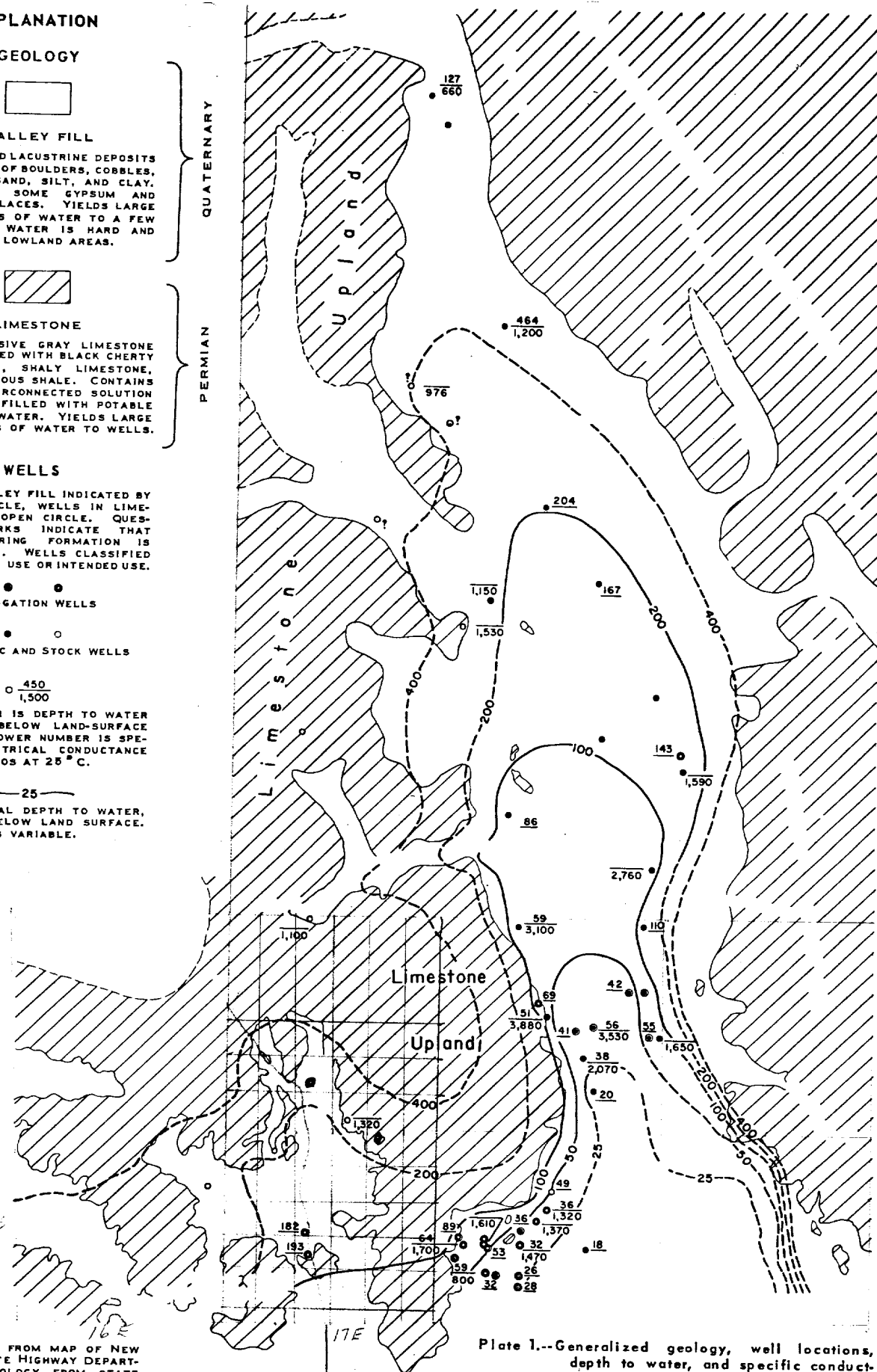

BASE MODIFIED FROM MAP OF NEW MEXICO, STATE HIGHWAY DEPARTMENT. GEOLOGY FROM STATE LINE NORTHWARD ABOUT 9 MILES AFTER KING (1949).

Plate 1.--Generalized geology, well locations, depth to water, and specific conductance of water in the Crow Flats area, Otero County, N. Mex.

T.22 S.

T.23 S.

T.24 S.

T.25 S.

T.26 S.

R.14 E.

R.15 E.

R.16 E.

R.17 E.

NEW MEXICO

TEXAS

To Dal City, Tex.

Scale 1 inch = 3 Miles

1 1/2 0 1 2 3 4
STATUTE MILES

1966

Control by U.S. Coast and Geodetic Survey; U.S. Geological Survey; U.S. Forest Service; Bureau of Land Management and Planning Commission; Modified Contour Projection Standard; Projected 1957 North American Datum