

UNITED STATES  
DEPARTMENT OF THE INTERIOR

## GEOLOGICAL SURVEY

## APPLICATION FOR PERMIT TO DRILL, DEEPEN, OR PLUG BACK

## 1a. TYPE OF WORK

DRILL ☒DEEPEN ☐PLUG BACK ☐

## b. TYPE OF WELL

OIL  
WELL ☒GAS  
WELL ☐OTHER ☐SINGLE  
ZONE ☐MULTIPLE  
ZONE ☐

## 2. NAME OF OPERATOR

Yates Petroleum Corporation

## 3. ADDRESS OF OPERATOR

207 S. 4th, Artesia, New Mexico 88210

## 4. LOCATION OF WELL (Report location clearly and in accordance with any State requirements.)

At surface

1285' FSL and 1980' FWL

At proposed prod. zone

same

## 14. DISTANCE IN MILES AND DIRECTION FROM NEAREST TOWN OR POST OFFICE\*

Approximately 9 miles west of Dunkin, New Mexico

## 15. DISTANCE FROM PROPOSED\*

LOCATION TO NEAREST

PROPERTY OR LEASE LINE, FT.

(Also to nearest drlg. unit line, if any)

## 18. DISTANCE FROM PROPOSED LOCATION\*

TO NEAREST WELL, DRILLING, COMPLETED,  
OR APPLIED FOR, ON THIS LEASE, FT.

## 21. ELEVATIONS (Show whether DF, RT, GR, etc.)

6372.4' GL

23.

## PROPOSED CASING AND CEMENTING PROGRAM

SIZE OF HOLE	SIZE OF CASING	WEIGHT PER FOOT	SETTING DEPTH	QUANTITY OF CEMENT
17 1/2"	13 3/8"	48# J-55	appr. 250'	250 sx circulate
12 1/4"	9 5/8"	32.5# J-55	appr. 1500'	900 sx circulate
7 7/8"	4 1/2" or	17#-15.5	TD	1250 sx
	5 1/2"	11.6-10.5#		

We propose to drill and test the Pre-cambrian and intermediate formations. Approximately 250' of surface casing will be set to shut off gravel and cavings and intermediate casing will be set at approximately 1500'. If commercial, will run 4 1/2" or 5 1/2" casing with 600' cement cover, will perforate and stimulate as needed for production.

MUD PROGRAM: FW gel/LCM to 1500', FW/gel/starch to 4300', starch/driskpak/KCL to 6700', flosal/driskpak/KCL to TD.

BOP PROGRAM: BOP's and hydril will be installed on the 9 5/8" csg and tested daily.

IN ABOVE SPACE DESCRIBE PROPOSED PROGRAM: If proposal is to deepen or plug back, give data on present productive zone and proposed new productive zone. If proposal is to drill or deepen directionally, give pertinent data on subsurface locations and measured and true vertical depths. Give blowout preventer program, if any.

24.

SIGNED

TITLE Regulatory Agent

DATE 10/12/83

(This space for Federal or State office use)

PERMIT NO.

APPROVAL DATE

Orig. Sgd. Earl R. Cunningham

District Manager

DEC 01 1983

APPROVED BY

TITLE

DATE

CONDITIONS OF APPROVAL, IF ANY:

APPROVAL SUBJECT TO  
GENERAL REQUIREMENTS AND  
SPECIAL STIPULATIONS  
ATTACHED

**NEW MEXICO OIL CONSERVATION COMMISSION  
WELL LOCATION AND ACREAGE DEDICATION PLAT**

Form C-102  
Supersedes C-128  
Effective 1-1-65

All distances must be from the outer boundaries of the Section.

Operator <b>YATES PETROLEUM CORPORATION</b>			Lease <b>DOG CANYON "YF" FEDERAL</b>		Well No. <b>1</b>
Unit Letter <b>K</b>	Section <b>15</b>	Township <b>18 South</b>	Range <b>15 East</b>	County <b>Otero</b>	
Actual Fraction Location of Well: <b>1785</b> feet from the <b>South</b> line and <b>1980</b> feet from the <b>West</b> line					
Ground Level Elev. <b>6372.4</b>	Producing Formation <b>Bliss</b>		Pool <b>Wildcat</b>	Dedicated Acreage: <b>40</b> Acres	

1. Outline the acreage dedicated to the subject well by colored pencil or hachure marks on the plat below.
2. If more than one lease is dedicated to the well, outline each and identify the ownership thereof (both as to working interest and royalty).
3. If more than one lease of different ownership is dedicated to the well, have the interests of all owners been consolidated by communitization, unitization, force-pooling, etc?

☐ Yes ☐ No If answer is "yes," type of consolidation \_\_\_\_\_

If answer is "no," list the owners and tract descriptions which have actually been consolidated. (Use reverse side of this form if necessary.) \_\_\_\_\_

No allowable will be assigned to the well until all interests have been consolidated (by communitization, unitization, forced-pooling, or otherwise) or until a non-standard unit, eliminating such interests, has been approved by the Commission.

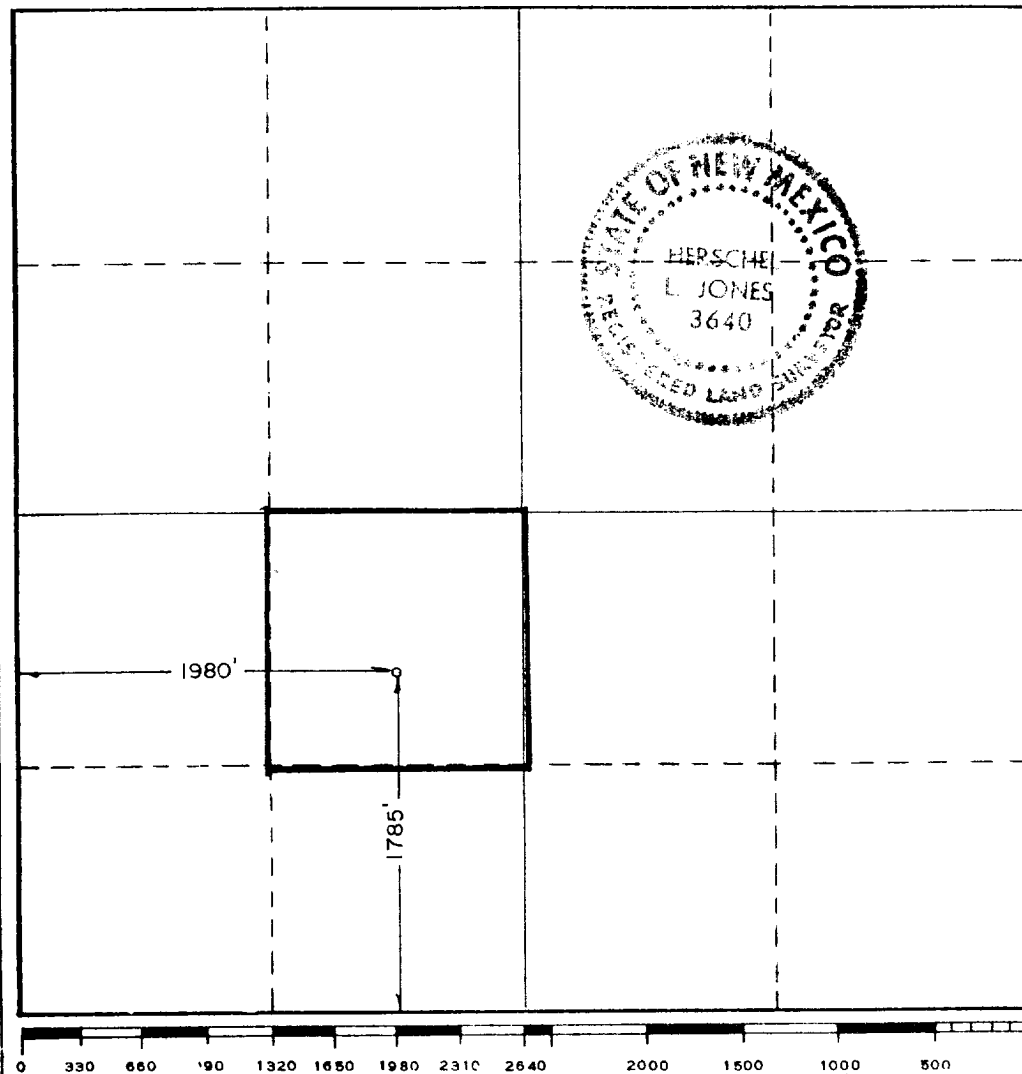

**CERTIFICATION**

*I hereby certify that the information contained herein is true and complete to the best of my knowledge and belief.*

Name  
**Gliserio Rodriguez**  
Position  
**Regulatory Agent**  
Company  
**Yates Petroleum Corp.**  
Date  
**11/30/83**

*I hereby certify that the well location shown on this plat was plotted from field notes of actual surveys made by me or under my supervision, and that the same is true and correct to the best of my knowledge and belief.*

Date Surveyed  
**11/2/83**  
Registered Professional Engineer and/or Land Surveyor

Certificate No.  
**3640**

Rotating head if necessary  
2" Fill up Line

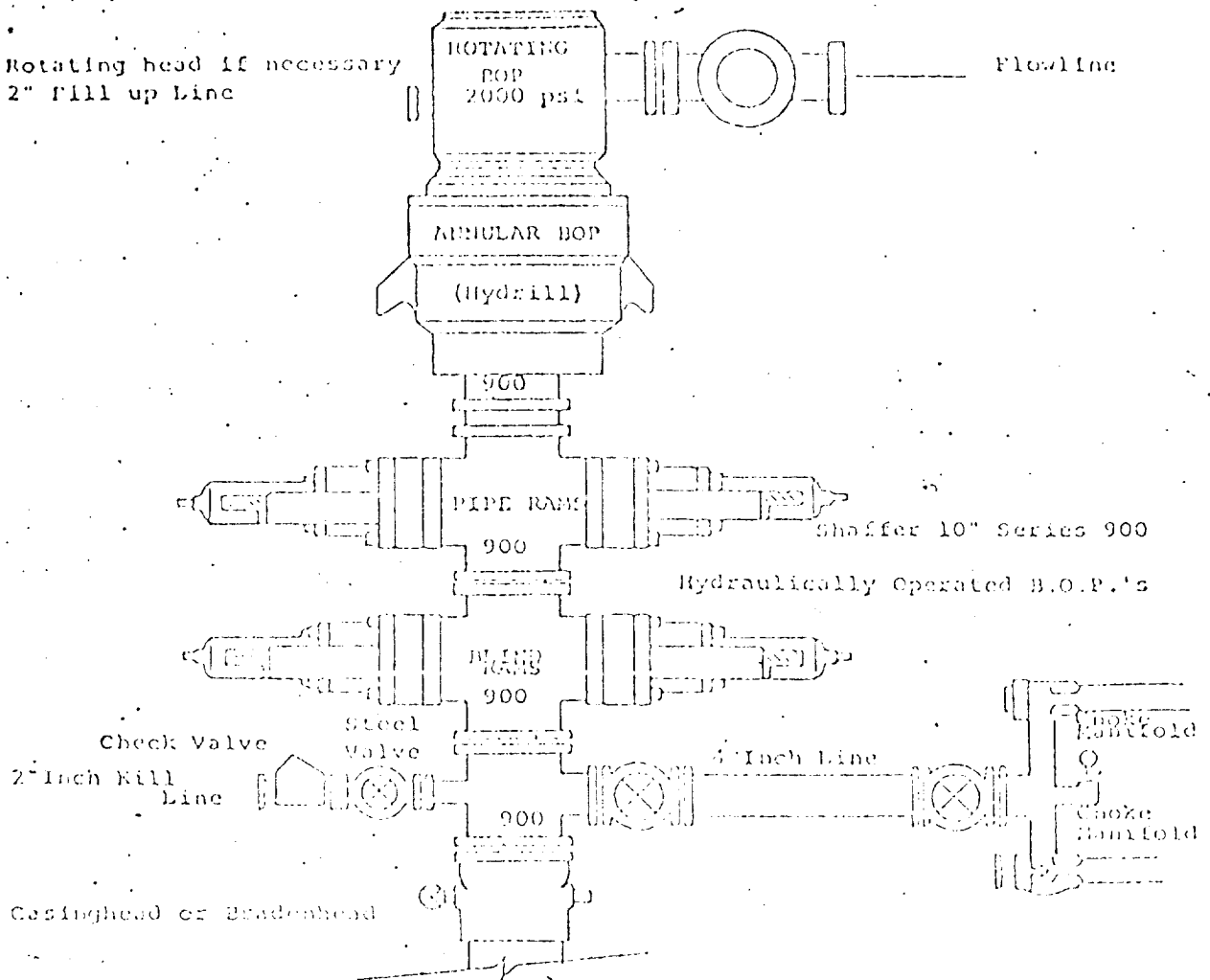

THE FOLLOWING CONSTITUTE MINIMUM BLOWOUT PREVENTER REQUIREMENTS

1. All preventers to be hydraulically operated with secondary manual controls installed prior to drilling out from under casing.
2. Choke outlet to be a minimum of 4" diameter.
3. Kill line to be of all steel construction of 2" minimum diameter.
4. All connections from operating manifolds to preventers to be all steel, hole or tube a minimum of one inch in diameter.
5. The available closing pressure shall be at least 15% in excess of that required with sufficient volume to operate the B.O.P.'s.
6. All connections to and from preventer to have a pressure rating equivalent to that of the B.O.P.'s.
7. Inside blowout preventer to be available on rig floor.
8. Operating controls located a safe distance from the rig floor.
9. Hole must be kept filled on trips below intermediate casing. Operator not responsible for blowouts resulting from not keeping hole full.
10. D. P. float must be installed and used below zone of first gas indication.

YATES PETROLEUM CORPORATION  
Dog Canyon "YF" Federal #1  
1650' FSL and 1980' FWL  
Section 15-T18S-R15E  
Otero County, New Mexico

In conjunction with Form 9-331C, Application for Permit to Drill subject well, Yates Petroleum Corporation submits the following ten items of pertinent information in accordance with USGS requirements.

1. The geologic surface formation is San Andres.

2. The estimated tops of geologic markers are as follows:

Glorieta	650'	Montoya	8105'
Tubb	2350'	Ellenburger	8355'
Abo	3500'	Bliss	8805'
Mississippian	7347'	Precambrian	8850'
Silurium	7748'	TD	9000'

3. The estimated depths at which anticipated water, oil or gas formations are expected to be encountered:

Water: approximately 350'

Oil or Gas: 3550', 7360', 8820'

4. Proposed Casing Program: See Form 9-331C.

5. Pressure Control Equipment: See Form 9-331C.

6. Mud Program: See Form 9-331C.

7. Auxiliary Equipment: Kelly Cock; pit level indicators and flow sensor equipment; sub with full-opening valve on floor, drill pipe connection.

8. Testing, Logging and Coring Program:

Samples: 5' lithologic, canned samples at 50' intervals from 1500' to TD.

DST's: In Mississippian and as indicated by logs.

Logging: CNL-Litho Density; DLL-RxO; Sonic-GR, surface to TD; pipemeter. Open hole log will be run before intermediate casing.

Mudlogging: One man unit surface to TD.

9. No abnormal pressures or temperatures are anticipated.

10. Anticipated starting date: As soon as possible after approval.

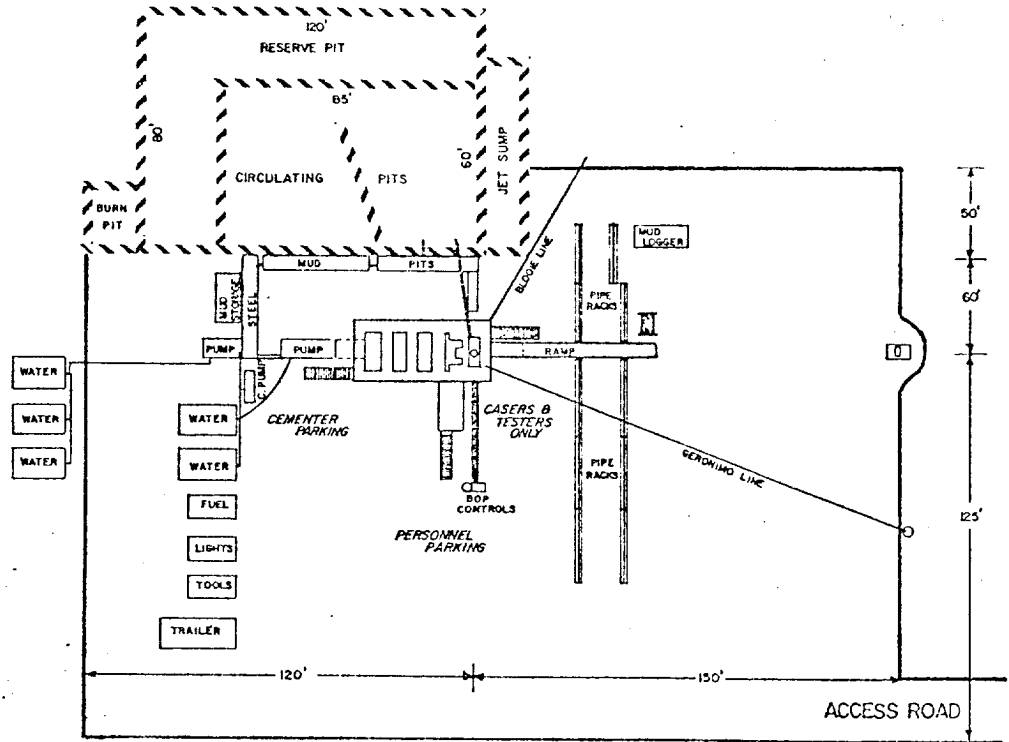

DRILLING RIG LAYOUT

Scale: 1 inch = 50 feet

TANK BATTERY LAYOUT

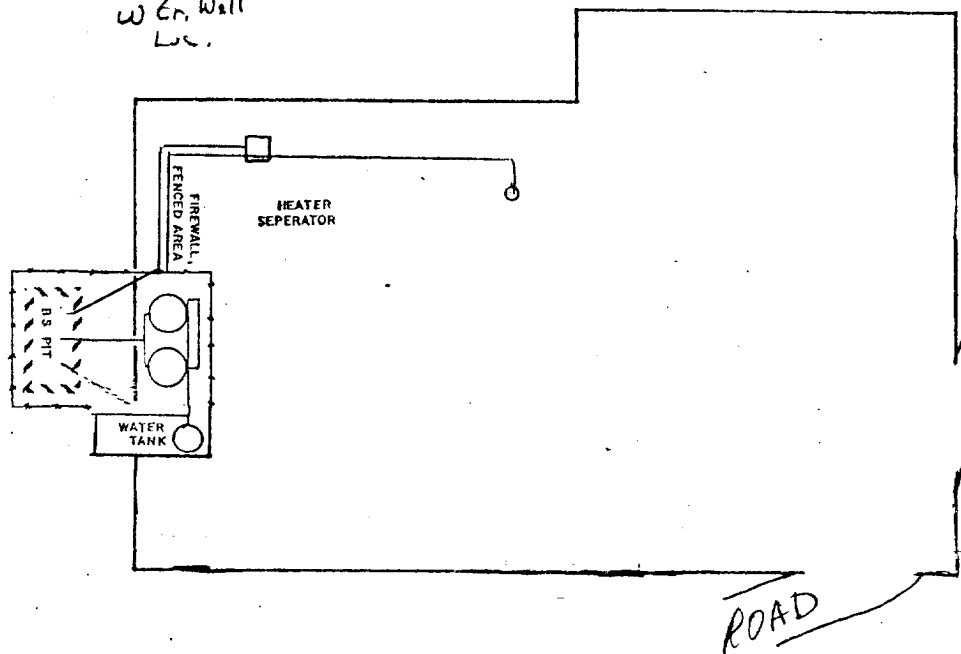

TANK BATTERY LAYOUT

Scale: 1 inch = 50 feet