

NO. OF COPIES RECEIVED	6
DISTRIBUTION	
SANTA FE	/
FILE	/ ✓
U.S.G.S.	2
LAND OFFICE	/
OPERATOR	/

NEW MEXICO OIL CONSERVATION COMMISSION

RECEIVED

JUN 3 1970

O. C. C.  
ARTESIA, OFFICE

Form C-101  
Revised 1-1-65

5A. Indicate Type of Lease	
STATE <input checked="" type="checkbox"/>	FEE <input type="checkbox"/>
5. State Oil & Gas Lease No.	
L-2899	

APPLICATION FOR PERMIT TO DRILL, DEEPEN, OR PLUG BACK

1a. Type of Work		7. Unit Agreement Name	
b. Type of Well DRILL <input checked="" type="checkbox"/> DEEPEN <input type="checkbox"/> PLUG BACK <input type="checkbox"/> OIL WELL <input checked="" type="checkbox"/> GAS WELL <input type="checkbox"/> OTHER <input type="checkbox"/> SINGLE ZONE <input type="checkbox"/> MULTIPLE ZONE <input type="checkbox"/>		8. Farm or Lease Name	
2. Name of Operator		9. Well No.	
Gulf Oil Corporation		1	
3. Address of Operator		10. Field and Pool, or Wildcat	
Box 670, Hobbs, New Mexico 88240		Wildcat	
4. Location of Well UNIT LETTER H LOCATED 1980 FEET FROM THE North LINE AND 660 FEET FROM THE East LINE OF SEC. 35 TWP. 12-S RGE. 1-W NMPM		12. County	
		Sierra	
19. Proposed Depth		19A. Formation	20. Rotary or C.T.
8100'		Basement	Rotary
21. Elevations (Show whether DF, RT, etc.)	21A. Kind & Status Plug. Bond	21B. Drilling Contractor	22. Approx. Date Work will start
5112' GL	Blanket	To be furnished later	June 15, 1970

23.

PROPOSED CASING AND CEMENT PROGRAM

SIZE OF HOLE	SIZE OF CASING	WEIGHT PER FOOT	SETTING DEPTH	SACKS OF CEMENT	EST. TOP
17-1/2"	13-3/8"	48#	500'	Circulate	
12-1/4"	* 9-5/8"	36#	2500'	300 sacks	*
8-3/4"	* 5-1/2" or 7"	15.5 or 23#	8100'	300 or 500 sacks	

\* If necessary, because of lost circulation, water flow or production shows, will run 9-5/8" casing and set at approximately 2500'. If 9-5/8" casing is not run, will reduce hole to 8-3/4" at 2500' and drill to TD at 8100'. If well is productive, will run 5-1/2" or 7" casing to TD.

APPROVAL VALID  
FOR 90 DAYS UNLESS  
DRILLING COMMENCED.  
EXPIRES 9-4-70

IN ABOVE SPACE DESCRIBE PROPOSED PROGRAM: IF PROPOSAL IS TO DEEPEN OR PLUG BACK, GIVE DATA ON PRESENT PRODUCTIVE ZONE AND PROPOSED NEW PRODUCTIVE ZONE. GIVE BLOWOUT PREVENTER PROGRAM, IF ANY.

I hereby certify that the information above is true and complete to the best of my knowledge and belief.

Signed Orig. Signed by R. W. Sands Title Production Superintendent Date June 2, 1970

(This space for State Use)

APPROVED BY W. A. Gressett TITLE OIL AND GAS INSPECTOR DATE JUN 4 1970

CONDITIONS OF APPROVAL, IF ANY:

\* 9 3/8" must be circulated if fresh water zones are encountered below the 13 3/8"

**NEW MEXICO OIL CONSERVATION COMMISSION  
WELL LOCATION AND ACREAGE DEDICATION PLAT**

Form C-102  
Supersedes C-128  
Effective 1-1-65

All distances must be from the outer boundaries of the Section.

Operator <b>GULF OIL CORP.</b>			Lease <b>SIERRA K STATE</b>		Well No. <b>1</b>
Unit Letter <b>H</b>	Section <b>35</b>	Township <b>12 SOUTH</b>	Range <b>1 WEST</b>	County <b>SIERRA</b>	
Actual Footage Location of Well: <b>1980</b> feet from the <b>NORTH</b> line and <b>660</b> feet from the <b>EAST</b> line					
Ground Level Elev. <b>5112.1</b>	Producing Formation <b>Basement</b>		Pool <b>Wilcoat</b>	Dedicated Acreage: <b>40</b> Acres	

1. Outline the acreage dedicated to the subject well by colored pencil or hatchure marks on the plat below.
2. If more than one lease is dedicated to the well, outline each and identify the ownership thereof (both as to working interest and royalty).
3. If more than one lease of different ownership is dedicated to the well, have the interests of all owners been consolidated by communitization, unitization, force-pooling, etc?

☐ Yes ☐ No If answer is "yes," type of consolidation **UNIT**

If answer is "no," list the owners and tract descriptions which have actually been consolidated. (Use reverse side of this form if necessary.) \_\_\_\_\_

No allowable will be assigned to the well until all interests have been consolidated (by communitization, unitization, forced-pooling, or otherwise) or until a non-standard unit, eliminating such interests, has been approved by the Commission.

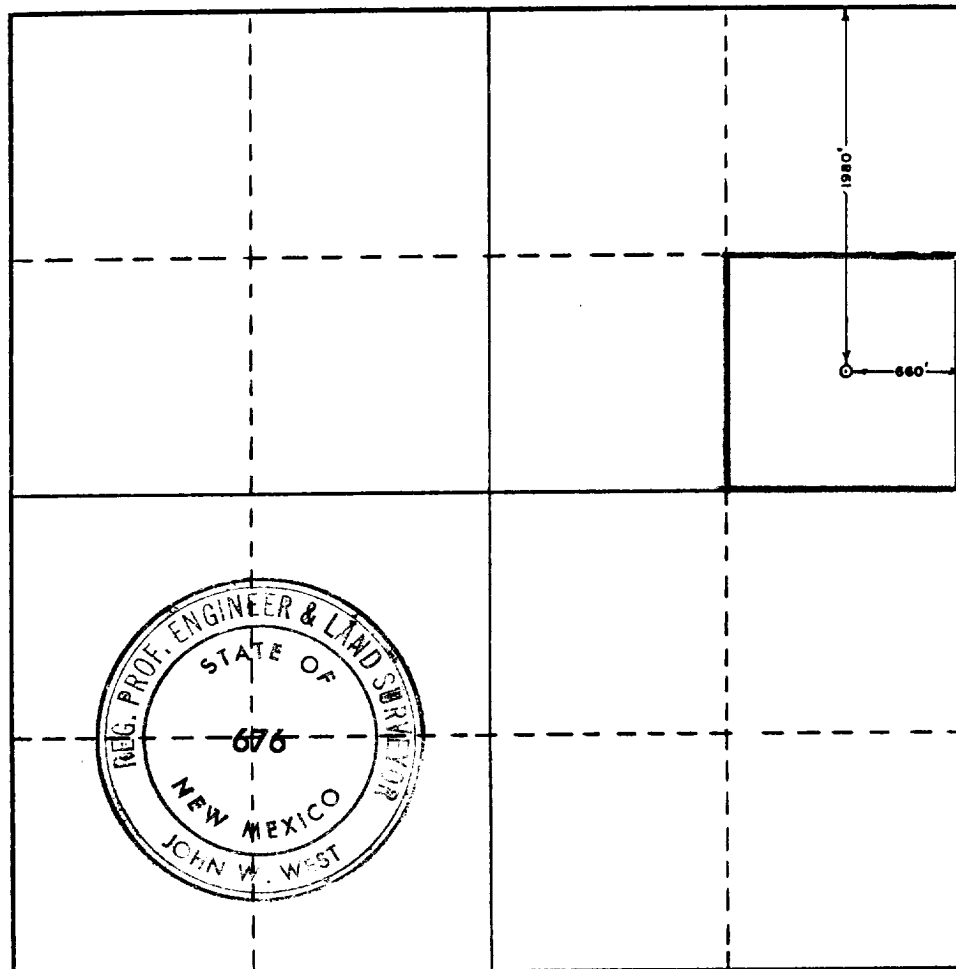

**CERTIFICATION**

I hereby certify that the information contained herein is true and complete to the best of my knowledge and belief.

**Orig. Signed by R.W.Sands**

Name \_\_\_\_\_  
Position  
**Production Superintendent**  
Company  
**Gulf Oil Corporation**  
Date  
**June 2, 1970**

I hereby certify that the well location shown on this plat was plotted from field notes of actual surveys made by me or under my supervision, and that the same is true and correct to the best of my knowledge and belief.

Date Surveyed  
**MAY 25, 1970**

Registered Professional Engineer and/or Land Surveyor

*John W. West*

Certificate No. **676**

