

0+6-MMS-Roswell

1-File

1-H.O. Woods-Midland

1-Jim-Engr.

1-Foreman

NEW MEXICO OIL CONSERVATION COMMISSION  
WELL LOCATION AND ACREAGE DEDICATION PLAT

JUL 27 1982

Form C-122  
Supersedes C-123  
Effective 1-4-82

All distances must be from the outer boundaries of the Section.

Lease No. 10557 071		Lease Airport Ark Res 7 Federal		Well No. 1
Section 7	Township 12S	Range 4W	County Sierra	
Location of Well: 2310 feet from the East line and 990 feet from the North line				
Formation Pennsylvanian	Pool Undesignated	Dedicated Acreage: 320 Acres		

- Outline the acreage dedicated to the subject well by colored pencil or hatchure marks on the plat below.
- If more than one lease is dedicated to the well, outline each and identify the ownership thereof (both as to working interest and royalty).
- If more than one lease of different ownership is dedicated to the well, have the interests of all owners been consolidated by communitization, unitization, force-pooling, etc?

☒ Yes ☐ No If answer is "yes," type of consolidation Exploratory Unit

If answer is "no," list the owners and tract descriptions which have actually been consolidated. (Use reverse side of this form if necessary.)

No allowable will be assigned to the well until all interests have been consolidated (by communitization, unitization, forced-pooling, or otherwise) or until a non-standard unit, eliminating such interests, has been approved by the Commission.

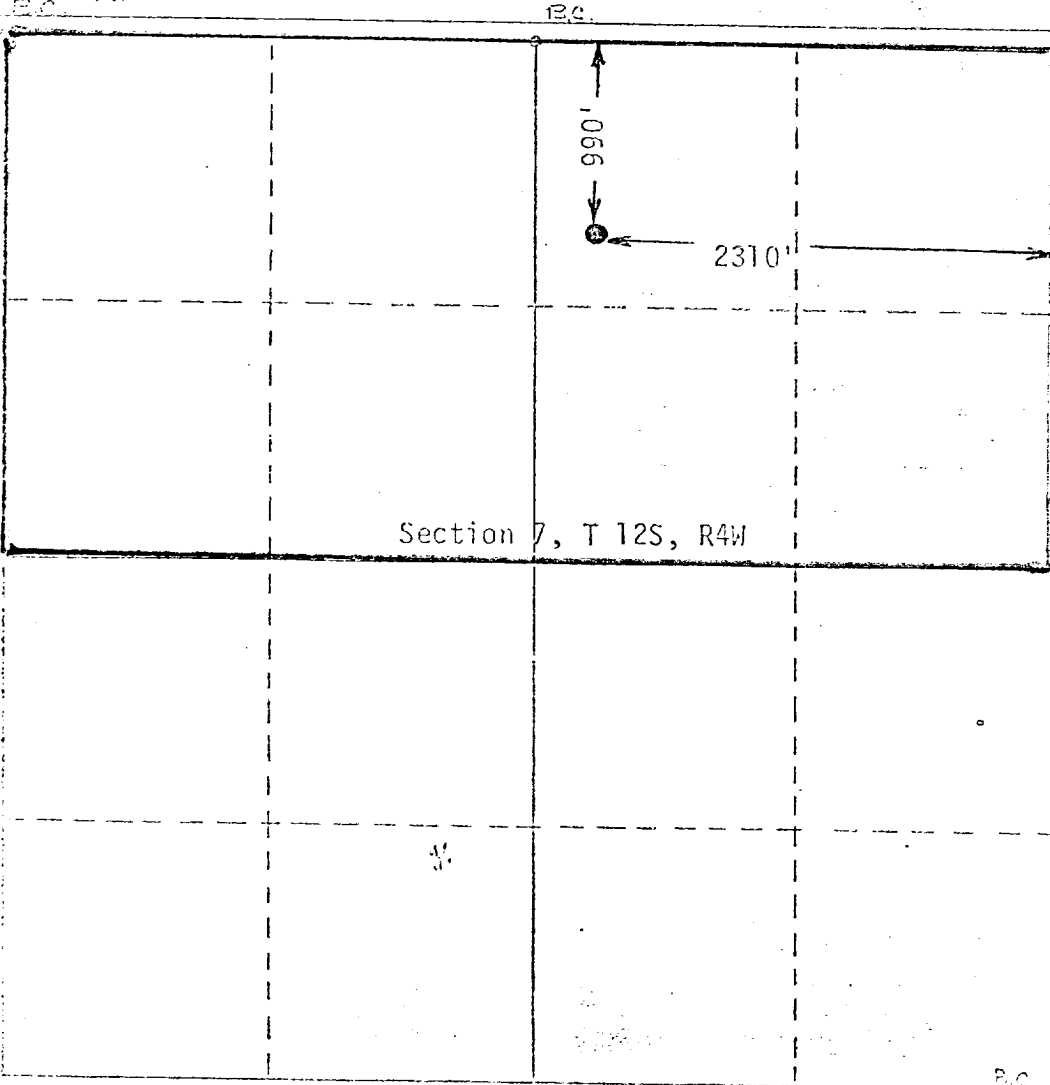

## CERTIFICATION

I hereby certify that the information contained herein is true and complete to the best of my knowledge and belief.

Name Dale R. Crockett  
Position Area Superintendent  
Company Getty Oil Company

Date June 21, 1982

I hereby certify that the well location shown on this plat was plotted from field notes of actual surveys made by me or under my supervision, and that the same is true and correct to the best of my knowledge and belief.

March 17, 1982

Date Surveyed  
Registered Professional Engineer  
and/or Land Surveyor

4115