

(SUBMIT IN TRIPLICATE)

UNITED STATES  
DEPARTMENT OF THE INTERIOR  
GEOLOGICAL SURVEY

Land Office

Lease No.

Unit

RECEIVED

MAY 19 1960

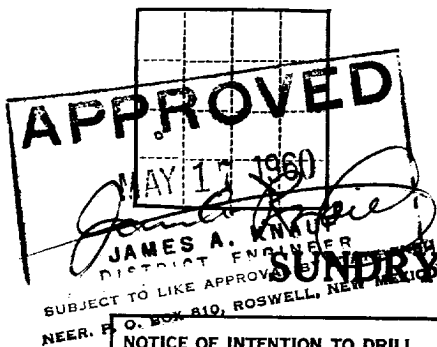

## SUNDRY NOTICES AND REPORTS ON WELLS

ARTESIA, OFFICE

NOTICE OF INTENTION TO DRILL	<input checked="" type="checkbox"/>	SUBSEQUENT REPORT OF WATER SHUT-OFF	
NOTICE OF INTENTION TO CHANGE PLANS		SUBSEQUENT REPORT OF SHOOTING OR ACIDIZING	
NOTICE OF INTENTION TO TEST WATER SHUT-OFF		SUBSEQUENT REPORT OF ALTERING CASING	
NOTICE OF INTENTION TO RE-DRILL OR REPAIR WELL		SUBSEQUENT REPORT OF RE-DRILLING OR REPAIR	
NOTICE OF INTENTION TO SHOOT OR ACIDIZE		SUBSEQUENT REPORT OF ABANDONMENT	
NOTICE OF INTENTION TO PULL OR ALTER CASING		SUPPLEMENTARY WELL HISTORY	
NOTICE OF INTENTION TO ABANDON WELL			

(INDICATE ABOVE BY CHECK MARK NATURE OF REPORT, NOTICE, OR OTHER DATA)

Evarts  
Federal

May 13, 1960

Well No. 2 is located 1900 ft. from S line and 660 ft. from W line of sec. 53

NW 4 SW 4  
(1/4 Sec. and Sec. No.)17S  
(Twp.)27E  
(Range)NMPM  
(Meridian)Red Lake  
(Field)Eddy  
(County or Subdivision)New Mexico  
(State or Territory)

The elevation of the derrick floor above sea level is 3539 ft. GL.

## DETAILS OF WORK

(State names of and expected depths to objective sands; show sizes, weights, and lengths of proposed casings; indicate mudding jobs, cementing points, and all other important proposed work)

Queen Sand	600'	7" casing to 1000' and cemented to surface in 8-3/4" hole
Grayburg	950'	4 1/2" casing to approximately 2100' and cemented from bottom
San Andres	1250'	to approximately 900'
Pay Zone	1800'	

TD Approximately 2100' Will frac on completion if necessary

APPROVAL IS SUBJECT TO STATE  
ENGINEER REGULATIONS REQUIRED  
ON "APPLICATION FOR PERMIT TO  
DRILL FOR OIL" IN WATER BASIN.  
BOX 810, ROSWELL, NEW MEXICO

I understand that this plan of work must receive approval in writing by the Geological Survey before operations may be commenced.

Company Graridge Corporation

Address Box 752

Breckenridge, Texas

By

Charles E. Smith

Title

Production Clerk

ILLEGIBLE

NEW MEXICO OIL CONSERVATION COMMISSION

Well Location and Acreage Dedication Plat

Section A.

Date May 13, 1960

Operator Grariggs Corporation Lease Evarts  
Well No. 2 Unit Letter L Section 35 Township 17S Range 27E NMPM  
Located 1080 Feet From South Line, 660 Feet From West Line  
County Eddy G. L. Elevation 3539 Dedicated Acreage West Acres  
Name of Producing Formation San Andres Pool Red Lake

1. Is the Operator the only owner\* in the dedicated acreage outlined on the plat below?  
Yes X No       .
2. If the answer to question one is "no," have the interests of all the owners been consolidated by communitization agreement or otherwise? Yes        No       . If answer is "yes," Type of Consolidation
3. If the answer to question two is "no," list all the owners and their respective interests below:

Owner

Land Description

Section B

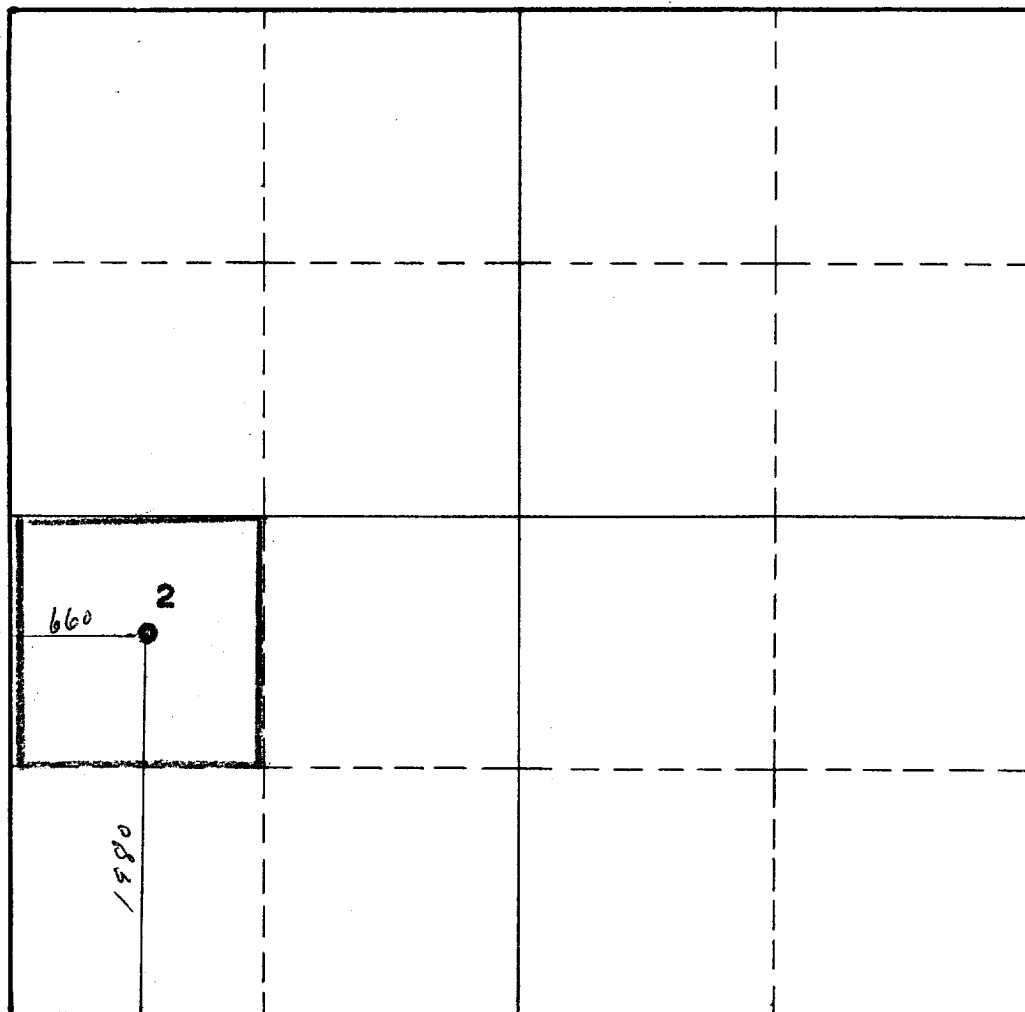

This is to certify that the information in Section A above is true and complete to the best of my knowledge and belief.

Grariggs Corporation  
(Operator)  
Charles W. Matis  
(Representative)

Address

This is to certify that the well location shown on the plat in Section B was plotted from field notes of actual surveys made by me or under my supervision and that the same is true and correct to the best of my knowledge and belief.

Date Surveyed May 17, 1960

John A. Mathis Jr.  
Registered Professional  
Engineer and/or Land Surveyor.

Certificate No. 1502