

NOTICE OF INTENTION TO DRILL

Notice must be given to the District Office of the Oil Conservation Commission and approval obtained before drilling or recompletion begins. If changes in the proposed plan are considered advisable, a copy of this notice showing such changes will be returned to the sender. Submit this notice in **QUINTUPPLICATE**. One copy will be returned following approval. See additional instructions in Rules and Regulations of the Commission. **If State Land submit 6 Copies Attach Form G- 128 in triplicate to first 3 copies of form G-101**

Artesia, New Mexico
(Place)

March 20, 1959
(Date)

OIL CONSERVATION COMMISSION
SANTA FE, NEW MEXICO

30-015-01382

Gentlemen:

You are hereby notified that it is our intention to commence the **Drilling** of a well to be known as

N. Gordon Phillips
(Company or Operator)

State Welch
(Lease)

Well No. 2

in N
(Unit)

The well is

located 990' feet from the South line and 1980' feet from the West line of Section 15, T. 17S, R. 28E, NMPM.

(GIVE LOCATION FROM SECTION LINE) Red Lake Pool, Eddy County

If State Land the Oil and Gas Lease is No. R - 1969

If patented land the owner is

Address

We propose to drill well with drilling equipment as follows: Cable Tools

The status of plugging bond is Single Well Bond 39 - B1

Drilling Contractor Tom Boyd Drilling Company

We intend to complete this well in the Premier formation at an approximate depth of 2,000 feet.

CASING PROGRAM

We propose to use the following strings of Casing and to cement them as indicated:

Size of Hole	Size of Casing	Weight per Foot	New or Second Hand	Depth	Sacks Cement
12 1/2"	10 3/4"	38#	Second Hand	312'	Mud
10 "	8 5/8"	28#	Second Hand	375'	50 sacks
8 "	5 1/2"	14#	Second Hand	2,000'	100 sacks

If changes in the above plans become advisable we will notify you immediately.

ADDITIONAL INFORMATION (If recompletion give full details of proposed plan of work.)

Approved _____, 19____
Except as follows:

OIL CONSERVATION COMMISSION
By M. L. Armstrong

Sincerely yours,

N. Gordon Phillips
(Company or Operator)

By Louis C. Baker

Position Agent

Send Communications regarding well to

Name N. Gordon Phillips

Address Box 638, Artesia, New Mexico

NEW MEXICO OIL CONSERVATION COMMISSION
WELL LOCATION AND ACREAGE DEDICATION PLAT

FORM C-128
 Revised 5/1/57

SEE INSTRUCTIONS FOR COMPLETING THIS FORM ON THE REVERSE SIDE

SECTION A

Operator <i>N. Gordon Phillips</i>			Lease <i>State Butte (Welch)</i>		Well No. <i>2</i>
Unit Letter <i>N</i>	Section <i>15</i>	Township <i>17S</i>	Range <i>28E</i>	County <i>Eddy</i>	
Actual Footage Location of Well: <i>990</i> feet from the <i>South</i> line and <i>1980</i> feet from the <i>West</i> line					
Ground Level Elev. <i>3540</i>	Producing Formation <i>PREMIER</i>		Pool <i>RED LAKE</i>	Dedicated Acreage: <i>40</i> Acres	

1. Is the Operator the only owner in the dedicated acreage outlined on the plat below? YES ☒ NO ____ . ("Owner" means the person who has the right to drill into and to produce from any pool and to appropriate the production either for himself or for himself and another. (65-3-29 (e) NMSA 1935 Comp.)
2. If the answer to question one is "no," have the interests of all the owners been consolidated by communitization agreement or otherwise? YES ____ NO ____ . If answer is "yes," Type of Consolidation ____
3. If the answer to question two is "no," list all the owners and their respective interests below:

Owner	Land Description

SECTION B *R28E*

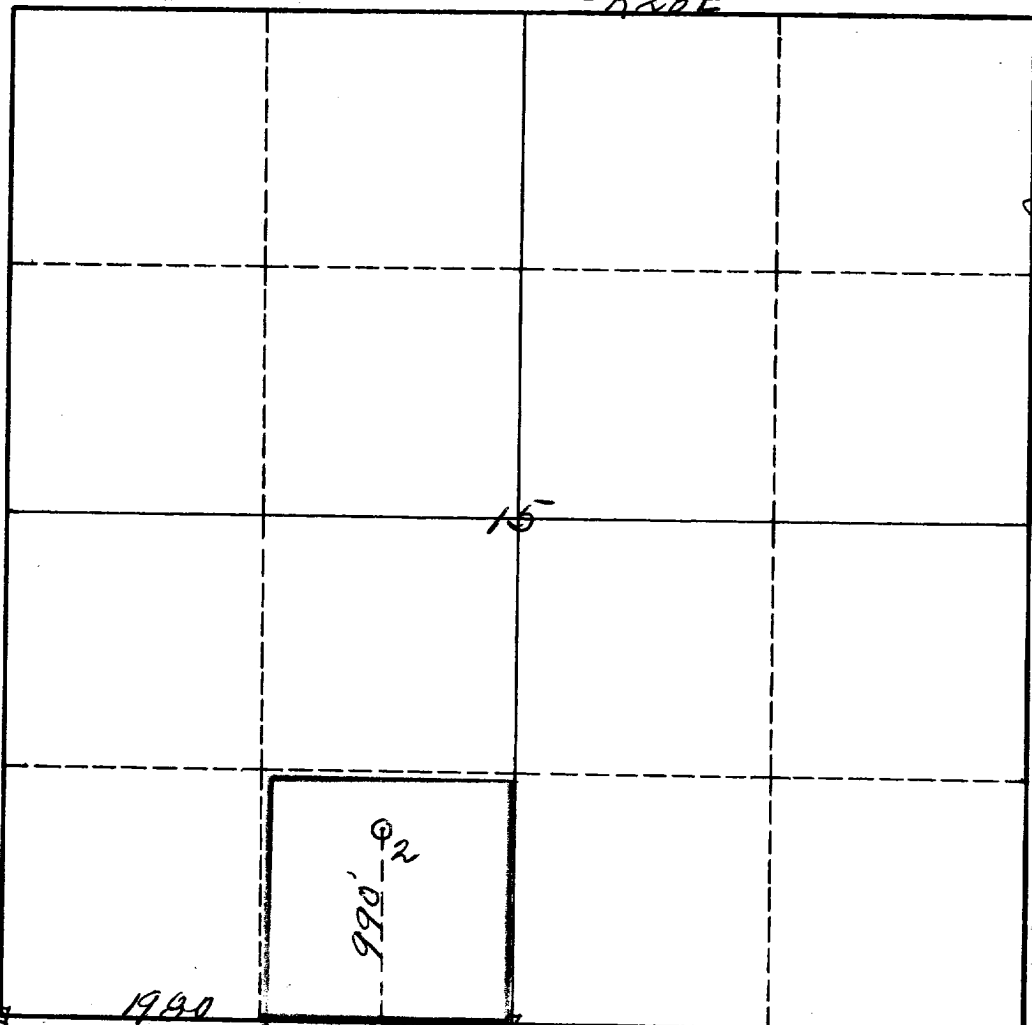

CERTIFICATION

I hereby certify that the information in SECTION A above is true and complete to the best of my knowledge and belief.

Louis E. Baker
 Name
AGENT
 Position
N. GORDON PHILLIPS
 Company
MARCH 20, 1959
 Date

I hereby certify that the well location shown on the plat in SECTION B was plotted from field notes of actual surveys made by me or under my supervision, and that the same is true and correct to the best of my knowledge and belief.

Date Surveyed
March 17th 1959
 Registered Professional Engineer
 and/or Land Surveyor

James A. Brown
 Certificate No. *542*

INSTRUCTIONS FOR COMPLETION OF FORM C-128

1. Operator shall furnish and certify to the information called for in Section A.
2. Operator shall outline the dedicated acreage for *both* oil and gas wells on the plat in Section B.
3. A registered professional engineer or land surveyor registered in the State of New Mexico or approved by the Commission shall show on the plat the location of the well and certify this information in the space provided.
4. All distances shown on the plat must be from the outer boundaries of the Section.
5. If additional space is needed for listing owners and their respective interests as required in question 3 of Section A, please use space below.