

NEW MEXICO OIL CONSERVATION COMMISSION
Santa Fe, New Mexico

NOTICE OF INTENTION TO DRILL OR RECOMPLETE

Notice must be given to the District Office of the Oil Conservation Commission and approval obtained before drilling or recompletion begins. If changes in the proposed plan are considered advisable, a copy of this notice showing such changes will be returned to the sender. Submit this notice in QUINTUPLICATE. One copy will be returned following approval. See additional instructions in Rules and Regulations of the Commission.

If State Land submit 6 Copies

Midland, Texas
(Place)

July 16 1962 RECEIVED
(Date)

OIL CONSERVATION COMMISSION
SANTA FE, NEW MEXICO

JUL 16 1962

Gentlemen:

You are hereby notified that it is our intention to commence the (Drilling) ~~completion~~ of a well to be

D. C. C.
ARTESIA OFFICE

Delhi-Taylor Oil Corporation
(Company or Operator)

State
(Lease)

Well No. 15

N

(Unit)

The well is

located 1980 feet from the South West line and 660 feet from the

line of Section 28, T. 17S, R. 28E, NMPM.

(GIVE LOCATION FROM SECTION LINE)

Artesia Red Lake Pool, Eddy County

If State Land the Oil and Gas Lease is No. B-4575

If patented land the owner is

Address

We propose to drill well with drilling equipment as follows: Cable tools

The status of plugging bond is Active

Drilling Contractor Kincaid & Watson

We intend to complete this well in the Grayburg

formation at an approximate depth of 2000 feet.

CASING PROGRAM

We propose to use the following strings of Casing and to cement them as indicated:

Size of Hole	Size of Casing	Weight per Foot	New or Second Hand	Depth	Sacks Cement
10"	8-5/8"	20	New	500	50
8"	4-1/2"	9.5	New	2100	100

If changes in the above plans become advisable we will notify you immediately.

ADDITIONAL INFORMATION (If recompletion give full details of proposed plan of work.)

Case pay zone. Jet perforate. Sand-oil fracture for production.

JUL 16 1962

Approved _____, 19____
Except as follows:

Sincerely yours,

DELHI-TAYLOR OIL CORPORATION
(Company or Operator)

By *A. J. Belton*

Position District Superintendent

Send Communications regarding well to

Name Delhi-Taylor Oil Corporation

Address Box 1821, Midland, Texas

OIL CONSERVATION COMMISSION

By *M. L. Armstrong*

NUMBER OF COPIES RECEIVED	
DISTRIBUTION	
SANTA FE	
FILE	
U.S.G.S.	
LAND OFFICE	
TRANSPORTER	OIL
	GAS
PRODUCTION OFFICE	
OPERATOR	

NEW MEXICO OIL CONSERVATION COMMISSION
WELL LOCATION AND ACREAGE DEDICATION PLAT
 SEE INSTRUCTIONS FOR COMPLETING THIS FORM ON THE REVERSE SIDE

FORM C-128
 Revised 5/1/57

SECTION A

Operator Delhi Taylor Oil Corp.		Lease		State		Well No. 15
Unit Letter M	Section 28	Township T-17-S	Range R-28-E	County Eddy		
Actual Footage Location of Well: 660 feet from the South line and 1980 feet from the West line						
Ground Level Elev. 3683	Producing Formation Grayburg		Pool Artesia Red Lake	Dedicated Acreage: 40 Acres		

1. Is the Operator the only owner in the dedicated acreage outlined on the plat below? YES X NO ____ . ("Owner" means the person who has the right to drill into and to produce from any pool and to appropriate the production either for himself or for himself and another. (65-3-29 (e) NMSA 1935 Comp.)
2. If the answer to question one is "no," have the interests of all the owners been consolidated by communitization agreement or otherwise? YES ____ NO ____ . If answer is "yes," Type of Consolidation _____
3. If the answer to question two is "no," list all the owners and their respective interests below:

Owner	Land Description

SECTION B

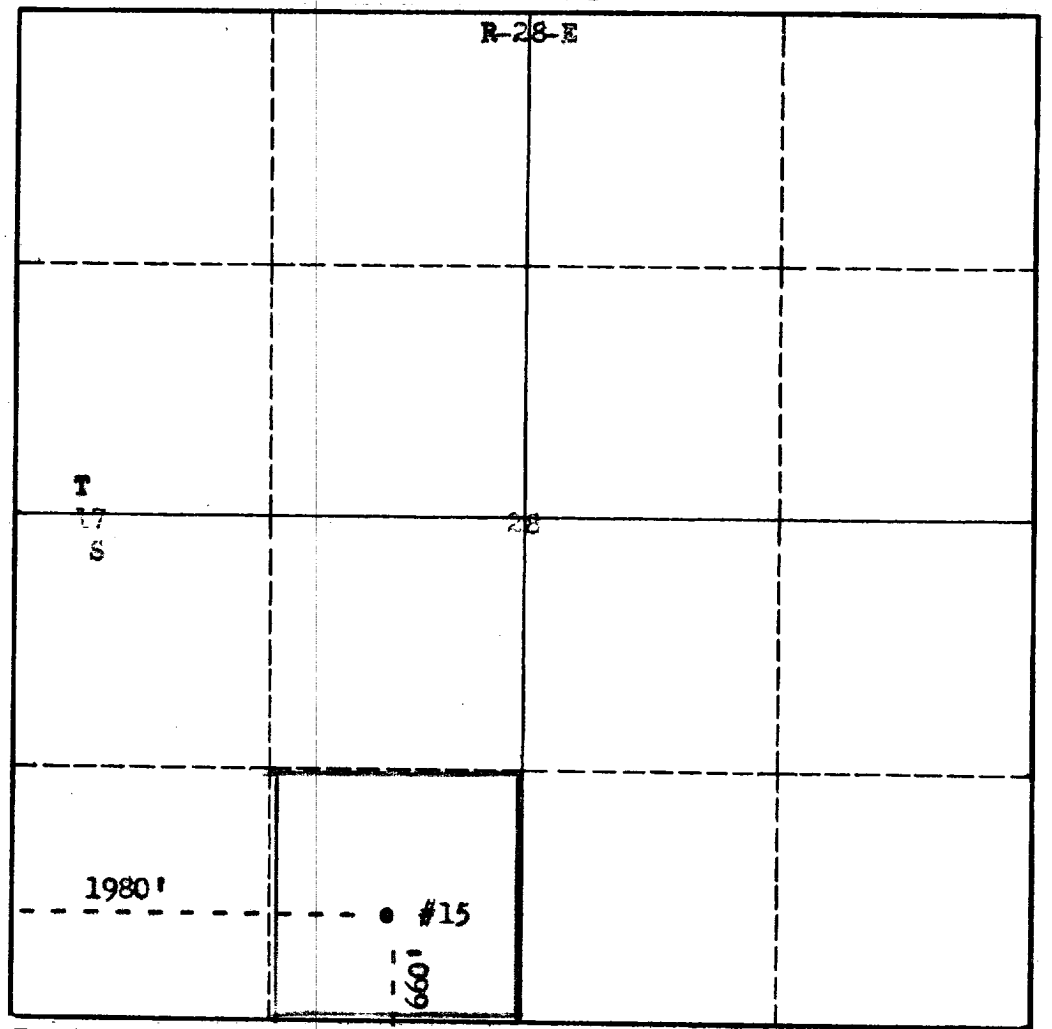

CERTIFICATION

I hereby certify that the information in SECTION A above is true and complete to the best of my knowledge and belief.

Name
<i>J. J. [Signature]</i>
Position
District Superintendent
Company
Delhi-Taylor Oil Corp.
Date
July 13, 1962

I hereby certify that the well location shown on the plat in SECTION B was plotted from field notes of actual surveys made by me or under my supervision, and that the same is true and correct to the best of my knowledge and belief.

Date Surveyed
July 10, 1962
Registered Professional Engineer and/or Land Surveyor
<i>[Signature]</i>

Certificate No. **3280**

