

NEW MEXICO OIL CONSERVATION COMMISSION
Santa Fe, New Mexico

RECEIVED
Revised (12/1/55)

FEB 23 1960

30-015-01650

NOTICE OF INTENTION TO DRILL

Notice must be given to the District Office of the Oil Conservation Commission and approval obtained before drilling or recompletion begins. If changes in the proposed plan are considered advisable, a copy of this notice showing such changes will be returned to the sender. Submit this notice in QUINTUPLICATE. One copy will be returned following approval. See additional instructions in Rules and Regulations of the Commission. If State Land submit 6 Copies Attach Form G-128 in triplicate to first 3 copies of form G-101

Hobbs, New Mexico

(Place)

February 22, 1960

(Date)

OIL CONSERVATION COMMISSION
SANTA FE, NEW MEXICO

Gentlemen:

You are hereby notified that it is our intention to commence the Drilling of a well to be known as

Pan American Petroleum Corporation

(Company or Operator)

State of New Mexico "BJ"

(Lease)

Well No. 2, in J The well is

located 1650 feet from the South line and 1958.35 feet from the

East

line of Section 31, T 17S, R 28E, NMPM.

(GIVE LOCATION FROM SECTION LINE)

Empire Abo Pool, Eddy County

If State Land the Oil and Gas Lease is No. B-2071

If patented land the owner is

Address

We propose to drill well with drilling equipment as follows: 0 - TD with rotary tools

The status of plugging bond is Blanket bond on file with Commission

Drilling Contractor Lee Drilling Co.

Philtower Bldg., Tulsa, Oklahoma

We intend to complete this well in the Abo formation at an approximate depth of 6500 feet.

CASING PROGRAM

We propose to use the following strings of Casing and to cement them as indicated:

Size of Hole	Size of Casing	Weight per Foot	New or Second Hand	Depth	Sacks Cement
11"	8-5/8"	22.7#	New	1300'	circ.
7-7/8"	5-1/2"	14#	New	6500'	850 sz

If changes in the above plans become advisable we will notify you immediately.

ADDITIONAL INFORMATION (If recompletion give full details of proposed plan of work.)

FEB 23 1960

Approved....., 19.....
Except as follows:

OIL CONSERVATION COMMISSION

By M. L. Armstrong

Sincerely yours,

Pan American Petroleum Corporation

(Company or Operator)

By.....

Position **Area Superintendent**

Send Communications regarding well to

Name **J. W. Brown**

Address **Box 68 - Hobbs NM**

RECEIVED

NEW MEXICO OIL CONSERVATION COMMISSION
WELL LOCATION AND ACREAGE DEDICATION PLATFORM C-128
Revised 5/1/57

FEB 23 1960

SEE INSTRUCTIONS FOR COMPLETING THIS FORM ON THE REVERSE SIDE **D. C. C.**

SECTION A

ARTESIAN OFFICE

Operator Pan American Petroleum Corp			Lease State BJ		Well No. 2
Unit Letter J	Section 31	Township 17 South	Range 28 East	County Eddy	
Actual Footage Location of Well: 1958.35 feet from the East line and 1650 feet from the South line					
Ground Level Elev. Not Yet Avail.	Producing Formation Abo		Pool Undesign Empire Abo		Dedicated Acreage: 40 Acres

1. Is the Operator the only owner in the dedicated acreage outlined on the plat below? YES ☒ NO ____ . ("Owner" means the person who has the right to drill into and to produce from any pool and to appropriate the production either for himself or for himself and another. (65-3-29 (e) NMSA 1935 Comp.)
2. If the answer to question one is "no," have the interests of all the owners been consolidated by communitization agreement or otherwise? YES ____ NO ____ . If answer is "yes," Type of Consolidation ____
3. If the answer to question two is "no," list all the owners and their respective interests below:

Owner	Land Description

SECTION B

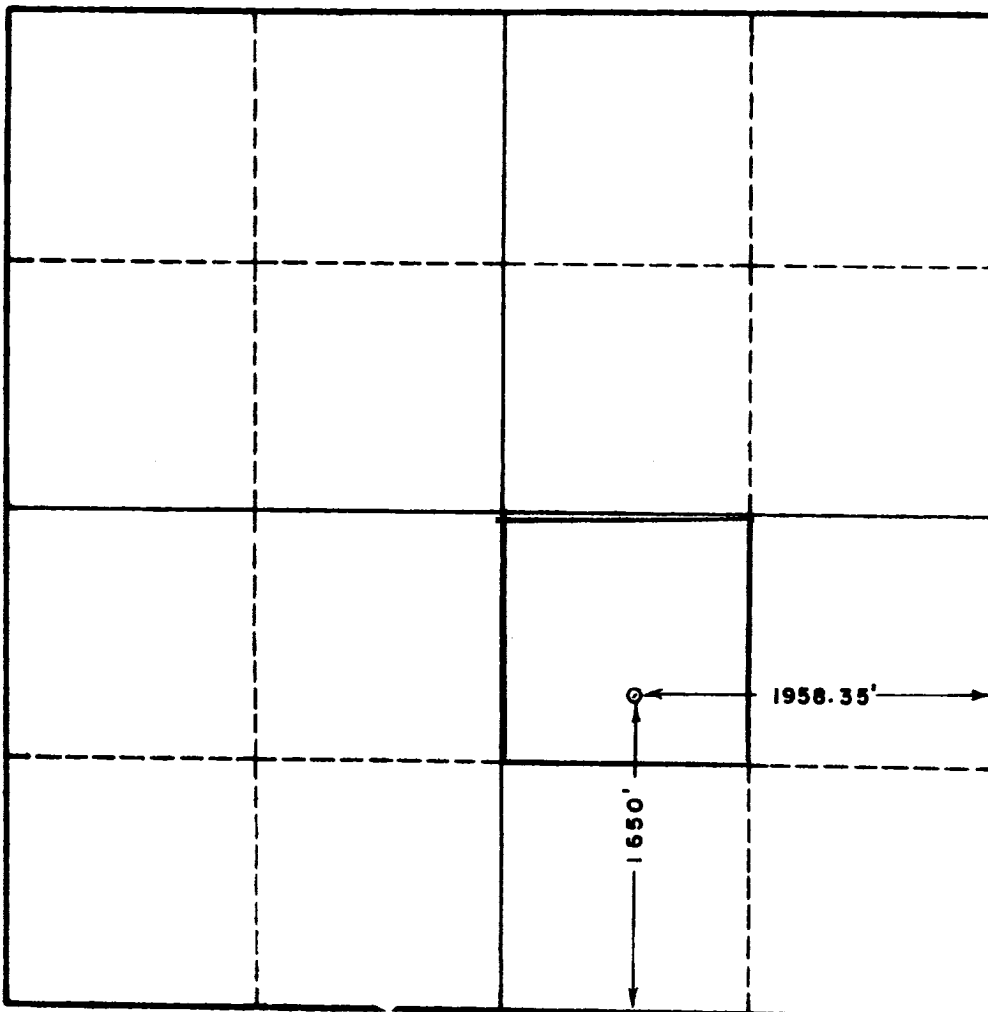

CERTIFICATION

I hereby certify that the information in SECTION A above is true and complete to the best of my knowledge and belief.

Name Original Signed by
J. W. BROWN

Position
Area Superintendent
Company
Pan American Petr. Corp.

Date
2-22-60

I hereby certify that the well location shown on the plat in SECTION B was plotted from field notes of actual surveys made by me or under my supervision, and that the same is true and correct to the best of my knowledge and belief.

Feb 20, 1960

Date Surveyed

Registered Professional Engineer
and/or Land Surveyor, **JOHN W. WEST**

John W. West
Certificate No.

N. M. - P. E. & L. S. NO. 676

JOHN W. WEST ENGINEERING COMPANY

412 NORTH DAL PASO
HOBBS, NEW MEXICO

February 20, 1960

RECEIVED

FEB 23 1960

J. C. C.
ARTESIA, OFFICE

Pan American Petroleum Corp.
P. O. Box 68,
Hobbs, New Mexico.

Gentlemen:

On February 20, 1960, a survey was made to locate your State BJ Well No. 2 at a point 1958.35 feet from the east line, and 1650 feet from the south line, and your State BM Well No. 1 at a point 2387.22 feet from the west line, and 1650 feet from the south line, and your State BE Well No. 2 at a point 1089.33 feet from the west line, and 1651.12 feet from the south line, all in Sec. 31, Twp 17 S, Rng 28 E, N.M.P.M., Eddy County, New Mexico.

Beginning at a point marked by a 2 inch iron pipe with a brass plate inscribed as the common corner of Sec. 31, and 32, Twp 17 S, Rng 28 E, and Sec 5, and 6, Twp 18 S, Rng 28 E, N.M.P.M.; thence chaining S 88° 55' W, along the south boundary line of said Sec. 31 a distance of 1958.35 feet to a point marked by a 2 inch wooden hub, from which the south quarter corner of said Sec 31, common to the north quarter corner of Sec 6, Twp 18 S, Rng 28 E, marked by a 1 inch iron pipe with brass plate, bears S 88° 55' W, a distance of 642.71 feet; thence N 0° 34' W, a distance of 1650 feet to the point of location of your State BJ Well No. 2; thence S 88° 55' W, a distance of 972.71 feet to the point of location of your Stat BM Well No. 1; Thence S 88° 58' W, a distance of 1297.89 feet to the point of location of your B E Well No. 2; thence S 88° 55' W, a distance of 1089.33 feet to a point marked in the west boundary line of said Sec. 31 by a 2 inch wooden hub; thence S 0° 18' E along the west boundary line of said Sec 31 a distance of 1651.12 feet to a point marked by a 2 inch iron pipe with a brass plate inscribed as the southwest corner of said Sec 31.

I hereby certify that the foregoing survey was made in the field under my supervision and that the same is true and correct to the best of my knowledge and belief.

Respectfully submitted,

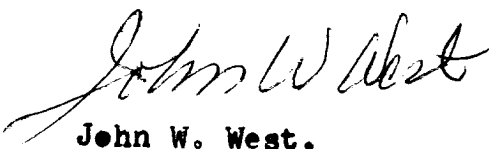

John W. West.

OIL CONSERVATION COMMISSION

ARTESIA DISTRICT OFFICE

No. Copies Received

6

DISTRIBUTION

	NO. FURNISHED	
OPERATOR	1	
SANTA FE	1	
PRODUCTION OFFICE		
STATE LAND OFFICE	1	
U. S. G. S.	2	
TRANSPORTER		
FILE	1	✓
BUREAU OF MINES		