

30-015-10885

Form C-101
Revised 1-1-65

NEW MEXICO OIL CONSERVATION COMMISSION

NO. OF COPIES RECEIVED	6
DISTRIBUTION	
SANTA FE	1
FILE	1
U.S.G.S.	3
LAND OFFICE	7
OPERATOR	1

5A. Indicate Type of Lease	
STATE <input checked="" type="checkbox"/>	FEE <input type="checkbox"/>
5. State Oil & Gas Lease No.	
B-8617	

APPLICATION FOR PERMIT TO DRILL, DEEPEN, OR PLUG BACK

1a. Type of Work		DRILL <input checked="" type="checkbox"/> DEEPEN <input type="checkbox"/> PLUG BACK <input type="checkbox"/>	
b. Type of Well		OIL WELL <input checked="" type="checkbox"/> GAS WELL <input type="checkbox"/> OTHER <input type="checkbox"/> SINGLE ZONE <input type="checkbox"/> MULTIPLE ZONE <input type="checkbox"/>	
2. Name of Operator		R. D. Collier	
3. Address of Operator		Artesia, New Mex.	
4. Location of Well		UNIT LETTER <u>1</u> LOCATED <u>1650</u> FEET FROM THE <u>South</u> LINE	
AND <u>1650</u> FEET FROM THE <u>East</u> LINE OF SEC. <u>16</u> TWP. <u>17</u> RGE. <u>28</u> NMPM			
7. Unit Agreement Name		Hammond Bros.	
8. Firm or Lease Name		Yates State	
9. Well No.		1	
10. Field and Pool, or Wildcat		Red Lake	
12. County		Eddy	
19. Proposed Depth		2000	
19A. Formation		premier sand	
20. Rotary or C.T.		C. T.	
21. Elevations (Show whether DF, RT, etc.)		3586	
21A. Kind & Status Plug. Bond		Blanket	
21B. Drilling Contractor		Hammond Bros.	
22. Approx. Date Work will start		10/29/66	

23.

PROPOSED CASING AND CEMENT PROGRAM

SIZE OF HOLE	SIZE OF CASING	WEIGHT PER FOOT	SETTING DEPTH	SACKS OF CEMENT	EST. TOP
10	8 5/8	24	500	50	
8	5 1/2	9 1/4	1800	75	

Propose to drill to 2000' or test premier sand. Will run 500' of 8 5/8 casing will cement with 50 sacks. Will run 5 1/2 casing for oil string and cement.

RECEIVED

APPROVAL VALID
FOR 90 DAYS UNLESS
DRILLING COMMENCED.

EXPIRES 1-31-67

NOV 1 1966

O. C. C.
ARTESIA, OFFICE

IN ABOVE SPACE DESCRIBE PROPOSED PROGRAM: IF PROPOSAL IS TO DEEPEN OR PLUG BACK, GIVE DATA ON PRESENT PRODUCTIVE ZONE AND PROPOSED NEW PRODUCTIVE ZONE. GIVE BLOWOUT PREVENTER PROGRAM, IF ANY.

I hereby certify that the information above is true and complete to the best of my knowledge and belief.

Signed R. D. Collier Title operator Date 10/28/66

(This space for State Use)

APPROVED BY W. P. Gracett TITLE OIL AND GAS INSPECTOR DATE 10/27/66

CONDITIONS OF APPROVAL, IF ANY:

NEW MEXICO OIL CONSERVATION COMMISSION
WELL LOCATION AND ACREAGE DEDICATION PLAT

Form C-102
Supersedes C-128
Effective 1-1-65

All distances must be from the outer boundaries of the Section.

Operator R.D. Collier		Lease Yates--State		Well No. 1
Unit Letter J	Section 16	Township 17 South	Range 28 East	County Eddy
Actual Footage Location of Well: 1650 feet from the South line and 1650 feet from the East line				
Ground Level Elev: 3586	Producing Formation	Pool	Dedicated Acreage: 40 Acres	

1. Outline the acreage dedicated to the subject well by colored pencil or hatchure marks on the plat below.
2. If more than one lease is dedicated to the well, outline each and identify the ownership thereof (both as to working interest and royalty).
3. If more than one lease of different ownership is dedicated to the well, have the interests of all owners been consolidated by communitization, unitization, force-pooling, etc?

RECEIVED

☐ Yes ☐ No If answer is "yes," type of consolidation **NOV 1 1966**

If answer is "no," list the owners and tract descriptions which have actually been consolidated. (Use reverse side of this form if necessary.) **O.C.C. ARTESIA, OFFICE**

No allowable will be assigned to the well until all interests have been consolidated (by communitization, unitization, forced-pooling, or otherwise) or until a non-standard unit, eliminating such interests, has been approved by the Commission.

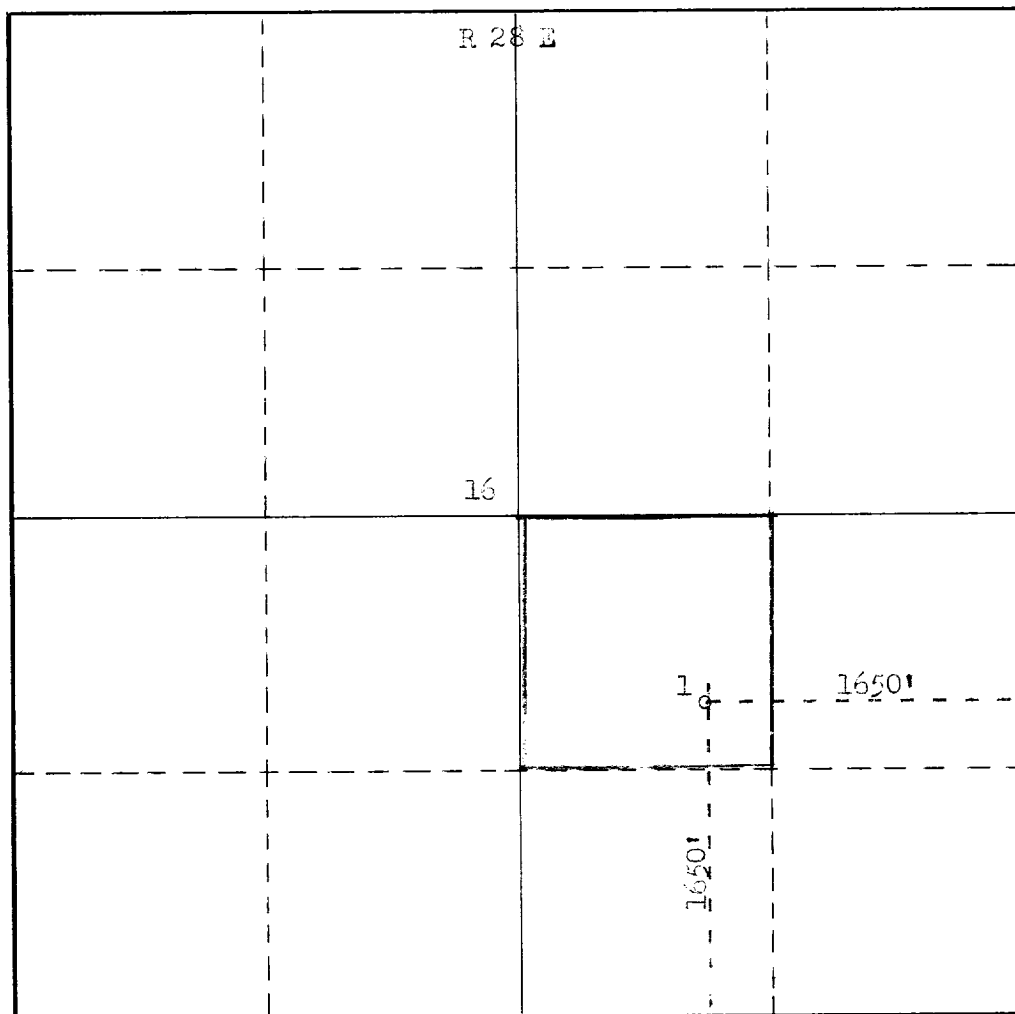

CERTIFICATION

I hereby certify that the information contained herein is true and complete to the best of my knowledge and belief.

Name **R.D. Collier**
Position **Operator**
Company **Hammond Bros**
Date **Oct 28/66**

I hereby certify that the well location shown on this plat was plotted from field notes of actual surveys made by me or under my supervision, and that the same is true and correct to the best of my knowledge and belief.

Date Surveyed **October, 28, 1966**
Registered Professional Engineer and/or Land Surveyor

James H. Loran
Certificate No. **H.M.L.S. No. 542**