

UNITED STATES  
DEPARTMENT OF THE INTERIOR  
GEOLOGICAL SURVEYSUBMIT IN TRIP DATE\*  
(Other instruction on re-  
verse side)

30-015-21917

Form approved.  
Budget Bureau No. 42-R1424.

5. LEASE DESIGNATION AND SERIAL NO.

NM 0219603

6. IF INDIAN, ALLOTTEE OR TRIBE NAME

7. UNIT AGREEMENT NAME

8. FARM OR LEASE NAME

Federal "BZ"

9. WELL NO.

16

10. FIELD AND POOL, OR WILDCAT

X Eagle Creek San Andres

11. SEC., T., R., M., OR BLK. AND  
SURVEY OR AREA

Unit H

Sec. 28-17S-25E

12. COUNTY OR PARISH

Eddy

13. STATE

NM

## SUNDRY NOTICES AND REPORTS ON WELLS

(Do not use this form for proposals to drill or to deepen or plug back a different reservoir.

Use "APPLICATION FOR PERMIT—" for such proposals.

RECEIVED

MAY 21 1979

O.C.C.  
ARTESIA. OFFICE1. OIL ☒ GAS ☐  
WELL WELL OTHER

2. NAME OF OPERATOR

Yates Petroleum Corporation

3. ADDRESS OF OPERATOR

207 South Fourth Street - Artesia, NM 88210

4. LOCATION OF WELL (Report location clearly and in accordance with any State requirements.\*  
See also space 17 below.)

At surface 1980' FNL &amp; 660' FEL of Section 28-17S-25E

14. PERMIT NO.

15. ELEVATIONS (Show whether DF, RT, GR, etc.)

3550' GR; 3566' KB

16. Check Appropriate Box To Indicate Nature of Notice, Report, or Other Data

## NOTICE OF INTENTION TO:

TEST WATER SHUT-OFF

FRACTURE TREAT

SHOOT OR ACIDIZE

REPAIR WELL

(Other) Re-entry

PULL OR ALTER CASING

MULTIPLE COMPLETE

ABANDON\*

CHANGE PLANS

X

## SUBSEQUENT REPORT OF:

WATER SHUT-OFF

FRACTURE TREATMENT

SHOOTING OR ACIDIZING

(Other)

REPAIRING WELL

ALTERING CASING

ABANDONMENT\*

(NOTE: Report results of multiple completion on Well  
Completion or Recompletion Report and Log form.)17. DESCRIBE PROPOSED OR COMPLETED OPERATIONS (Clearly state all pertinent details, and give pertinent dates, including estimated date of starting any  
proposed work. If well is directionally drilled, give subsurface locations and measured and true vertical depths for all markers and zones perti-  
nent to this work.)\*

OTD 8302 P &amp; A 10-25-76

This old deep test was plugged back to 1500' and capped with a dry hole marker in October, 1976'. The pad and access road were left "as is" except for the pits which were levelled. We propose now to remove the cap and marker, to clean out the hole to 1500' and run 5½" 14# J-55 casing and cement to the surface. Will perforate and sand frac for San Andres completion.

18. I hereby certify that the foregoing is true and correct

SIGNED

TITLE Engineer

DATE 5-11-79

(This space for Federal or State office use)

APPROVED BY (Orig. Sgd.) ALBERT R. STALL

TITLE ACTING DISTRICT ENGINEER

DATE MAY 18 1979

CONDITIONS OF APPROVAL, IF ANY:

NEW MEXICO OIL CONSERVATION COMMISSION  
WELL LOCATION AND ACREAGE DEDICATION FORM

Form C-102  
Supersedes C-128  
Effective 1-1-65

All distances must be from the outer boundaries of the Section.

Operator <b>YATES PETROLEUM CORP</b>		Lease <b>Federal BZ</b>		Well No. <b>16</b>
Unit Letter	Section <b>28</b>	Township <b>17-S</b>	Range <b>25-E</b>	County <b>Eddy</b>
Actual Footage Location of Well: <b>1980</b> feet from the <b>North</b> line and <b>660</b> feet from the <b>East</b> line				
Ground Level Elev. <b>3550</b>	Producing Formation <b>San Andres</b>		Pool <b>Eagle Creek</b>	Dedicated Acreage: <b>40</b> Acres

1. Outline the acreage dedicated to the subject well by colored pencil or hatchure marks on the plat below.
2. If more than one lease is dedicated to the well, outline each and identify the ownership thereof (both as to working interest and royalty).
3. If more than one lease of different ownership is dedicated to the well, have the interests of all owners been consolidated by communitization, unitization, force-pooling, etc?

☐ Yes ☐ No If answer is "yes," type of consolidation \_\_\_\_\_

If answer is "no," list the owners and tract descriptions which have actually been consolidated. (Use reverse side of this form if necessary.) \_\_\_\_\_

No allowable will be assigned to the well until all interests have been consolidated (by communitization, unitization, forced-pooling, or otherwise) or until a non-standard unit, eliminating such interests, has been approved by the Commission.

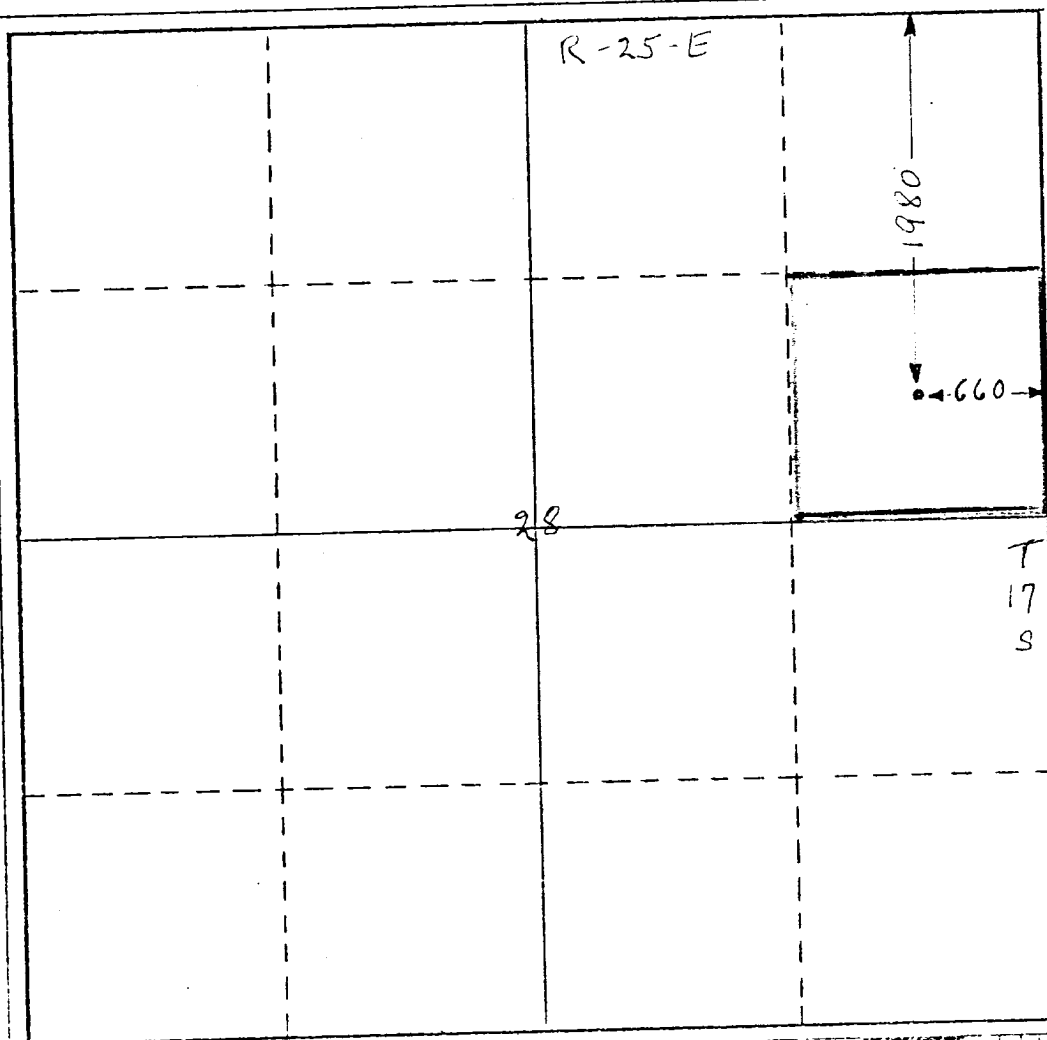

CERTIFICATION

I hereby certify that the information contained herein is true and complete to the best of my knowledge and belief.

*Eddie M. Mahfood*  
Name  
**EDDIE M MAHFOOD**  
Position  
**ENGINEER**  
Company  
**YATES PETROLEUM CORP**  
Date  
**5-11-79**

I hereby certify that the well location shown on this plat was plotted from field notes of actual surveys made by me or under my supervision, and that the same is true and correct to the best of my knowledge and belief.

Date Surveyed  
**Refer to Original Plat**  
Registered Professional Engineer  
and/or Land Surveyor

Cert. Plate No.

