

NO. OF COPIES RECEIVED	5
DISTRIBUTION	
SANTA FE	1
FILE	1
U.S.G.S.	2
LAND OFFICE	
OPERATOR	1

NEW MEXICO OIL CONSERVATION COMMISSION

MAY 31 1977

O. C. C.
ARTESIA, OFFICE

30-015-22166

Form C-101
Revised 1-1-65

5A. Indicate Type of Lease	
STATE <input type="checkbox"/>	FEE <input checked="" type="checkbox"/>
5. State Oil & Gas Lease No.	

APPLICATION FOR PERMIT TO DRILL, DEEPEN, OR PLUG BACK

1a. Type of Work		7. Unit Agreement Name	
b. Type of Well DRILL <input checked="" type="checkbox"/> DEEPEN <input type="checkbox"/> PLUG BACK <input type="checkbox"/> OIL WELL <input checked="" type="checkbox"/> GAS WELL <input type="checkbox"/> OTHER <input type="checkbox"/> SINGLE ZONE <input checked="" type="checkbox"/> MULTIPLE ZONE <input type="checkbox"/>		8. Farm or Lease Name Wolf	
2. Name of Operator Collier & Collier		9. Well No. 1	
3. Address of Operator P.O. Box 798, Artesia, NM 88210		10. Field and Pool, or Wildcat Und. E. Empire Y. 7R	
4. Location of Well ONLY LETTER <u>M</u> LOCATED <u>990</u> FEET FROM THE <u>South</u> LINE <u>330</u> FEET FROM THE <u>West</u> LINE OF SEC. <u>23</u> TWP. <u>17S</u> RGE. <u>28E</u> NADOM		11. County Eddy	
19. Proposed Depth 850		19A. Formation 7 Rivers	
20. History or C.T. CT		21. Estimated Contractor Hughes Drilling	
22. Approx. Date Work will start June 1, 1977		23. Elevation (show whether Dr, RL, etc.) 3590	
24. Kind & Status of Prop. Bond Statewide		25. Estimated Contractor Hughes Drilling	

PROPOSED CASING AND CEMENT PROGRAM

SIZE OF HOLE	SIZE OF CASING	WEIGHT PER FOOT	SETTING DEPTH	SACKS OF CEMENT	EST. TOP
10"	8 5/8"	24#	90'		
8"	7"	20#	450'	Water Shut off	
6 1/4"	5 1/2"	14#	845'	150 Surface	

June 1, 1977

Plan to spud 7 Rivers Test with 10" bit
Will drill approx 100' to check for surface water with 10 inch bit.
Will reduce hole to 8 1/4" and continue to 450' Srt intermediate 7" for water shut off.
Reduce hole to 6 1/4" to TD, run 5 1/2" circ. cement to surface.

APPROVAL VALID
FOR 90 DAYS UNLESS
DRILLING COMMENCED,
EXPIRES 9-1-77

IN ABOVE SPACE DESCRIBE PROPOSED PROGRAM IF PROPOSAL IS TO DEEPEN OR PLUG BACK, GIVE DATA ON PRESENT PRODUCTIVE ZONE AND PROPOSED NEW PRODUCTIVE ZONE, GIVE FLOWOUT PREVENTER PROGRAM, IF ANY.

I hereby certify that the information above is true and complete to the best of my knowledge and belief.

Signed [Signature] Title Agent Date May 31, 1977

(This space for State Use)

APPROVED BY [Signature] TITLE SUPERVISOR, DISTRICT II DATE JUN 1 1977

CONDITIONS OF APPROVAL, IF ANY:

Cement must be circulated to
surface behind 5 1/2" casing

Notice 1110 C.C. for sufficient
time to witness cementing
at 5 1/2"

MEXICO OIL CONSERVATION COMMISS
WELL LOCATION AND ACREAGE DEDICATION PLAT

Form C-102
 Supersedes C-128
 Effective 1-1-65

All distances must be from the outer boundaries of the Section

Operator COLLIER & COLLIER			Lease Wolf		Well No. 1
Unit Letter "M"	Section 23	Township 17 South	Range 28 East	County Eddy	
Actual Footage Location of Well: 990 feet from the South line and 330 feet from the West line					
Ground Level Elev. 3590.0	Producing Formation Y-SR	Pool W. E. Empire Y-SR		Dedicated Acreage: 40 Acres	

1. Outline the acreage dedicated to the **subject** well by colored pencil or hachure marks on the plat below.
2. If more than one lease is dedicated to the well, outline each and identify the ownership thereof (both as to working interest and royalty).
3. If more than one lease of different ownership is dedicated to the well, have the interests of all owners been consolidated by communitization, unitization, force-pooling, etc?

☐ Yes ☐ No If answer is "yes," type of consolidation _____

If answer is "no," list the owners and tract descriptions which have actually been consolidated. (Use reverse side of this form if necessary.) _____

No allowable will be assigned to the well until all interests have been consolidated (by communitization, unitization, forced-pooling, or otherwise) or until a non-standard unit, eliminating such interests, has been approved by the Commission.

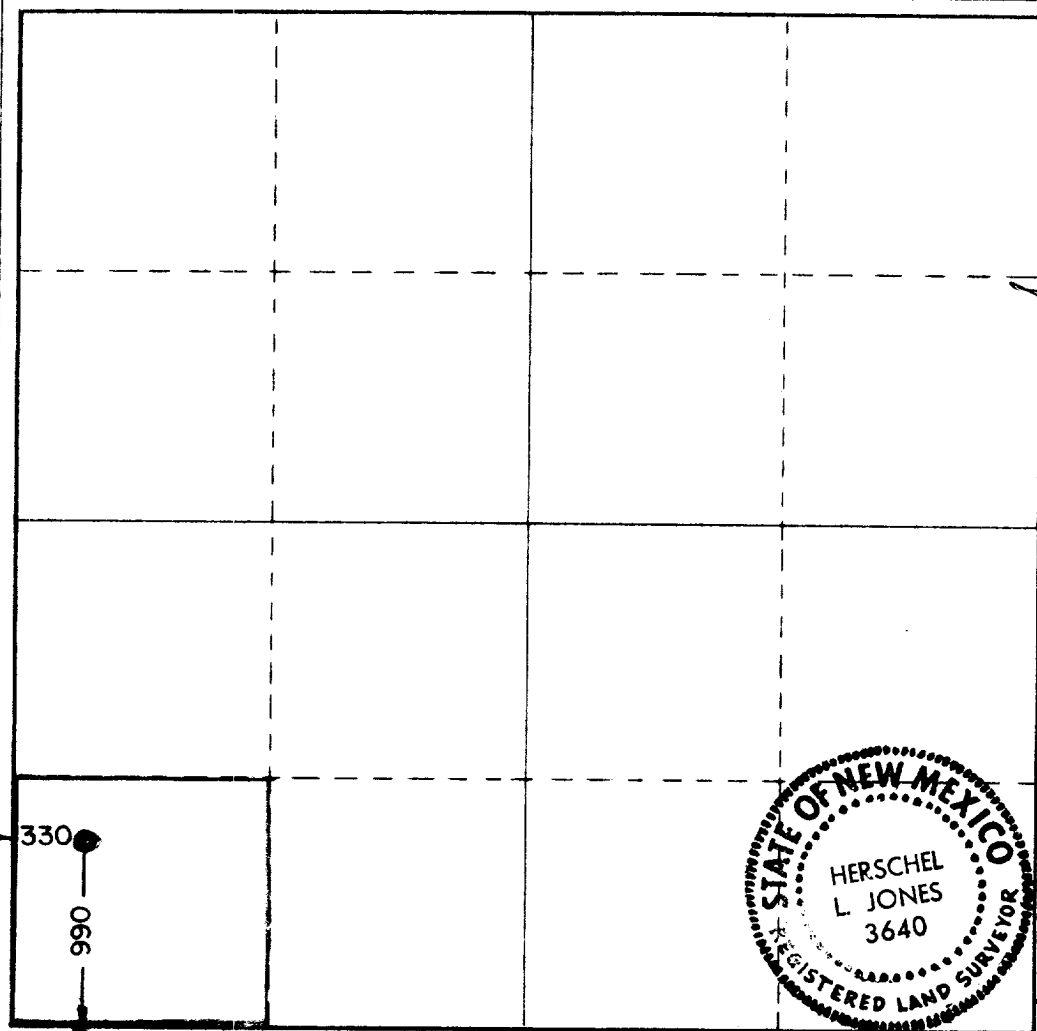

CERTIFICATION

I hereby certify that the information contained herein is true and complete to the best of my knowledge and belief.

Name *Timothy D. Collier*
 Position *Partner*
 Company *Collier & Collier*
 Date *May 18, 1977*

I hereby certify that the well location shown on this plat was plotted from field notes of actual surveys made by me or under my supervision, and that the same is true and correct to the best of my knowledge and belief.

Date Surveyed
May 18, 1977
 Registered Professional Engineer
 and/or Land Surveyor

Herschel L. Jones
 Certificate No.
3640