

NEW MEXICO OIL CONSERVATION COMMISSION
WELL LOCATION AND ACREAGE DEDICATION

Form C-102
Supersedes C-128
Effective 1-1-65

All distances must be from the outer boundaries of the Section.

Operator YATES PETROLEUM CORPORATION			Lease Walnut Draw KV Federal			Well No. 1		
Unit Letter L	Section 7	Township 16 South	Range 24 East	County Eddy				
Actual Footage Location of Well: 1980 feet from the South line and 660 feet from the West line								
Ground Level Elev. 3723.8	Producing Formation DEVONIAN		Pool UNDES. 10/1/64			Dedicated Acreage: 320.311.18 Acres		

1. Outline the acreage dedicated to the subject well by colored pencil or hachure marks on the plat below.
2. If more than one lease is dedicated to the well, outline each and identify the ownership thereof (both as to working interest and royalty).
3. If more than one lease of different ownership is dedicated to the well, have the interests been consolidated by communitization, unitization, force-pooling, etc?

RECEIVED

MAR 12 1979

**U.S. GEOLOGICAL SURVEY
ARTESIA, NEW MEXICO**

☒ Yes ☐ No If answer is "yes," type of consolidation To Be COMMUNITIZED

If answer is "no," list the owners and tract descriptions which have actually been consolidated. (Use reverse side of this form if necessary.)

No allowable will be assigned to the well until all interests have been consolidated (by communitization, unitization, forced-pooling, or otherwise) or until a non-standard unit, eliminating such interests, has been approved by the Commission.

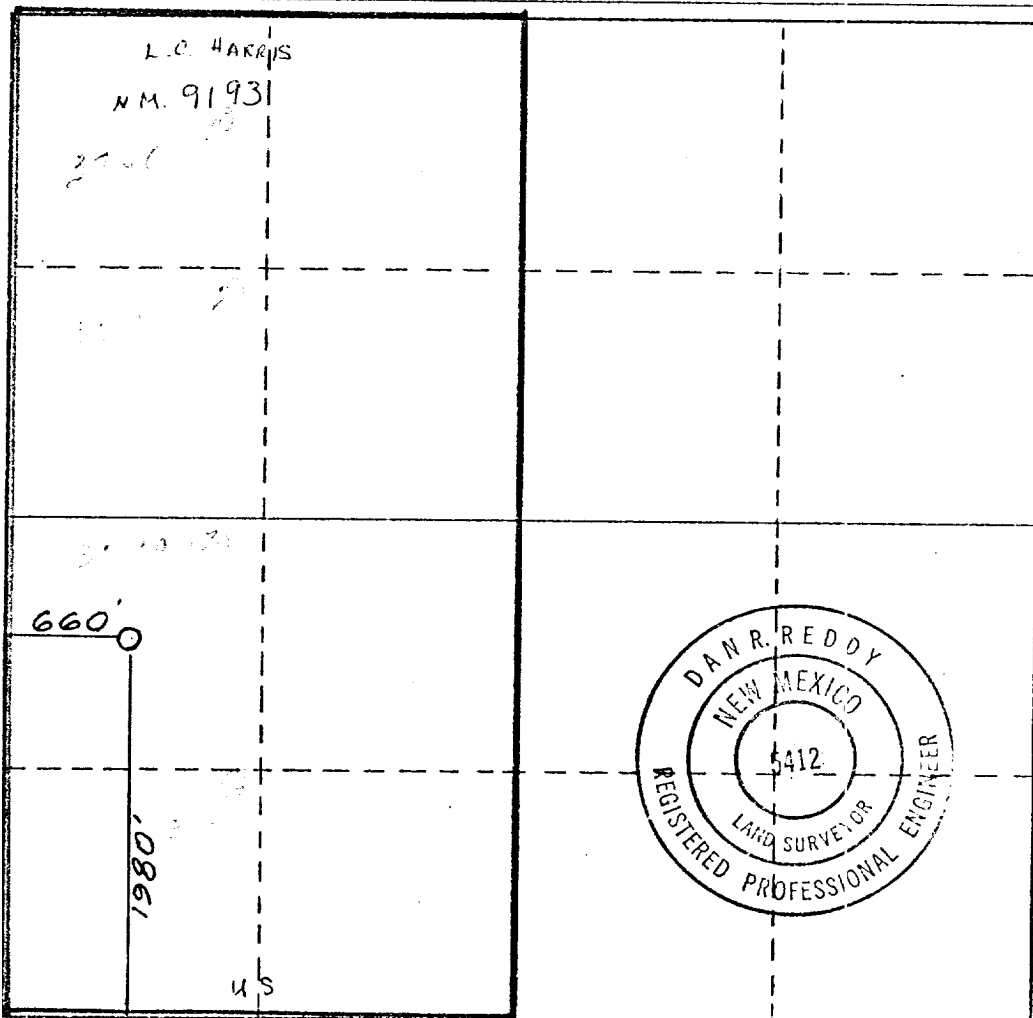

CERTIFICATION

I hereby certify that the information contained herein is true and complete to the best of my knowledge and belief.

Name
EDDIE M. HANFORD

Position
ENGINEER

Company
YATES PETROLEUM CORP.

Date
3-8-79

I hereby certify that the well location shown on this plat was plotted from field notes of actual surveys made by me or under my supervision, and that the same is true and correct to the best of my knowledge and belief.

Date Surveyed
March 7, 1979

Registered Professional Engineer and/or Land Surveyor

Dan R. Reddy

Certificate No.
New Mexico PE&LS #5412