

UNITED STATES
DEPARTMENT OF THE INTERIOR
GEOLOGICAL SURVEY

RECEIVED COMMISSION
Artesia, NM 88210
MAY 21 1982

Form approved
Budget Bureau No. 42 R1425.

30-015-24161

Revised to include
wt of casing

APPLICATION FOR PERMIT TO DRILL, DEEPEN, OR PLUG BACK

1a. TYPE OF WORK
DRILL ☒ DEEPEN ☐ ARTESIAL PLUG BACK ☐

b. TYPE OF WELL
OIL WELL ☐ GAS WELL ☒ OTHER ☐
SINGLE ZONE ☒ MULTIPLE ZONE ☐

2. NAME OF OPERATOR

The Superior Oil Company ✓
3. ADDRESS OF OPERATOR

P.O. Box 3901, Midland, Texas 79702

4. LOCATION OF WELL (Report location clearly and in accordance with any State requirements.*)
At surface 1480' FNL, 660' FWL of Section 5

At proposed prod. zone same

14. DISTANCE IN MILES AND DIRECTION FROM NEAREST TOWN OR POST OFFICE*

18 miles NE from Artesia, New Mexico

15. DISTANCE FROM PROPOSED*
LOCATION TO NEAREST
PROPERTY OR LEASE LINE, FT.
(Also to nearest Grig. unit line, if any)
18. DISTANCE FROM PROPOSED LOCATION*
TO NEAREST WELL, DRILLING, COMPLETED,
OR APPLIED FOR, ON THIS LEASE, FT.

16. NO. OF ACRES IN LEASE

647.36

19. PROPOSED DEPTH

10,200'

17. NO. OF ACRES ASSIGNED
TO THIS WELL

323.24

20. ROTARY OR CABLE TOOLS

Rotary

21. ELEVATIONS (Show whether DF, RT, GR, etc.)

3605.8' GR

23. PROPOSED CASING AND CEMENTING PROGRAM

SIZE OF HOLE	SIZE OF CASING	WEIGHT PER FOOT	SETTING DEPTH	QUANTITY OF CEMENT
Rat Hole	20"	94.0#	40' CIRCULATE	Redi-Mix to Surface
17 1/2"	13 3/8"	54.5#	450' CIRCULATE	405 sx Class C to Surface
11"	8 5/8"	32.0#	2,250' CIRCULATE	645 sx Class C & Lite
7 7/8"	5 1/2"	17.0#	10,000'	*865 sx Class H

*Cmt 2 stages w/TOC on 1-st @ 8700', 2nd @ 6400' w/DV @ 8600'.

Attached: Supplemental Drilling Data
BOP Sketches
Rig Equipment List
Multi-Point Surface use and Operations Plan
Archaeological Clearance Report

RECEIVED
MAY 17 1982

OIL & GAS
U.S. GEOLOGICAL SURVEY
ROSWell, NEW MEXICO

Gas Not Dedicated

IN ABOVE SPACE DESCRIBE PROPOSED PROGRAM: If proposal is to deepen or plug back, give data on present productive zone and proposed new productive zone. If proposal is to drill or deepen directionally, give pertinent data on subsurface locations and measured and true vertical depths. Give blowout preventer program, if any.

24.

SIGNED Approved G. E. Tate TITLE Production Superintendent DATE 5/14/82

(This space for Federal or State office use)

(Orig. Sgd.) GEORGE H. STEWART

PERMIT NO. MAY 15 1982

APPROVAL DATE

APPROVED FOR

JAMES A. GILBERT
DISTRICT SUPERVISOR

TITLE

DATE

5-18-82 VERBAL APPROVAL FROM MR STANLEY, HMOCD.
FORMAL APPROVAL 6-6-82.

Printed ID-1
NLA 5-25-82

NEW MEXICO OIL CONSERVATION COMMISSION
WELL LOCATION AND ACREAGE DEDICATION PLAT

Form O-102
Supersedes O-128
Effective 1-1-65

All distances measured from the outer boundaries of the Section

The Superior Oil Co			Star Federal			Well No. 1		
E	5	16 South	29 East	Eddy				
1480 feet from the north			660 feet from the west			line		
3605.8'		Morrow		Wildcat		Dedicated Acreage: 323.34 Acres		

- Outline the acreage dedicated to the subject well by colored pencil or hatchure marks on the plat below.
- If more than one lease is dedicated to the well, outline each and identify the ownership thereof (both as to working interest and royalty) See Attachment.

If more than one lease of different ownership is dedicated to the well, have the interests of all owners been consolidated by communitization, unitization, force-pooling, etc?

☒ Yes ☐ No If answer is "yes," type of consolidation Communitization Agreement

If answer is "no" list the owners and tract descriptions which have actually been consolidated. (Use reverse side of this form if necessary)

No additional well will be assigned to the well until all interests have been consolidated (by communitization, unitization, force-pooling, or otherwise) or until a non-standard unit, eliminating such interests, has been approved by the Commission.

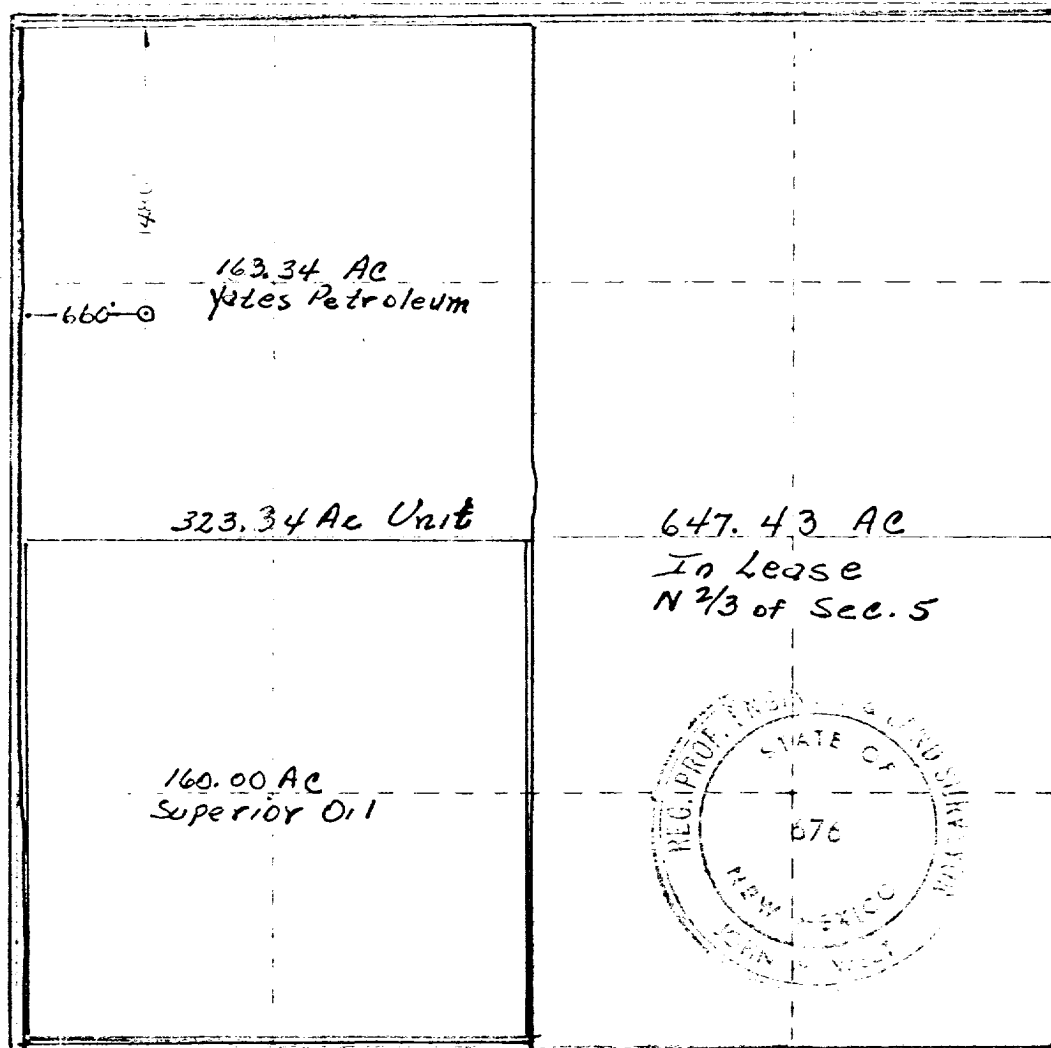

CERTIFICATION

I hereby certify that the information contained herein is true and complete to the best of my knowledge and belief.

Name G. E. Tate
Position Production Superintendent
Company The Superior Oil Company
Date 5/4/82

I hereby certify that the well location shown on this plat was plotted from field notes of actual surveys made by me or under my supervision, and that the same is true and correct to the best of my knowledge and belief.

Date Surveyed 4-26-82
Registered Professional Engineer and/or Land Surveyor John W. West

Certificate No. JOHN W. WEST 676
PATRICK A. ROMERO 6668
Ronald J. Eidson 3239

C-102 Attachments

Working Interest Owners

The Superior Oil Company	.4948
Yates Petroleum Company	.5052
Total	<u>1.0000</u>

Royalty Owners

Sanford Starman (ORRI)	.03125
Will Mandelberg (ORRI)	.03125
Harold R. De Moss	.05000
Bureau of Land Management	.88750
Total	<u>1.00000</u>

SUPPLEMENTAL DRILLING DATA
THE SUPERIOR OIL COMPANY
STAR FEDERAL NO. 1
SECTION 5, T16S, R29E
EDDY COUNTY, NEW MEXICO

1. SURFACE FORMATION

Quaternary

2. ESTIMATED TOPS OF GEOLOGIC MARKERS

Yates	610'
7 Rivers Queen	1410'
Grayburg San Andres	2080'
Glorieta	3760'
Drinkard	4885'
Abo	5660'
Wolfcamp	6960'
Cisco	8160'
Canyon	8460'
Strawn	8835'
Atoka	9235'
Morrow	9410'
Miss (Chester)	9820'

3. ANTICIPATED POSSIBLE HYDROCARBON BEARING ZONES

10,000'

4. PROPOSED CASING AND CEMENTING PROGRAM

See Form 9-331C

5. PRESSURE CONTROL EQUIPMENT

BOP sketches attached

6. MUD PROGRAM

<u>DEPTH</u>	<u>TYPE MUD</u>	<u>WT/GAL.</u>	<u>VIS. API</u>	<u>WLCC/30M</u>
0 - 500'	Spud	8.6 - 9.2	48 - 50	NC
450 - 2,250'	Cut Brine	8.8 - 9.0	29	NC
2,250 - 7,000'	Cut Brine	8.6 - 8.8	29	NC
7,000 - 10,000'	Brine Polymer	8.8 - 9.4	34 - 36	8-10

7. STRUCTURE MAP

See Attachment

8. TESTING, LOGGING AND CORING PROGRAMS

- a. Drill Stem Tests: DST #1 - 610 - 3760'
DST #2 - 9,235 - 9820'
- b. Logging: Mud logger operational from 2,000' to TD
- c. Electric Log Program:

<u>Depth</u>	<u>Type</u>
2,250-10,000'	FDC-CNL-Sonic BHC-Sonic-GR DLL W/RXO-GR

- d. No velocity survey
- e. Coring: None

9. ABNORMAL PRESSURE ZONES

We anticipate no abnormal pressure while drilling

10. UNUSUAL DRILLING CONDITIONS

General American's Brewer No. 28 was whip stocked @ 6310' due to 14° deviation at 7488'. Well was drilled in Section 12, T16S, R29E, Eddy County, New Mexico.

11. ANTICIPATED STARTING DATE

Operations will commence prior to June 1, 1982

SUPERIOR OIL

Wellhead Diagram

WELL Star Federal #1
 CO. Eddy ST. New Mexico
 TD. 10,000'

TREE

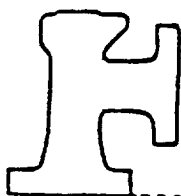

FLANGE 2 9/16" x 5000#

ADAPTER

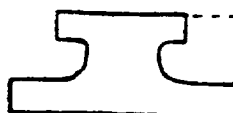

FLANGE 2 9/16" x 5000#

FMC-OCT Type B0-2

FLANGE 7 1/16" x 5000#

22 3/8" TUBING
HEAD

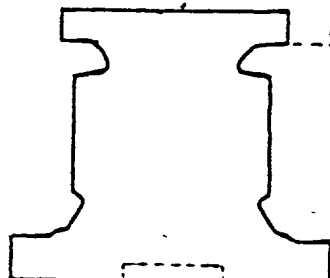

FLANGE 7 1/16" x 5000#

FMC-OCT Type TC

FLANGE 11" x 3000#

CASING
3/4" SPOOL

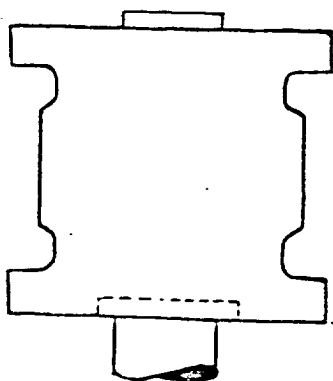

FLANGE 11" x 3000#

FMC-OCT Type C-22-BG

FLANGE 13 5/8" x 3000#

CASING
1/16" HEAD

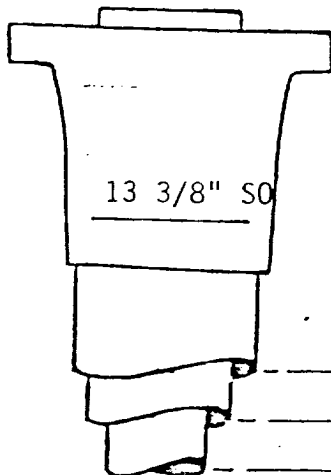

FLANGE 13 5/8" x 3000#

FMC-OCT Type C-22-BP

13 3/8" SO

13 3/8" 54.5# K-55 ST&C

8 5/8" 32.0# K-55 ST&C

5 1/2" 17.0# K-55 ST&C

SUPERIOR OIL

May 4, 1982

State of New Mexico
Energy and Minerals Department
P. O. Box 2088
Santa Fe, New Mexico 87501

Attention: Dick Stametz

Subject: Unorthodox Location (SWR #104)
Star Federal Well No. 1
1480' FNL and 660' FWL
Section 5, T16S, R29E
Eddy County, New Mexico

Gentlemen:

Superior Oil Company is applying for an exception to Statewide Rule 104, (an unorthodox location), to drill the Star Federal Well No. 1 at 1480' FNL and 660' FWL of Section 5, T16S, R29E, Eddy County, New Mexico. This location is 500' closer to the north lease line than Statewide Rules require.

The regular location of 1980' FNL and 660' FWL was examined on 5/3/81 by Dr. J. Loring Haskell and remains of indian artifacts were found on the picked drillsite. By moving the location 500' to the north those artifacts will remain undisturbed as that is a "clean" location.

Attached are waivers from Gulf Oil Company, the only offset operator, to the Star Federal lease. This well is a joint project with Yates Petroleum and Superior will be the operator. Attached, also, are copies of plats showing offset operators, lease ownership and the archaeological Clearance Report.

Superior Oil Company respectfully requests the subject location exception be granted administratively.

If additional information is needed please call collect to Lorraine Maroney, at (915) 684-0884, extension 133.

Sincerely,

Diat:

O+1 NM E+MD

cc

USGS

Files, Midland

Prod Supt "

Geot "

Prod Supt, Subline

Reg Mgr. Woodlark

Prod Geot "

G. E. Tate
Production Superintendent

LM:gam

The Superior Oil Company

Midland Production District
P.O. Box 3901, Midland, TX 79702, (915) 684-0884