

(November 1983)
(formerly 9-331C)

UNITED STATES
DEPARTMENT OF THE INTERIOR
BUREAU OF LAND MANAGEMENT

(Other in sections on
side)

Budget Bureau No. 1004-0136
Expires August 31, 1985

APPLICATION FOR PERMIT TO DRILL, DEEPEN, OR PLUG BACK

1a. TYPE OF WORK

DRILL ☒

DEEPEN ☐

PLUG BACK ☐

b. TYPE OF WELL

OIL
WELL ☒

GAS
WELL ☐

OTHER

SINGLE
ZONE ☐

MULTIPLE
ZONE ☐

2. NAME OF OPERATOR

Suntex Resources, Inc. ✓

3. ADDRESS OF OPERATOR

8111 LBJ Freeway, Suite 570, Dallas, TX 75251

4. LOCATION OF WELL (Report location clearly and in accordance with any State requirements)

At surface

988' FWL & 2310' FNL of Sec. 17-T16S-R29E, N1PM

At proposed prod. zone

Same

14. DISTANCE IN MILES AND DIRECTION FROM NEAREST TOWN OR POST OFFICE*

Approximately 8.8 mi. Northwest of Loco Hills, NM

10. DISTANCE FROM PROPOSED*

LOCATION TO NEAREST

PROPERTY OR LEASE LINE, FT.

(Also to nearest drg. unit line, if any)

990'

16. NO. OF ACRES IN LEASE

320

17. NO. OF ACRES ASSIGNED
TO THIS WELL

40

13. DISTANCE FROM PROPOSED LOCATION*
TO NEAREST WELL, DRILLING, COMPLETED,
OR APPLIED FOR, ON THIS LEASE, FT.

1300'

19. PROPOSED DEPTH

1850'

20. ROTARY OR CABLE TOOLS

Rotary

21. ELEVATIONS (Show whether DF, RT, GR, etc.)

3640.2' G.L.

22. APPROX. DATE WORK WILL START*

December 26, 1985

23.

PROPOSED CASING AND CEMENTING PROGRAM

SIZE OF HOLE	SIZE OF CASING	WEIGHT PER FOOT	SETTING DEPTH	QUANTITY OF CEMENT
12 1/4"	8 5/8"	24#	300'	Class "C" w/ 2% gel to surface
7 7/8"	4 1/2"	10.50#	1850'	235 Sacks lite + 100 sks Class "C"

Well will be drilled to a total depth of approximately 1900' and all potential oil and gas zones will be evaluated. If commercial production is indicated, well will be selectively perforated and stimulated.

Attached are: 1. Well location and dedication plat.
2. Supplemental drilling data.
3. Surface Use Plan

Gas is not dedicated to a pipeline.

IN ABOVE SPACE DESCRIBE PROPOSED PROGRAM: If proposal is to deepen or plug back, give data on present productive zone and proposed new productive zone. If proposal is to drill or deepen directionally, give pertinent data on subsurface locations and measured and true vertical depths. Give blowout preventer program, if any.

24.

SIGNED

Truman Casey

TITLE

Agent for Truman Casey,
Field Representative

DATE

12/13/85

(This space for Federal or State office use)

PERMIT NO.

APPROVAL DATE

APPROVED BY

Adrian

TITLE

DATE

12-23-85

CONDITIONS OF APPROVAL, IF ANY:

*See Instructions On Reverse Side

Title 18 U.S.C. Section 1001 makes it a crime for any person knowingly and willfully to make to any department or agency of the United States any false, fictitious or fraudulent statements or representations as to any matter within its jurisdiction.

APPROVAL SUBJECT TO
GENERAL REQUIREMENTS AND
SPECIAL STIPULATIONS
ATTACHED

NEW MEXICO OIL CONSERVATION COMMISSION
WELL LOCATION AND ACREAGE DEDICATION PLAT

Form C-102
Supersedes C-128
Effective 1-1-65

All distances must be from the outer boundaries of the Section

Operator SUN-TEX RESOURCES INC.		Lease SHILOH RODNEY FEDERAL		Well No. 3	
Tract Letter E	Section 17	Township 16 SOUTH	Range 29 EAST	County EDDY	
Actual Surface Location of Well: 2310 feet from the NORTH line and 988 feet from the WEST line					
Ground Level Elev. 3540.2'	Producing Formation Queen		Pool Mid. High Lawrence River	Dedicated Acreage: 40.0 Acres	

1. Outline the acreage dedicated to the subject well by colored pencil or hatchure marks on the plat below.
2. If more than one lease is dedicated to the well, outline each and identify the ownership thereof (both as to working interest and royalty).
3. If more than one lease of different ownership is dedicated to the well, have the interests of all owners been consolidated by communitization, unitization, force-pooling, etc?

☐ Yes ☐ No If answer is "yes," type of consolidation _____

If answer is "no," list the owners and tract descriptions which have actually been consolidated. (Use reverse side of this form if necessary.) _____

No allowable will be assigned to the well until all interests have been consolidated (by communitization, unitization, forced-pooling, or otherwise) or until a non-standard unit, eliminating such interests, has been approved by the Commission.

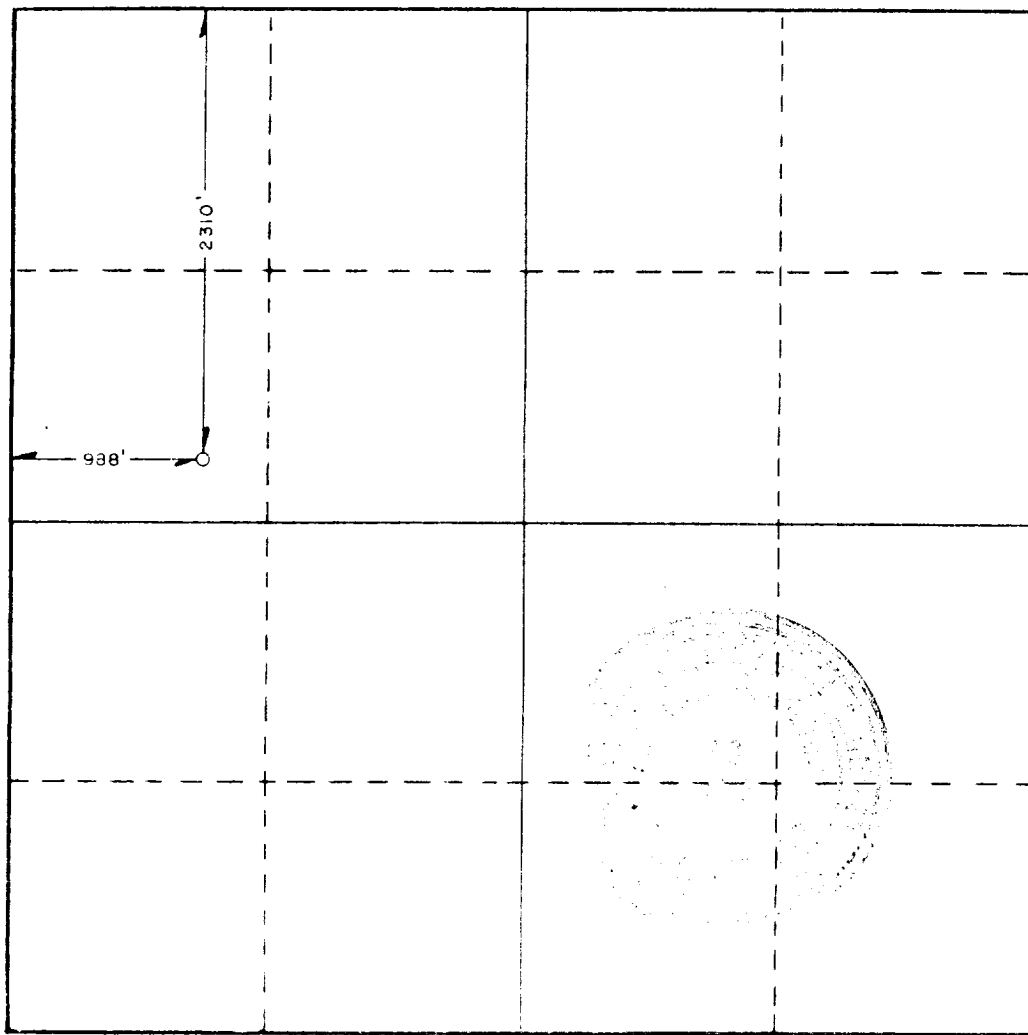

CERTIFICATION

I hereby certify that the information contained herein is true and complete to the best of my knowledge and belief.

Beth McDonald

Name
Beth McDonald
Position Agent for Truman Casey, Field Representative
Company
Suntex Resources, Inc.

Date
12/13/85

I hereby certify that the well location shown on this plat was plotted from field notes of actual surveys made by me or under my supervision, and that the same is true and correct to the best of my knowledge and belief.

Date Surveyed
DECEMBER 10, 1985

Registered Professional Engineer and/or Land Surveyor

John W. West

Certificate No. JOHN W. WEST, 676
RONALD J. EIDSON, 3239

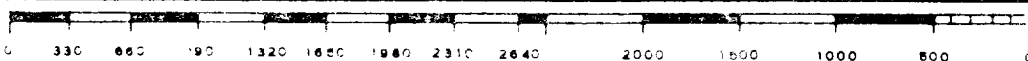

6286

REGAN OFFSHORE INTERNATIONAL, INC.

Torrance,

REGAN BLOWOUT PREVENTERS

The Regan Torus Blowout Preventer is used primarily on production and workover rigs for well control up to 3000 PSI working pressure.

DESIGN FEATURES

- The Torus Preventer is designed for minimum height to facilitate its use with production and workover rigs.
- The rubber packer will conform to any object in the well bore. Sealing ability is not affected by minor damage to the inner bore.
- The packer will seal on open hole at full working pressure.
- The dual packer design increases the reliability of the preventer since the outer rubber is never exposed to the well bore. Under ordinary service, the outer packer is rarely replaced.

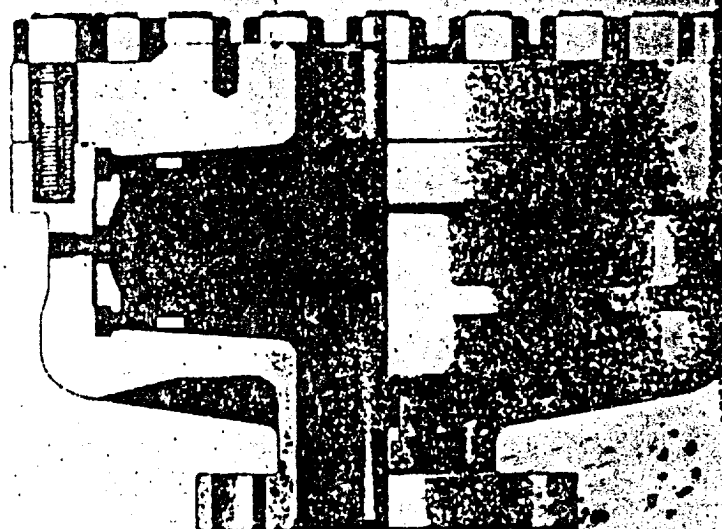
TORUS BLOWOUT PREVENTER
PATENTED

SPECIFICATIONS

Nominal Size	Test Pressure (psi)	DIMENSIONS (In.)			Weight (lb.)	End Flanges (1)	R/RX Ring Grooves	Side Outlet
		Outside Diameter	Thru Bore	Overall Height				
6	1500 2000	27 1/4 28 1/4	21 1/8 21 3/8	19 1/4 21 1/4	1400 1900	Nom. 6 Nom. 6	45 45	None 2" L.P.
8	2000	34 1/4	27	25	2625	Nom. 8	45	None

For more information
contact Regan
Offshore International
Inc. 4010 E. 10th Ave.
Torrance, CA 90503
Tel. (310) 551-1111
Telex 154111
Fax (310) 551-1112

SUPPLEMENTAL DRILLING DATA

Suntex Resources, Inc.

WELL: ~~Rodney~~ Federal #3

988' FWL & 2310' FNL, Sec. 17-T16S-R29E

Eddy County, New Mexico

1. SURFACE FORMATION: Quaternary

2. ESTIMATED TOPS OF GEOLOGICAL MARKERS:

Queen	1550'	Penrose	1770'
-------	-------	---------	-------

3. ANTICIPATED POROSITY ZONES:

Water	None
Oil	1550' - 1800'

4. CASING DESIGN:

Hole Size	Casing	Interval	Weight	Class	Joint	Condition
12¼"	8-5/8"	0 - 300'	24#	J-55	ST&C	New
7-7/8"	4½"	0 - 1850'	10.5#	J-55	ST&C	New

5. SURFACE CONTROL EQUIPMENT: Regan Blowout Preventer (specifications attached).

6. CIRCULATING MEDIUM: 0 - 300': Fresh Water
300' - 1900': Brine Water

7. AUXILIARY EQUIPMENT: Drill string safety valve.

8. TESTING, LOGGING AND CORING PROGRAMS: Dual Laterolog w/ Gamma Ray: 1 - 1850'.
Compensated Density Neutron Log: 850' - 1850'.

9. ABNORMAL PRESSURES, TEMPERATURES OR GASES: None anticipated.

10. ANTICIPATED DATES: It is planned that operations will commence about December 26, 1985, or immediately upon approval of this application. Duration of drilling and completion operations should be 20 to 40 days.

ARTESIA QUADRANGLE - 106

EDDY & CHAVES COUNTIES
R.29 E.

R.27 E.

R.28 E.

Correct - 95

T.15 S.

T.16 S.

T.17 S.

T.18 S.

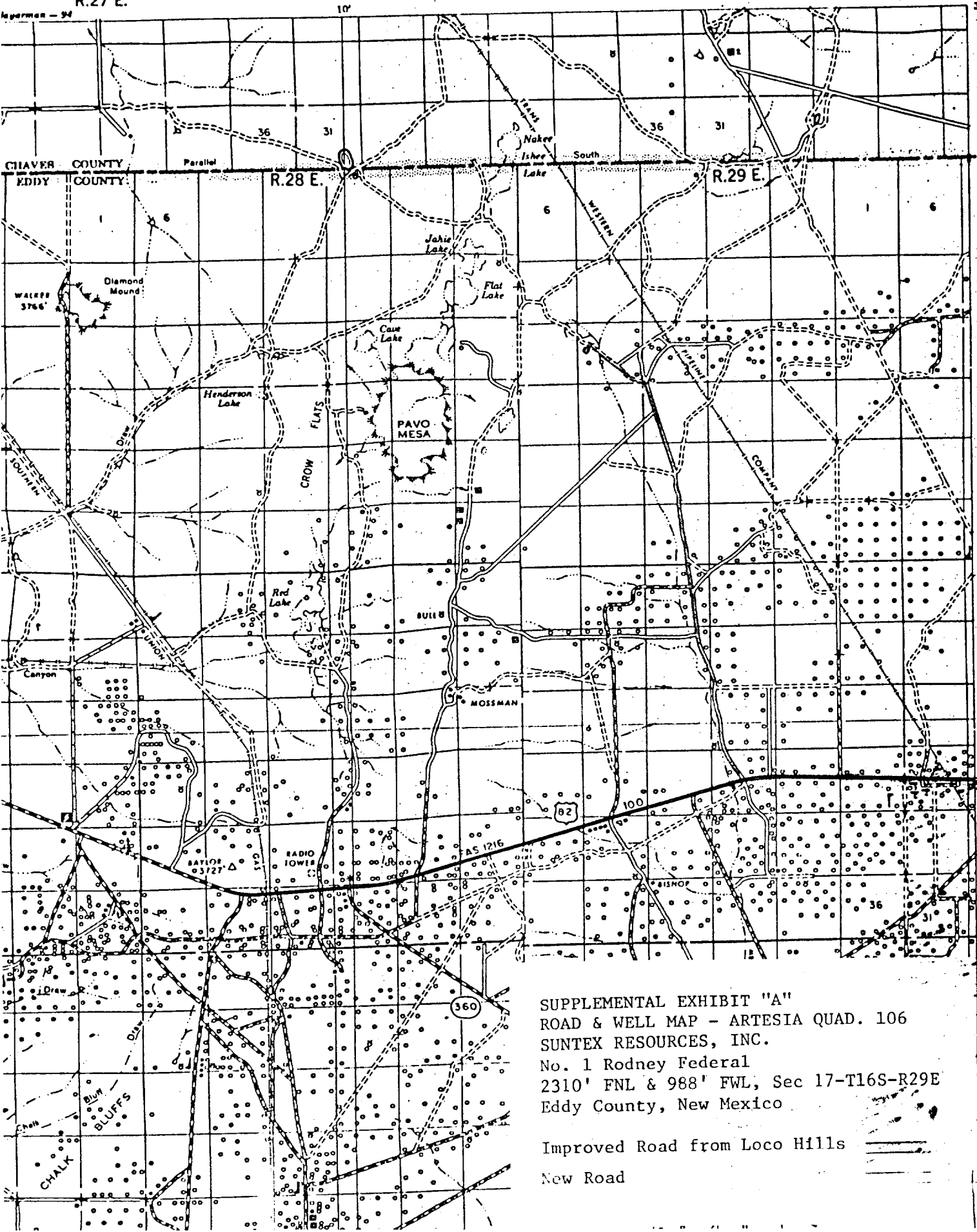

SUPPLEMENTAL EXHIBIT "A"
ROAD & WELL MAP - ARTESIA QUAD. 106
SUNTEX RESOURCES, INC.
No. 1 Rodney Federal
2310' FNL & 988' FWL, Sec 17-T16S-R29E
Eddy County, New Mexico

Improved Road from Loco Hills
New Road

PLAT FOR PIT LOCATION FOR ARTESIA FISHING TOOL

Rigs #1 & #2; L & M DRILLING #2 and LARUE
DRILLING #2

EXHIBIT "B"

