

Submit 3 Copies
to Appropriate
District Office

State of New Mexico
Energy, Minerals and Natural Resources Department

Form C-103
Revised 1-1-89

OIL CONSERVATION DIVISION

DISTRICT I
P.O. Box 1980, Hobbs NM 88241-1980

2040 Pacheco St.
Santa Fe, NM 87505

DISTRICT II
P.O. Drawer DD, Artesia, NM 88210

DISTRICT III
1000 Rio Brazos Rd., Aztec, NM 87410

WELL API NO. 30-015-30138
5. Indicate Type of Lease STATE <input checked="" type="checkbox"/> FEE <input type="checkbox"/>
6. State Oil & Gas Lease No.
7. Lease Name or Unit Agreement Name WASHINGTON "33" STATE
8. Well No. 6
9. Pool name or Wildcat WILDCAT (YESO) & ARTESIA (Q-G-SA)

SUNDRY NOTICES AND REPORTS ON WELLS (DO NOT USE THIS FORM FOR PROPOSALS TO DRILL OR TO DEEPEN OR PLUG BACK TO A DIFFERENT RESERVOIR. USE "APPLICATION FOR PERMIT" (FORM C-101) FOR SUCH PROPOSALS.)	
1. Type of Well: OIL WELL <input checked="" type="checkbox"/> GAS WELL <input type="checkbox"/> OTHER <input type="checkbox"/>	
2. Name of Operator ARCO Permian	
3. Address of Operator P.O. Box 1610 Midland, TX 79702	
4. Well Location Unit Letter C : 790 Feet From The NORTH Line and 1650 Feet From The WEST Line Section 33 Township 17S Range 28E NMPM EDDY County	
10. Elevation (Show whether DF, RKB, RT, GR, etc.) 3667'	

11.

Check Appropriate Box to Indicate Nature of Notice, Report, or Other Data

NOTICE OF INTENTION TO:

PERFORM REMEDIAL WORK ☐ PLUG AND ABANDON ☐
TEMPORARILY ABANDON ☐ CHANGE PLANS ☒
PULL OR ALTER CASING ☐
OTHER: ☐

SUBSEQUENT REPORT OF:

REMEDIAL WORK ☐ ALTERING CASING ☐
COMMENCE DRILLING OPNS. ☐ PLUG AND ABANDONMENT ☐
CASING TEST AND CEMENT JOB ☐
OTHER: ☐

12. Describe Proposed or Completed Operations (Clearly state all pertinent details, and give pertinent dates, including estimated date of starting any proposed work) SEE RULE 1103.

THIS WELLBORE WAS CHANGED FROM ORIGINALLY PERMITTED LOCATION OF 990'FNL AND 1650'FWL TO 790'FNL AND 1650'FWL. ATTACHED IS A PLAT SHOWING THE NEW LOCATION.

*Post FD-1
5-15-98
Amend FLS*

RECEIVED
DISTRICT II ARTESIA

I hereby certify that the information above is true and complete to the best of my knowledge and belief.

SIGNATURE Laurie Cherry TITLE REGULATORY COMPLIANCE DATE 4/29/98
TYPE OR PRINT NAME LAURIE CHERRY TELEPHONE NO. 915-688-5532

(This space for State Use)

**ORIGINAL SIGNED BY TIM W. GUM
DISTRICT II SUPERVISOR**

APPROVED BY _____ TITLE _____ DATE 5-11-98

CONDITIONS OF APPROVAL, IF ANY:

DISTRICT I
P.O. Box 1980, Hobbs, NM 88241-1980

DISTRICT II
P.O. Drawer DD, Artesia, NM 88211-0710

DISTRICT III
1000 Rio Brazos Rd., Aztec, NM 87410

DISTRICT IV
P.O. BOX 2088, SANTA FE, N.M. 87504-2088

State of New Mexico
Energy, Minerals and Natural Resources Department

Form C-102
Revised February 10, 1994
Submit to Appropriate District Office
State Lease - 4 Copies
Fee Lease - 3 Copies

OIL CONSERVATION DIVISION
P.O. Box 2088
Santa Fe, New Mexico 87504-2088

☐ AMENDED REPORT

WELL LOCATION AND ACREAGE DEDICATION PLAT

API Number 30-015-30138	Pool Code	Pool Name WILDCAT (YESO) AND ARTESIA (Q-G-SA)
Property Code	Property Name WASHINGTON 33 STATE	Well Number 6
OGRID No. 000990	Operator Name ARCO PERMIAN	Elevation 3667'

Surface Location									
UL or lot No.	Section	Township	Range	Lot Idn	Feet from the	North/South line	Feet from the	East/West line	County
C	33	17 S	28 E		790	NORTH	1650	WEST	EDDY
UL Location If Different From Surface									

Bottom Hole Location If Different From Surface									
UL or lot No.	Section	Township	Range	Lot Idn	Feet from the	North/South line	Feet from the	East/West line	County
Dedicated Acres 40		Joint or Infill	Consolidation Code		Order No.				

NO ALLOWABLE WILL BE ASSIGNED TO THIS COMPLETION UNTIL ALL INTERESTS HAVE BEEN CONSOLIDATED
OR A NON-STANDARD UNIT HAS BEEN APPROVED BY THE DIVISION

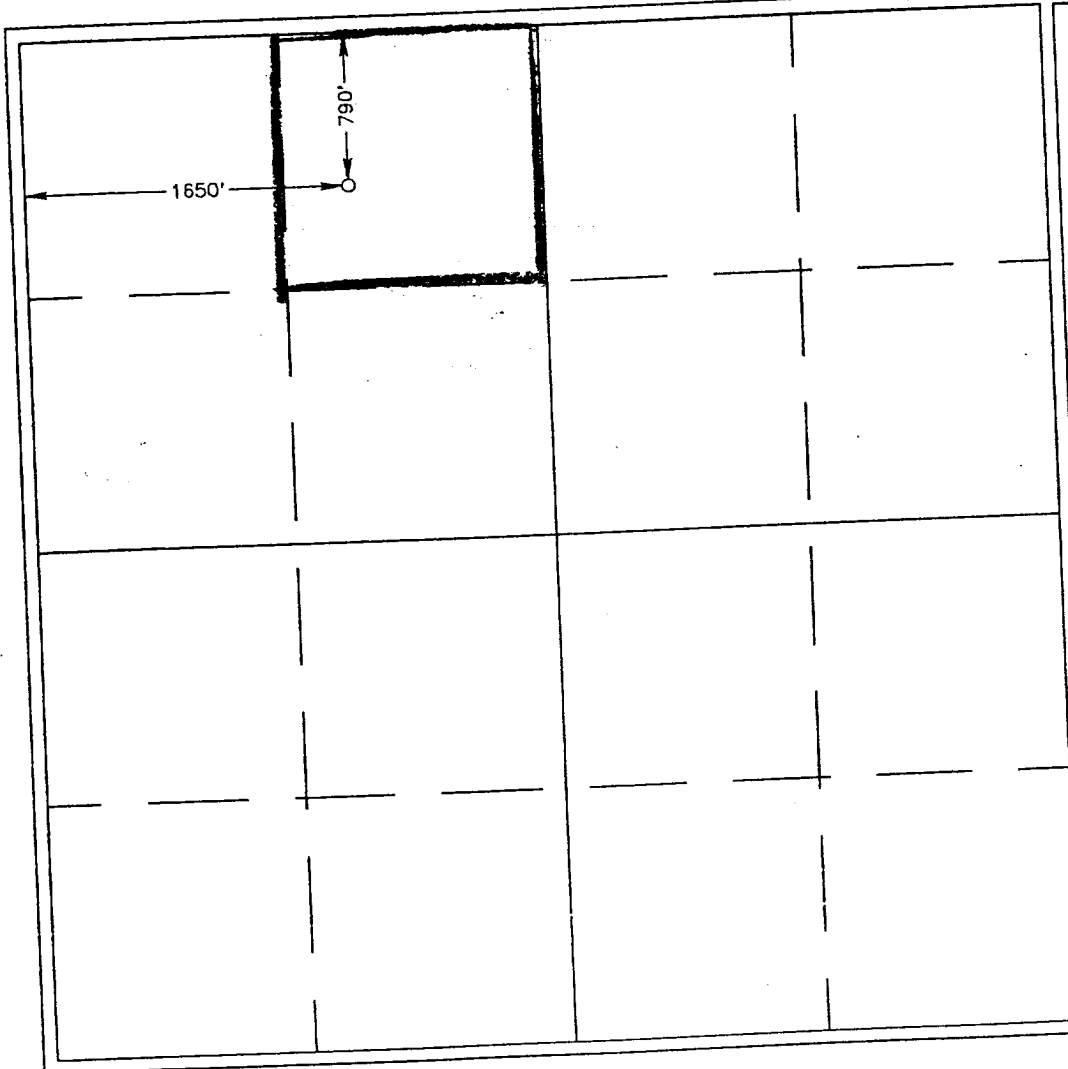

OPERATOR CERTIFICATION

I hereby certify that the information contained herein is true and complete to the best of my knowledge and belief.

Signature
LAURIE CHERRY
Printed Name
REC. / COMP. ASST.
Title
4/29/98
Date

SURVEYOR CERTIFICATION

I hereby certify that the well location shown on this plat was plotted from field notes of actual surveys made by me or under my supervision and that the same is true and correct to the best of my belief.

APRIL 23, 1998

Date Surveyed
Signature & Seal of Professional Surveyor
ROBERT J. EDSON
NEW MEXICO
3239
98-11-0676
CDG
3-24-98
Certified by
ROBERT J. EDSON
PROFESSIONAL SURVEYOR
12641