

NO. OF COPIES RECEIVED	
DISTRIBUTION	
SANTA FE	1
FILE	1
U.S.G.S.	2
LAND OFFICE	1
OPERATOR	1

RECEIVED

SEP 20 1982

O. C. D.

ARTESIA OFFICE

5A. Indicate Type of Lease	STATE <input checked="" type="checkbox"/> FCC <input type="checkbox"/>
5. State Oil & Gas Lease No.	21-1000
7. Unit Agreement Name	Little Cuevo Unit
8. Form or Lease Name	Little Cuevo Unit
9. Well No.	1
10. Field and Pool, or Wildcat	Wildcat Abo
12. County	Chaves

APPLICATION FOR PERMIT TO DRILL, DEEPEN, OR PLUG BACK

Type of Work DRILL ☒ DEEPEN ☐ PLUG BACK ☐

Type of Well OIL WELL ☐ GAS WELL ☒ OTHER ☐ SINGLE ZONE ☐ MULTIPLE ZONE ☐

Name of Operator Yates Petroleum Corporation

Address of Operator 207 S. 4th, Artesia, New Mexico 88210

Location of Well UNIT LETTER I LOCATED 1980 FEET FROM THE South LINE

660 FEET FROM THE East LINE OF SEC. 29 TWP. 17S RGE. 18E



19. Proposed Depth appr. 6100' 19A. Formation Abo 20. Rotary or C.T. Rotary

Elevations (Show whether LF, RT, etc.) 5389' GL 21A. Kind & Status Plug, Bond Blanket 21B. Drilling Contractor LaRue Drilling 22. Approx. Date Work will start ASAP

PROPOSED CASING AND CEMENT PROGRAM

SIZE OF HOLE	SIZE OF CASING	WEIGHT PER FOOT	SETTING DEPTH	SACKS OF CEMENT	EST. TOP
12 1/4"	9 5/8"	32#	1200'	500 sx	circulated
7 7/8"	5 1/2 or 4 1/2"	15.5# 9.5#	TD	700 sx	

We intend to drill and test the Abo and other formations. Will set approximately 1200' of 9 5/8" surface casing and circulate the cement to shut off caving. If needed, 7" intermediate could be run with enough cement to tie back into the surface casing. If commercial, production casing will be run and cemented with adequate cover.

MUD PROGRAM: FW gel and LCM to 1200', KCL added to 2500', SW gel/KCL to TD.

BOP PROGRAM: BOP will be installed at the offset and tested daily.

GAS NOT DEDICATED.

APPROVAL VALID FOR 180 DAYS
PERMIT EXPIRES 3-28-83
UNLESS DRILLING UNDERWAY

BOVE SPACE DESCRIBE PROPOSED PROGRAM: IF PROPOSAL IS TO DEEPEN OR PLUG BACK, GIVE DATA ON PRESENT PRODUCTIVE ZONE AND PROPOSED NEW PRODU

by certify that the information above is true and complete to the best of my knowledge and belief.

by Estevan Robles Title Regulatory Manager Date 9/20/82

(This space for State Use)

ROVED BY Mike Williams TITLE OIL AND GAS INSPECTOR DATE SEP 24 1982

DITIONS OF APPROVAL, IF ANY:

Pending Case 7664
9/15/82

Notify N.M.O.C.C. in sufficient
time to witness cementing
the casing

N MEXICO OIL CONSERVATION COMMISSION
WELL LOCATION AND ACREAGE DEDICATION PLAT

Form C-102
Supersedes C-128
Effective 1-1-65

All distances must be from the outer boundaries of the Section.

Operator YATES PETROLEUM CORPORATION			Lease Little Cuevo Unit No. 1		Well No. 1
Unit Letter I	Section 20	Township 17 South	Range 18 East	County Chaves	
Actual Footage Location of Well: 1980 feet from the South line and 660 feet from the East line					
Ground Level Elev. 5389.	Producing Formation Abo		Pool Wildcat also		Dedicated Acreage: 160 Acres

1. Outline the acreage dedicated to the subject well by colored pencil or hachure marks on the plat below.
2. If more than one lease is dedicated to the well, outline each and identify the ownership thereof (both as to working interest and royalty).
3. If more than one lease of different ownership is dedicated to the well, have the interests of all owners been consolidated by communitization, unitization, force-pooling, etc?

☒ Yes ☐ No If answer is "yes," type of consolidation UNITIZATION

If answer is "no," list the owners and tract descriptions which have actually been consolidated. (Use reverse side of this form if necessary.)

No allowable will be assigned to the well until all interests have been consolidated (by communitization, unitization, forced-pooling, or otherwise) or until a non-standard unit, eliminating such interests, has been approved by the Commission.

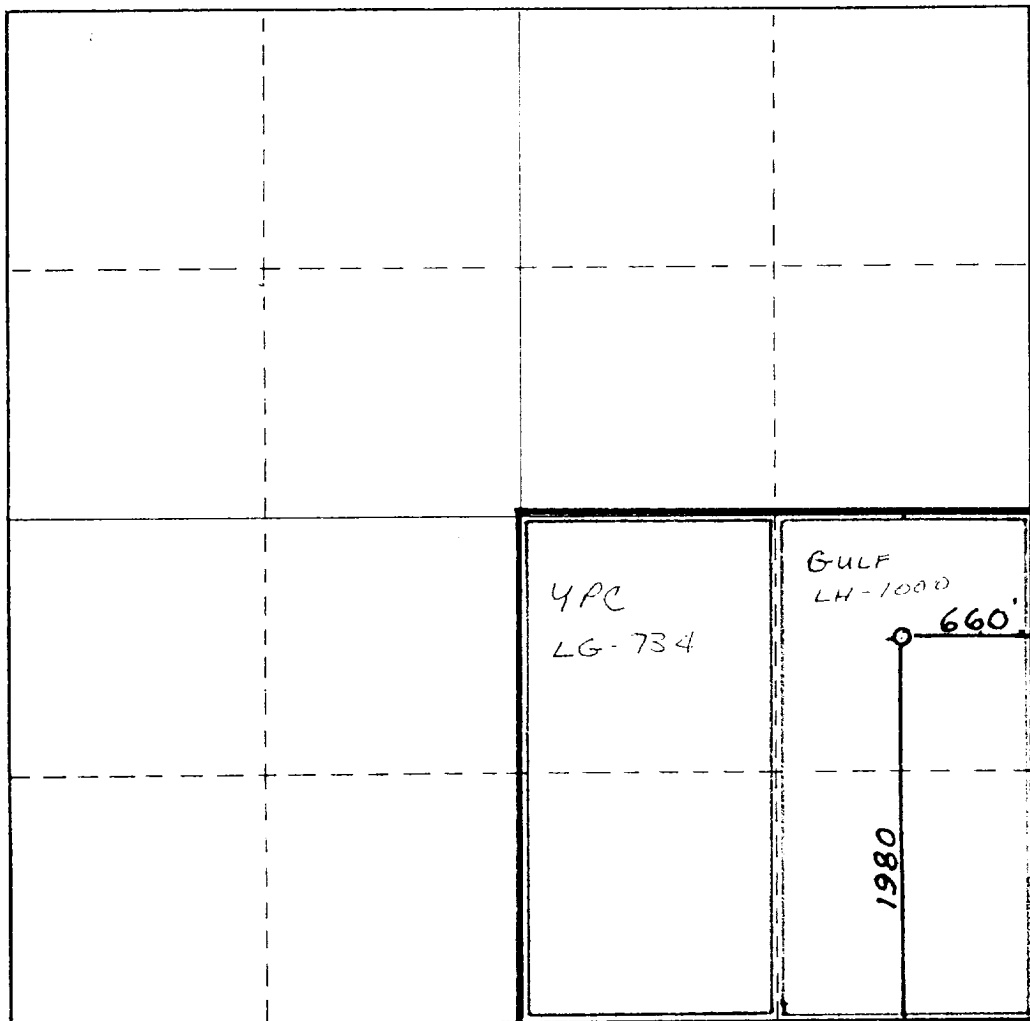

CERTIFICATION

I hereby certify that the information contained herein is true and complete to the best of my knowledge and belief.

Name
Gliserio Rodriguez
Position
Regulatory Manager
Company
Yates Petroleum Corp.

Date
9/20/82

I hereby certify that the well location shown on this plat was plotted from field notes of actual surveys made by me or under my supervision, and that the same is true and correct to the best of my knowledge and belief.

Date Surveyed
September 19, 1982

Registered Professional Engineer and/or Land Surveyor

Certificate No.
NM PE&LS #5412

0 330 660 990 1320 1650 1980 2310 2640 2000 1500 1000 500 0

Exhibit 5

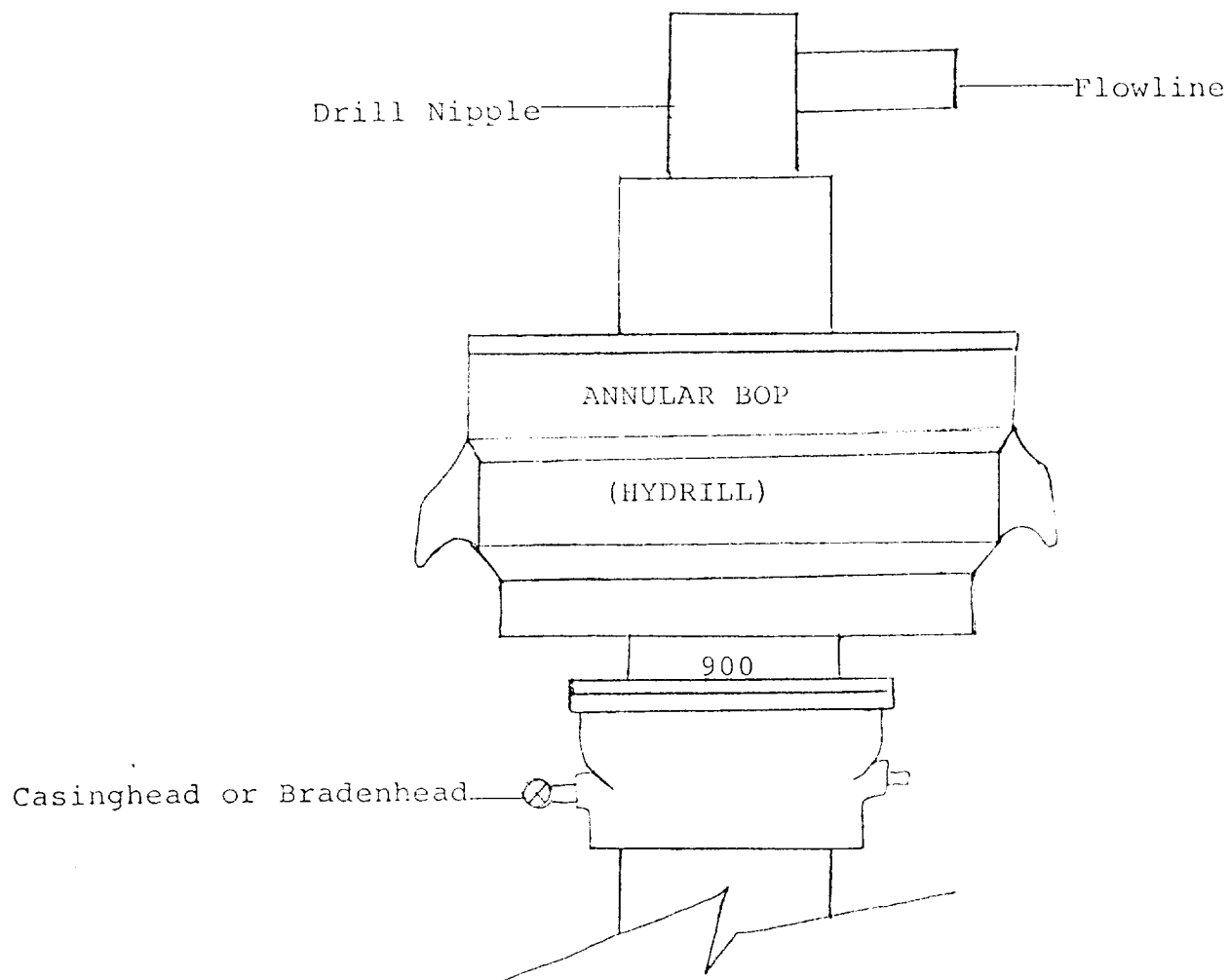

THE FOLLOWING CONSTITUTE MINIMUM BLOWOUT PREVENTER REQUIREMENTS

1. All preventers to be hydraulically operated with secondary manual controls installed prior to drilling out from under casing.
2. All connections from operating manifolds to preventers to be all steel. Hole or tube a minimum of one inch in diameter.
3. The available closing pressure shall be at least 15% in excess of that required with sufficient volume to operate the BOP's.
4. All connections to and from preventer to have a pressure rating equivalent to that of the BOP's.
5. Hole must be kept filled on trips below intermediate casing.