

NOTICE OF INTENTION TO DRILL

Notice must be given to the District Office of the Oil Conservation Commission and approval obtained before drilling or recompletion begins. If changes in the proposed plan are considered advisable, a copy of this notice showing such changes will be returned to the sender. Submit this notice in QUINTUPLICATE. One copy will be returned following approval. See additional instructions in Rules and Regulations of the Commission. If State Land submit 6 Copies Attach Form C-128 in triplicate to first 3 copies of form C-101

Midland, Texas

September 24, 1957

(Place)

(Date)

OIL CONSERVATION COMMISSION
SANTA FE, NEW MEXICO

Gentlemen:

You are hereby notified that it is our intention to commence the Drilling of a well to be known as
Neil E. Salsich

(Company or Operator)

State AB

(Lease)

Well No. 1

in R

(Unit)

The well is

located 1980 feet from the South line and 1980 feet from the West

line of Section 2, T. 17S, R. 29E, NMPM.

(GIVE LOCATION FROM SECTION LINE) Anderson Pool, Eddy County

If State Land the Oil and Gas Lease is No. B-5084

If patented land the owner is

Address

We propose to drill well with drilling equipment as follows: Rotary to TD

The status of plugging bond is \$10,000.00 Blanket Bond, Maryland Casualty Co.

Drilling Contractor Loco Drilling Company, Midland, Texas

We intend to complete this well in the Grayburg

formation at an approximate depth of 2700 feet.

CASING PROGRAM

We propose to use the following strings of Casing and to cement them as indicated:

Size of Hole	Size of Casing	Weight per Foot	New or Second Hand	Depth	Sacks Cement
11-7/8	8-5/8	24#	Used	300	Circulate
7-7/8	4-1/2	9.5	New	2700	125

If changes in the above plans become advisable we will notify you immediately.

ADDITIONAL INFORMATION (If recompletion give full details of proposed plan of work.)

Approved SEP 26 1957, 19.....
Except as follows:

Sincerely yours,

Neil E. Salsich

(Company or Operator)

By *Neil E. Salsich*

Position Operator

Send Communications regarding well to

Name Neil E. Salsich

Address 304 Central Building, Midland, Texas

OIL CONSERVATION COMMISSION

By *M. L. Armstrong*

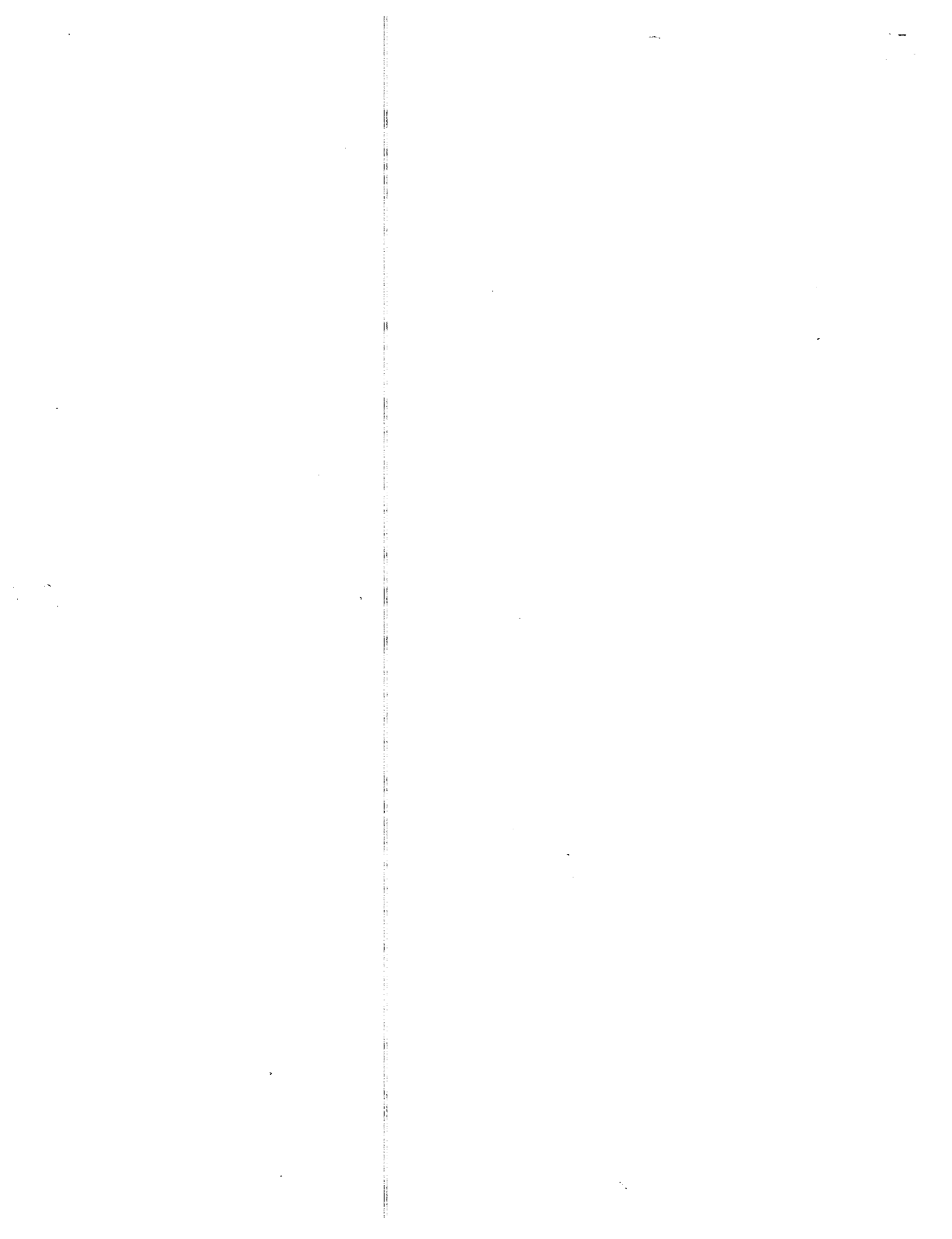

Well Location and Acreage Dedication Plat

Oil Cons. Comm.

Date ARTESIA OFFICE 7-8-1957

Section A.

Operator NEAL E. SALSICH Lease STATE AB
Well No. 1 Unit Letter K Section 2 Township 17-S Range 29-E NMPM
Located 1980 Feet From SOUTH Line, 1980 Feet From WEST Line
County EDDY G. L. Elevation 3640.87 Dedicated Acreage 40 Acres
Name of Producing Formation Pool

- 1. Is the Operator the only owner* in the dedicated acreage outlined on the plat below? Yes [checked] No
2. If the answer to question one is "no," have the interests of all the owners been consolidated by communitization agreement or otherwise? Yes No. If answer is "yes," Type of Consolidation
3. If the answer to question two is "no," list all the owners and their respective interests below:

Owner

Land Description

Table with 2 columns: Owner, Land Description. Contains empty rows for listing owners and land descriptions.

Section B

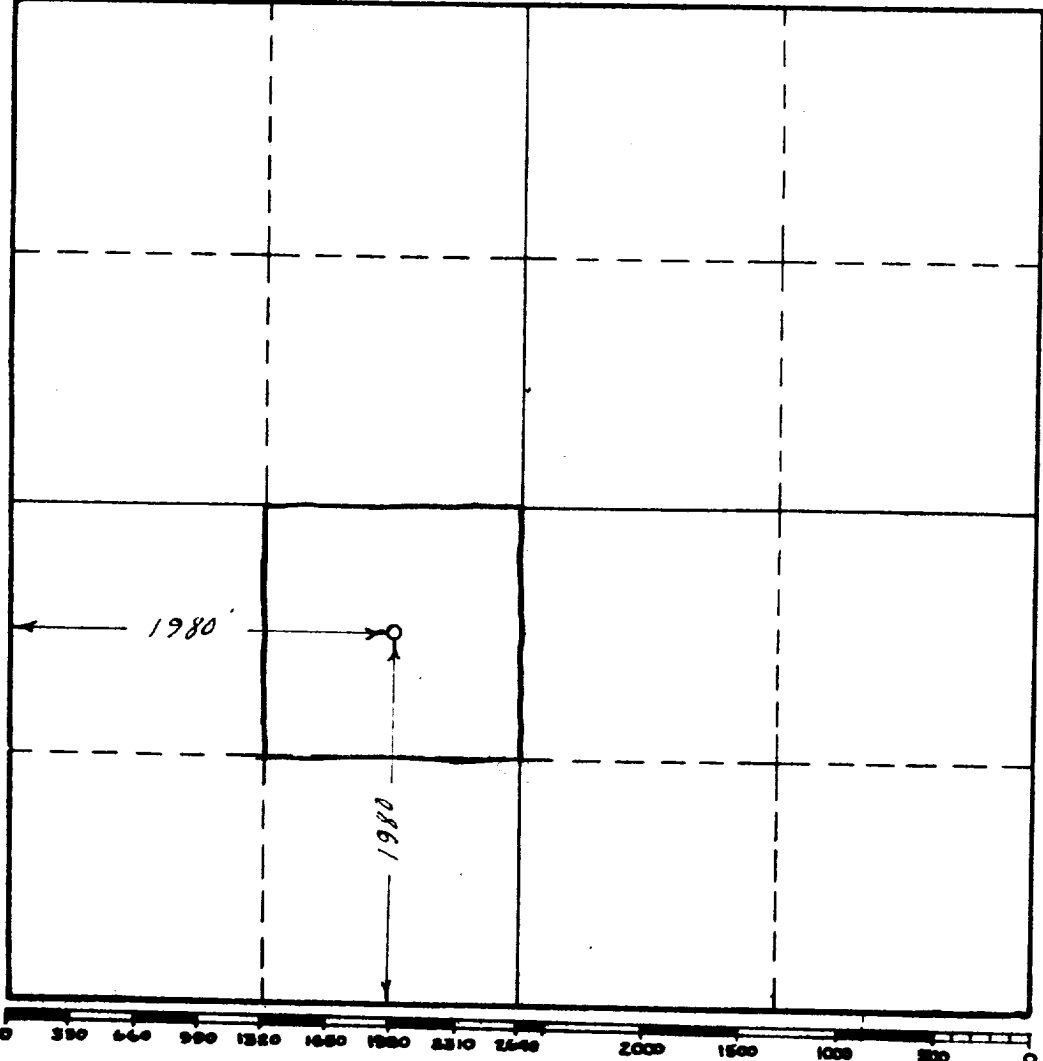

This is to certify that the information in Section A above is true and complete to the best of my knowledge and belief.

Neal E. Salsich (Operator)

(Representative)

Mudland Texas Address

This is to certify that the well location shown on the plat in Section B was plotted from field notes of actual surveys made by me or under my supervision and that the same is true and correct to the best of my knowledge and belief. Date Surveyed 7-8-1957

John W. West Registered Professional Engineer and/or Land Surveyor.

Certificate No. 676

(See instructions for completion of this form)

OIL CONSERVATION COMMISSION

ARTESIA DISTRICT OFFICE

No. Copies Received 6

DISTRIBUTION

	NO. FURNISHED	
Operator	<u>1</u>	
Santa Fe		
Proration Office	<u>1</u>	
State Land Office	<u>1</u>	
U. S. G. S.	<u>1</u>	
Transporter		
File	<u>1</u>	<input checked="" type="checkbox"/>