

(SUBMIT IN TRIPLICATE)

UNITED STATES
DEPARTMENT OF THE INTERIOR
GEOLOGICAL SURVEY

Land Office Las Cruces
Lead No. 10 061783 B
Unit 061783 (6)
JUL 28 1959
30-015-00760

SUNDRY NOTICES AND REPORTS ON WELLS

NOTICE OF INTENTION TO DRILL	<input checked="" type="checkbox"/>	SUBSEQUENT REPORT OF WATER SHUT-OFF	
NOTICE OF INTENTION TO CHANGE PLANS		SUBSEQUENT REPORT OF SHOOTING OR ACIDIZING	
NOTICE OF INTENTION TO TEST WATER SHUT-OFF		SUBSEQUENT REPORT OF ALTERING CASING	
NOTICE OF INTENTION TO RE-DRILL OR REPAIR WELL		SUBSEQUENT REPORT OF RE-DRILLING OR REPAIR	
NOTICE OF INTENTION TO SHOOT OR ACIDIZE		SUBSEQUENT REPORT OF ABANDONMENT	
NOTICE OF INTENTION TO PULL OR ALTER CASING		SUPPLEMENTARY WELL HISTORY	
NOTICE OF INTENTION TO ABANDON WELL			

(INDICATE ABOVE BY CHECK MARK NATURE OF REPORT, NOTICE, OR OTHER DATA)

USAMANN FEDERAL

July 20, 1959

Well No. 2 is located 1650 ft. from S line and 990 ft. from W line of sec. 3

NW 1/4 SW 1/4 Section 3
(1/4 Sec. and Sec. No.)

18S
(Twp.)

27E
(Range)

NMPM
(Meridian)

Undesignated
(Field)

144
(County or Subdivision)

New Mexico
(State or Territory)

The elevation of the derrick floor above sea level is _____ ft.

furnish later. **JUL 28 1959**

DETAILS OF WORK

(State names of and expected depths to objective sands; show sizes, weights, and lengths of proposed casings; indicate mudding jobs, cementing points, and all other important proposed work)

We propose to drill the above well with rotary tools to an approximate depth of 6200' to test the Abo. Casing program will be as follows:

Size of Hole
12-1/4

Size of Casing
8-5/8

Depth
1500

Cement
Circulate 2% Gel, plus 100 sacks meat on bottom

7-7/8

4-1/2

6200

650 sacks Lone Star Incer plus 100 sacks 2% Incer gel plus 100 sacks 50-50 Pozmix "G".

APPROVAL IS SUBJECT TO STATE ENGINEERS REGULATIONS REQUIRED ON "APPLICATION FOR PERMIT TO DRILL FOR OIL" IN WATER BASIN. BOX 810, ROSWELL, NEW MEXICO

I understand that this plan of work must receive approval in writing by the Geological Survey before operations may be commenced.

Company Pan American Petroleum Corporation

Address Post Office Box 68

Hobbs, New Mexico

By _____

Title Area Superintendent

NEW MEXICO OIL CONSERVATION COMMISSION
WELL LOCATION AND ACREAGE DEDICATION PLAT

FORM C-128
Revised 5/1/57

SEE INSTRUCTIONS FOR COMPLETING THIS FORM ON THE REVERSE SIDE

SECTION A

Operator Pan American Pet. Corp.		Lease Mann Federal		JUL 28 1959	
Unit Letter L	Section 3	Township 18 South	Range 27 East	County Eddy	
Actual Footage Location of Well: 1650 feet from the South line and 990 feet from the West line					
Ground Level Elev. Purnish later	Producing Formation Abo		Pool Empire Abo	Dedicated Acreage: 40 Acres	

1. Is the Operator the only owner in the dedicated acreage outlined on the plat below? YES ☒ NO ☐ ("Owner" means the person who has the right to drill into and to produce from any pool and to appropriate the production either for himself or for himself and another. (65-3-29 (e) NMSA 1935 Comp.)
2. If the answer to question one is "no," have the interests of all the owners been consolidated by communization agreement or otherwise? YES ☐ NO ☐ If answer is "yes," Type of Consolidation _____
3. If the answer to question two is "no," list all the owners and their respective interests below:

Owner	Land Description

RECEIVED

JUL 22 1959

U. S. GEOLOGICAL SURVEY
ARTESIA, NEW MEXICO
CERTIFICATION

SECTION B

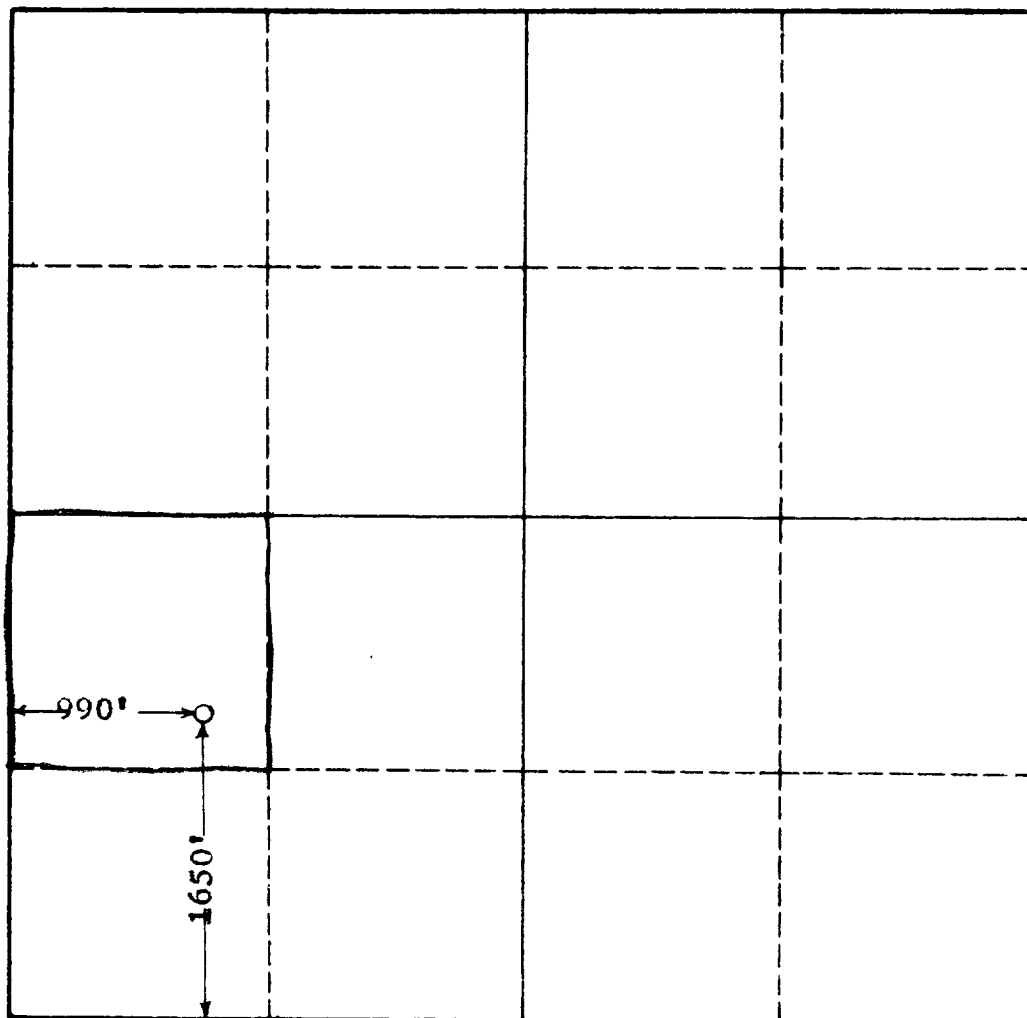

I hereby certify that the information in SECTION A above is true and complete to the best of my knowledge and belief.

Name _____ Original Signed by
J. W. BROWN

Position
Area Superintendent

Company
Pan American Petroleum Corp.

Date
July 20, 1959

I hereby certify that the well location shown on the plat in SECTION B was plotted from field notes of actual surveys made by me or under my supervision, and that the same is true and correct to the best of my knowledge and belief.

Date Surveyed

7-17-59

Registered Professional Engineer
and/or Land Surveyor, **JOHN W. WEST**

John W. West

Certificate No.
N. M. - P. E. & L. S. NO. 676

0 330 660 990 1320 1650 1980 2310 2640 2000 1500 1000 500 0

JOHN W. WEST ENGINEERING COMPANY

412 NORTH DAL PASO
HOBBS, NEW MEXICO

July 18, 1959

Pan American Pet. Corp.
Hobbs, New Mexico

On July 17, 1959, a survey was made to locate your No. 6 location on the U.S.A. Malco Refineries "H" lease at a point 2310 feet from the North line and 1650 feet from the East line of Section 3, Township 18 South, Range 27 East, N.M.P.M., Eddy County, New Mexico.

A flag was set at the Quarter Corner marker common to Sections 2 and 3, and the Transit was set up at the USGLO Section corner marker common to Sections 2, 3, 34 and 35. Thence chaining South from the Transit a distance of 2310 feet, thence West 1650 feet to the location site of the USA Malco Refineries "H" No. 6. As a check on our survey we chained East from the location site 1650 feet, thence South 287 feet to the USGLO Quarter corner marker common to Sections 2 and 3, checking in within 0.5 feet of the distance as shown on the USGLO township plats.

I hereby certify that the foregoing survey was made in the field under my supervision and that the same is true and correct to the best of my knowledge and belief.

Respectfully submitted,

John W. West

ARTESIA DISTRICT OFFICE

No. Copies Received

0.31000000

Number of hauls	Atlantic croaker (%)	Striped bass (%)	Rockfish (%)	Atlantic herring (%)
1	85	35	45	35
2	10	45	35	25
3	5	15	25	15
4	5	10	15	10

Condition	Control (%)	MCI (%)	AD (%)
1	95	85	75
2	90	80	70
3	85	75	65
4	85	75	65

100

3. *Chlorophyll a* and *Chlorophyll b* contents were determined by spectrophotometry using the method of Lichtenthaler and Whistler (1987).

[illegible]

352 07 34953