

Form 9-831a
(Feb. 1951)

Fed. Land Office LC-070938

(SUBMIT IN TRIPLICATE)

Lease No. Hondo Lease Unitized

Unit L

APPROVED: MAY 12 1960
JAMES A. KNAUF, DISTRICT ENGINEER
SUBJECT TO LIKE APPROVAL BY STATE ENG'G
NEER. P. O. BOX 810 ROSWELL NEW MEXICO

UNITED STATES
DEPARTMENT OF THE INTERIOR
GEOLOGICAL SURVEY

30-015-00841

RECEIVED
MAY 13 1960

See Attached Plat

SUNDRY NOTICES AND REPORTS ON WELLS

O. C. C.
ARTESIA, OFFICE

NOTICE OF INTENTION TO DRILL.....	<input checked="" type="checkbox"/>	SUBSEQUENT REPORT OF WATER SHUT-OFF.....	
NOTICE OF INTENTION TO CHANGE PLANS.....		SUBSEQUENT REPORT OF SHOOTING OR ACIDIZING.....	
NOTICE OF INTENTION TO TEST WATER SHUT-OFF.....		SUBSEQUENT REPORT OF ALTERING CASING.....	
NOTICE OF INTENTION TO RE-DRILL OR REPAIR WELL.....		SUBSEQUENT REPORT OF RE-DRILLING OR REPAIR.....	
NOTICE OF INTENTION TO SHOOT OR ACIDIZE.....		SUBSEQUENT REPORT OF ABANDONMENT.....	
NOTICE OF INTENTION TO PULL OR ALTER CASING.....		SUPPLEMENTARY WELL HISTORY.....	
NOTICE OF INTENTION TO ABANDON WELL.....			

(INDICATE ABOVE BY CHECK MARK NATURE OF REPORT, NOTICE, OR OTHER DATA)

ABO-CHALK BLUFF DRAW UNIT

May 10, 1960

Well No. 10 is located 1650 ft. from ^X~~N~~_S line and 990 ft. from ^X~~E~~_W line of sec. 9

NW/4 of SW/4 of 9 (1/4 Sec. and Sec. No.) 18-S (Twp.) 27-E (Range) (Meridian)

Empire-Abo (Field) Eddy (County or Subdivision) New Mexico (State or Territory)

The elevation of the derrick floor above sea level is later ft.

RECEIVED
MAY 12 1960
U. S. GEOLOGICAL SURVEY
ARTESIA, NEW MEXICO

DETAILS OF WORK

(State names of and expected depths to objective sands; show sizes, weights, and lengths of proposed casings; indicate mudding jobs, cementing points, and all other important proposed work)

CASING PROGRAM		DEPTH	CEMENTING PROGRAM	CORING PROGRAM
Size	Wt.			
8-5/8	24#	1500	Circulate to surface.	None
4-1/2	9.50	6100	Circulate to approx. 600' above top of uppermost pay.	

Halliburton method of cementing to be used.

Minimum mud for samples.

Proposed total depth 6100' to test the Abo Formation.

Surface csg. to be set & cemented in accordance with State Engineering Memo No. 63 covering the Artesia Water Basin.

APPROVAL IS SUBJECT TO STATE ENGINEERS REGULATIONS REQUIRED ON "APPLICATION FOR PERMIT TO DRILL FOR OIL" IN WATER BASIN.

BOX 810, ROSWELL, NEW MEXICO

I understand that this plan of work must receive approval in writing by the Geological Survey before operations may be commenced.

Company Humble Oil & Refining Co.

Address Box 1600

Midland, Texas

By

Title Area Adm.

NEW MEXICO OIL CONSERVATION COMMISSION

Well Location and Acreage Dedication Plat

Section A.

Date May 10, 1960

Operator Humble Oil & Refining Co. Lease Abo - Chalk Bluff Draw Unit
 Well No. 10 Unit Letter "L" Section 9 Township 18 South Range 27 East NMPM
 Located 1650 Feet From South Line, 990 Feet From West Line
 County Eddy G. L. Elevation Later Dedicated Acreage 40 Acres
 Name of Producing Formation Abo Pool Empire - Abo

1. Is the Operator the only owner* in the dedicated acreage outlined on the plat below?
 Yes _____ No
2. If the answer to question one is "no", have the interests of all the owners been consolidated by communitization agreement or otherwise? Yes No _____ If answer is "yes," Type of Consolidation Unitization
3. If the answer to question two is "no," list all the owners and their respective interests below:

Owner

Land Description

<u>Owner</u>	<u>Land Description</u>

Section B

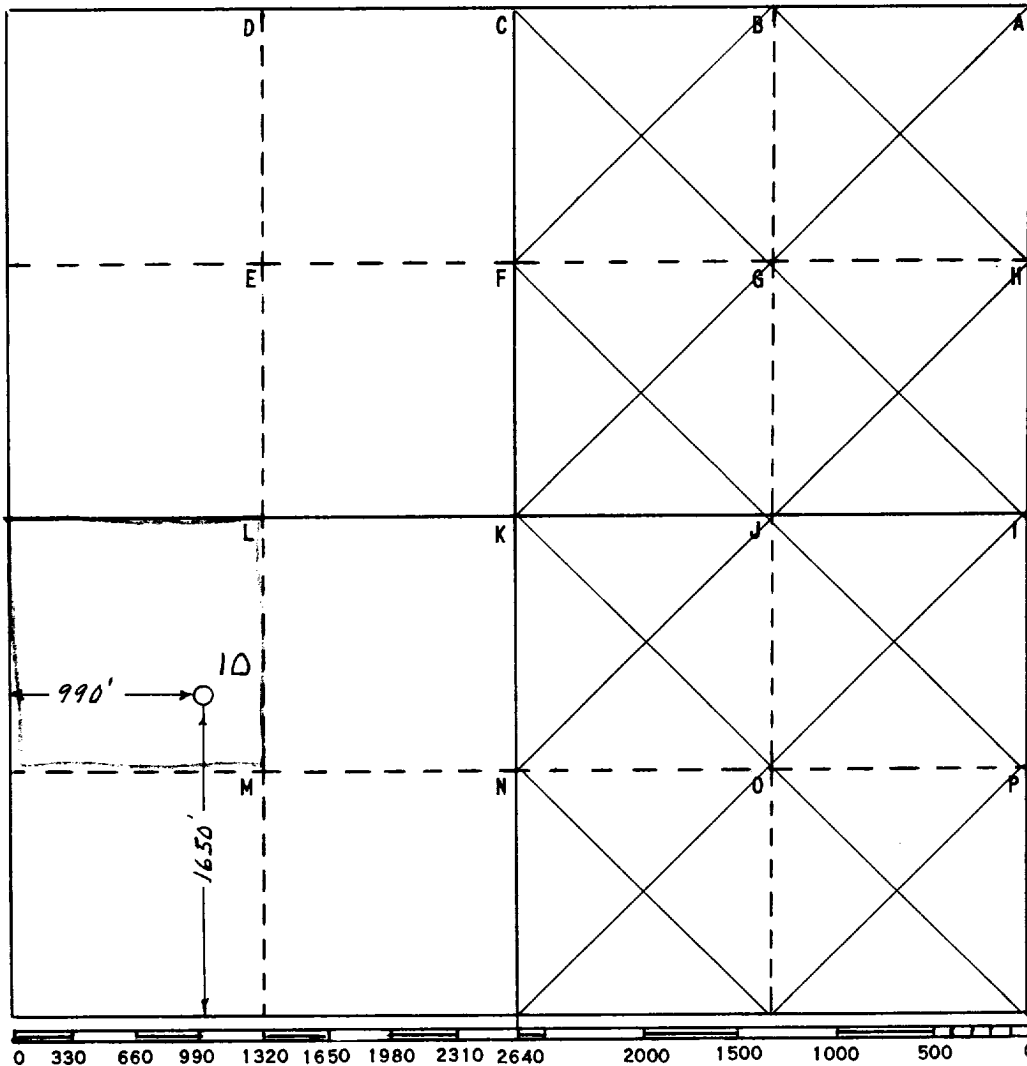

This is to certify that the information in Section A above is true and complete to the best of my knowledge and belief

HUMBLE OIL & REFG. CO.
 (Operator)

H.P. Hensley
 (Representative)

Box 1600 Midland, Texas
 Address

This is to certify that the well location shown on the plat in Section B was plotted from field notes of actual surveys made by me or under my supervision and that the same is true and correct to the best of my knowledge and belief.

Date Surveyed 5-6-60

Wendell S. Hunterfield
 Registered Professional
 Engineer and/or Land Surveyor

Certificate No. 1382