

Form 9-381a
(Feb. 1961)

APPROVED: *[Signature]*
JUL 14 1960
REGISTERED PROFESSIONAL ENGINEER
STATE OF NEW MEXICO
ROSWELL, NEW MEXICO

(SUBMIT IN TRIPLICATE)

UNITED STATES
DEPARTMENT OF THE INTERIOR
GEOLOGICAL SURVEY

Land Office **New Mexico**
Lease No. **NM 025606**
Unit **B**

RECEIVED

SUNDRY NOTICES AND REPORTS ON WELLS

		B. C. C.
NOTICE OF INTENTION TO DRILL	<input checked="" type="checkbox"/>	SUBSEQUENT REPORT OF WATER ANALYSIS
NOTICE OF INTENTION TO CHANGE PLANS		SUBSEQUENT REPORT OF SHOOTING OR ACIDIZING
NOTICE OF INTENTION TO TEST WATER SHUT-OFF		SUBSEQUENT REPORT OF ALTERING CASING
NOTICE OF INTENTION TO RE-DRILL OR REPAIR WELL		SUBSEQUENT REPORT OF RE-DRILLING OR REPAIR
NOTICE OF INTENTION TO SHOOT OR ACIDIZE		SUBSEQUENT REPORT OF ABANDONMENT
NOTICE OF INTENTION TO PULL OR ALTER CASING		SUPPLEMENTARY WELL HISTORY
NOTICE OF INTENTION TO ABANDON WELL		

(INDICATE ABOVE BY CHECK MARK NATURE OF REPORT, NOTICE, OR OTHER DATA)

July 13, 1960

Well No. **2-2** is located **990** ft. from **N** line and **1650** ft. from **E** line of sec. **29**

NW 1/4 **29** **18 S** **27 E** **NM 1/4**
(1/4 Sec. and Sec. No.) (Twp.) (Range) (Meridian)
Undesignated **County** **New Mexico**
(Field) (County or Subdivision) (State or Territory)

The elevation of the derrick floor above sea level is **3362** ft.

DETAILS OF WORK

(State names of and expected depths to objective sands; show sizes, weights, and lengths of proposed casings; indicate mudding jobs, cementing points, and all other important proposed work)

Propose to drill to approximate depth of 1600 feet to test Grayburg formation with Lee Drilling Company rotary rig. The following casing is proposed:

14 5-1/2" J-55 to total depth cemented to surface with approximately 400 sacks 50-50 pozmix and 200 sacks neat.

I understand that this plan of work must receive approval in writing by the Geological Survey before operations may be commenced.

Company **William and Mildred Crane Hudson**

Address **P. O. Box 476**
Artesia, New Mexico

LEE DRILLING COMPANY
By *[Signature]*
Drilling Supt.
Title
Agent

RECEIVED

NEW MEXICO OIL CONSERVATION COMMISSION
WELL LOCATION AND ACREAGE DEDICATION PLAT

FORM C-128
Revised 5/1/57

JUL 18 1960

SEE INSTRUCTIONS FOR COMPLETING THIS FORM ON THE REVERSE SIDE.

SECTION A				ARTESIA, OFFICE	
Operator William & Mildred Crane Hudson			Lease Federal # "G"	Well No. 2	
Unit Letter B	Section 29	Township 18 South	Range 27 East	County Eddy	
Actual Footage Location of Well: 990 feet from the North line and 1650 feet from the East line					
Ground Level Elev. 3350	Producing Formation Premier		Pool <i>Acres</i>	Dedicated Acreage: 40 Acres	

1. Is the Operator the only owner in the dedicated acreage outlined on the plat below? YES _____ NO _____. ("Owner" means the person who has the right to drill into and to produce from any pool and to appropriate the production either for himself or for himself and another. (65-3-29 (e) NMSA 1935 Comp.)
2. If the answer to question one is "no," have the interests of all the owners been consolidated by communitization agreement or otherwise? YES _____ NO _____. If answer is "yes," Type of Consolidation _____
3. If the answer to question two is "no," list all the owners and their respective interests below:

Owner	Land Description

SECTION B

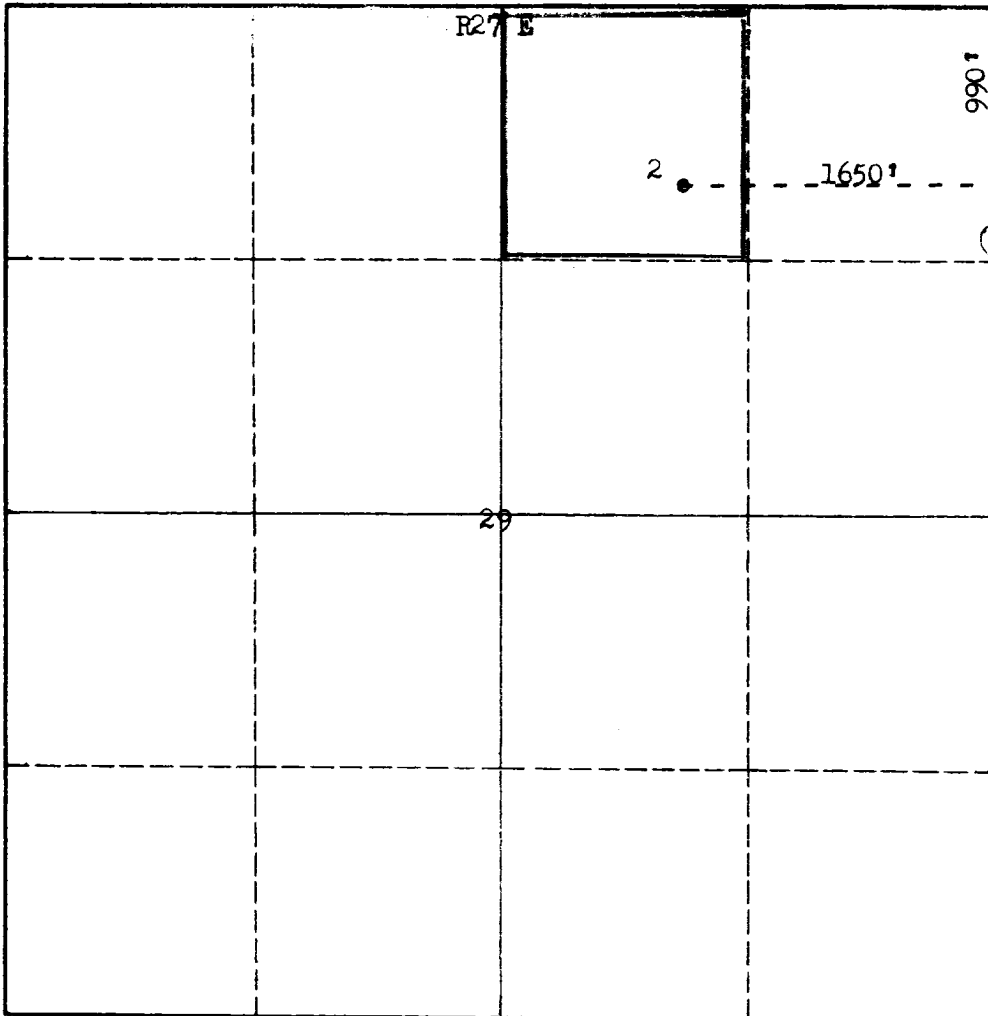

CERTIFICATION

I hereby certify that the information in SECTION A above is true and complete to the best of my knowledge and belief.

Name *Fred Justice*
Position *Production Supt.*
Company *Lee Drilling Co*
Date *7-14-60*

I hereby certify that the well location shown on the plat in SECTION B was plotted from field notes of actual surveys made by me or under my supervision, and that the same is true and correct to the best of my knowledge and belief.

Date Surveyed July, 12, 1960
Registered Professional Engineer and/or Land Surveyor
James A. Dixon
Certificate No. N.M.L.S. No. 542

0 330 660 990 1320 1650 1980 2310 2640 2000 1500 1000 500 0

INSTRUCTIONS FOR COMPLETION OF FORM C-128

1. Operator shall furnish and certify to the information called for in Section A.
2. Operator shall outline the dedicated acreage for *both* oil and gas wells on the plat in Section B.
3. A registered professional engineer or land surveyor registered in the State of New Mexico or approved by the Commission shall show on the plat the location of the well and certify this information in the space provided.
4. All distances shown on the plat must be from the outer boundaries of the Section. 122
5. If additional space is needed for listing owners and their respective interests as required in question 3 of Section A, please use space below.