

NEW MEXICO OIL CONSERVATION COMMISSION
Santa Fe, New Mexico

Form C-101
Revised (12/1/55)

NOTICE OF INTENTION TO DRILL

Notice must be given to the District Office of the Oil Conservation Commission and approval obtained before drilling or recompletion begins. If changes in the proposed plan are considered advisable, a copy of this notice showing such changes will be returned to the sender. Submit this notice in QUINTUPPLICATE. One copy will be returned following approval. See additional instructions in Rules and Regulations of the Commission. If State Land submit 6 Copies Attach Form C-128 in triplicate to first 3 copies of form C-101

Artesia, New Mexico
(Place)

December 5, 1962
(Date)

OIL CONSERVATION COMMISSION
SANTA FE, NEW MEXICO

Gentlemen:

You are hereby notified that it is our intention to commence the Drilling of a well to be known as

Western-Yates
(Company or Operator)

State 648

Well No. 69

O

The well is

located 1117 feet from the South line and 1461 feet from the

East

line of Section 10

T. 19-S

R. 28-E

NMPM.

(GIVE LOCATION FROM SECTION LINE)

Artesia

Pool,

Eddy

County

If State Land the Oil and Gas Lease is No. 648

If patented land the owner is

Address

We propose to drill well with drilling equipment as follows: cable tools

The status of plugging bond is blanket bond

Drilling Contractor Harvey Yates

We intend to complete this well in the Grayburg

formation at an approximate depth of 2180 feet.

CASING PROGRAM

We propose to use the following strings of Casing and to cement them as indicated:

Size of Hole	Size of Casing	Weight per Foot	New or Second Hand	Depth	Sacks Cement
8"	7"	17 lb.	Used	450'	50 sx.
6"	4 1/2"	11.6 lb.	New	2180'	125 sx.

If changes in the above plans become advisable we will notify you immediately.

ADDITIONAL INFORMATION (If recompletion give full details of proposed plan of work.)

RECEIVED

DEC 6 1962

O. C. C.
ARTESIA, OFFICE

Approved DEC 6 1962, 19
Except as follows:

Sincerely yours,

Western-Yates
(Company or Operator)

By

Position Assistant Production Superintendent

Send Communications regarding well to

Name Western-Yates

Address P.O. Box 427, Artesia, New Mexico

OIL CONSERVATION COMMISSION

By M. L. Armstrong

NEW MEXICO OIL CONSERVATION COMMISSION
WELL LOCATION AND ACREAGE DEDICATION PLAT

FORM C-128
Revised 5/1/57

SEE INSTRUCTIONS FOR COMPLETING THIS FORM ON THE REVERSE SIDE

SECTION A

Operator Western-Yates			Lease State 648		Well No. 69
Unit Letter O	Section 10	Township 19-S	Range 28-E	County Eddy	
Actual Footage Location of Well: 1117 feet from the S line and 1461 feet from the E line					
Ground Level Elev. 3506'	Producing Formation Grayburg		Pool Artesia		Dedicated Acreage: 40 Acres

1. Is the Operator the only owner in the dedicated acreage outlined on the plat below? YES ☒ NO ____ . ("Owner" means the person who has the right to drill into and to produce from any pool and to appropriate the production either for himself or for himself and another. (65-3-29 (e) NMSA 1935 Comp.)
2. If the answer to question one is "no," have the interests of all the owners been consolidated by communitization agreement or otherwise? YES ____ NO ____ . If answer is "yes," Type of Consolidation _____
3. If the answer to question two is "no," list all the owners and their respective interests below:

Owner	Land Description

SECTION B

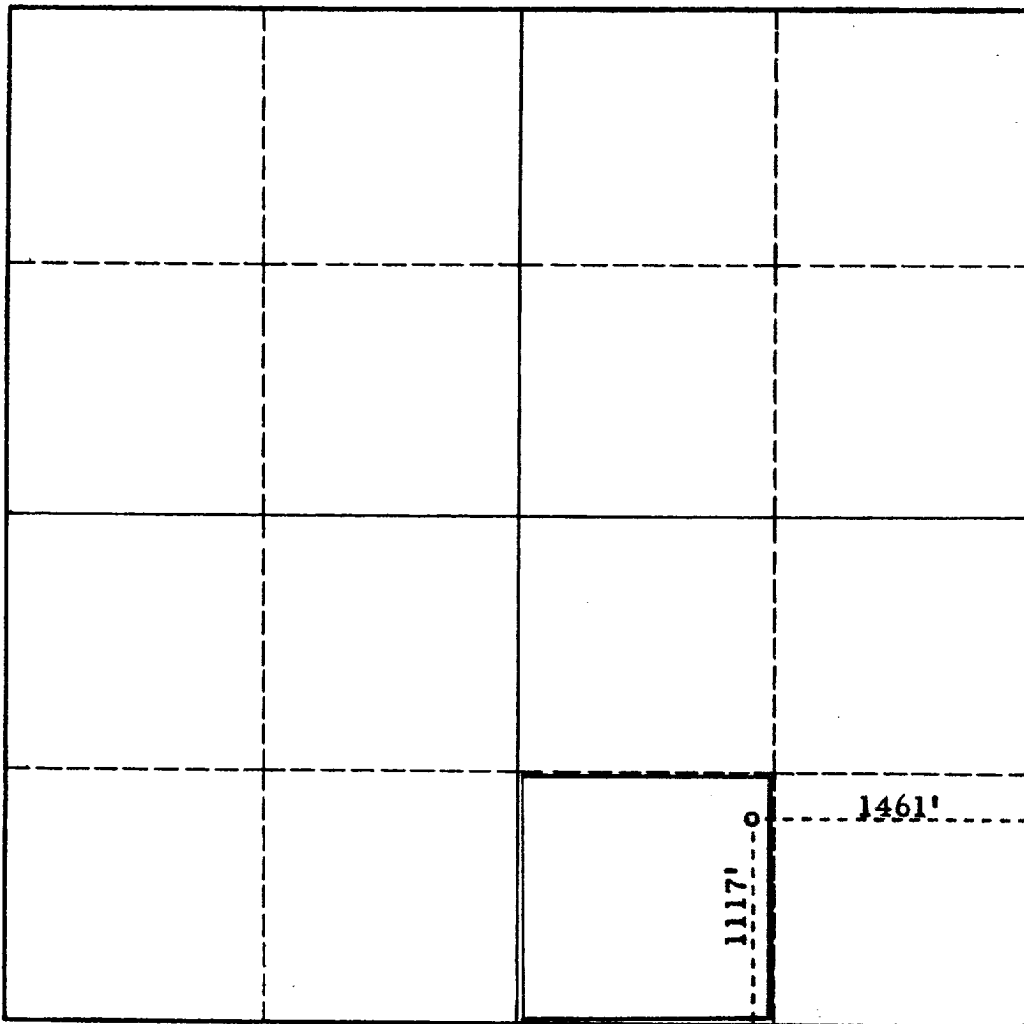

CERTIFICATION

I hereby certify that the information in SECTION A above is true and complete to the best of my knowledge and belief.

Name <i>Jack B. Bender</i>
Position Ast. Prod. Supt.
Company Western-Yates
Date March 23, 1962

I hereby certify that the well location shown on the plat in SECTION B was plotted from field notes of actual surveys made by me or under my supervision, and that the same is true and correct to the best of my knowledge and belief.

Date Surveyed March 17, 1962
Registered Professional Engineer and/or Land Surveyor <i>Harry E. Yates</i>
Certificate No. 772

INSTRUCTIONS FOR COMPLETION OF FORM C-128

1. Operator shall furnish and certify to the information called for in Section A.
2. Operator shall outline the dedicated acreage for *both* oil and gas wells on the plat in Section B.
3. A registered professional engineer or land surveyor registered in the State of New Mexico or approved by the Commission shall show on the plat the location of the well and certify this information in the space provided.
4. All distances shown on the plat must be from the outer boundaries of the Section.
5. If additional space is needed for listing owners and their respective interests as required in question 3 of Section A, please use space below.

