

NEW MEXICO OIL CONSERVATION COMMISSION
Santa Fe, New Mexico

NOTICE OF INTENTION TO DRILL OR RECOMPLETE

Notice must be given to the District Office of the Oil Conservation Commission and approval obtained before drilling or recompletion begins. If changes in the proposed plan are considered advisable, a copy of this notice showing such changes will be returned to the sender. Submit this notice in QUINTUPLICATE. One copy will be returned following approval. See additional instructions in Rules and Regulations of the Commission.

Midland, Texas

(Place)

March 13, 1956

(Date)

OIL CONSERVATION COMMISSION
SANTA FE, NEW MEXICO

Gentlemen:

You are hereby notified that it is our intention to commence the (Drilling) (~~Recompletion~~) of a well to be known as

W. H. Black

(Company or Operator)

State Lease

(Lease)

Well No. 2

H

(Unit)

located 990 feet from the East line and 1650 feet from the

North

line of Section 32, T. 19 S, R. 30 E, NMPM.

(GIVE LOCATION FROM SECTION LINE) Undesignated Pool, Eddy County

If State Land the Oil and Gas Lease is No. E-9542

If patented land the owner is

Address

We propose to drill well with drilling equipment as follows: Cable Tools

The status of plugging bond is Approved - Statewide Central Surety

Insurance Company Bond #257434

Drilling Contractor J. C. Clower

D	C	B	A
E	F	G	X H
L	K	J	I
M	N	O	P

We intend to complete this well in the Yates Formation

formation at an approximate depth of 1700 feet.

CASING PROGRAM

We propose to use the following strings of Casing and to cement them as indicated:

Size of Hole	Size of Casing	Weight per Foot	New or Second Hand	Depth	Sacks Cement
12"	9 5/8"	32.30	New	375'	150
8"	5 1/2"	14#	New	1685'	425

If changes in the above plans become advisable we will notify you immediately.

ADDITIONAL INFORMATION (If recompletion give full details of proposed plan of work.)

Approved _____, 19_____
Except as follows:

OIL CONSERVATION COMMISSION

By J. G. Johnson

Title _____

Sincerely yours,

W. H. Black

(Company or Operator)

By

Position

Agent

Send Communications regarding well to

Name J. S. Bell

Address Box 174

Midland, Texas

NEW MEXICO
OIL CONSERVATION COMMISSION

Form C-128

Well Location and/or Gas Proration Plat

Date FEB 21 1956

Operator W H BLACK

Lease LOWE STATE

Well No. 2 Section 32 Township 19S Range 30E NMPM

Located 1650 Feet From NORTH Line, 990 Feet From EAST Line,

EDDY

County, New Mexico. G. L. Elevation 3271.7

Name of Producing Formation _____ Pool _____ Dedicated Acreage _____

(Note: All distances must be from outer boundaries of Section)

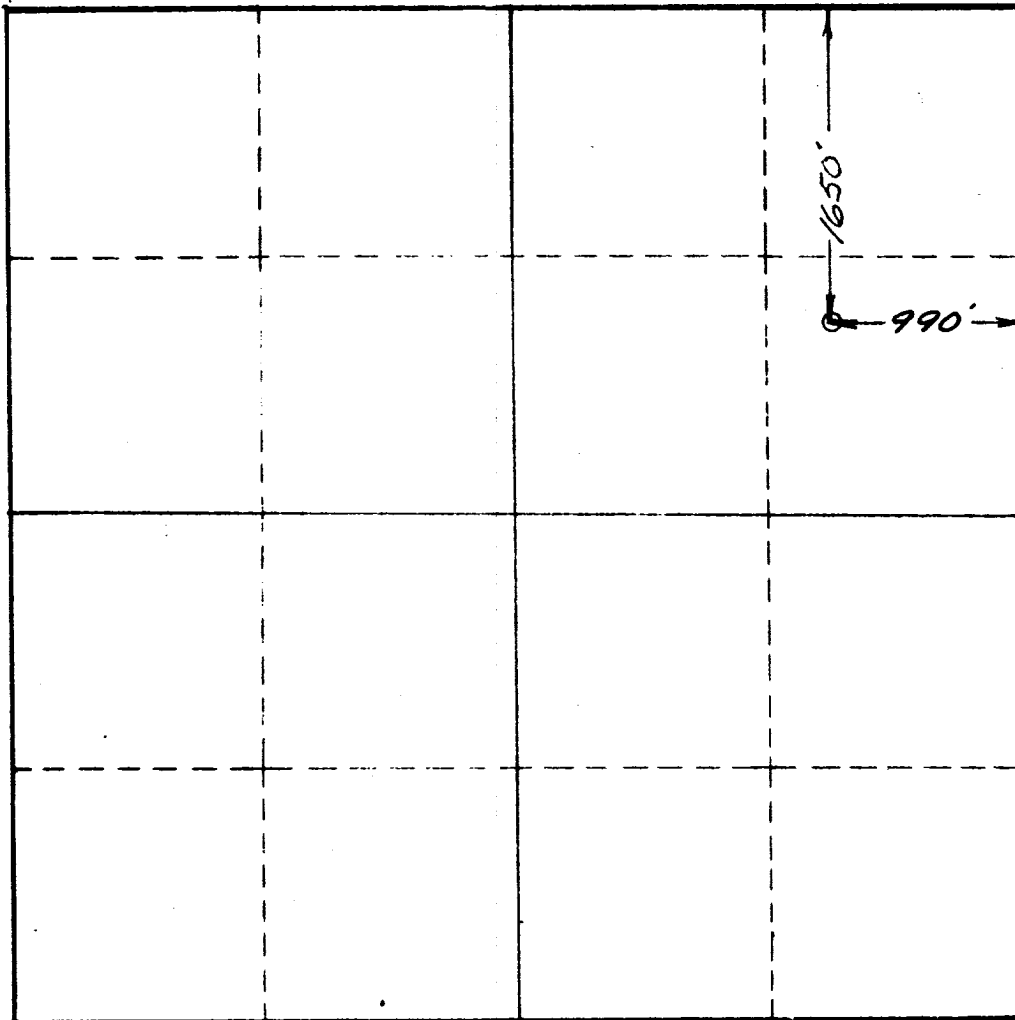

SCALE: 1" = 1000'

1. Is this Well a Dual Comp.? Yes ___ No ___
2. If the answer to Question 1 is yes, are there any other dually completed wells within the dedicated acreage? Yes ___ No ___

This is to certify that the above plat was prepared from field notes of actual surveys made by me or under my supervision and that the same are true and correct to the best of my knowledge and belief.

Name _____
Position _____
Representing _____
Address _____

Date Surveyed FEB. 20, 1956
John W. West
Registered Professional Engineer and/or
Land Surveyor