

(SUBMIT IN TRIPLICATE)

UNITED STATES  
DEPARTMENT OF THE INTERIOR  
GEOLOGICAL SURVEY

Land Office 43  
Lease No. 029392 B  
Unit 4

SEP

SUNDRY NOTICES AND REPORTS ON WELLS

NOTICE OF INTENTION TO DRILL.....	<input checked="" type="checkbox"/>	SUBSEQUENT REPORT OF WATER SHUT-OFF.....	
NOTICE OF INTENTION TO CHANGE PLANS.....		SUBSEQUENT REPORT OF SHOOTING OR ACIDIZING.....	
NOTICE OF INTENTION TO TEST WATER SHUT-OFF.....		SUBSEQUENT REPORT OF ALTERING CASING.....	
NOTICE OF INTENTION TO RE-DRILL OR REPAIR WELL.....		SUBSEQUENT REPORT OF RE-DRILLING OR REPAIR.....	
NOTICE OF INTENTION TO SHOOT OR ACIDIZE.....		SUBSEQUENT REPORT OF ABANDONMENT.....	
NOTICE OF INTENTION TO PULL OR ALTER CASING.....		SUPPLEMENTARY WELL HISTORY.....	
NOTICE OF INTENTION TO ABANDON WELL.....			

(INDICATE ABOVE BY CHECK MARK NATURE OF REPORT, NOTICE, OR OTHER DATA)

SEPTEMBER 4TH, 1958

Well No. HINKLE 3-35 B is located 990 ft. from N line and 990 ft. from E line of sec. 35  
NE 1/4 SEC. 35 18S 31E N.M.P.M.  
(1/4 Sec. and Sec. No.) (Twp.) (Range) (Meridian)  
SHUGART EDDY NEW MEXICO  
(Field) (County or Subdivision) (State or Territory)

The elevation of the derrick floor above sea level is ..... ft.

DETAILS OF WORK

(State names of and expected depths to objective sands; show sizes, weights, and lengths of proposed casings; indicate mudding jobs, cementing points, and all other important proposed work)

PLAN TO RUN 925 FEET OF 8 INCH CASING AND CEMENT WITH 50 BAGS.

PLAN TO RUN 3800 FEET OF 7 INCH CASING, CEMENT WITH 100 BAGS OF CEMENT, PERFORATE THE 7 INCH CASING AND TREAT.

(V. P. SHELDON PLAT ATTACHED)

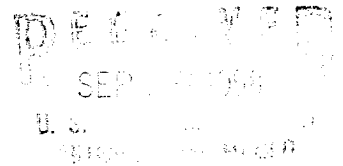

I understand that this plan of work must receive approval in writing by the Geological Survey before operations may be commenced.

Company J. M. WELCH  
 Address BOX 1296, ARTESIA, NEW MEXICO.  
 By J. M. Welch  
 Title OWNER

NEW MEXICO OIL CONSERVATION COMMISSION

Well Location and Acreage Dedication Plat

**APPROVED**  
SEP 10 1958  
JOHN A. FROST  
DISTRICT ENGINEER

Section A.

Date 9-9-58

Operator J.M. Welch Lease Hinkle #3 35  
Well No. 3-35 Unit Letter A Section 35 Township 18N Range 31E NMPM  
Located 990 Feet From N Line, 990 Feet From W Line  
County Eddy G. L. Elevation \_\_\_\_\_ Dedicated Acreage 40 Acres  
Name of Producing Formation Queen Pool Shugart

1. Is the Operator the only owner\* in the dedicated acreage outlined on the plat below?  
Yes  No \_\_\_\_\_.
2. If the answer to question one is "no," have the interests of all the owners been consolidated by communitization agreement or otherwise? Yes \_\_\_\_\_ No \_\_\_\_\_. If answer is "yes," Type of Consolidation \_\_\_\_\_
3. If the answer to question two is "no," list all the owners and their respective interests below:

<u>Owner</u>	<u>Land Description</u>

Section B

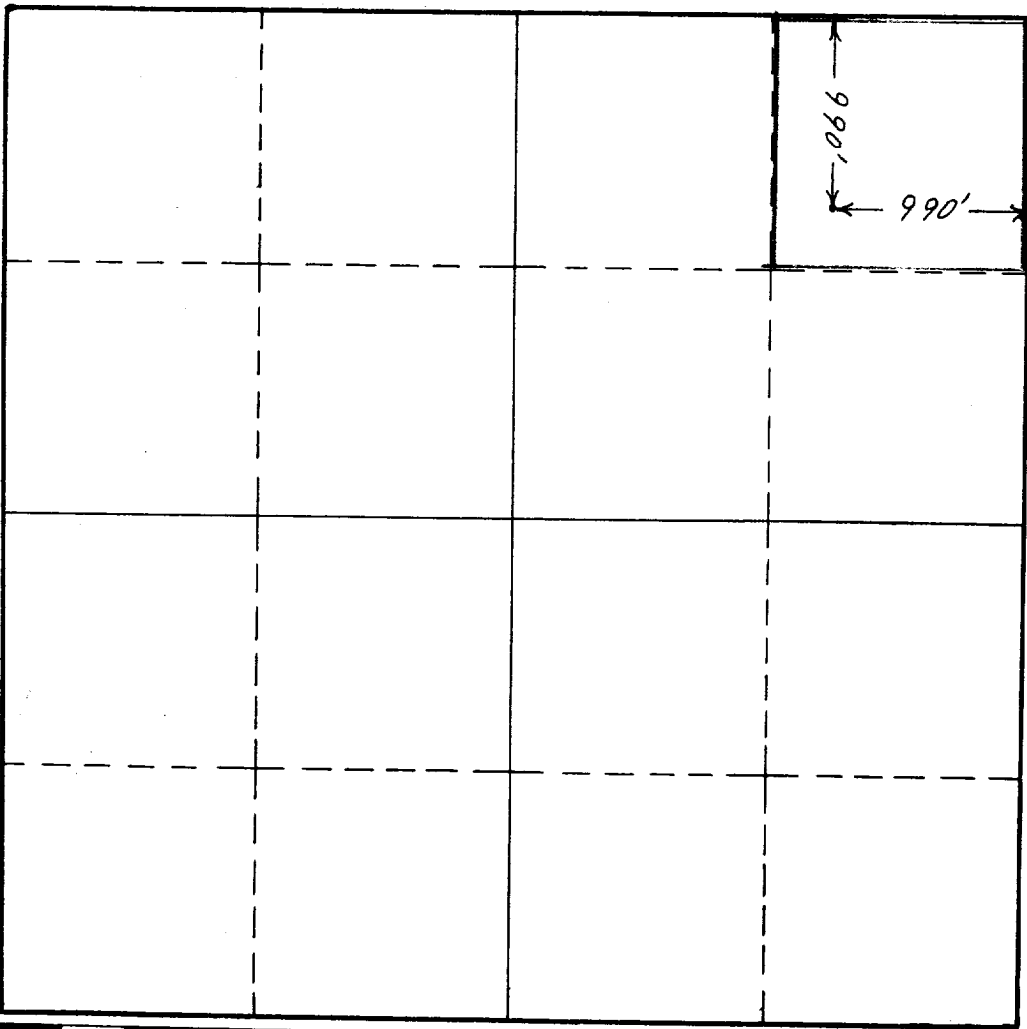

This is to certify that the information in Section A above is true and complete to the best of my knowledge and belief.

J. M. Welch  
(Operator)

(Representative)

Artesia, New Mexico  
Address

This is to certify that the well location shown on the plat in Section B was plotted from field notes of actual surveys made by me or under my supervision and that the same is true and correct to the best of my knowledge and belief.

Date Surveyed 9-8-58  
V. P. Sheldon  
Registered Professional  
Engineer and/or Land Surveyor.

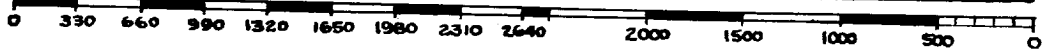

INSTRUCTIONS FOR COMPLETION :

1. Operator shall furnish and certify to the information called for in Section A.
2. Operator shall outline the dedicated acreage for both oil and gas wells on the plat in Section B.
3. A registered professional engineer or land surveyor registered in the State of New Mexico or approved by the Commission shall show on the plat the location of the well and certify this information in the space provided.
4. All distances shown on the plat must be from the outer boundaries of Section.
5. If additional space is needed for listing owners and their respective interests as required in question 3, Section A, please use space below

\* "Owner" means the person who has the right to drill into and to produce from any pool and to appropriate the production either for himself or for himself and another. (65-3-29 (e) NMSA 1953 Comp.)