

UNITED STATES
DEPARTMENT OF THE INTERIOR
GEOLOGICAL SURVEY

30-015-20201

5. LEASE DESIGNATION AND SERIAL NO.
NM04219

6. IF INDIAN, ALLOTTEE OR TRIBE NAME

7. UNIT AGREEMENT NAME

8. FARM OR LEASE NAME
Anderson

9. WELL NO.
2

10. FIELD AND POOL, OR WILDCAT
West
McMillan Sk-Q

11. SEC., T., R., M., OR BLK.
AND SURVEY OR AREA
Sec. 11-20S-26E, MPM

12. COUNTY OR PARISH
Eddy

13. STATE
N. M.

APPLICATION FOR PERMIT TO DRILL, DEEPEN, OR PLUG BACK

1a. TYPE OF WORK
DRILL DEEPEN PLUG BACK

b. TYPE OF WELL
OIL WELL GAS WELL OTHER SINGLE ZONE MULTIPLE ZONE

2. NAME OF OPERATOR
S. P. Yates

3. ADDRESS OF OPERATOR
207 So 4th Street - Artesia, New Mexico

4. LOCATION OF WELL (Report location clearly and in accordance with any State requirements.)*
At surface 2310' FSL & 990' FEL of Sec. 11-20S-26E
At proposed prod. zone

14. DISTANCE IN MILES AND DIRECTION FROM NEAREST TOWN OR POST OFFICE*
Approx 4 miles from Lakewood, New Mexico

15. DISTANCE FROM PROPOSED* LOCATION TO NEAREST PROPERTY OR LEASE LINE, FT. (Also to nearest dirg. unit line, if any)
2310'

16. NO. OF ACRES IN LEASE
320

17. NO. OF ACRES ASSIGNED TO THIS WELL
40

18. DISTANCE FROM PROPOSED LOCATION* TO NEAREST WELL, DRILLING, COMPLETED, OR APPLIED FOR, ON THIS LEASE, FT.
700'

19. PROPOSED DEPTH
700' (Approx. Cable Tools & Rotary)

20. ROTARY OR CABLE TOOLS
Cable Tools & Rotary

21. ELEVATIONS (Show whether DF, RT, GR, etc.)
3278' GR

22. APPROX. DATE WORK WILL START*
1-14-69

23. PROPOSED CASING AND CEMENTING PROGRAM

SIZE OF HOLE	SIZE OF CASING	WEIGHT PER FOOT	SETTING DEPTH	QUANTITY OF CEMENT
15 1/2"	12"	32#	Approx 30'	Ready-Mix
10"	8-5/8"	24#	" 200'	Set & pull
8"	4 1/2"	9#	" 700'	Circulate

It is the intention of S. P. Yates to drill a 15 1/2" hole, set 1 joint of 12" conductor pipe. Drill a 10" hole to approx. 200' and set 8-5/8" casing. Reduce hole to 8" and run 4 1/2" casing to total depth of approximate 700'.

RECEIVED

JAN 15 1969

O. C. C.
ARTESIA, OFFICE

RECEIVED
JAN 13 1969
U. S. GEOLOGICAL SURVEY
ARTESIA, NEW MEXICO

IN ABOVE SPACE DESCRIBE PROPOSED PROGRAM: If proposal is to deepen or plug back, give data on present productive zone and proposed new productive zone. If proposal is to drill or deepen directionally, give pertinent data on subsurface locations and measured and true vertical depths. Give blowout preventer program, if any.

24. SIGNED M. L. Armstrong TITLE Agent DATE 1-13-69

(This space for Federal or State office use)

PERMIT NO. _____ APPROVAL OPERATIONS

APPROVED

APPROVED BY R. L. BEEKMA

CONDITIONS OF APPROVAL, IF ANY:

THIS APPROVAL IS REVOKED IF OPERATIONS ARE NOT COMMENCED WITHIN 3 MONTHS. EXPIRES APR 13 1969

DECLARED WATER BASIN

CEMENT BEHIND THE 4 1/2" CASING MUST BE CIRCULATED

*See Instructions On Reverse Side

NOTIFY USGS IN SUFFICIENT TIME TO WITNESS CEMENTING THE 4 1/2" CASING.

NE MEXICO OIL CONSERVATION COMMISSION
WELL LOCATION AND ACREAGE DEDICATION PLAT

Form C-122
Supersedes C-128
Effective 1-1-65

All distances must be from the outer boundaries of the Section.

Operator S.P. Yates			Lease Anderson		Well No. 2
Unit Letter I	Section 11	Township 20 South	Range 26 East	County Eddy	
Actual Footage Location of Well: 2310 feet from the South line and 990 feet from the East line					
Ground Level Elev. 3278	Producing Formation Duncan	Pool Yates - 28-7	Dedicated Acreage: 40 Acres		

1. Outline the acreage dedicated to the subject well by colored pencil or hachure marks on the plat below.
2. If more than one lease is dedicated to the well, outline each and identify the ownership thereof (both as to working interest and royalty).
3. If more than one lease of different ownership is dedicated to the well, have the interests of all owners been consolidated by communitization, unitization, force-pooling, etc?

Yes No If answer is "yes," type of consolidation _____

If answer is "no," list the owners and tract descriptions which have actually been consolidated. (Use reverse side of this form if necessary.) _____

No allowable will be assigned to the well until all interests have been consolidated (by communitization, unitization, forced-pooling, or otherwise) or until a non-standard unit, eliminating such interests, has been approved by the Commission.

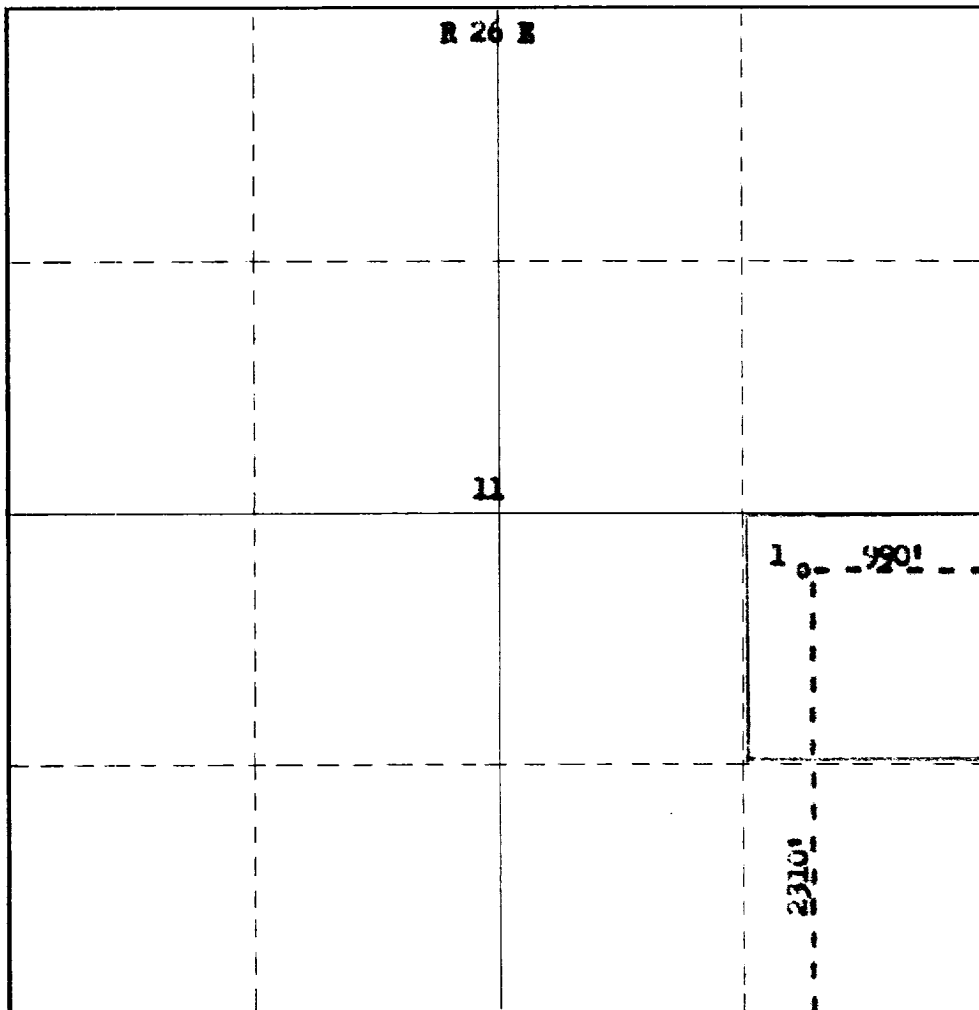

CERTIFICATION

I hereby certify that the information contained herein is true and complete to the best of my knowledge and belief.

M.L. Armstrong
Name

Position
Agent

Company
Yates Petroleum Corp.

Date
1-13-69

I hereby certify that the well location shown on this plat was plotted from field notes of actual surveys made by me or under my supervision, and that the same is true and correct to the best of my knowledge and belief.

Date Surveyed
January, 10, 1969

Registered Professional Engineer and/or Land Surveyor

James H. Brown
Certificate No.

N.A.L.S. No. 562

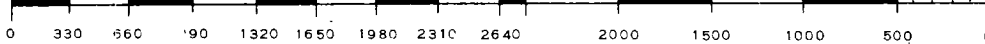

T
20
S