

R 26E

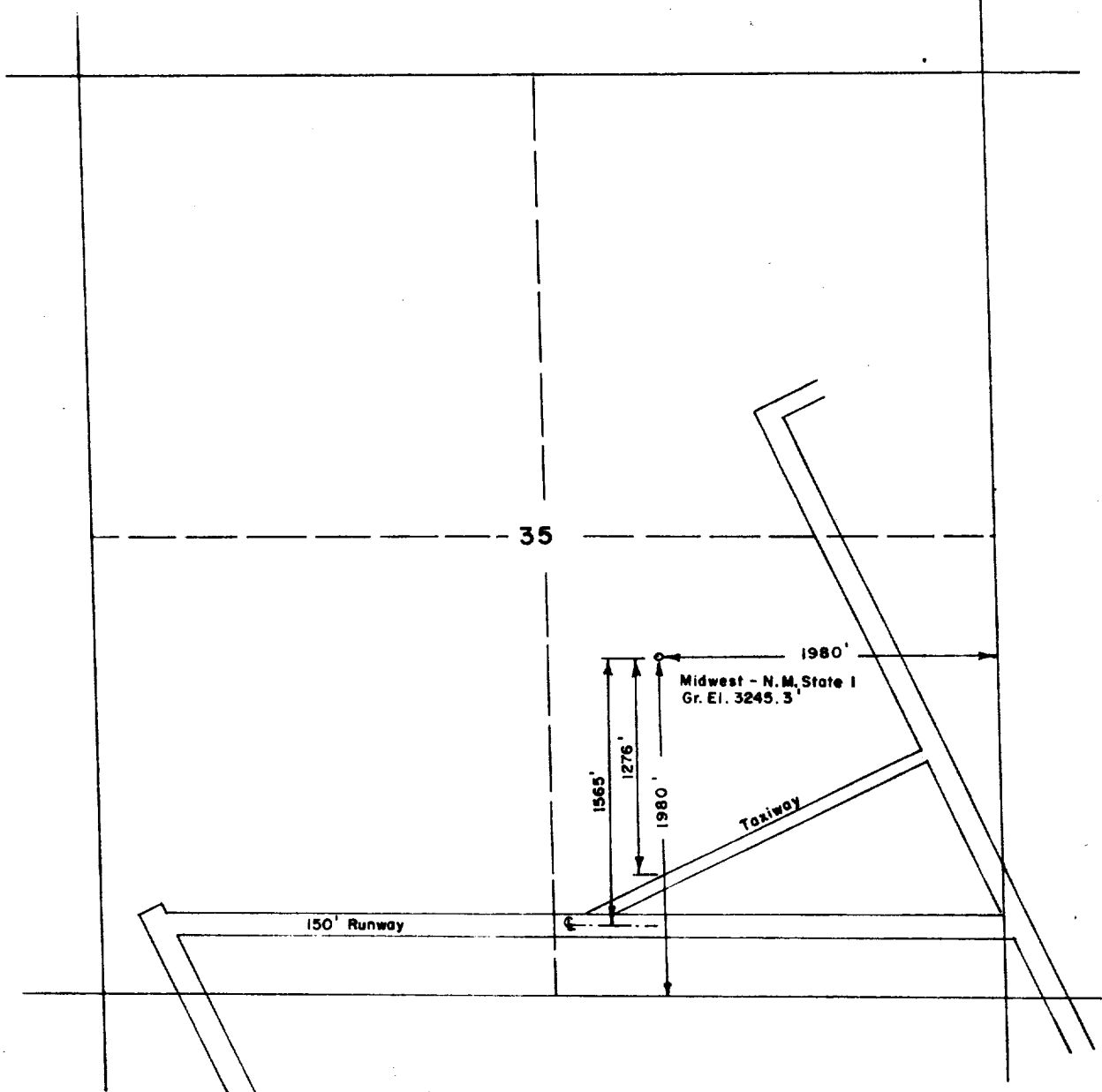

T 22S

RECEIVED

JUL 3 1972

O. C. C.
ARTESIA, OFFICE

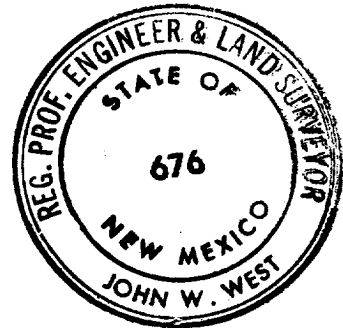

I HEREBY CERTIFY THAT THIS PLAT WAS MADE FROM NOTES TAKEN IN THE FIELD IN A BONA FIDE SURVEY MADE UNDER MY SUPERVISION, AND THAT THE SAME IS TRUE AND CORRECT TO THE BEST OF MY KNOWLEDGE AND BELIEF.

John W. West
JOHN W. WEST, N.M. P.E. & L.S. NO. 676
TEXAS R.P.S. NO. 1138

MIDWEST OIL CORP.	
PLAT SHOWING LOCATION OF N.M. STATE Y No. 1 AND TAXIWAY AND RUNWAY OF CARLSBAD MUNICIPAL AIRPORT, T-22-S, R-26-E, N. M. P. M. EDDY COUNTY, NEW MEXICO.	
JOHN W. WEST ENGINEERING COMPANY CONSULTING ENGINEERS HOBBS, NEW MEXICO	
Scale 1"=1000'	Drawn by J.N.N.
Date JUNE 15, 1972	Sheet 1 of 1 Sheets

