

MEXICO OIL CONSERVATION BOARD
WELL LOCATION AND ACREAGE DEDICATION PLAT

LIVED

All distances must be from the outer boundaries of the Section

DEC 7 1972

Lessee TEXAS OIL & GAS Corp.			Location City of Carlsbad		
Section 0	Section 12	Township 32 South	Range 26 East	County Eddy	State N.M.
Actual True Location of Well:					
660 feet from the south line and		1980 feet from the east line			
Ground Level Elev. 3149.4	Producing Formation Morrow	Section Carlsbad, South		Section 320	

1. Outline the acreage dedicated to the subject well by colored pencil or hatchure marks on the plat below.
2. If more than one lease is dedicated to the well, outline each and identify the ownership thereof (both as to working interest and royalty).
3. If more than one lease of different ownership is dedicated to the well, have the interests of all owners been consolidated by communitization, unitization, force-pooling, etc?

☒ Yes ☐ No If answer is "yes," type of consolidation Force Pooling

If answer is "no," list the owners and tract descriptions which have actually been consolidated. (Use reverse side of this form if necessary.)

No allowable will be assigned to the well until all interests have been consolidated (by communitization, unitization, forced-pooling, or otherwise) or until a non-standard unit, eliminating such interests, has been approved by the Commission.

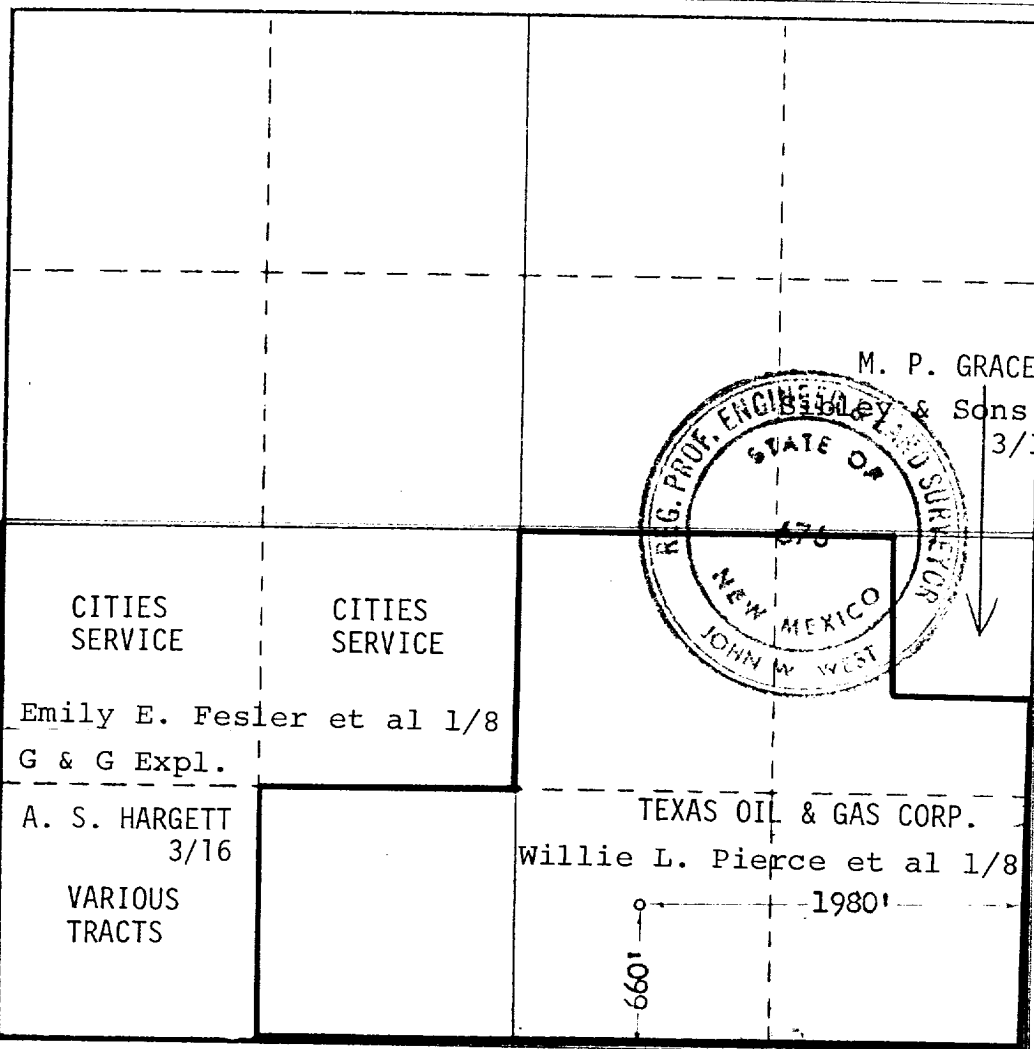

CERTIFICATION

I hereby certify that the information contained herein is true and complete to the best of my knowledge and belief.

Name
Petroleum Engineer

Position
Texas Oil & Gas Corp.

Date
December 6, 1972

I hereby certify that the well location shown on this plat was plotted from field notes of actual surveys made by me or under my supervision, and that the same is true and correct to the best of my knowledge and belief.

Date Surveyed
Oct. 20, 1972

Registered Professional Engineer and/or Land Surveyor

John W. West
Certificate No. **676**

0 330 660 990 1320 1650 1980 2310 2640 2970 3300 3630 3960 4290 4620 4950 5280 5610 5940 6270 6600