

DISTRICT I  
 P.O. Box 1980, Hobbs, NM 88241-1980

State of New Mexico  
 Energy, Minerals and Natural Resources Department

Form C-102  
 Revised February 10, 1994  
 Submit to Appropriate District Office  
 State Lease - 4 Copies  
 Fee Lease - 3 Copies

DISTRICT II  
 P.O. Drawer ED, Artesia, NM 88211-0719

OIL CONSERVATION DIVISION  
 P.O. Box 2088  
 Santa Fe, New Mexico 87504-2088

DISTRICT III  
 1000 Rio Brazos Rd., Artec, NM 87410

AMENDED REPORT

DISTRICT IV  
 P.O. Box 2088, Santa Fe, NM 87504-2088

WELL LOCATION AND ACREAGE DEDICATION PLAT

API Number	Pool Code	Pool Name
		Indian Basin Morrow
Property Code	Property Name	Well Number
	INDIAN BASIN "A"	4
OGRID No.	Operator Name	Elevation
14021	MARATHON OIL COMPANY	3855

Surface Location

UL or lot No.	Section	Township	Range	Lot Idn	Feet from the	North/South line	Feet from the	East/West line	County
G	22	21 S	23 E		1650	NORTH	1650	EAST	EDDY

Bottom Hole Location If Different From Surface

UL or lot No.	Section	Township	Range	Lot Idn	Feet from the	North/South line	Feet from the	East/West line	County

Dedicated Acres	Joint or Infill	Consolidation Code	Order No.
640			

NO ALLOWABLE WILL BE ASSIGNED TO THIS COMPLETION UNTIL ALL INTERESTS HAVE BEEN CONSOLIDATED OR A NON-STANDARD UNIT HAS BEEN APPROVED BY THE DIVISION

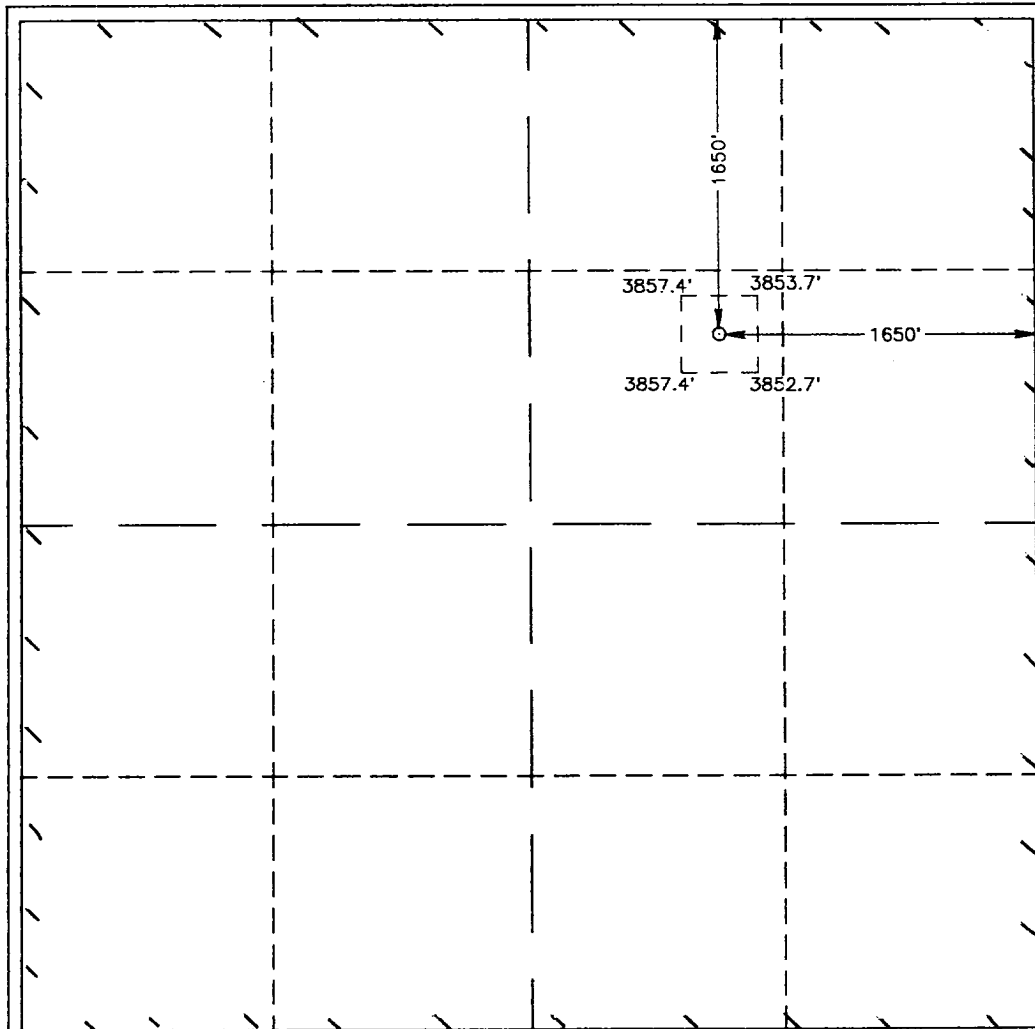

**OPERATOR CERTIFICATION**

I hereby certify the the information contained herein is true and complete to the best of my knowledge and belief.

Jerry Fletcher  
 Signature

*[Signature]*  
 Printed Name

Engineer Tech.  
 Title

10/24/00  
 Date

---

**SURVEYOR CERTIFICATION**

I hereby certify that the well location shown on this plat was plotted from field notes of actual surveys made by me or under my supervision, and that the same is true and correct to the best of my belief.

OCTOBER 18, 2000  
 Date Surveyed JLP

Signature & Seal of Professional Surveyor

*[Signature]* 10/23/00  
 W.C. Num. 00-11-1320

Certificate No. RONALD J. EIDSON, 3239  
 GARY G. EIDSON, 12641