

Form 9-331
(Mar 1963)

UNITED STATES DEPARTMENT OF THE INTERIOR
GEOLOGICAL SURVEY

SUBMIT IN TRIPLICATE*
(Other instructions on reverse side)

Form approved,
Budget Bureau No. 42-R1424.
5. LEASE DESIGNATION AND SERIAL NO.

SUNDRY NOTICES AND REPORTS ON WELLS

(Do not use this form for proposals to drill or to deepen or plug into a different reservoir.
Use "APPLICATION FOR PERMIT" for such proposals.)

NM-15295 RECEIVED

6. IF INDIAN, ALLOTTEE OR TRIBE NAME

JAN 30 1980

7. UNIT AGREEMENT NAME

JAN 28 1980

8. FARM OR LEASE NAME

C & K Federal

9. WELL NO.

2-Y

10. FIELD AND POOL, OR WILDCAT

Wildcat

11. SEC., T., R., M., OR BLK. AND SURVEY OR AREA

Sec. 8, T-24-S, R-26-E

1. OIL WELL GAS WELL OTHER

2. NAME OF OPERATOR
C & K Petroleum, Inc.

3. ADDRESS OF OPERATOR
P.O. Drawer 3546, Midland, Texas 79702

4. LOCATION OF WELL (Report location clearly and in accordance with any State requirements.*
See also space 17 below.)
At surface

1650' FSL to 1781' FEL, Sec. 8, T-24-S, R-26-E,
Eddy County, New Mexico

14. PERMIT NO. 15. ELEVATIONS (Show whether DF, RT, GR, etc.)
3481.9

12. COUNTY OR PARISH 13. STATE
Eddy NM

16. Check Appropriate Box To Indicate Nature of Notice, Report, or Other Data

NOTICE OF INTENTION TO:

TEST WATER SHUT-OFF
FRACTURE TREAT
SHOOT OR ACIDIZE
REPAIR WELL
(Other)
PULL OR ALTER CASING
MULTIPLE COMPLETE
ABANDON*
CHANGE PLANS

SUBSEQUENT REPORT OF:

WATER SHUT-OFF
FRACTURE TREATMENT
SHOOTING OR ACIDIZING
(Other)
REPAIRING WELL
ALTERING CASING
ABANDONMENT*

(NOTE: Report results of multiple completion on Well Completion or Recompletion Report and Log form.)

17. DESCRIBE PROPOSED OR COMPLETED OPERATIONS (Clearly state all pertinent details, and give pertinent dates, including estimated date of starting any proposed work. If well is directionally drilled, give subsurface locations and measured and true vertical depths for all markers and zones pertinent to this work.)*

It has been brought to our attention that our original staked location for this well was not a standard location. To remedy this situation and to comply with the Standard Location Minimum Distance Provisions, we have moved the location 19' North. We are attaching a revised well location plat which reflects the new location.

18. I hereby certify that the foregoing is true and correct

SIGNED [Signature] TITLE Administrative Supervisor DATE 01-25-80

(This space for Federal or State office use)

APPROVED BY GEORGE H. STEWART TITLE DATE

NEW MEXICO OIL CONSERVATION COMMISSION
WELL LOCATION AND ACREAGE DEDICATION PLAT

Form C-102
 Supersedes C-128
 Effective 1-1-65

All distances must be from the outer boundaries of the Section

Operator C & K Petroleum Inc.		Lease CK Federal		Well No. 2-Y
Unit Letter J	Section 8	Township 24 South	Range 26 East	County Eddy
Actual Footage Location of Well: 1650' feet from the South line and 1781 feet from the East line				
Ground Level Elev. 3481.9	Producing Formation Delaware	Pool Wildcat	Dedicated Acreage: 40 Acres	

1. Outline the acreage dedicated to the subject well by colored pencil or hachure marks on the plat below.
2. If more than one lease is dedicated to the well, outline each and identify the ownership thereof (both as to working interest and royalty).
3. If more than one lease of different ownership is dedicated to the well, have the interests of all owners been consolidated by communitization, unitization, force-pooling, etc?

Yes No If answer is "yes," type of consolidation _____

If answer is "no," list the owners and tract descriptions which have actually been consolidated. (Use reverse side of this form if necessary.) _____

No allowable will be assigned to the well until all interests have been consolidated (by communitization, unitization, forced-pooling, or otherwise) or until a non-standard unit, eliminating such interests, has been approved by the Commission.

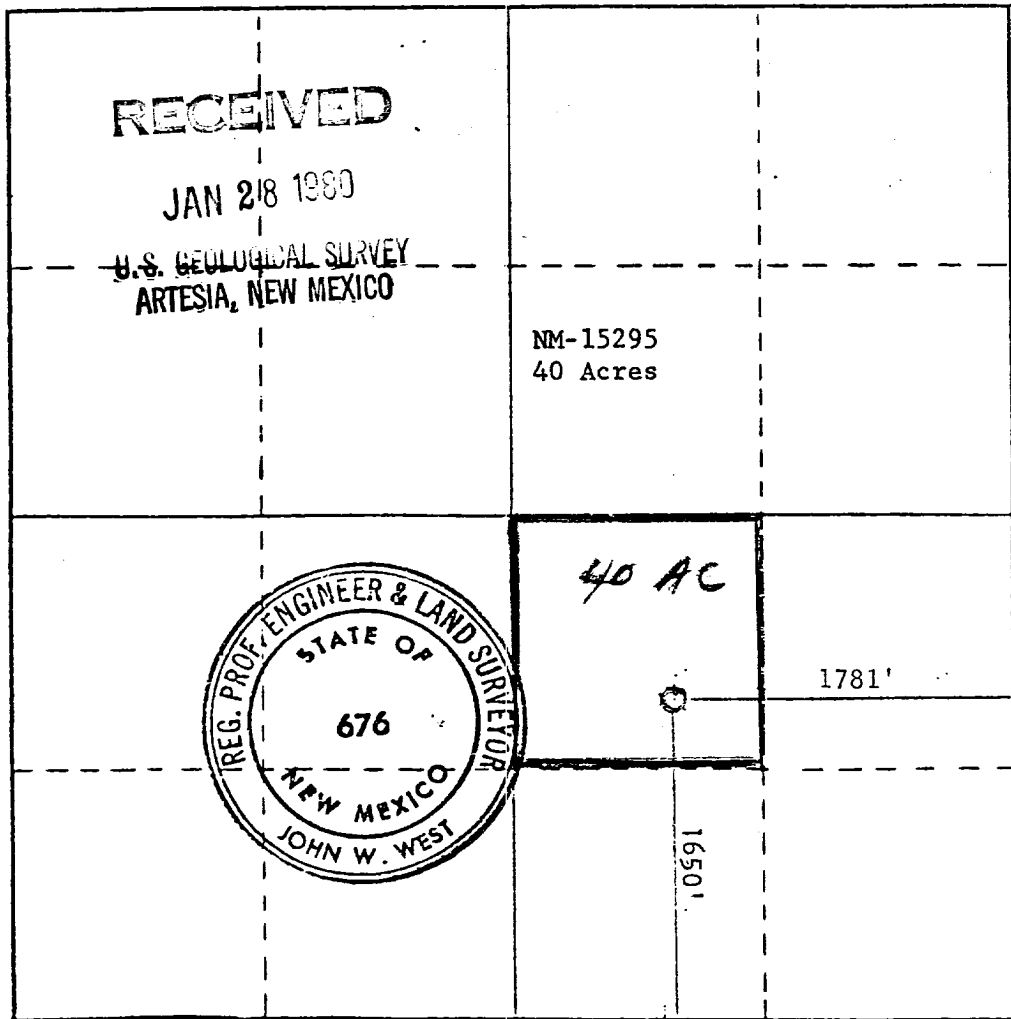

RECEIVED

JAN 218 1980

**U.S. GEOLOGICAL SURVEY
 ARTESIA, NEW MEXICO**

**NM-15295
 40 Acres**

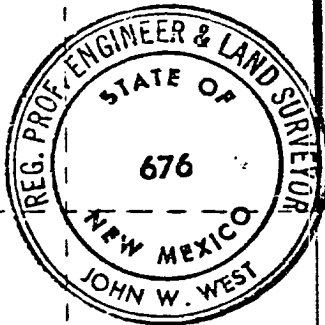

CERTIFICATION

I hereby certify that the information contained herein is true and complete to the best of my knowledge and belief.

[Signature]

Name
Administrative Supervisor

Position
C & K Petroleum, Inc.

Company
September 14, 1979

Date

I hereby certify that the well location shown on this plat was plotted from field notes of actual surveys made by me or under my supervision, and that the same is true and correct to the best of my knowledge and belief.

Date Surveyed
September 4, 1979

Registered Professional Engineer and/or Land Surveyor

[Signature]

Certificate No. **John W. West 676**
Ronald J. Eidson 3239

