

NO. OF COPIES RECEIVED	
DISTRIBUTION	
SANTA FE	
FILL	
U.S.G.S.	
LAND OFFICE	
OPERATOR	

OCT - 2 1981
O. C. D.
ARTESIA, OFFICE

5A. Indicate Type of Lease
STATE FEE
5. State Oil & Gas Lease No.
LG 1480

APPLICATION FOR PERMIT TO DRILL, DEEPEN, OR PLUG BACK

a. Type of Work
b. Type of Well
c. Name of Operator
d. Address of Operator
e. Location of Well

DRILL DEEPEN PLUG BACK
OIL WELL GAS WELL OTHER
SINGLE ZONE MULTIPLE ZONE
HCW Exploration, Inc. ✓
P.O. Box 10585, Midland, Texas 79702
UNIT LETTER I LOCATED 1980 FEET FROM THE South LINE
660 FEET FROM THE East LINE OF SEC. 16 TWP. 25-S RCF. 28-E NMPM

7. Unit Agreement Name
8. Part of Lease Name
9. Well No.
10. Field and Pool, or Wildcat
12. County

Gulf State ¹⁶ ~~15~~
1
Wildcat
Eddy

18. Proposed Depth: 8400'
19A. Formation: Bone Spring
20. Rotary or C.T.: Rotary
21. Elevations (Show whether DP, RT, etc.): G.L. 2981'
21A. Kind & Status Plug. Bond: Blanket
21B. Drilling Contractor: HCW Drlg. Corp.
22. Approx. Date Work will start: November 1981

PROPOSED CASING AND CEMENT PROGRAM

SIZE OF HOLE	SIZE OF CASING	WEIGHT PER FOOT	SETTING DEPTH	SACKS OF CEMENT	EST. TOP
17-1/2"	13-3/8"	48#	400'±	400 sx.	circ
12-1/4"	8-5/8"	24# & 32#	2600'±	2000 sx.	circ
7-7/8"	4-1/2"	10.5# & 11.6#	8400'±	1500 sx.	2600'

Drill 17 1/2" hole to 400'±. Set & cement 13-3/8" csg at 400'± w/400 sx, circulate to surface. WOC 18 hrs. Drill 12-1/4" hole to 2600'±. Set 8-5/8" casing at 2600'±, cement to surface w/approx. 2000 sx. WOC 18 hrs. Drill 7-7/8" hole to 8400'. Run logs. If production is indicated, run 4-1/2" casing to TD & cement with sufficient volume to bring cement into 8-5/8" casing. Blowout preventer program will consist of annular preventer on 13-3/8" surface casing and a 13-5/8" 5000 psi W.P. double with pipe rams & blind rams on 8-5/8" intermediate casing. No abnormal pressures are anticipated. Well should reach total depth with 9.0-9.5 ppg cut brine water.

APPROVAL VALID FOR 180 DAYS
PERMIT EXPIRES 4-6-82
UNLESS DRILLING UNDERWAY

ABOVE SPACE DESCRIBE PROPOSED PROGRAM; IF PROPOSAL IS TO DEEPEN OR PLUG BACK, GIVE DATA ON PRESENT PRODUCTIVE ZONE AND PROPOSED NEW PRODUCTION ZONE. GIVE BLOWOUT PREVENTER PROGRAM, IF ANY.

I hereby certify that the information above is true and complete to the best of my knowledge and belief.

Signed Steve A Douglas Title Division Engineer Date 10-1-81

(This space for State Use)

APPROVED BY W. A. Gressitt TITLE SUPERVISOR, DISTRICT II DATE OCT 6 1981

CONDITIONS OF APPROVAL, IF ANY:

MEXICO OIL CONSERVATION COMMISSION
WELL LOCATION AND ACREAGE DEDICATION PLAT

Form C-102
Supersedes C-128
Effective 1-4-65

All distances must be from the outer boundaries of the Section.

Operator H.C.W. EXPLORATION, INC.		Lease GULF "16" STATE 16		Well No. 1
Unit Letter I	Section 16	Township 25 South	Range 28 East	County Eddy

Actual Footage Location of Well:
1980 feet from the South line and 660 feet from the East line

Ground Level Elev. 2981.3	Producing Formation Bone Spring	Pool Wildcat Bone Spring	Dedicated Acreage: 80 40 Acres
------------------------------	------------------------------------	-----------------------------	-----------------------------------

- Outline the acreage dedicated to the subject well by colored pencil or hachure marks on the plat below.
- If more than one lease is dedicated to the well, outline each and identify the ownership thereof (both as to working interest and royalty).
- If more than one lease of different ownership is dedicated to the well, have the interests of all owners been consolidated by communitization, unitization, force-pooling, etc?

Yes No If answer is "yes," type of consolidation _____

If answer is "no," list the owners and tract descriptions which have actually been consolidated. (Use reverse side of this form if necessary.) _____

No allowable will be assigned to the well until all interests have been consolidated (by communitization, unitization, forced-pooling, or otherwise) or until a non-standard unit, eliminating such interests, has been approved by the Commission.

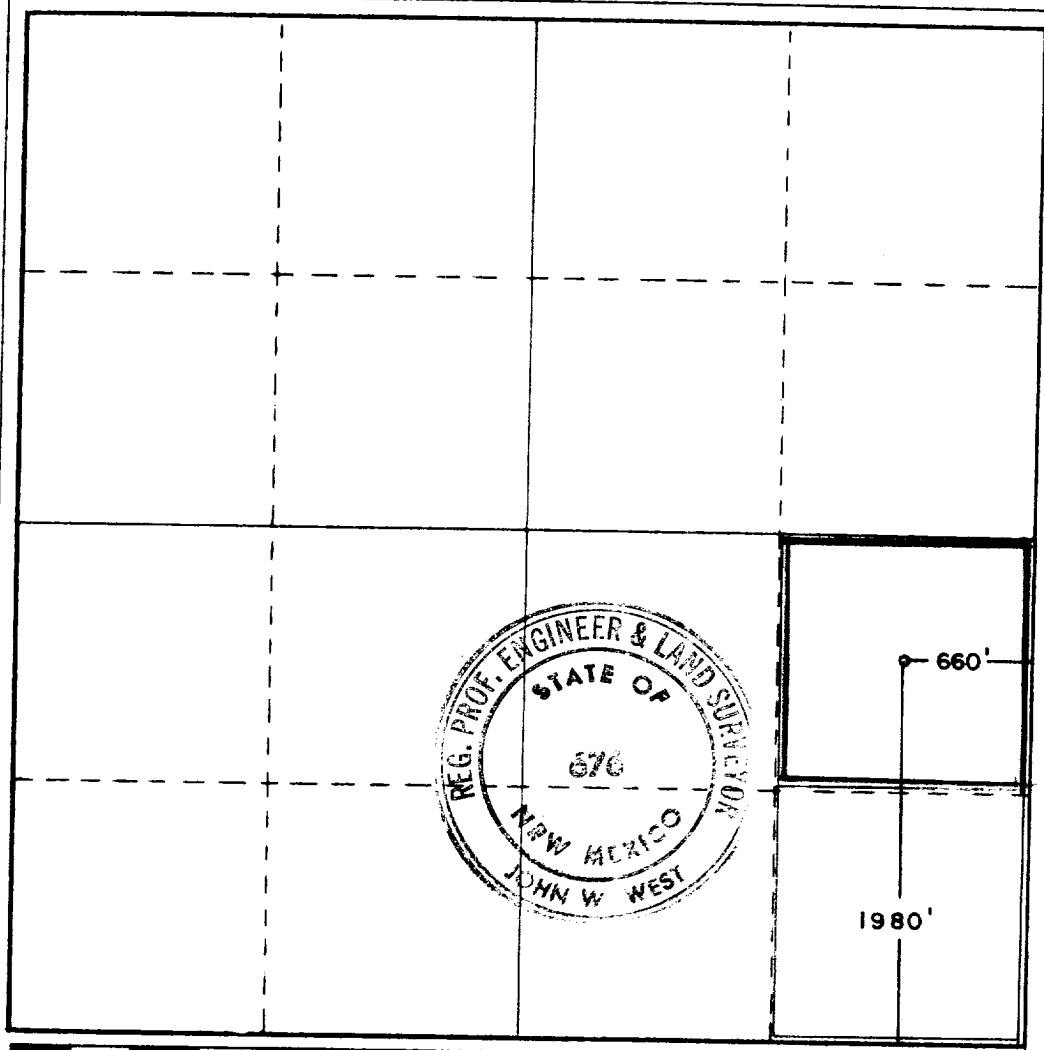

CERTIFICATION

I hereby certify that the information contained herein is true and complete to the best of my knowledge and belief.

Steve A Douglas

Name
Division Engineer
Position
HCW Exploration, Inc.
Company
October 1, 1981
Date

I hereby certify that the well location shown on this plat was plotted from field notes of actual surveys made by me or under my supervision, and that the same is true and correct to the best of my knowledge and belief.

Date Surveyed
8/31/81
Registered Professional Engineer and/or Land Surveyor

John W. West
Certificate No. JOHN W. WEST 676
PATRICK A. ROMERO 6868
Ronald J. Eidson 3239

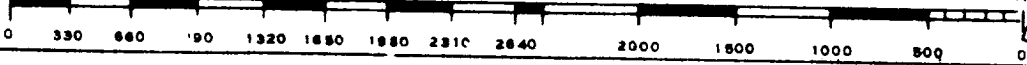



HCW EXPLORATION, INC.

P. O. Box 10585
Suite 200
601 N. Loraine Street
Midland, Texas 79702
(915) 683-3303

October 1, 1981

RECEIVED
OCT - 2 1981
O. C. D.
ARTESIA OFFICE

Energy and Minerals Department
Oil Conservation Division
Drawer DD
Artesia, New Mexico 88210

Gentlemen:

Please find enclosed six copies of Form C-101 and four copies of Form C-102 on the HCW Exploration, Inc. Gulf State "16" No. 1. If there are any problems with these forms please notify.

Sincerely,
Steve A. Douglas
Steve A. Douglas
Division Engineer