

Form 3160-5
(June 1990)

UNITED STATES
DEPARTMENT OF THE INTERIOR
BUREAU OF LAND MANAGEMENT

FORM APPROVED
Budget Bureau No. 1004-0135
Expires: March 31, 1993

SUNDRY NOTICES AND REPORTS ON WELLS

Do not use this form for proposals to drill or to deepen or reentry to a different reservoir.

Use "APPLICATION FOR PERMIT - " for such proposals

SUBMIT IN TRIPLICATE

1. Type of Well
☒ Oil Well ☐ Gas Well ☐ Other

2. Name of Operator
ARCO Permian

3. Address and Telephone No.

P.O. Box 1089, Eunice, NM 88231

505-394-1649

4. Location of Well (Footage, Sec., T., R., M., or Survey Description)

Unit Letter H, 1750' FNL & 990' FEL
Sec. 8, T26S, R29E

5. Lease Designation and Serial No.

NM101108

6. If Indian, Allottee or Tribe Name

7. If Unit or CA, Agreement Designation

8. Well Name and No.

West Brushy 2
Federal

9. API Well No.

10. Field and Pool, or exploratory Area

Brushy Draw Delaware

11. County or Parish, State

Eddy NM

12. CHECK APPROPRIATE BOX(s) TO INDICATE NATURE OF NOTICE, REPORT, OR OTHER DATA

TYPE OF SUBMISSION

- ☒ Notice of Intent
☐ Subsequent Report
☐ Final Abandonment Notice

TYPE OF ACTION

- ☐ Abandonment
☐ Recompletion
☐ Plugging Back
☐ Casing Repair
☐ Altering Casing
☒ Other Location
☒ Change of Plans
☐ New Construction
☐ Non-Routine Fracturing
☐ Water Shut-Off
☐ Conversion to Injection
☐ Dispose Water

(Note: Report results of multiple completion on Well Completion or Recompletion Report and Log form.)

13. Describe Proposed or Completed Operations (Clearly state all pertinent details, and give pertinent dates, including estimated date of starting any proposed work. If well is directionally give subsurface locations and measured and true vertical depths for all markers and zones pertinent to this work.)*

ARCO Permian requests permission to change this well location as per direction from Barry Hunt - BLM. The original APD location referenced Unit Letter H, 1650' FNL & 990' FEL, Sec. 8, T26S, R29E. The new well location will change to Unit Letter H, 1750' FNL & 990' FEL, Sec. 8, T26S, R29E as indicated on the attached Well Location and Dedication Plat.

The V-door location will face the West and the drilling pits will face the South.

14. I hereby certify that the foregoing is true and correct

Signed

[Signature]

Title Sr. Administrative Asst.

Date 06/19/01

(This space for Federal or State office use)

Approved by

[Signature] JOE G. LARA

Title

Acting FIELD MANAGER

Date

JUL 03 2001

Conditions of approval, if any:

Title 18 U.S.C. Section 1001, makes it a crime for any person knowingly and willfully to make to any department or agency of the United States any false, fictitious or fraudulent statement or representations as to any matter within its jurisdiction.

* See Instruction on Reverse Side

State of New Mexico

Energy, Minerals and Natural Resources Department

DISTRICT I

P.O. Box 1960, Hobbs, NM 88241-1960

DISTRICT II

P.O. Drawer DD, Artesia, NM 88211-0719

DISTRICT III

1000 Rio Brazos Rd., Asteo, NM 87410

DISTRICT IV

P.O. BOX 2088, SANTA FE, N.M. 87504-2088

OIL CONSERVATION DIVISION

P.O. Box 2088

Santa Fe, New Mexico 87504-2088

Form C-102

Revised February 10, 1994

Submit to Appropriate District Office

State Lease - 4 Copies

Fee Lease - 3 Copies

WELL LOCATION AND ACREAGE DEDICATION PLAT

☐ AMENDED REPORT

API Number	Pool Code	Pool Name
Property Code	Property Name WEST BRUSHY FEDERAL "8"	Well Number 2
OGRID No.	Operator Name ARCO PERMIAN	Elevation 2928'

Surface Location

UL or lot No.	Section	Township	Range	Lot Idn	Feet from the	North/South line	Feet from the	East/West line	County
H	8	26-S	29-E		1750	NORTH	990	EAST	EDDY

Bottom Hole Location If Different From Surface

UL or lot No.	Section	Township	Range	Lot Idn	Feet from the	North/South line	Feet from the	East/West line	County
Dedicated Acres	Joint or Infill	Consolidation Code	Order No.						

NO ALLOWABLE WILL BE ASSIGNED TO THIS COMPLETION UNTIL ALL INTERESTS HAVE BEEN CONSOLIDATED OR A NON-STANDARD UNIT HAS BEEN APPROVED BY THE DIVISION

	OPERATOR CERTIFICATION I hereby certify the the information contained herein is true and complete to the best of my knowledge and belief. <u>Kenn H. Murriss</u> Signature <u>Kenn H. Murriss</u> Printed Name <u>Sr. Admin. Asst</u> Title <u>6.19.01</u> Date
	SURVEYOR CERTIFICATION I hereby certify that the well location shown on this plat was plotted from field notes of actual surveys made by me or under my supervision, and that the same is true and correct to the best of my belief. JUNE 12, 2001 Date Surveyed Signature & Seal of Professional Surveyor <u>Ronald E. Kidson</u> 6/08/01 81-11-0726 Certificate No. <u>RONALD E. KIDSON 3239</u> <u>CARY KIDSON 12641</u>

VICINITY MAP

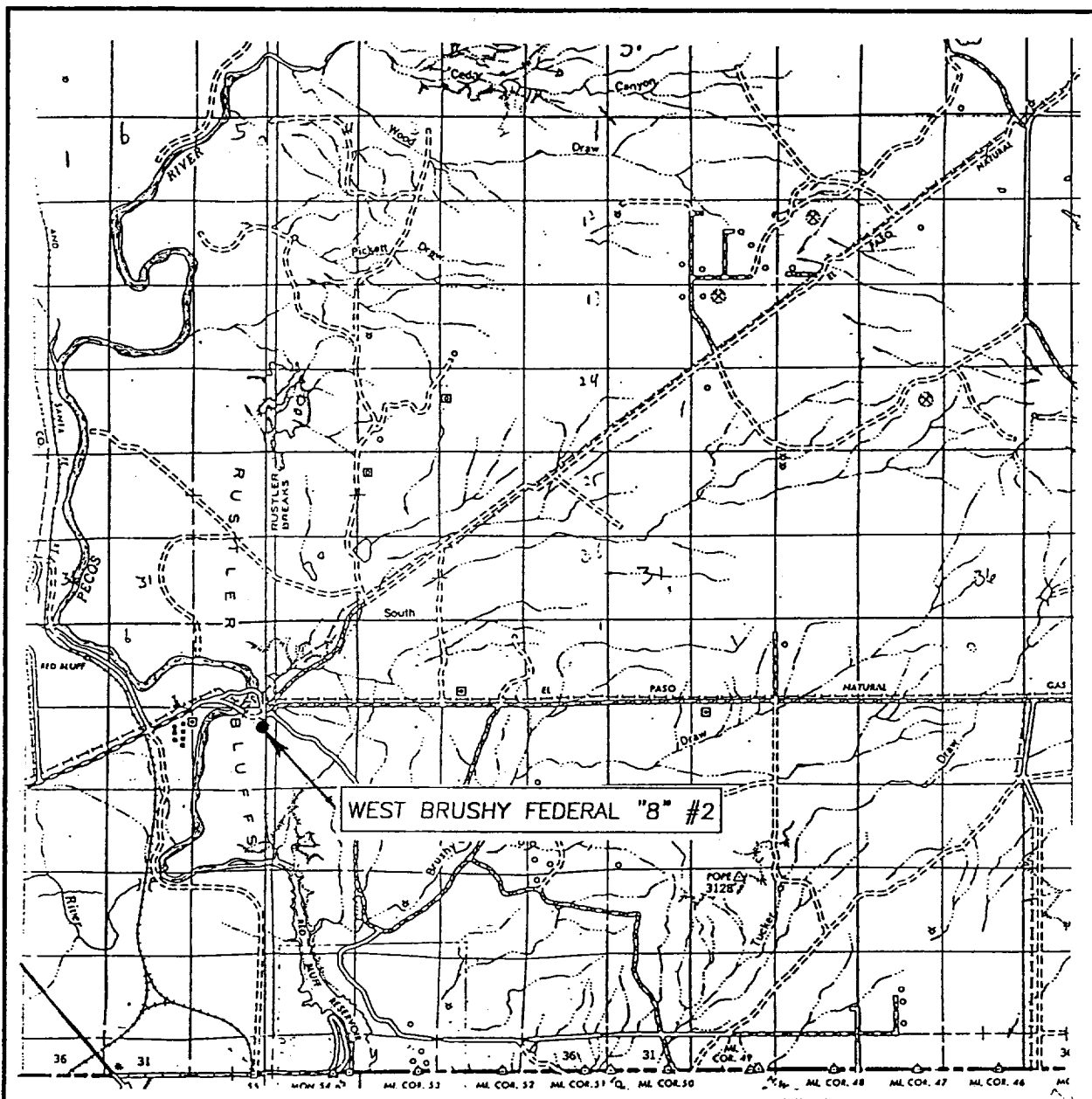

SCALE: 1" = 2 MILES

SEC. 8 TWP. 26-S RGE. 29-E

SURVEY N.M.P.M.

COUNTY EDDY

DESCRIPTION 1750' FNL & 990' FEL

ELEVATION 2928'

OPERATOR ARCO PERMIAN

LEASE WEST BRUSHY FEDERAL "8"

JOHN WEST SURVEYING
HOBBS, NEW MEXICO
(505) 393-3117

